



# Yamaha Wolverine RMAX Slip-On Installation Instructions

**For Models:** Wolverine RMAX (2021-2026)

## Removal

NOTE: If your vehicle is equipped with a rear camera please refer to the Rear Camera Relocation kit instruction before proceeding with the exhaust installation.

1. Remove the (5) caps covering the bolts securing the Plastic Muffler Protector.
2. Remove the Plastic Muffler Protector.
3. Remove the (2) bolts securing the small auxiliary heat shield to the main Exhaust heat shield.
4. Remove the Spring bolts from the factory ball gasket assembly and set the springs aside for use later.
5. With the Dump bed in the up position remove the (2) bolts securing the under bed heat shield to the Exhaust heat shield.
6. Remove the bolt tucked in the frame rail Behind the right rear shock.
7. Remove the final (2) bolts securing the exhaust heat shield to the frame and let the shield rest on the muffler assembly.
8. Next remove the (2) 12mm head bolts securing the Muffler assembly to the frame of the vehicle and remove the muffler with the heat shield in one piece.

## Installation

1. Begin by installing the supplied **(2xM8-1.25x20 Speed Clips)** onto the factory underbed heat shield.
2. Using the supplied **(2xM8-1.25x20 Hex Bolts, 2xM8 Nylock Nuts and 4x 1/4" Flat Washers)** Loosely secure the **HMF Lower Bracket** to the frame.
3. Using the supplied **(2xM8-1.25x16 Hex Bolts, 2x 1/4" Flat Washers)** loosely secure the **HMF Top Mounting Bracket** to the threaded holes on back of the frame making sure that the factory bed heatshield sits on top of the **Top Mounting Bracket**.
4. Take the **HMF Heatshield** slip it in between the **Upper** and **Lower HMF Mounting Brackets** and secure all three pieces with





the provided **(2xM8-1.25x25, 4x 1/4" Flat Washers)** into the previously installed **(2xM8-1.25x20 Speed Clips)**.

5. With the **brackets** in place use the provided **(2xM8-1.25x20 Hex Bolts, 2xM8 Nylock Nuts and 4x1/4" Flat Washers)** to loosely secure the **HMF Titan Muffler assembly** to the **Lower Bracket**.



6. Once the **HMF Muffler Assembly** is in place take the provided **(2x M10x80-M8x1.25 Shoulder bolts, 2x M8-1.25 Stover Nuts, 2x 3/8" USS Washers and 2x 3/8" Flat Washers)** and the factory springs to secure the inlet of the **HMF Titan** can to the Factory Ball Gasket.

7. With all components in place make any final positioning adjustments and tighten all hardware.





## Hardware

-  (1) 400005 - 90005100C
-  (2) 400033 - Bolt - Hex - M8-1.25 X 16
-  (4) 400030 - Bolt - Hex - M8-1.25 X 20
-  (2) 400028 - Bolt - Hex - M8-1.25 X 25
-  (2) 400431 - Bolt - Shoulder - M10 X 80 - M8 X

### 1.25 Thread

-  (4) 400015 - Nut - Nylock - M8-1.25
-  (2) 400436 - Nut - Speed/Clip - M8-1.25 x 20mm

### Long

-  (2) 400014 - Nut - Stover - M8-1.25
-  (12) 400073 - Washer - Flat - 1/4"
-  (2) 400065 - Washer - Flat - 3/8"
-  (2) 400063 - Washer - USS - 3/8"

\* Click thumbnails to enlarge

Figure #1



Figure #2

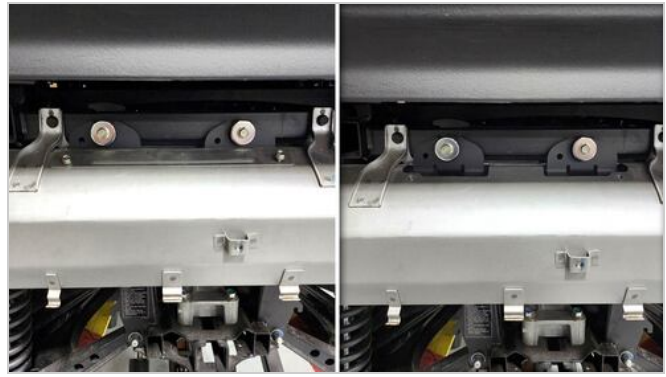

Figure #3



Figure #4

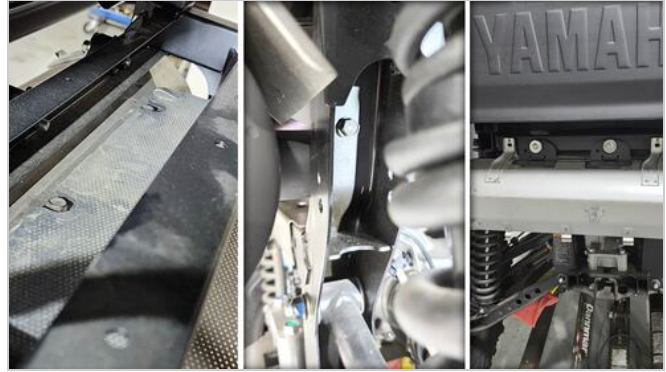

Figure #5



Figure #6

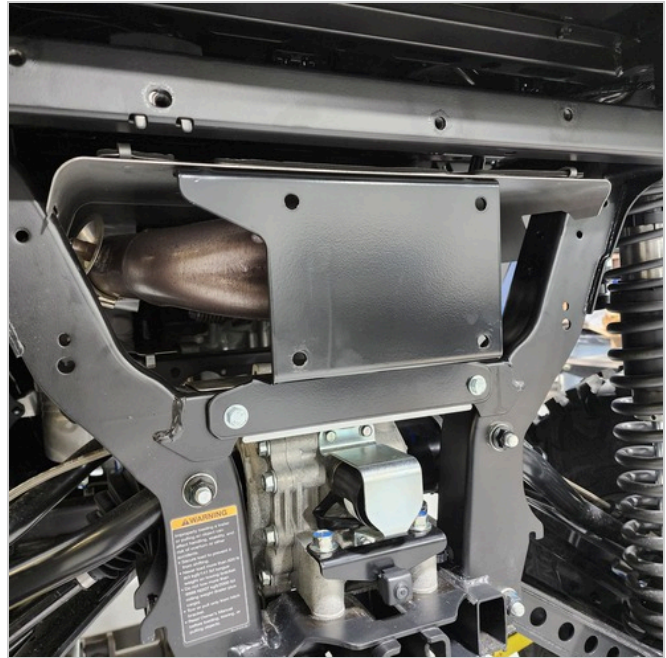

Figure #7

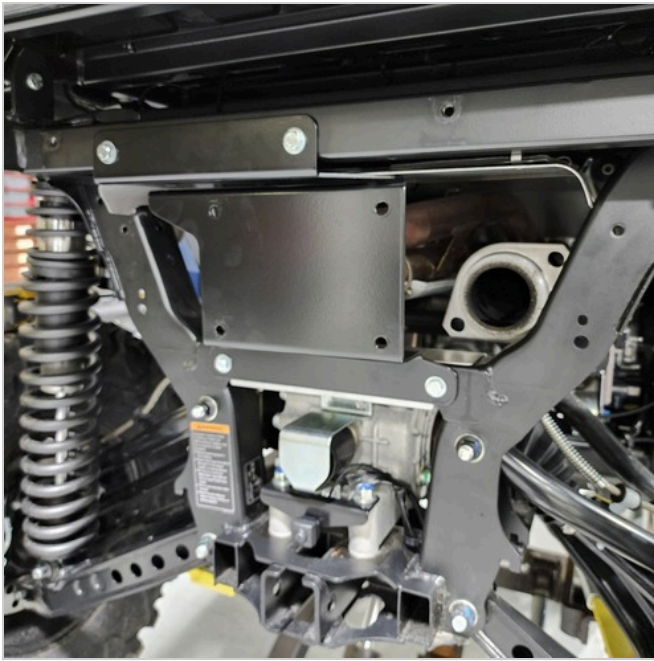

Figure #8



Figure #9



Figure #10



**(1) 90005100C**



**(2) Bolt - Hex - M8-1.25 X 16**

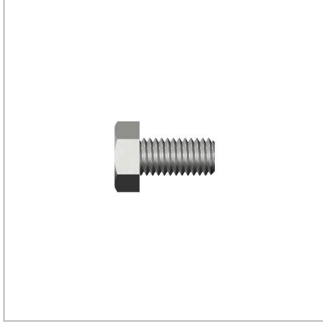

**(4) Bolt - Hex - M8-1.25 X 20**

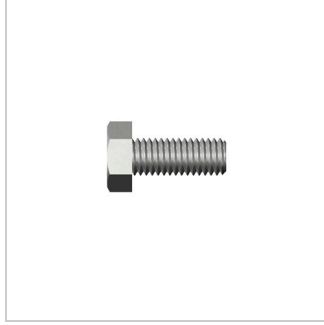

**(2) Bolt - Hex - M8-1.25 X 25**

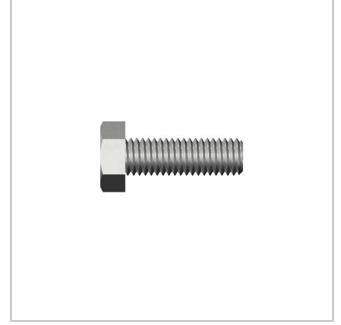

**(2) Bolt - Shoulder - M10 X 80 - M8 X 1.25 Thread**

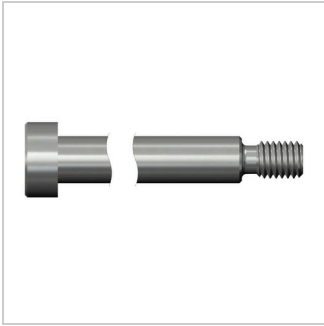

**(4) Nut - Nylock - M8-1.25**

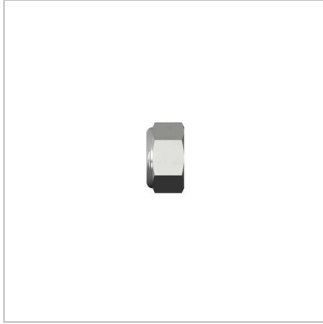

**(2) Nut - Speed/Clip - M8-1.25 x 20mm Long**



**(2) Nut - Stover - M8-1.25**



**(12) Washer - Flat - 1/4"**

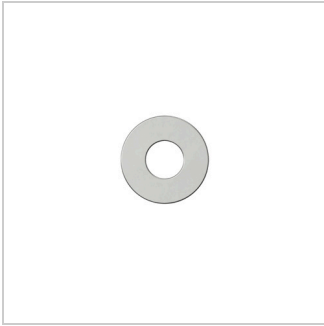

**(2) Washer - Flat - 3/8"**

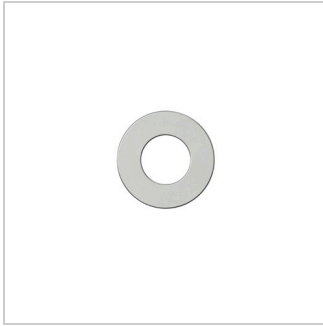

**(2) Washer - USS - 3/8"**

