

*FREE SHIPPING ON ORDERS OVER \$98 (EXCLUSIONS APPLY)

[SHOP CATEGORIES](#)[WHY S&B](#)[SHOP BY VEHICLE](#)

0

INSTALL INSTRUCTIONS FOR CAI-75-5172

[PRINT](#)

BEFORE YOU START

Note: This intake kit may not fit with the following Aftermarket Parts installed:

- Body Lift or Lowering Kit
- Custom Hood
- Throttle Body Spacer / Upgrade

Please read the entire product guide before proceeding.

- Ensure all parts are present.
- If you are missing any of the components, call our customer support at (909) 947-0015.
- Do not work on your vehicle while the engine is hot.
- Make sure the engine is turned off and the vehicle is in Park or the Parking Brake is set.

REQUIRED TOOLS

- 5/16 or 8mm socket/nut driver
- Flat head screw driver
- X-Acto knife
- Phillips Head screw driver



Hi. Need any help?

[Cookie Preferences](#)

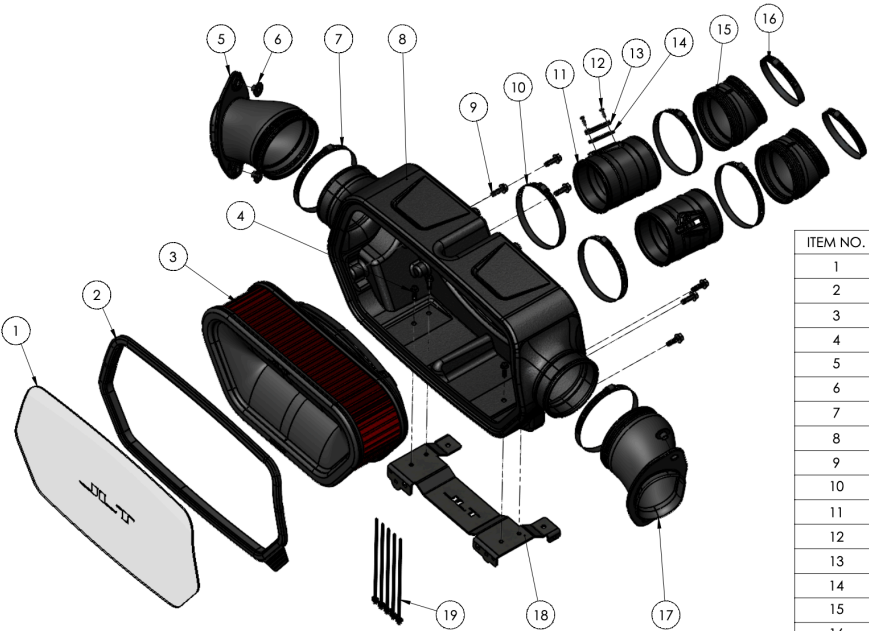

ITEM NO.	PART NUMBER	DESCRIPTION	QTY.
1	AI2910-00	Clear Lid	1
2	AI2904C-00	Snap-in Lid Seal, Silicone	1
3	KF-1097	S&B Air Filter	1
4	AI1983-00	M6-1.0 Hex Head, Black	4
5	AI2905C-00	Left Inlet Coupler, Silicone	1
6	AI2296-00	Bushing, Aluminum	4
7	AG1010-01	Hose Clamp #80, Black	2
8	AL1439-00	Air Box	1
9	AI2992-00	M8-1.25 Hex Head, SS	6
10	AG1009-01	Hose Clamp #72, Black	4
11	AL1438-00	Tube	2
12	AI1837-00	#8-32 MAF Screws	4
13	AI1822-00	MAF Plate, Black	2
14	AI1823-00	MAF Gasket, Black	2
15	AI2907C-00	Angled Reducing Coupler, Silicone	2
16	AG1008-01	Hose Clamp #60, Black	2
17	AI2906C-00	Right Inlet Coupler, Silicone	1
18	AI2911-00	Bracket/Heat Shield, Black	1
19	AI2154-00	Push In Mount Cable Tie	5

STEP 1

Remove the engine cover from the vehicle. Save the bolts for later.



Remove the 10mm bolt and slide the coolant tank out of the way.



STEP 3

Disconnect and sensor by disengaging the red locking tab and sliding up on the tab with a pick.



STEP 4

Disconnect the MAF harnesses as seen in the image. To see how to remove, please refer to our install video starting at 2:30.

https://www.youtube.com/watch?v=A6O_6W3S2fg&t=6s

STEP 5

Remove the O2 sensors by unclipping each one.

STEP 6

With a panel popper, remove the two grey push rivets seen in the image.

STEP 7

Remove the two brown/orange push rivets that secure down the bottom harnesses to the airbox.

STEP 8

Loosen the hose clamps that are on the couplers.

STEP 9

Remove the screw on the drivers side as seen in the image. Do not lose this.

STEP 10

To get to the passenger side bottom airbox mount bolt, remove the canister.

STEP 11

Now remove the bottom bolt once there is clearance.

STEP 12

Now take a magnet or claw tool and remove the bolt. Do not skip this steps, otherwise you will lose the bolt.

STEP 13

Remove the trunk cover carpet.

STEP 14

Now remove the screws that hold down the trunk cover.

STEP 15

Remove the final two airbox mounting bolts.

STEP 16

Slide the red clip on the sensor then remove the harness.

STEP 17

Remove all the bolts that hold down the factory scoops.

Remove the last push rivet holding down the bottom of the box.

STEP 19

Remove the passenger side MAF sensor.

STEP 20

To remove the stock airbox, unclip the lid off the airbox and remove the filters. This will give you the clearance to remove the whole airbox.

STEP 21

Remove both couplers from the vehicle.

STEP 22

Remove the 10mm bolts that secure down the factory scoops. (on both driver and passenger side)

STEP 23

Install the JLT bracket and secure down.

STEP 24

Install the JLT scoops and secure down with the bolts. They will be labeled left and right.

STEP 25

Transfer the heat shield to the JLT airbox.

STEP 25B

If you have the Fabspeed High Flow Cats, you will need to leave out the bottom bolt on the heat shields as these would contact the O2 sensor.

STEP 26

Transfer the gps antenna to the jlt airbox.

STEP 27

Cookie Preferences

Transfer the MAF sensors and install them onto the JLT tubes.

STEP 28

Install the JLT hose clamps and couplers onto the vehicle.

STEP 29

Remove the sensor from the stock airbox and install it onto the JLT bracket.

STEP 30

Clip this line back in.

[Cookie Preferences](#)

If you broke the
brown/orange push rivet, we
supply extra.

STEP 31

Install the hose clamps onto
the scoops.

STEP 32

Install the JLT airbox into the
vehicle.

Install the 10mm into the bottom on the airbox. tighten down

STEP 34

Clip back in the sensor at the bottom of the airbox.

STEP 35

Tighten down the hose clamps that are on the scoops.

STEP 36

[Cookie Preferences](#)

Install the tubes into the filter.
Then tighten down the hose
clamps.

STEP 37

Install the JLT filter into the
airbox.

STEP 38

Tighten down the hose
clamps on the couplers.

[Cookie Preferences](#)

STEP 39

Reconnect the MAF harnesses on both sides on the vehicle.

STEP 40

Reconnect the gps antenna.

STEP 41

Reinstall the canister.

STEP 42

Reinstall the coolant tank.

STEP 43

Reinstall the engine cover.

STEP 44

Snap in the JLT clear lid.

STEP 45

Reinstall the trunk cover and carpet.

