

*FREE SHIPPING ON ORDERS OVER \$98 (EXCLUSIONS APPLY)

[SHOP CATEGORIES](#)[WHY S&B](#)[SHOP BY VEHICLE](#)

0

INSTALL INSTRUCTIONS FOR CAI-75-5143

[PRINT](#)

BEFORE YOU START

Note: This intake kit may not fit with the following Aftermarket Parts installed:

- Body Lift or Lowering Kit
- Custom Hood
- Throttle Body Spacer / Upgrade

Please read the entire product guide before proceeding.

- Ensure all parts are present.
- If you are missing any of the components, call our customer support at (909) 947-0015.
- Do not work on your vehicle while the engine is hot.
- Make sure the engine is turned off and the vehicle is in Park or the Parking Brake is set.

REQUIRED TOOLS

- Socket Wrench
- 7mm, 10mm, Socket
- Adjustable Wrench
- Pliers
- 5/16" Socket/Nut Driver
- Panel Popper/Flat Blade Screwdriver



Hi. Need any help?

[Cookie Preferences](#)

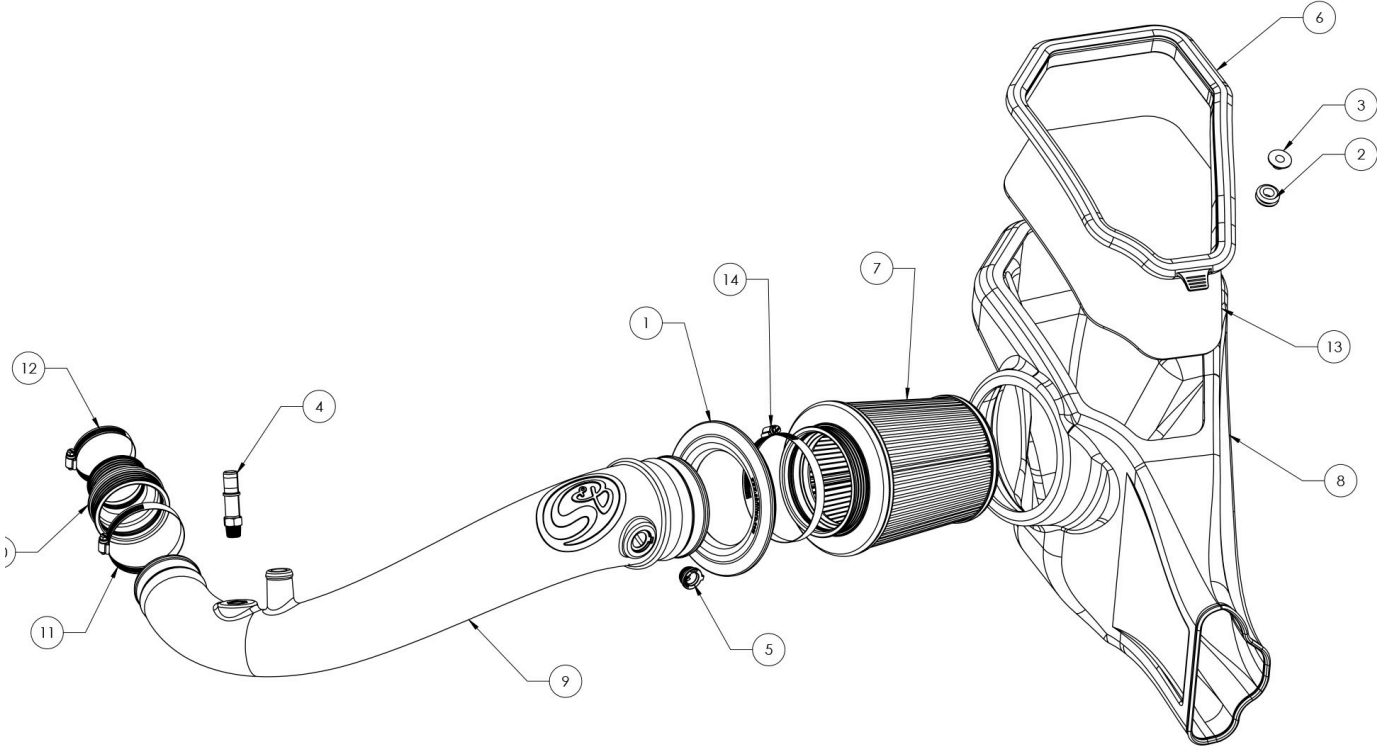

ITEM NO.	PART NUMBER	DESCRIPTION	QTY.	ITEM NO.	PART NUMBER	DESCRIPTION	QTY.
1	AI1650C-00	SILICONE TUBE SEAL	1	8	AL1378B-00	AIR BOX	1
2	AI1563-00	AIR BOX GROMMET	1	9	AL1378-00	INTAKE TUBE	1
3	AI2296-00	MACHINED SHOULDER WASHER	1	10	AI2551C-00	SILICONE COUPLER	1
4	AI1701-00	FITTING, QUICK CONNECT TO 3/8 NPT	1	11	AG1015-00	HOSE CLAMP, #48	1
5	AI1948C-00	SILICONE IAT SENSOR ADAPTER	1	12	AG1004-00	HOSE CLAMP, #36	1
6	AI2552C-00	SILICONE LID SEAL	1	13	AI2553-00	AIR BOX LID	1
7	KF-1057	AIR FILTER	1	14	AG1010-00	HOSE CLAMP, #80	1

STEP 1

Cookie Preferences

Remove the battery cover from the vehicle by removing the twist rivets found in the 3 locations shown. To remove each screw, rotate the heads counter clockwise for a few rotations and then lift up.

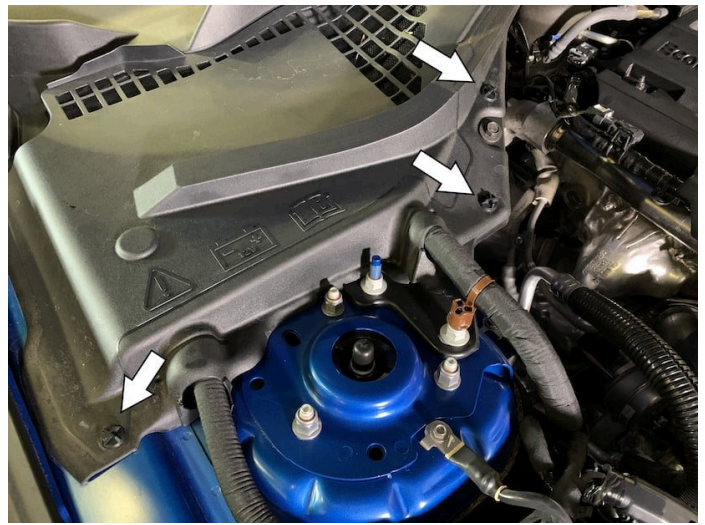

STEP 2

With the ignition switched off and the parking brake set, disconnect the negative battery harness on the battery. The battery must be disconnected for at least 2 hours to ensure proper functionality of the kit during use. Be sure to cover the end of the harness for the rest of the installation process so that it does not touch any part of the vehicle that acts as a ground point.

Note: Failure to disconnect the battery may cause the CEL to illuminate upon completion of the installation and subsequent operation.

Do not skip this step!



STEP 3

Disconnect the turbo bypass hose from the stock intake tube by squeezing the clamp with pliers and pulling up.



STEP 4

Disconnect the PCV quick connect tube from the stock intake tube by pushing the blue tab clockwise and pulling up.

STEP 5 (IMAGE 1)

Loosen the hose clamps connecting the stock intake tube to the turbo and air box.

STEP 5 (IMAGE 2)

STEP 6

Remove the stock intake tube from the vehicle.

STEP 7

Disconnect the harness from the intake air temperature sensor by pushing down on the indicated tab and pulling out.

STEP 8 (IMAGE 1)

Disconnect the IAT harness from the stock air box and tab pictured.

STEP 8 (IMAGE 2)

STEP 9

Remove the screw securing the stock intake box to the vehicle.

STEP 10

Remove the stock intake box from the vehicle by lifting it up and out.

STEP 11

Verify that the grommet pictured did not come out of its hole on the vehicle with the stock intake box. If it did, remove it from the intake box and return it to its hole on the vehicle.

STEP 12

Install the rubber grommet

Cookie Preferences [ulder washer \(3\)](#)

into the hole found on the JLT intake box (8). Then install the silicone tube seal (1) into the hole on the front of the S&B intake box.

STEP 13

Place the JLT intake box into the vehicle, ensuring that the front inlet completely encompasses the front grill air connection and that the prong found on the box seats snugly into the grommet shown in step 11.

STEP 14

Secure the JLT intake box to the vehicle by reinstalling the

Cookie Preferences

oved in step 9.

STEP 15

Install the IAT sensor adapter (5) onto the JLT intake tube.

STEP 16

Install the quick connect fitting (4) onto the JLT intake tube until hand tight, then use a crescent wrench and tighten it another one to two complete turns.

IMPORTANT: Do not over

[Cookie Preferences](#)

**the Quick
Connect Fittings can break**

or the threaded inserts may strip!

STEP 17

Place the large side of the silicone coupler (10) around the small end of the JLT intake tube (9) and secure it with the #52 hose clamp (11). Loosely tighten the #40 hose clamp (12) around the other side of the coupler so that it doesn't fall off.

STEP 18

Install the JLT intake tube into the vehicle, sliding the coupler on to the end of the

turbo, and pushing the large end of the intake tube through the tube seal on the S&B intake box. Then tighten the #40 hose clamp.

STEP 18 (IMAGE 2)

STEP 19

Connect the PCV tube to the quick connect fitting on the JLT intake tube by pressing it down until you hear a click.

STEP 20

Connect the turbo bypass hose to the JLT intake tube by sliding it over the inlet and securing it with the OEM clamp.

STEP 21

Remove the IAT sensor from the stock air box by twisting

lockwise and

pulling out. Install that sensor onto the JLT intake tube by pressing it into the rubber adapter and twisting clockwise until the tab on the sensor passes the locking clip found on the face of the adapter.

STEP 22

Reconnect the IAT sensor harness to the IAT sensor.

STEP 23

Reconnect the IAT sensor harness to the pictured tab with the OEM push in zip tie.

STEP 24

Place the filter (7) in the JLT air box and attach it to the JLT intake tube by sliding its flange around the tube opening and tightening the #80 hose clamp (14) around it.

STEP 25

Peel the protective paper off

of the clear lid (13)

and slide the lid into the silicone snap in lid seal (6).

STEP 26

Snap the lid onto the top of the airbox by pressing down on all of the edges, ensuring that all edges of the lid are securely and completely snapped into place.

STEP 27

Reconnect the negative terminal on the battery.

STEP 28

Reinstall the battery cover
and secure it down with the
twist rivets removed in step 1

STEP 29

Inspect your installation,
make sure the kit is properly
positioned and all fasteners
are secured. JLT recommends
keeping all stock parts in case
you would ever need to
reinstall the stock intake.

Cookie Preferences \ label near the
intake kit.

**The installation is now
complete.**