

*FREE SHIPPING ON ORDERS OVER \$98 (EXCLUSIONS APPLY)



SHOP CATEGORIES

WHY S&B

SHOP BY VEHICLE



0

INSTALL INSTRUCTIONS FOR CAI-75-5142



PRINT

BEFORE YOU START

Note: This intake kit may not fit with the following Aftermarket Parts installed:

- Body Lift or Lowering Kit
- Custom Hood
- Throttle Body Spacer / Upgrade

Please read the entire product guide before proceeding.

- Ensure all parts are present.
- If you are missing any of the components, call our customer support at (909) 947-0015.
- Do not work on your vehicle while the engine is hot.
- Make sure the engine is turned off and the vehicle is in Park or the Parking Brake is set.

REQUIRED TOOLS

- Socket Wrench
- 7mm, 10mm, Socket
- Adjustable Wrench
- Pliers
- Bolt Cutters
- 5/16" Nut Driver & 1/4" Nut Driver or Flat Blade Screwdriver
- T20 Torx
- Phillips Head Screwdriver
- Panel Popper / Flat Blade Screwdriver



Hi. Need any help?

Cookie Preferences



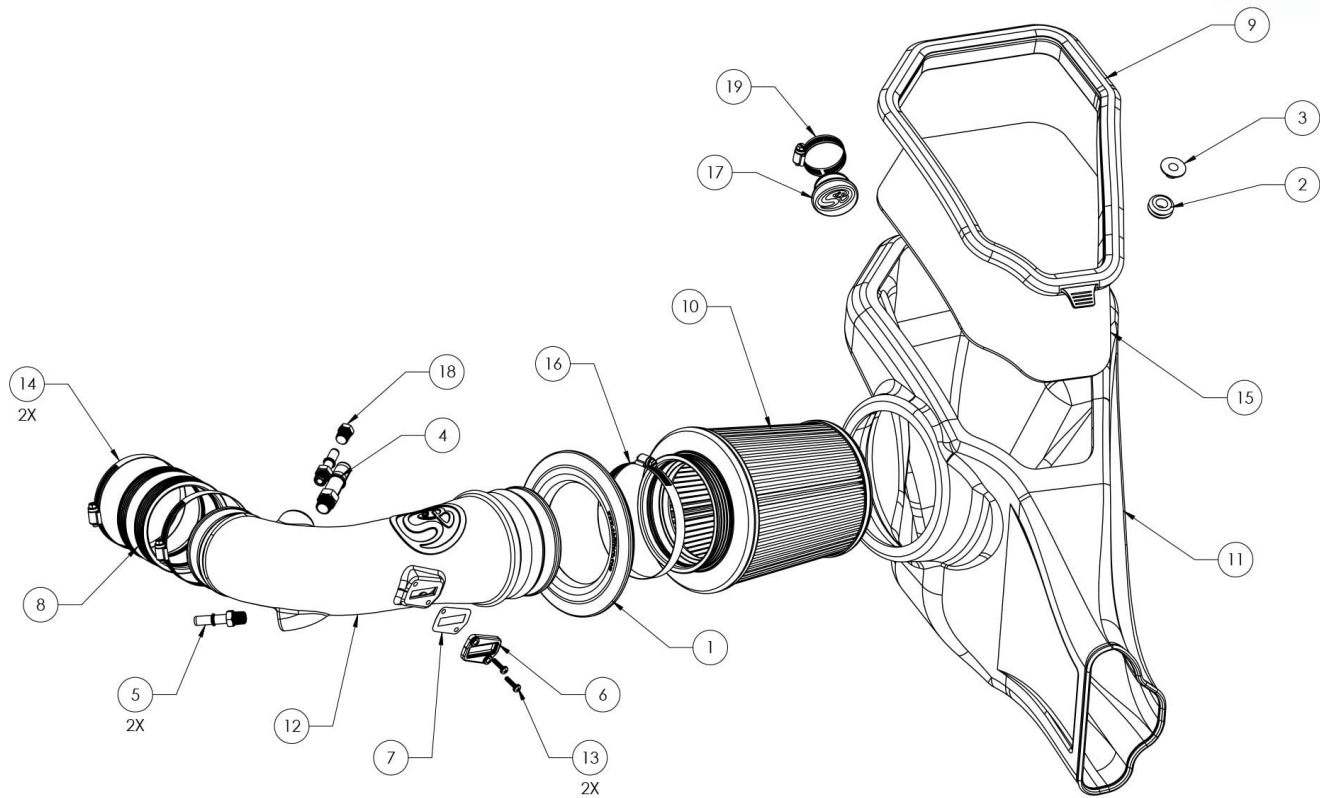

ITEM NO.	PART NUMBER	DESCRIPTION	QTY.	ITEM NO.	PART NUMBER	DESCRIPTION	QTY.
1	AI1650C-00	SILICONE TUBE SEAL	1	11	AL1378B-00	AIR BOX	1
2	AI1563-00	AIR BOX GROMMET	1	12	AL1376-00	INTAKE TUBE	1
3	AI2296-00	MACHINED SHOULDER WASHER	1	13	AI1837-00	8-32 THREAD SIZE, 3/4" LONG SCREW	2
4	AI1701-00	FITTING, QUICK CONNECT TO 3/8 NPT	1	14	AG1008-00	HOSE CLAMP, #60	2
5	AI1776-00	FITTING, QUICK CONNECT TO 1/4 NPT	2	15	AI2553-00	AIR BOX LID	1
6	AI1822-00	MAF ADAPTER PAD	1	16	AG1010-00	HOSE CLAMP, #80	1
7	AI1823-00	MAF PAD GASKET	1	17	AI2554-00	SOUND TUBE DELETE PLUG	1
8	AI1678C-00	SILICONE COUPLER	1	18	AI2587-00	FITTING PLUG	1
9	AI2552C-00	SILICONE LID SEAL	1	19	AG1017-00	Hose Clamp, #24	1
10	KF-1057	AIR FILTER	1				

STEP 1

Cookie Preferences

Remove the battery cover from the vehicle by removing the twist on panel screws in the 3 locations shown. To remove each screw, rotate the heads counter clockwise for a few rotations and then lift up.

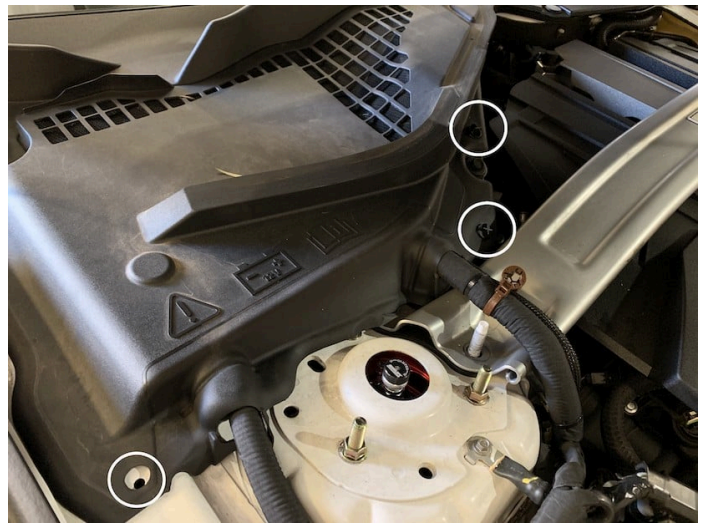

STEP 2

With the ignition switched off and the parking brake set, disconnect the negative battery harness on the battery. The battery must be disconnected for at least 2 hours to ensure proper functionality of the kit during use. Be sure to cover the end of the harness for the rest of the installation process.

Note: Failure to disconnect the battery may cause the CEL to illuminate upon completion of the installation and subsequent operation. Do not skip this step!



STEP 3

Lift up on the engine cover, popping it off of the top of the engine to gain access to the entire intake system.



STEP 4

Pull out and push down on the red locking tab to disconnect the MAF sensor harness from the MAF sensor.

STEP 5

Disconnect the two indicated hoses from the stock intake tube by pushing the black tabs in and pulling out. If you have the 2017 model year,

Cookie Preferences tube will not have

the connection found closer to the engine.

STEP 6

Disconnect the cabin sound tube from the stock intake tube by squeezing the clamp with pliers and pulling out.

STEP 7

Disconnect the PCV hose from the stock intake tube by pushing the black tab in and pulling out.

STEP 8

Loosen the hose clamps found on both ends of the stock intake tube. Remove the tube from the vehicle.

STEP 9

Pop off the MAF harness from it's mounting points on the stock intake box and vehicle frame.

STEP 9 (IMAGE 2)

STEP 10

Remove the screw securing the stock intake box to the vehicle.

STEP 11

Remove the stock intake box from the vehicle by lifting it up and out.

STEP 12

Verify that the grommet pictured did not come out of its hole on the vehicle with the stock intake box. If it did, remove it from the intake box and return it to its hole on the vehicle.

STEP 13

Cut off the crimp-on clamp

Cookie Preferences ne cabin sound

tube. After it has been cut off, remove from the vehicle, the section of the tube which used to connect the stock intake tube to the area where the clamp was found.

STEP 13 (IMAGE2)

STEP 14

Install the S&B block off plug (17) into the rubber cup that makes up the end of the remaining cabin sound tube. Use the #24 hose clamp (19) to secure the plug within the rubber cup. The function of these last steps was to delete the cabin sound tube from the vehicle in the easiest way possible. Doing this provides

for a more genuine intake sound that is not artificially boosted or pumped into the cabin. The removal of the cabin sound tube may not be skipped and is necessary in the installation of the S&B intake kit.

STEP 15

Install the rubber grommet (2) and shoulder washer (3) into the hole found on the JLT intake box.

STEP 16

Place the JLT intake box (11) into the vehicle, ensuring that the front inlet completely encompasses the front grill air connection and that the

Cookie Preferences d on the box seats

snugly into the grommet
shown in step 12.

STEP 17

Secure the JLT intake box to
the vehicle by reinstalling the
screw removed in step 10.

STEP 18

Install the tube seal (1) onto the JLT intake box.

STEP 19

MAF sensor from the stock intake box.

STEP 20 (PART A)

Prepare the JLT intake tube for installation by connecting all of the components shown in the picture to the intake tube. These components include the two ¼ NPT quick connects (5), ⅜ NPT quick connects (5), silicone coupler,

[Cookie Preferences](#)

MAF sensor, MAF sensor pad (6) and MAF sensor gasket (7). Hand tighten quick connect fittings and then use a crescent wrench and tighten it another one to two complete turns. Secure the silicone coupler (8) to the tube using a #60 hose clamp (14) and tighten the other #60 hose clamp around the other end of the coupler so that the hose clamp remains somewhat loose but doesn't fall off. As stated in step 5, if you have the 2017 model year, the stock intake tube will not have one of the quick connections shown. If you have a 2017 model, install the threaded plug (18) in place of the 1/4" NPT quick connect to block off that hole on the JLT intake tube.

IMPORTANT: Do not over tighten the Quick Connect Fittings as they can break or the threaded inserts may strip!

STEP 20 (PART B)

Attach the MAF sensor to the JLT intake tube using the MAF gasket, MAF sensor pad and phillips head

[Cookie Preferences](#)

screws (13). The MAF gasket should be contacting the tube with the adapter, pad followed by the MAF sensor, sitting on top of it.

STEP 21

Install the S&B intake tube (12) into the vehicle in the position shown. Tighten the #60 hose clamp, securing the JLT intake tube to the engine throttle body.

STEP 22

Connect the vacuum hoses to the JLT intake tube, pressing them onto the ¼ NPT quick connects.

STEP 22 (IMAGE 2)

STEP 23

Connect the PCV hose to the JLT intake tube, pressing it onto the $\frac{3}{8}$ NPT quick connect

STEP 24

Reconnect the MAF sensor harness to the MAF sensor by pressing forward on the red locking tab.

STEP 25

Connect the filter (10) to the JLT intake tube by placing it inside of the airbox and

Cookie Preferences [Change](#) over the

end of the tube. Secure the filter to the tube by tightening the #80 hose clamp (16).

STEP 26

Install the lid seal (9) onto the lid (15) by stretching it around the perimeter of the lid. Snap the lid onto the top of the airbox by pressing down on all of the edges, ensuring that all edges of the lid are securely and completely snapped into place.

STEP 27

Cookie Preferences e engine cover by pressing it down into the

correct position on top of the engine.

STEP 28

Reconnect the negative terminal on the battery.

STEP 29

Replace the battery cover by reinstalling the twisting panel screws.

STEP 30

Inspect your installation, make sure the kit is properly positioned and all fasteners are secured. JLT recommends keeping all stock parts in case you would ever need to reinstall the stock intake. Affix the ID label near the intake kit. **The installation is now complete.**

