



INSTALL INSTRUCTIONS FOR 75-5158

[PRINT](#)

BEFORE YOU START

STOP! IMPORTANT INFORMATION

Warning: Failure to disable the Air Filter Life System will cause a warning light that can only be reset by a GM Dealer. Please ensure you have disabled the system prior to driving the vehicle with your new S&B Intake. Please refer to steps 38-42 to cover this procedure.

REQUIRED TOOLS

- 10mm Socket
- T15, T20 Torx Bit
- Pin Removal Tool or Flat Blade Screwdriver
- 5/16" Nut Driver or Flat Blade Screwdriver
- Phillips Screwdriver
- P5/32" or 4mm Allen Wrench
- 1 Pair of Pliers or similar tool

- This intake kit may not fit with the following aftermarket parts installed: Body Lift or Lowering Kit , or a Custom Hood.
- Please read the entire product guide before proceeding.
- Ensure all parts are present.
- If you are missing any of the components, call our customer support at (909) 947-0015.
- Do not work on your vehicle while the engine is hot.
- Make sure the engine is turned off and the vehicle is in Park or the Parking Brake is set.



Hi. Need any help?



Cookie Preferences

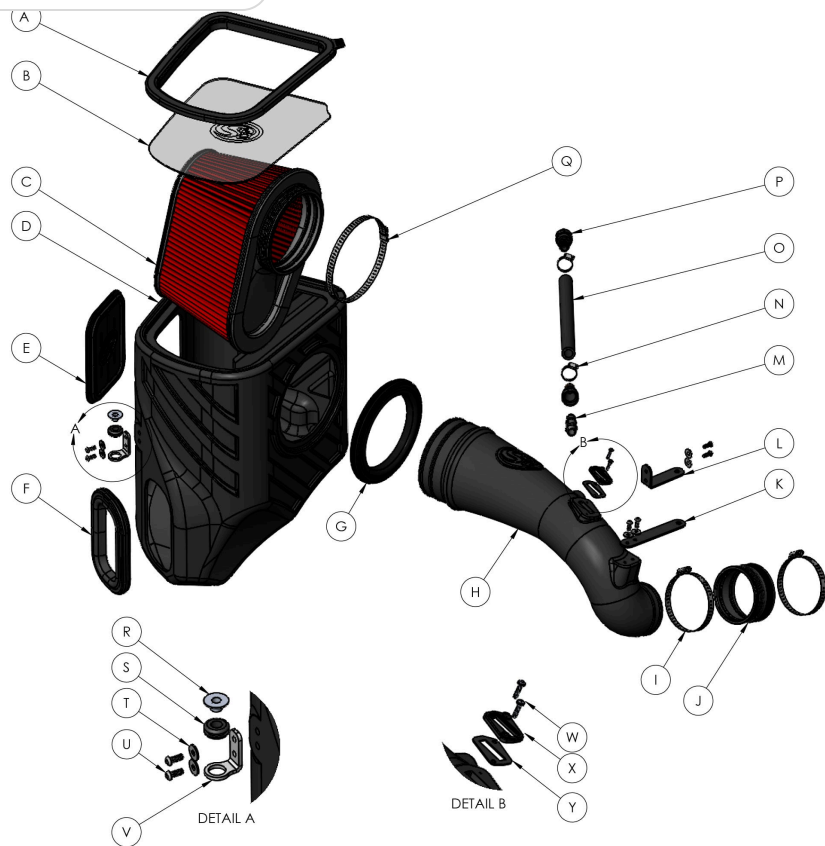

ITEM NO.	PART NUMBER	DESCRIPTION	QTY.
A	AI2634C-00	Snap-In Lid Seal	1
B	AI2635-00	Polycarbonate Lid	1
C	KF-1076	S&B Air Filter	1
D	AL1391B-00	Intake Box	1
E	AI2289C-00	Box Plug	1
F	AI2287C-00	Fender Seal	1
G	AI2470C-00	Tube Seal	1
H	AL1391-00	Intake Tube	1
I	AG1018-00	Hose Clamp, #64	2
J	AI1129C-00	Silicone Coupler	1
K	AI2636-00	mounting bracket #1	1
L	AI2637-00	mounting bracket #2	1
M	AI1701-01	Fitting, Quick Connect to 3/8"NPT	1
N	AG1030-00	Hose Clamp, #12	2
O	AI1039-09	Silicone Hose, 5/8 -14"	1
P	AI2294-00	0.625IN QC Female To 0.625IN Barb, Straight	2
Q	AG1012-00	Hose Clamp, #104	1
R	AI2296-00	Machined Shoulder Washer	1
S	AI1563-00	Air Box Grommet	1
T	AI1755-00	M6 Masher, SS	6
U	AI2190-00	Button Head Hex Drive Screw	6
V	AI2473-00	Box Mounting Bracket	1
W	AI1837-00	8-32 x 3/4" screw	2
X	AI1822-00	Maf Adapter Pad	1
Y	AI1823-00	Maf Gasket	1

STEP 1

Disconnect negative terminal on Battery

IMPORTANT: Failure to disconnect the battery for a minimum of 2 hours may cause the Check Engine Light to illuminate upon completion of the installation or subsequent operation.

[Cookie Preferences](#)**KIP THIS STEP!**

STEP 2

Disconnect Mass Airflow Sensor Harness - Slide red locking tab away from MAF sensor to release.

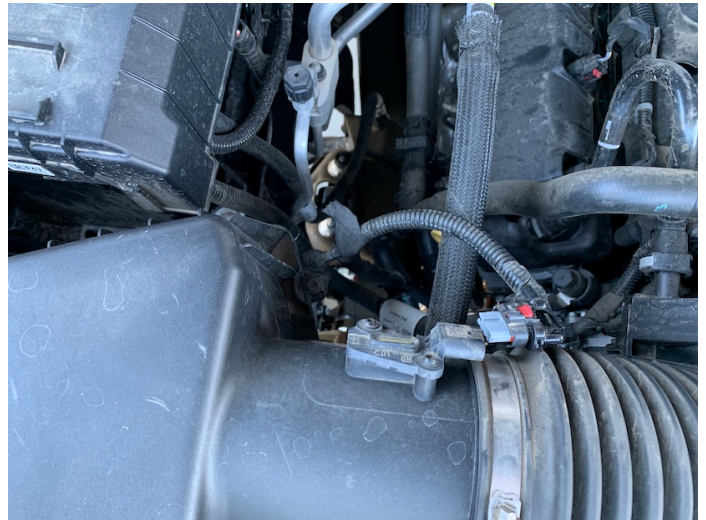

[Cookie Preferences](#)

STEP 3

Remove Hood Latch Handle -
2 Torx screws.

Tool Needed: t15 torx bit

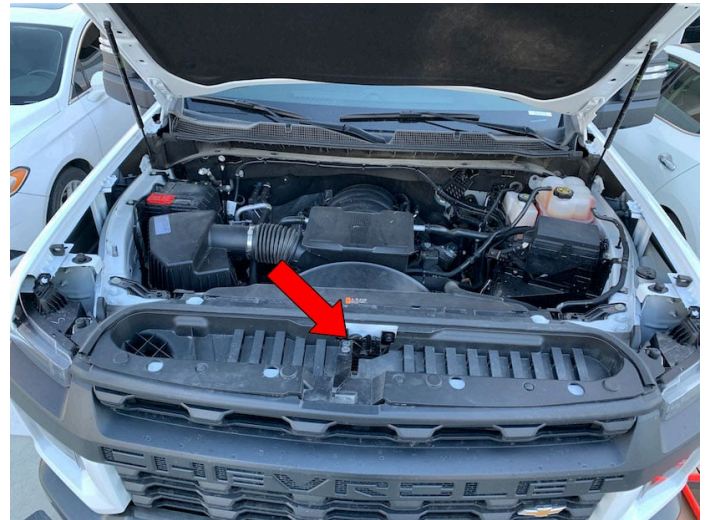

STEP 4

Remove Radiator Cover - Use
a panel popper to remove all
of the push rivets.

Panel Popper

STEP 5

Use a panel popper to
remove the push rivet

[Cookie Preferences](#) he intake duct to
the core support

Tool Needed: Panel removal
popper.

STEP 6

Pull up on the intake duct
until it separates from the
stock airbox.

STEP 7

Remove the 10mm nut that
secures the airbox.

[Cookie Preferences](#)

STEP 8

Loosen the hose clamp that secures the intake box to the factory resonator.

Tool Needed: Flathead screwdriver.

STEP 9

Use a panel popper tool to remove the MAF harness from the airbox.

[Cookie Preferences](#)

STEP 10

Remove the airbox from the vehicle.

STEP 11

Pull upwards on the coolant line to remove it from the resonator.

STEP 12

Loosen the hose clamp at the throttle body.

Note: Flathead screwdriver of 5/16 nutdriver.

[Cookie Preferences](#)

STEP 13

Push down on the gray tab to disconnect the Crank Case Vent line from the resonator.

STEP 14

Remove the tube and resonator assembly from the vehicle. Rotate the assembly 90 degrees and pull towards the passenger side of the vehicle to free it from the mounting bracket.

STEP 15

Remove the Crank Case Vent tube from the vehicle. Push down on the gray tab and pull away from the intake.

[Cookie Preferences](#)

STEP 16

Install the silicone scoop seal and airbox mounting bracket onto the airbox. Use the provided grommet and shoulder washer.

STEP 17

Install the tube seal into the airbox.

STEP 18

(Optional) Install the box plug into the airbox. (We recommend installing the box plug in warmer climates to ensure your vehicle gets the coldest air possible.

STEP 19

Ensure the airbox mounting grommets are in place prior to installing the S&B box. You may need to remove them from the original airbox.

STEP 20

Install the S&B air box into the vehicle. Line the mounting prongs up with the grommets and slide the mounting tab over the stud

Cookie Preferences nt side of the
airbox.

STEP 21

Use a 10mm ratchet to
reinstall the nut on the
mounting bracket.

STEP 22

Install the factory air inlet
scoop into the S&B box.

STEP 23

Reinstall the plastic rivet into the factory air scoop.

STEP 24

Install the CCV quick connect fitting into the tube. Tighten by hand until it is snug and complete one revolution with a wrench. Do not over tighten or this fitting will crack.

STEP 25

Transfer the mass airflow sensor onto the tube. Install the foam MAF gasket between the plastic spacer and the tube itself. Then, use the provided longer phillips screws & washers to reinstall the sensor. Tighten until the

[Cookie Preferences](#) et is compressed to ensure a good seal.

STEP 26

Install the coolant line mounting brackets onto the tube using the 4 allen screws included. The coolant line removed from the resonator will snap into these brackets.

STEP 27

Install the silicone coupler and clamps onto the throttle body. Tighten the throttle body side clamp using a flathead screwdriver or 5/16" nut driver.

STEP 28

Install the air filter into the airbox.

STEP 29

Place the air filter into the airbox, then install the tube into the airbox and coupler on the throttle body. Tighten the hose clamps on the tube and filter using a flathead screwdriver or 5/16" nut driver.

STEP 30

[Cookie Preferences](#)

oolant line into the the mounting brackets. You may need to pop the driver side clip open with a flathead screwdriver in order to slide it over into the proper position to attach to the mounting bracket. Then snap it closed once it is lined up.

STEP 31

Reconnect the mass airflow sensor.

STEP 32

Install the quick connect fittings into the hose and secure with the provided hose clamps. Then, install the hose assembly into the vehicle. You will need to measure and cut the hose to length. Be sure you hear an audible click with both fittings to ensure they are secure.

STEP 33

Reinstall the radiator cover
using the original push rivets.
Reinstall the hood latch
handle with the screws
removed earlier.

STEP 34

Remove the paper backing
from the lid. Be sure to also
remove the paper inside the
S&B logo.

[Cookie Preferences](#)

STEP 35

Install the Snap-In Lid Seal onto the Lid.

STEP 36

Install the Snap-In lid and lid seal into the airbox.

STEP 37

Use a 10mm socket to reconnect the ground.

[Cookie Preferences](#)

STEP 38

To prevent the following message from displaying, the Air Filter Life system will need to be disabled.

STEP 39

Navigate to the Options section of the Driver Information Center, and select the Info Page Options.

STEP 40

Ensure that the Air Filter Life has a green check mark next to it.

STEP 41

Navigate to the Info section of the Driver Information Center, and scroll down to the Air Filter Life section.

Press the wheel in to select the Menu for the Air Filter Life, and select Disable.

STEP 42

The screen should now display “Disabled”, as shown. Please verify the screen still shows disabled after the battery disconnect has been completed. If not, please repeat the process.

You can now move forward with the instructions to finish the installation of your new Cold Air Intake Kit.

STEP 43

The installation is complete. Inspect your installation, make sure the kit is properly positioned and all fasteners and hose clamps are secured. Affix the ID label near the intake kit. If you are an installer, give the owner the QR code for the Installation Instructions so that he/she is aware of the Maintenance and Operation procedures given in the beginning of the Instructions. The Installation is now complete.

Cookie Preferences