

*FREE SHIPPING ON ORDERS OVER \$98 (EXCLUSIONS APPLY)



SHOP CATEGORIES

WHY S&B

SHOP BY VEHICLE



0

INSTALL INSTRUCTIONS FOR 75-5138/75-5138D



PRINT

BEFORE YOU START

VEHICLE FITMENT: 2019-2025, 2.7L Truck/SUV 1500, Chevy/GMC

DEVICE NAME: COLD AIR INTAKE

REQUIRED TOOLS

10mm, 13mm, 3/4 Inch Wrench, T15, T20 Torx Bit, Pin Removal Tool or Flat Blade Screwdriver, 5/16" Nut Driver or Flat Blade Screwdriver, Phillips Screwdriver, P5/32" or 4mm Allen Wrench, 1 Pair of Pliers or similar tool.

Note: Approximate Install Time: 1 hour

STOP! IMPORTANT INFORMATION

Warning: Failure to disable the Air Filter Life System will cause a warning light that can only be reset by a GM Dealer. Please ensure you have disabled the system prior to driving the vehicle with your new S&B Intake. Please refer to steps to cover this procedure or watch the video linked [here](#).

This intake kit may not fit with the following aftermarket parts installed: Body Lift or Lowering Kit, Custom Hood.



Hi. Need any help?

Cookie Preferences



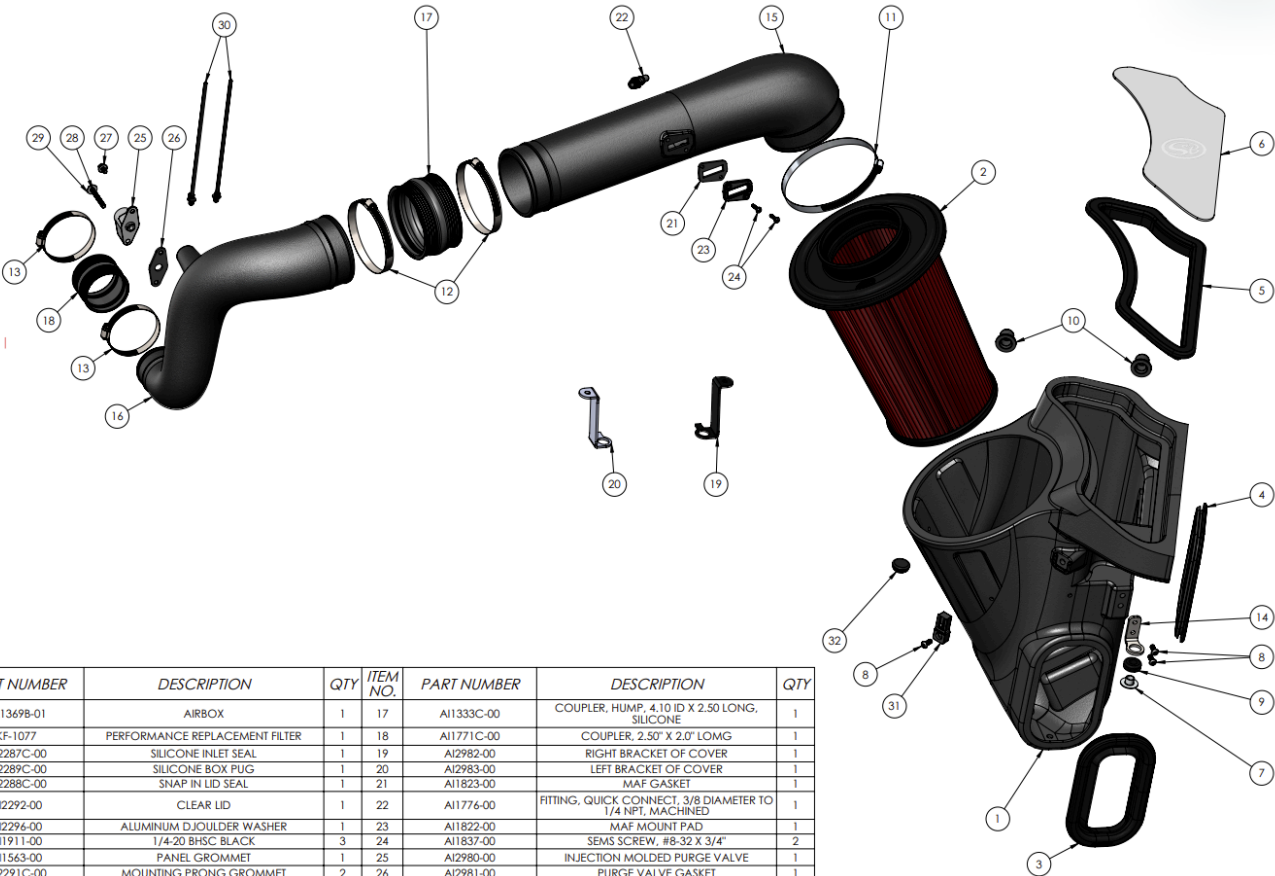

ITEM NO.	PART NUMBER	DESCRIPTION	QTY	ITEM NO.	PART NUMBER	DESCRIPTION	QTY
1	AL1369B-01	AIRBOX	1	17	AI1333C-00	COUPLER, HUMP, 4.10 ID X 2.50 LONG, SILICONE	1
2	KF-1077	PERFORMANCE REPLACEMENT FILTER	1	18	AI1771C-00	COUPLER, 2.50" X 2.0" LOMG	1
3	AI2287C-00	SILICONE INLET SEAL	1	19	AI2982-00	RIGHT BRACKET OF COVER	1
4	AI2289C-00	SILICONE BOX PUG	1	20	AI2983-00	LEFT BRACKET OF COVER	1
5	AI2288C-00	SNAP IN LID SEAL	1	21	AI1823-00	MAF GASKET	1
6	AI2292-00	CLEAR LID	1	22	AI1776-00	FITTING, QUICK CONNECT, 3/8" DIAMETER TO 1/4" NPT, MACHINED	1
7	AI2296-00	ALUMINUM DJOULDER WASHER	1	23	AI1822-00	MAF MOUNT PAD	1
8	AI1911-00	1/4-20 BHSC BLACK	3	24	AI1837-00	SEMS SCREW, #8-32 X 3/4"	2
9	AI1563-00	PANEL GROMMET	1	25	AI2980-00	INJECTION MOLDED PURGE VALVE	1
10	AI2291C-00	MOUNTING PRONG GROMMET	2	26	AI2981-00	PURGE VALVE GASKET	1
11	AG1011-00	HOSE CLAMP, #88	1	27	AI2452-00	HEX FLANGE BOLT, STEEL, ZINC PLTD, CLASS 8.8, DIN6921, M6X1X10MM	1
12	AG1018-00	HOSE CLAMP, #64	2	28	AI3029-00	MEDIUM-STRENGTH CLASS 8.8 STEEL HEX HEAD SCREW	1
13	AG1006-00	HOSE CLAMP, #44	2	29	AI1073-00	WASHER, FLAT, 1/4"	1
14	AI2473-00	BOX MOUNTING BRACKET	1	30	AI2154-00	PUSH IN MOUNT CABLE TIE	2
15	AL1447-00	ROTOMOLDED TUBE FILTER SIDE	1	31	AI2285-00	HARNESS BRACKET	1
16	AL1448-00	ROTOMOLDED TUBE ENGINE SIDE	1	32	AI1705-00	GROMMET / PLUG, CLOSED END, FOR 3/4" HOLE, 1.063"OD	1

STEP 1

Disconnect Battery
Disconnect the negative battery cable by loosening the terminal clamp and removing it from the battery post.

IMPORTANT: Failure to
Cookie Preferences the battery for a

minimum of 2 hours may cause the Check Engine Light to illuminate upon completion of the installation or subsequent operation.

DO NOT SKIP THIS STEP!

Tool Needed: 10mm Wrench or Socket.



STEP 2

Remove hood latch lever.

Tool Needed: T15 torx bit.

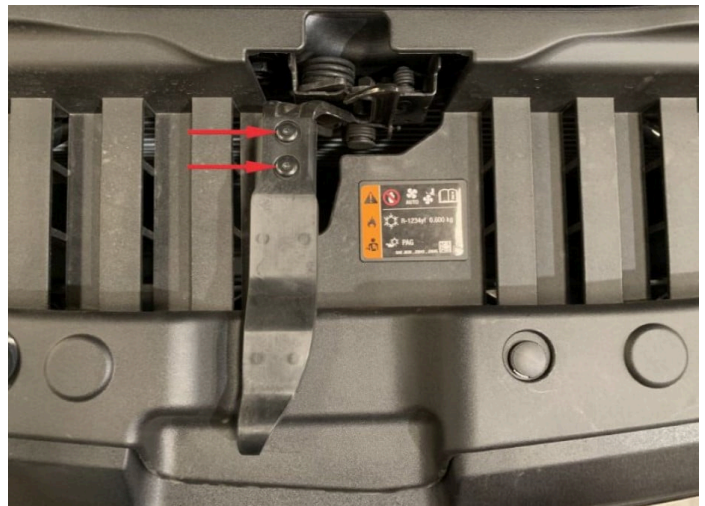

STEP 3

Remove the push clips holding down the large plastic air diverter. Pull out the large plastic air diverter and set aside.

Tool Needed: Panel removal tool or similar.

STEP 4

Remove the push clip holding the top of air inlet tube in place, and set the clip aside, separate from the other clips, as this one is unique.

Tool Needed: Panel removal tool or similar.

STEP 5

Pull the stock air inlet tube up enough that it is no longer connected to the stock airbox, it is not necessary to disconnect the tube to install

[Cookie Preferences](#)

the S&B Filters Cold Air
Intake.

STEP 6

Carefully disconnect the large wire harness at the front of the air intake. The snap feature is designed to release under sufficient upward force; however, pulling and tilting the harness toward the rear of the vehicle will typically help disconnect the harness.

Disconnect the push clip
(wrapped into the harness)
from the stock air intake.

Tool Needed: Panel removal
tool or similar.

STEP 8

Disconnect the MAF Harness.
Pull back on the red tab to
unlock the connector. Press
down on the black tab
directly under the red tab and
pull rearward to disconnect
the connector.

STEP 9

Remove the bolts holding down the engine cover and lift off.

STEP 10

Depress the white button and pull off the PCV connector

STEP 11

Remove the connector attached to the intake tube
ng the white

Cookie Preferences

button and pulling off.
Disconnect the electrical
connector next to the PCV
connector by sliding out the
grey tab and depressing the
button (the electrical
connector is marked by the
blue arrow)

STEP 12

Remove the push pins that
hold the wire harness to the
intake tube.

STEP 13

Remove the bolts holding the intake tube onto of the engine.

STEP 14

With a long extension and 7mm socket, loosen the hose clamp on the turbo.

STEP 15

Loosen the hose clamp on the intake tube and slide off the bellow. Lift the intake tube assembly up and out of the vehicle.

STEP 16

With a 10mm socket, remove the bolt holding down the airbox.

STEP 17

Ensure the front scoop is pulled out of the airbox. Pull the airbox forward to free the prongs on the backside of the airbox then maneuver the airbox out of the engine bay.

STEP 18

With a torx, remove the MAF sensor from the OEM intake tube.

STEP 19

Install the OEM MAF sensor onto the S&B Intake tube with the included MAF gasket, plastic MAF pad and (2) included Phillips head bolts

STEP 20

Remove the OEM purge valve from the OEM intake tube.

STEP 21

Install the S&B gasket & S&B Purge valve adaptor onto the S&B intake tube with included M6 flange bolt

STEP 22

Install the OEM purge valve into the S&B adaptor. Use the included S&B bolt and washing to secure down the valve.

STEP 23

Install the Christmas tree end of the zip ties into the inserts

STEP 24

Install the S&B quick connect fitting into the 1/4" NPT insert. Install by hand, then another half turn with a wrench. This is a NPT fitting so threads will be exposed.

STEP 25

Install the bracket for the electrical connector onto the S&B airbox

STEP 26

Install the box mounting bracket onto the S&B air box.

STEP 27

Install the grommet into the bracket and the S&B shoulder washer into the grommet.

STEP 28

Install the mounting prong grommets. While not required, we recommend installing the screws through the grommets so they don't fall off during the install.

STEP 29

Install the silicone inlet seal into the airbox.

STEP 30

Remove the plastic packaging from the air filter and "snap in" the filter flange to the airbox. See step 31 for a picture of what the filter looks like installed.

STEP 31

Install the airbox. Once the airbox is seated, install the front scoop into the airbox. Use can place your arm inside the front inlet to help push it into the airbox.

STEP 32

Install the electrical harness onto the bracket.

STEP 33

Reinstall the OEM flange nut
and tighten with socket

STEP 34

Use the provide S&B plug to
plug the opening of the box
after the flange nut is tight.

STEP 35

Install the harness Christmas tree into the hole on the airbox.

STEP 36

Remove the plastic from the clear lid. Install the clear lid into the silicone lid seal. Once in the lid seal, snap it into the S&B air box.

STEP 37

Using the OEM flange nuts, install the S&B engine cover brackets.

STEP 38

Install the included silicone coupler directly onto the turbo. Tighten the hose clamp

STEP 39

Place the hose clamp loosely onto the coupler and slide the lower S&B intake tube into the coupler.

STEP 40

Install the upper S&B intake tube loosely into the filter flange and connect the two tubes together with the S&B coupler.

STEP 41

After the tubes are in position, tighten down. Use a long extension to tighten the hose clamp on the coupler attached to the turbo.

STEP 42

Use the MAF extension to reconnect the MAF sensor. Zip tie the excess to the hose next to the intake tube.

STEP 43

Use the zip ties attached to the intake tube to secure the harnesses. Cut off the excess of the zip tie.

STEP 44

Reinstall the PCV connector and electrical connector onto the purge valve.

STEP 45

Install the PCV connector
onto the fitting.

STEP 46

Reinstall the engine cover
with the OEM bolts

STEP 47

Navigate to the "info page options"

STEP 48

Select "disable".

Please affix the included
CARB-approved EO label in
an area under the hood. We
placing it on the
radiator shroud, or the

Cookie Preferences

underside of the vehicle's
hood near the S&B product.

Cookie Preferences