



SHOP CATEGORIES

WHY S&B

SHOP BY VEHICLE



0

INSTALL INSTRUCTIONS FOR 75-5128-1/75-5128-1D



PRINT

BEFORE YOU START

VEHICLE FITMENT: 2019-2024, 5.3L/6.2L Truck/SUV 1500, Chevy/GMC

DEVICE NAME: COLD AIR INTAKE

REQUIRED TOOLS

10mm, 13mm, 3/4 Inch Wrench, T15, T20 Torx Bit, Pin Removal Tool or Flat Blade Screwdriver, 5/16" Nut Driver or Flat Blade Screwdriver, Phillips Screwdriver, P5/32" or 4mm Allen Wrench, 1 Pair of Pliers or similar tool.

Note: Approximate Install Time: 1 hour

STOP! IMPORTANT INFORMATION

Warning: Failure to disable the Air Filter Life System will cause a warning light that can only be reset by a GM Dealer. Please ensure you have disabled the system prior to driving the vehicle with your new S&B Intake. Please refer to steps 42-46 to cover this procedure or watch the video linked [here](#).

This intake kit may not fit with the following aftermarket parts installed: Body Lift or Lowering Kit, Custom Hood.



Hi. Need any help?



Cookie Preferences

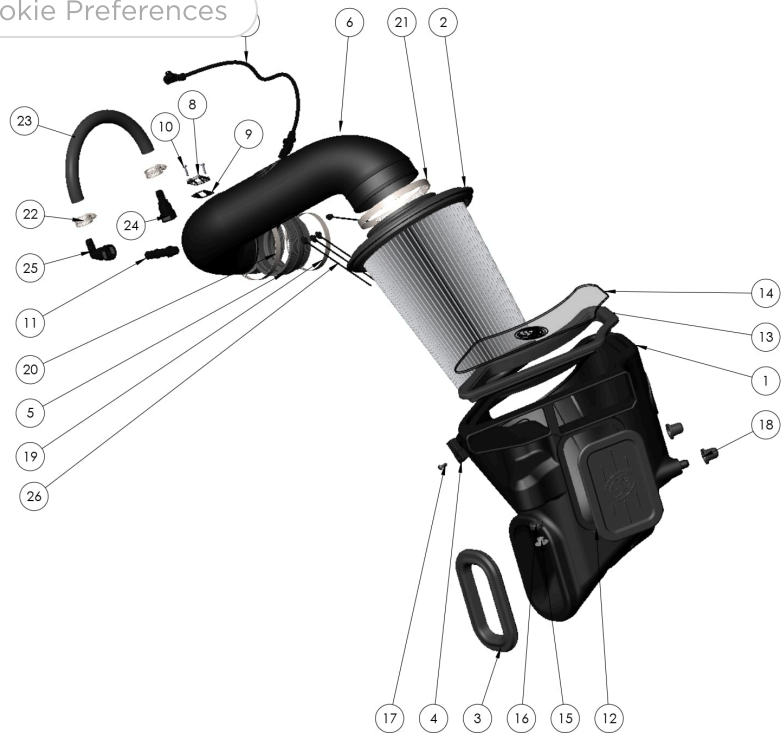

ITEM NO.	PARTNO	DESCRIPTION	QTY.
1	AL1353-01	AIRBOX	1
2	KF-1072	PERFORMANCE FILTER	1
3	AI2287C-00	SILICONE INLET SEAL	1
4	AI2285-00	HARNES BRACKET	1
5	AI1665C-00	SILICONE STEP COUPLER (FOR 5.3L)	1
6	AL1354-01	INTAKE TUBE	1
7	AI2293-00	MAF HARNES EXTENSION	1
8	AI1822-00	MAF MOUNT PAD	1
9	AI1823-00	MAF GASKET	1
10	AI1837-00	SEMS SCREW, 8-32 X 3/4"	2
11	AI1701-00	FITTING, QUICK CONNECT TO 3/8 NPT, NYLON	1
12	AI2289C-00	SILICONE BOX PLUG	1
13	AI2288C-00	SNAP IN LID SEAL	1
14	AI2292-00	CLEAR LID	1
15	AI2296-01	PLASTIC SHOULDER WASHER	1
16	AI1563-00	PANEL GROMMET	1
17	AI1911-00	1/4-20 BHSC BLACK	1
18	AI2291C-00	MOUNTING PRONG GROMMET	2
19	AG1008-00	HOSE CLAMP, #60	1
20	AG-1009-00	HOSE CLAMP, #72	1
21	AG1011-00	HOSE CLAMP, #88	1
22	AG1030-00	HOSE CLAMP #12	2
23	AI1039-09	LOCK ON FUEL HOSE, 14"	1
24	AI2294-00	0.625IN QC FEMALE TO 0.625IN BARB, STRAIGHT	1
25	AI2295-00	0.625IN QC FEMALE TO 0.625IN BARB, RIGHT ANGLE	1
26	AI2154-00	PUSH IN MOUNT CABLE TIE	4

STEP 1

Disconnect Battery
Disconnect the negative battery cable by loosening the terminal clamp and removing it from the battery post.

IMPORTANT: Failure to disconnect the battery for a minimum of 2 hours may cause the Check Engine Light to illuminate upon completion

Cookie Preferences [Installation or subsequent operation.](#)

DO NOT SKIP THIS STEP!

Tool Needed: 10mm Wrench
or Socket.



STEP 2

Remove hood latch lever.

Tool Needed: T15 torx bit.

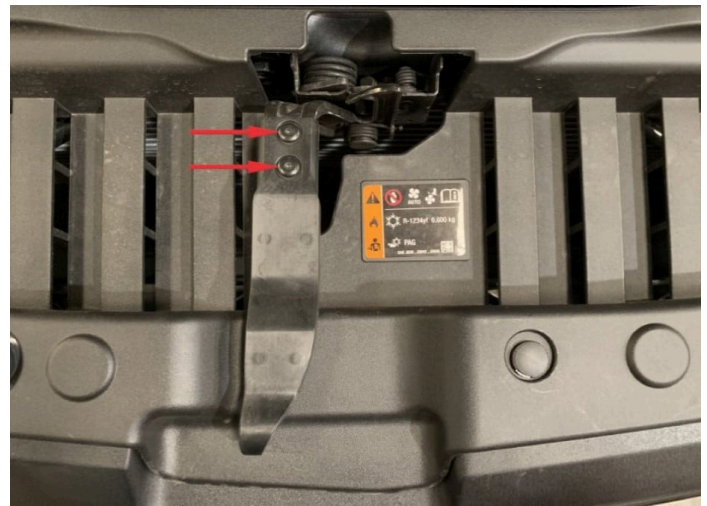

STEP 3

Remove the push clips
holding down the large
plastic air diverter. Remove
the large plastic air diverter
and set aside.

Tool Needed: Panel removal
tool or similar.

STEP 4

Disconnect and remove the support brace.

Tool Needed: 13mm Wrench or Socket.

STEP 5

Remove the push clip holding the top of air inlet tube in place, and set the clip aside, separate from the other clips, as this one is unique.

Tool Needed: Panel removal tool or similar.

STEP 6

[Cookie Preferences](#)

ock air inlet tube up enough that it is no longer connected to the stock airbox, it is not necessary to remove to the tube to install the S&B Filters Cold Air Intake.

STEP 6B

STEP 7

Carefully disconnect the large wire harness at the front of the air intake. The snap feature is designed to release under sufficient upward force; however, pulling and tilting the harness toward the rear of the vehicle will typically help disconnect the harness.

STEP 8

Disconnect the push clip
(wrapped into the harness)
from the stock air intake.

Tool Needed: Panel removal
tool or similar.

STEP 9

Disconnect the MAF Harness.
Pull back on the red tab to
unlock the connector. Press
down on the black tab
directly under the red tab and
pull rearward to disconnect
the connector.

STEP 10

[Cookie Preferences](#)

t the crankcase vent tube at both ends by pressing down on the grey quick disconnect buttons.

STEP 11

Loosen the hose clamp next to the MAF sensor and also the hose clamp on the throttle body.

Tool Needed: 5/16 nut driver or Flat Blade Screwdriver

STEP 12

Remove the stock air intake tube. The stock intake tube is connected to a bracket attached to the alternator. The tube can be removed from the bracket by tilting the tube until it is vertical, then

[Cookie Preferences](#) rd the passenger
side of the vehicle.

Note: Be sure to protect the
throttle body from debris.

STEP 13

Another option is to remove the bracket with the tube by cutting the zip ties attaching the wiring to the bracket and loosening the black screw with a 10mm socket. The bracket can then either be reinstalled or deleted.

STEP 14

Loosen the nut with captive washer holding down the stock airbox. Set aside the nut for reuse.

Cookie Preferences ed: 10mm wrench
or socket.

STEP 15

Remove the stock air box by lifting the front high enough to clear the stud, and pulling the airbox forward, sliding the rear-facing prongs out of the bracket

STEP 16

Find the S&B Air Intake Box (1) and the Silicone Inlet Seal (3). Install the Inlet Seal onto the Airbox.

STEP 17

Attach the Harness Bracket
(4) onto the airbox with the ¼
x 20 Button Head Cap Screw
(17).

Tool Needed: 5/32" or 4mm
Hex Key.

STEP 18

Install the Panel Grommet
(16) into the Airbox. Install
the Machined Aluminum
Shoulder Washer (15) into the
Panel Grommet.

STEP 19

If desired, install the Silicone Box Plug (12) into the side of the airbox. The plug is designed to be able to be inserted from either the interior or exterior of the box; install according to preference.

STEP 19B

STEP 20

Install the Mounting Prong Grommets (18) onto the rear

[Cookie Preferences](#) the Airbox.

STEP 21

Install the Airbox into the vehicle, sliding the prongs into their holes and lowering the box onto the stud. Reinstall the nut with captive washer onto the stud from the inside of the S&B Airbox.

Tool Needed: 10mm wrench or socket, a ratcheting wrench is ideal for this step.

STEP 22

Insert the stock air inlet tube into the Inlet Seal on the S&B Air Box. The stop on the

[Cookie Preferences](#)

inlet tube should be touching the seal when fully inserted. It may be helpful to guide the tube with one hand inside the airbox.

STEP 23

Reattach the unique push clip for the air inlet tube and reinstall the support bracket.

Tool Needed: 13mm Wrench or Socket.

STEP 24

Reinstall the large plastic air diverter and hood latch lever.

Tool Needed: T15 Torx bit.

STEP 25

Attach the large, forward wire harness to the Harness Bracket.

STEP 26A

Insert the push clip into the small hole in the S&B Air Box.

STEP 26B

Attach the Push In Cable Tie (26) into the upper hole in the side of the airbox and loosely secure the stock MAF Harness to keep it away from hot surfaces or moving parts. This tie will be tightened at the end of the installation.

STEP 27

Remove the film from the S&B Clear Lid (14) and S&B Logo.

STEP 28

Attach Snap-In Lid Seal (13)
to the S&B Clear Lid

STEP 29

Install the Snap-In Lid Assembly into the S&B Airbox. The installation is significantly easier if the snap is slid into the curved section and its corners, first, then chase the snap around the profile of the lid, ending on the straight side.

STEP 30

Find the S&B Air Filter (2) and snap the filter into the airbox. Similar to the clear lid, the installation is easiest when the snap is chased

[Cookie Preferences](#)

the perimeter of the filter base, starting with the lowest point of the filter. Attach the #88 Hose Clamp if not already attached.

STEP 31

Remove the MAF sensor from the stock airbox lid.

Tool Needed: T20 Torx bit.

STEP 32

Find the S&B Intake Tube (6) and HP1407. Install the MAF Sensor into the S&B Intake Tube using the MAF Gasket (9), MAF Pad (8), and supplied screws (10). Take care that the MAF pad and sensor are oriented correctly on the MAF boss on the tube.

[Cookie Preferences](#)

Tool Needed: Philips Head
Screwdriver

STEP 33

Screw the Quick Disconnect Adapter (11) into the Intake Tube (6) until hand tight, then use a crescent wrench and tighten it another one to two complete turns. There will likely still be some threads showing after tightening the proper amount. This is normal and will not impact the performance of the intake. Do not tighten more than instructed or the fitting will become cross-threaded.

Tool Needed: 3/4 Inch
Wrench

IMPORTANT: Do not over tighten, as the Quick Connect Fittings can break or the threaded inserts may strip!

STEP 34

Attach the Step Coupler (5) to the S&B Intake Tube using the supplied #72 Hose Clamp (20) and #60 Hose Clamp (19), leave the throttle body side loose for now.

Tool Needed: 5/16 nut driver or similar.

STEP 35

Attach the MAF Harness Extension Cable (8) to the MAF sensor.

STEP 36

[Cookie Preferences](#)

Push-In Cable Tie

(26) into the insert on the back of the intake tube. Loop the cable tie into itself and feed the MAF Harness Extension Cable through it

STEP 37

Install the intake tube into the vehicle, first mounting the coupler onto the throttle body, then swinging the tube down into the filter flange. Tighten all hose clamps.

Tool Needed: 5/16 nut driver or similar.

STEP 38

Connect the MAF Harness Extension Cable to the stock MAF Harness and tighten the Push-In Cable Tie.

STEP 39

Find the Lock on fuel hose
(22) Right Angle Quick
Disconnect (24) Straight
Quick Disconnect (23) and
#12 Hose Clamps (25).
Assemble the parts, as
shown, with the hose arcing
forward and Right Angle
Quick Disconnect pointed
upward. Using this
configuration will prevent the
natural curvature of the hose
from interfering with the
installation.

STEP 40

[Cookie Preferences](#)

Hose Assembly

from Step 39. Install the straight end connector to the engine and right-angle connector to the intake tube

STEP 41

Reconnect the Battery connections. Inspect your installation, ensure the kit is properly positioned and all fasteners are secure.

STEP 42

To prevent the following message from displaying, the Air Filter Life system will need to be disabled. Watch the video linked [here](#) for further instruction if needed.

STEP 43

Navigate to the Options section of the Driver Information Center, and select the Info Page Options.

STEP 44

Ensure that the Air Filter Life has a green check mark next to it.

STEP 45

Navigate to the Info section of the Driver Information Center, and scroll down to the Air Filter Life section. Press the wheel in to select the

Cookie Preferences The Air Filter Life,
and select Disable.

STEP 46

The screen should now display “Disabled”, as shown. The installation is now complete.

CARB EO LABEL

Please affix the included CARB-approved EO label in an area under the hood. We recommend placing it on the radiator shroud, or the underside of the vehicle’s hood near the S&B product.

Cookie Preferences

Cookie Preferences