



# INSTALL INSTRUCTIONS FOR 75-5121

[PRINT](#)

## BEFORE YOU START

### Vehicle Applications:

2018 Jeep Wrangler JL 3.6L, Gas

2018 Jeep Wrangler JK 3.6L, Gas

2019-2024 Jeep Wrangler JL 3.6L, Gas

2020-2024 Jeep Gladiator 3.6L, Gas

Note: This intake kit may not fit with the following  
Aftermarket Parts installed: Body Lift or Lowering Kit,  
Custom Hood, Throttle Body Spacer / Upgrade,  
Aftermarket turbocharger

## REQUIRED TOOLS

- Ratchet/Wrench
- 8mm & 10mm Socket
- Panel Popper
- Crescent Wrench
- Phillips Screwdriver
- Scissors



Hi. Need any help?



Cookie Preferences

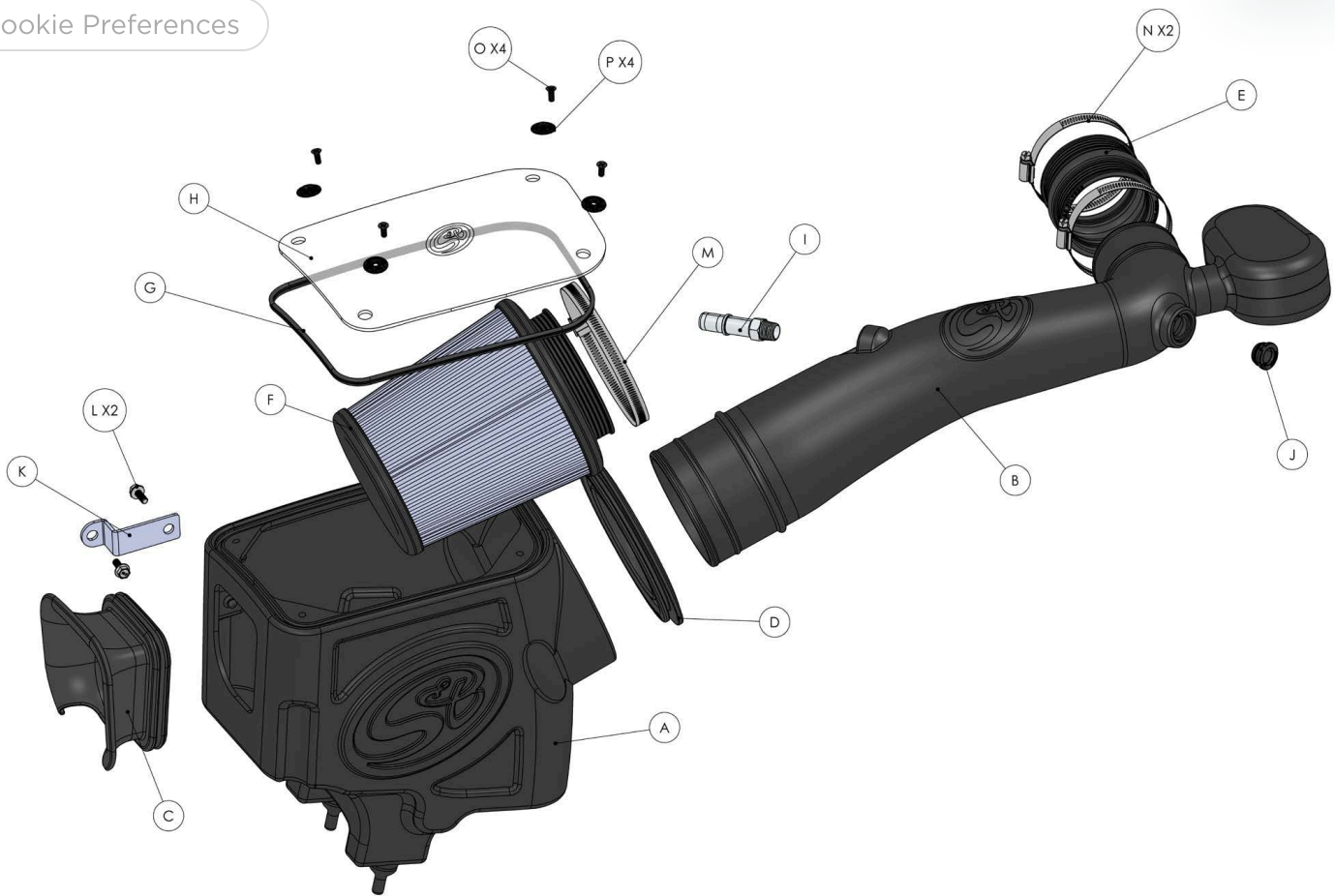

ITEM	QTY	DESCRIPTION	PART NUMBER
A	1	INTAKE BOX	AI1339B-00
B	1	INTAKE TUBE	AI1339-00
C	1	FENDER SEAL	AI2108C-00
D	1	TUBE SEAL	AI1650C-00
E	1	COUPLER	AI1601C-00
F	1	AIR FILTER	KF-1057
G	1	LID SEAL, 31"	AI1766-07
H	1	CLEAR LID	AI2120-00
I	1	QUICK CONNECT, FITTING TO 3/8" NPT	AI1701-00
J	1	IAT SENSOR GROMMET	AI1948C-00
K	1	BRACKET	AI2113-CT
L	2	BOLTS, FLANGE, M6 X16MM	AI2014-00
M	1	HOSE CLAMP #80	AG1010-00
N	2	HOSE CLAMP #56	AG1007-00
O	4	LID SCREW, 10-24	AI2005-00
P	4	LID WASHER, #10	AI2006-00

AMD451-00 REV-C 11/07/2018

HARDWARE PACKS
HP1583-00
AG1007-00
HP1585-00
AI2113-00
AI2014-00
HP1586-00
AI1701-00
AI1948C-00
LHP0004-00
AI2005-00
AI2006-00
HP1584-00
AI2120-00
AI1766-07

## STEP 1

With the ignition switched off and the parking brake set. Disconnect the negative battery cable on the passenger side.

**IMPORTANT:** Failure to disconnect the battery for a minimum of 2 hours may cause the Check Engine Light to illuminate upon completion of the installation or subsequent operation. **DO NOT SKIP THIS STEP!**



## STEP 2

Press down on the plastic clip to disengage the lock on the fitting then pull away to disconnect the CCV hose



## STEP 3

Disconnect the electrical harness from the IAT sensor



## STEP 4

Disconnect the three harness clips attached to the stock intake tube.

[Cookie Preferences](#)

## STEP 5

Remove the two bolts  
securing the stock intake  
tube to the fan shroud.

[Cookie Preferences](#)

## STEP 6

Loosen the hose clamp at the throttle body then pull the intake tube out and away from the throttle body.

## STEP 7

Remove the bolt securing the stock intake box to the fender.

## STEP 8

Lift the stock intake box to unseat the prongs from the grommets then remove the stock intake assembly from the vehicle.

[Cookie Preferences](#)

## STEP 9

Check to make sure the two grommets are still in place.

Adjust and reinstall if necessary.

[Cookie Preferences](#)

## STEP 10

Remove the bolt securing the two battery tray brackets together.

## STEP 11

Install the IAT Sensor Grommet (J) into the Intake Tube (B).

## STEP 12A

Note the position of the IAT sensor on the stock intake tube. Turn the sensor counterclockwise to unlock then pull out.



## STEP 12B

Install the IAT sensor into the Intake Tube (B). Make sure the sensor is installed in the same position as the stock intake tube.

## STEP 13

Install the Quick Connect Fitting (I) into the Intake Tube (B) until hand tight then use a crescent wrench and tighten it another one to two complete turns.

[Cookie Preferences](#)

**NT:** Do not over tighten, as the Quick Connect Fittings can break or the threaded inserts may strip!

## STEP 14

Install the Coupler (E) with the two #56 Hose Clamps (N) onto the Intake Tube (B) then tighten the hose clamp closest to the intake tube. Do not overtighten. Leave the hose clamp for the throttle body loose.

## STEP 15

Install the Tube Seal (D) onto the Intake Box (A).

[Cookie Preferences](#)

## STEP 16

Install the Tube Seal (D) onto the Intake Box (A).

## STEP 17

Install the Lid Seal (G) onto the groove on top of the Intake Box (A). Cut away any excess lid seal.

## STEP 18

Install and tighten the Bracket (K) with the M6 Bolt (L) onto the Intake Box (A). Do not overtighten.

## STEP 19

Align the prongs on the Intake Box (A) with the two grommets then push down on the intake box to fully seat the prongs.

## STEP 20

Align the mounting hole and secure the Bracket (K) to the battery tray bracket with the

[Cookie Preferences](#)

). Position the Fender Seal (C) up against the fender then tighten. Do not overtighten.

## STEP 21A

Install the Intake Tube (B) into the Intake Box (A) first then rotate the intake tube onto the throttle body.

## STEP 21B

Tighten the #56 Hose Clamp (N). Do not overtighten.

## STEP 22

Connect the IAT electrical harness into the IAT sensor

## STEP 23

Connect the CCV hose into the Quick Connect Fitting (I). You should hear a snapping sound when the CCV hose is fully secured

## STEP 24

Install the Air Filter (F) and #80 Hose Clamp (M) onto the Intake Tube (B) then tighten the hose clamp. Do not overtighten.

## STEP 25

Remove the protective covering from the Clear Lid (H)

## STEP 26

Install the Clear Lid (H) onto the Intake Box (A) then install and tighten the Lid Screws and Washer (O & P). Do not overtighten.

## STEP 27

Inspect your installation, make sure the kit is properly positioned and all fasteners are secured. S&B Filter recommends keeping all stock parts in case you would ever need to reinstall the stock intake. Affix the ID label near the intake kit. The installation is now complete.

## CARB EO LABEL

Please affix the included CARB-approved EO label in an area under the hood. We recommend placing it on the radiator shroud, or the underside of the vehicle's hood near the S&B product.



Cookie Preferences