



INSTALL INSTRUCTIONS FOR 75-5101

[PRINT](#)

BEFORE YOU START

- Please read the entire product guide before proceeding.
- Ensure all parts are present.
- If you are missing any of the components, call our customer support at (909) 947-0015.
- Do not work on your vehicle while the engine is hot.
- Make sure the engine is turned off and the vehicle is in Park or the Parking Brake is set.
- Note: This intake kit may not fit with the following Aftermarket Parts installed: Trucks with Remote Start option, Body Lift or Lowering Kit, Custom Hood, Throttle Body Spacer / Upgrade

REQUIRED TOOLS

- 8mm, 10mm Socket and Wrench
- T20 Safety Torx
- 5/16" Nut Driver or Flat Blade Screwdriver
- Phillips Screwdriver



Hi. Need any help?



Cookie Preferences

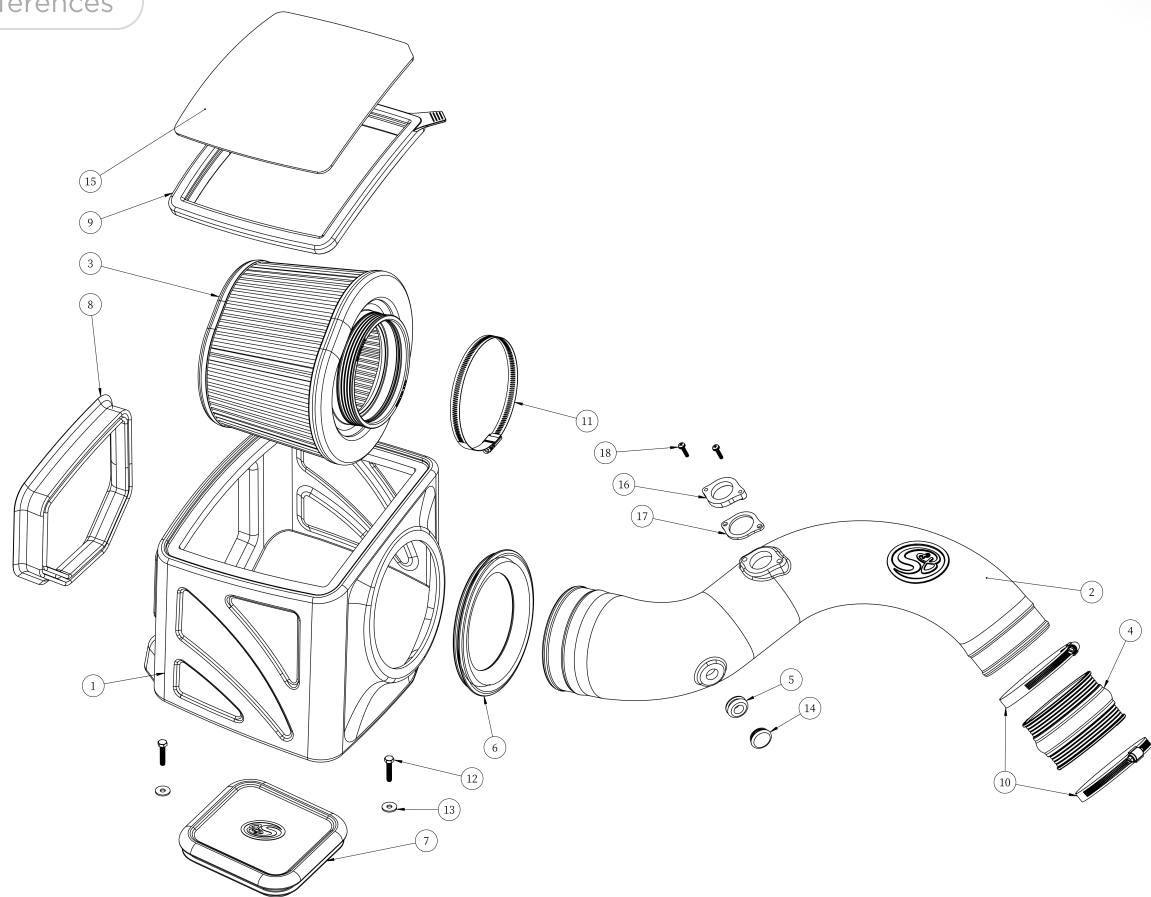

ITEM NO.	PART NUMBER	DESCRIPTION	QTY.
1	AI1241B-01	INTAKE BOX	1
2	AI1284-00	INTAKE TUBE	1
3	KF-1035	AIR FILTER	1
4	AI1321C-00	COUPLER	1
5	AI1563C-00	FILTER MINDER GROMMET	1
6	AI1717C-00	TUBE SEAL	1
7	AI1718C-00	BOX PLUG	1
8	AI1723C-00	FENDER SEAL	1
9	AI2535C-00	SNAP-IN SEAL	1
10	AG1008-00	Hose Clamp, #64	2
11	AG1010-00	HOSECLAMP, #80	1
12	AI1415-00	SCREW, M6 x 1.0 x 25mm Long	2
13	AI1535-00	WASHER, M6	2
14	AI1705-00	FILTER MINDER PLUG	1
15	AI1716-03	CLEAR LID	1
16	AI1722-00	MAF PLATE	1
17	AI1777-00	MAF GASKET	1
18	AI1837-00	SCREW, PHILLIPS, 8-32 X 3/4"	2

STEP 1

[Cookie Preferences](#)

Ignition switched off and the parking brake set, disconnect the negative battery cable on both batteries.

IMPORTANT: Failure to disconnect the battery for a minimum of 2 hours may cause the Check Engine Light to illuminate upon completion of the installation or subsequent operation. **DO NOT SKIP THIS STEP!**



STEP 2

Disconnect the MAF sensor harness.



STEP 3

Remove the stock resonator from the vehicle by loosening the bolt and the hose clamp.

[Cookie Preferences](#)

STEP 4

Remove the stock intake tube from the vehicle. Loosen the hose clamp at the turbo and stock intake box with a 5/16 Nut Driver or Flat Blade Screwdriver.

STEP 5

Remove the stock intake box by lifting up to unseat the two prongs from the airbox tray underneath.

STEP 6

Remove the five screws securing the factory airbox tray with a 10mm Socket or Wrench.

STEP 7

Remove the stock foil from the inner fender. This will allow for additional airflow with our kit.

[Cookie Preferences](#)

STEP 7 (IMAGE 2)

STEP 8

Install the Tube Seal (E) onto the Intake Box (A).

[Cookie Preferences](#)

STEP 9

Install the Fender Seal (F)
onto the Intake Box (A).

STEP 10

Carefully remove the MAF sensor from the stock intake tube with a T20 Safety Torx. Use the provided Foam Gasket (**R**), MAF Plate (**Q**), and 8-32 Screws (**K**) to install the MAF sensor onto the Intake Tube (**H**) with a Screwdriver. The MAF sensor should be installed in the same orientation as shown below.

Note: The MAF connector should be facing the coolant reservoir when installed in the vehicle.

STEP 10 (IMAGE 2)

STEP 11

Decide whether or not you want to reuse the stock filter minder. Insert the Filter Minder Plug (S) into the Air Tube (H) if you decide to leave the stock filter minder out, otherwise, insert the Filter Minder Grommet (P) with the filter minder.

STEP 11 (IMAGE 2)

STEP 12

Slide the Coupler (T) and two #72 Hose Clamps (J) onto the

[Cookie Preferences](#) e (H). Tighten the hose clamp closest to the tube. Leave the other end loose.

STEP 13

Install the Airbox (A) into the vehicle. Secure the airbox using the provided M6 Screws (M) and Washers (N).

STEP 14

Decide to install or leave out the Air Box Plug (G). See “Air Box Plug Testing”

STEP 15

Place the Air Filter into the Air Box with Hose Clamp #80. Do not tighten the hose clamp.

STEP 16

Insert the Air Tube first into the Airbox and then slide the other end of the Coupler onto the turbo mouthpiece. Tighten the #72 Hose Clamp at the turbo.

[Cookie Preferences](#)

STEP 17

Slide the Air Filter onto the Air Tube and tighten the #80 Hose Clamp. Install the Lid Seal into the Air Box grooves.

[Cookie Preferences](#)

STEP 18

Remove the protective covering from the Clear Lid.

STEP 19

Stretch silicone lid seal around the perimeter of the clear lid. It should be a snug fit. The notch on the lid and the tab of the lid seal should mate in the same corner.

STEP 20

Reconnect the MAF sensor harness.

STEP 21

Reconnect the negative terminal on both batteries. Inspect your installation, make sure the kit is properly positioned and all fasteners are secure. Affix the CARB and ID label near the intake kit. The installation is now complete.

Cookie Preferences