



INSTALL INSTRUCTIONS FOR 75-5080

[PRINT](#)

BEFORE YOU START

This intake kit may not fit with the following Aftermarket Parts installed:

Body Lift or Lowering Kit

Custom Hood

Throttle Body Spacer / Upgrade

REQUIRED TOOLS

- 10mm Wrench & Socket
- T-20 Security Torx Wrench (Supplied w/ Kit)
- 9/16" Wrench and Socket
- 5/16" Nut Driver or Flat Blade Screwdriver
- Phillips Screwdriver

- Please read the entire product guide before proceeding.
- Ensure all parts are present.
- If you are missing any of the components, call our customer support at (909) 947-0015.
- Do not work on your vehicle while the engine is hot.
- Make sure the engine is turned off and the vehicle is in Park or the Parking Brake is set.



Hi. Need any help?



Cookie Preferences

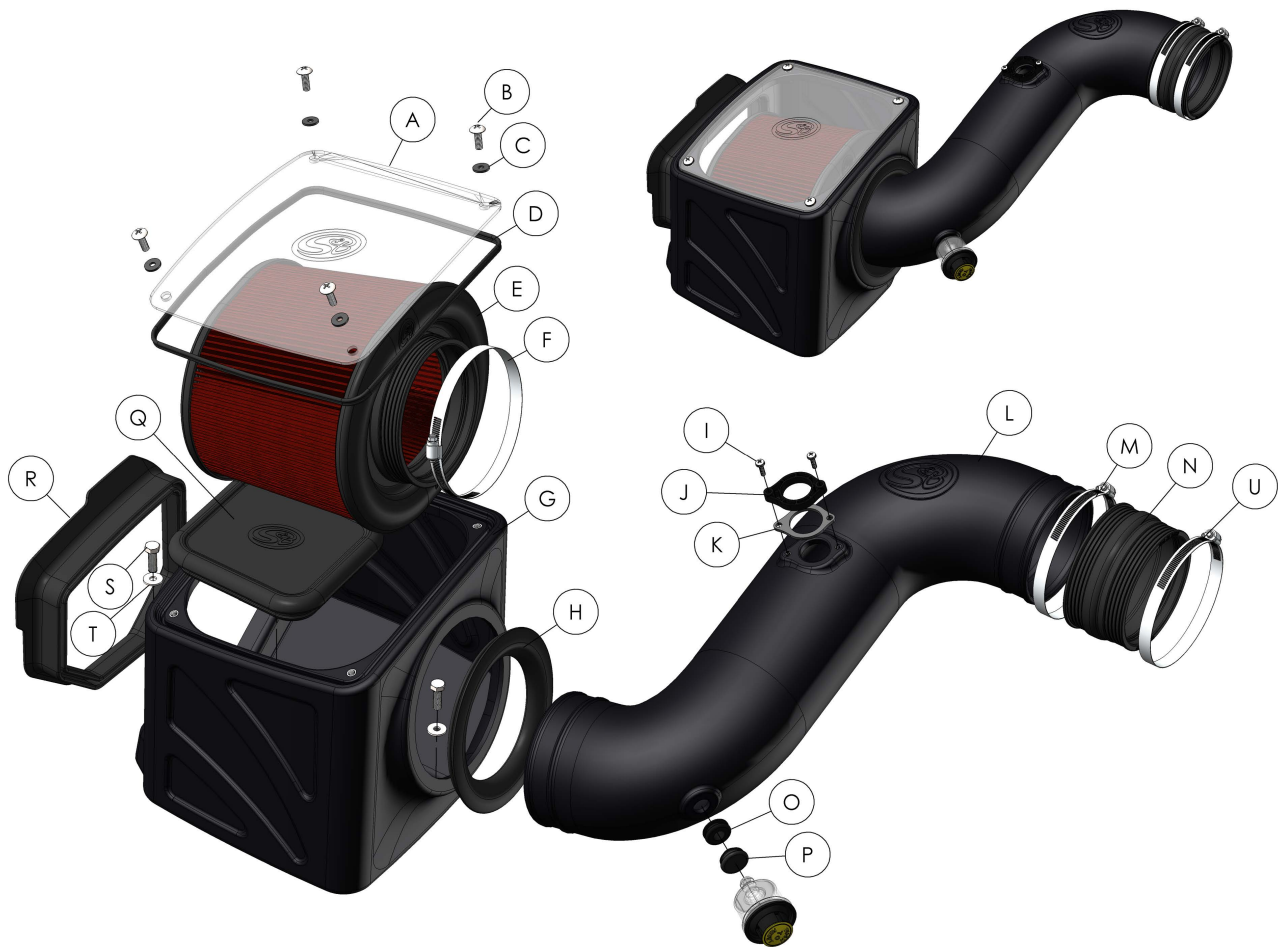

ITEM	QTY.	DESCRIPTION	P/N	ITEM	QTY.	DESCRIPTION	P/N
A	1	CLEAR LID	AI1716-00	O	1	GROMMET	AI1563-00
B	4	SCREW, TRUSS HEAD	AI1684-00	P	1	GROMMET PLUG	AI1705-00
C	4	RUBBER WASHER	AI1571-00	Q	1	BOX PLUG	AI1718C-00
D	1	LID SEAL	AI1766-04	R	1	FENDER SEAL	AI1723C-00
E	1	AIR FILTER	KF-1035	S	2	SCREW, M6	AI1415-00
F	1	HOSE CLAMP, #80	AG1010-00	T	2	WASHER, M6	AI1535-00
G	1	AIR BOX	AL1241B-00	U	1	HOSE CLAMP, #60	AG1008-00
H	1	TUBE SEAL	AI1717C-00				
I	2	SCREW WITH LOCK WASHER	AI1837-00				
J	1	MAF PLATE	AI1722-00				
K	1	FOAM GASKET	AI1777-00				
L	1	AIR TUBE	AL1241-00				
M	2	HOSE CLAMP, #64	AG1018-00				
N	1	COUPLER	AI1337C-00				

STEP 1

With the ignition switched off and the parking brake set, disconnect the negative battery cables on both batteries.

IMPORTANT: Failure to disconnect the battery for a minimum of 2 hours may cause the Check Engine Light to illuminate upon completion of the installation or subsequent operation. DO NOT SKIP THIS STEP!



STEP 2

Disconnect the MAF sensor harness



STEP 3

Loosen both hose clamps and remove the stock intake tube from the vehicle.



STEP 4

Pull up on the stock airbox to release the prongs from the two rubber grommets on the stock airbox tray.

STEP 5

Remove the five bolts on the stock airbox tray and remove the tray from the vehicle. Be sure to save the speed clips underneath. They will be

[Cookie Preferences](#)

to install the Airbox
(G) in Step 9.

STEP 6

Remove the plastic shield
from behind the headlight by
prying the tabs loose.

STEP 7

Insert the Fender Seal (R) onto the Airbox (G).

STEP 8

Insert the Tube Seal (H) onto the Airbox (G).

STEP 9

Install the Airbox (G) into the truck. Use the provided Screw and Washer (S & T) to secure the airbox to the truck.

STEP 10

Determine whether or not you want to install the Box Plug (Q).

STEP 11

Remove the sensor from the stock intake tube. Use the provided Foam Gasket (K), MAF Plate (J), and Screws (I) with Lock Washer to install the MAF sensor into the Air Tube (L). The MAF sensor should be installed in the same orientation as shown below.

Note: The MAF connector should be facing the coolant reservoir when installed in the vehicle.

STEP 12

Insert the provided Grommet (P) into the Air Tube (L) if your vehicle came with a Filter Minder.

STEP 13

Insert the filter minder into the grommet.

STEP 14

If you decide you do not want to reuse the filter minder, use

[Cookie Preferences](#)

mmet Plug (P) that
was provided instead.

STEP 15

Insert the Air Filter (E) into
the Airbox (G)

STEP 16

Slide the Coupler (N) and two
#72 Hose Clamp (M) onto the
Air Tube (L). Tighten the hose
clamp closest to the tube.
Leave the other end loose.

STEP 17

Insert the Air Tube (L) first into the Airbox (G) and then slide the other end of the Coupler (N) onto the turbo mouthpiece. Tighten the #72 Hose Clamp (M).

STEP 17 (IMAGE 2)

STEP 18

[Cookie Preferences](#)

the Air Filter (E) onto
the Air Tube (L) and tighten
the #80 Hose Clamp (F).

STOP! READ THIS BEFORE CONTINUING THE INSTALL

If your kit came with our new
snap-in lid design, please
proceed to **STEP 22** to install
your snap-in lid. If your lid is
the traditional screw in lid,
please proceed to the next
step.

STEP 19

Press the Edge Trim Seal (D)
into the grooves on the

[Cookie Preferences](#) (G).

STEP 20

Remove the protective covering from the Clear Lid (A).

STEP 21

Place the Clear Lid (A) on top of the Airbox (G) and secure the lid using the four provided Screw (B) and Washer (C).

Go To Step 25

[Cookie Preferences](#)

STEP 22

For Snap-In Lids Only

Remove the protective
covering from the Clear Lid.

STEP 23

For Snap-In Lids Only

Stretch silicone lid seal
around the perimeter of the

[Cookie Preferences](#)

d. It should be a snug
fit.

STEP 24

For Snap-In Lids Only

The notch on the lid and the
tab of the lid seal should
mate in the same corner.

STEP 25

Reconnect the MAF sensor harness.

STEP 26

Reconnect the negative terminal on the battery. Inspect your installation, make sure the kit is properly positioned and all fasteners are secure. The installation is now complete.

Cookie Preferences