



SHOP CATEGORIES

WHY S&amp;B

SHOP BY VEHICLE



0

# INSTALL INSTRUCTIONS FOR 75-5067



PRINT

## BEFORE YOU START

- 8mm, 10mm, 13mm Wrench & Socket
- Pin Removal Tool or Flat Blade Screwdriver
- 7/16" Wrench and Socket
- 5/16" Nut Driver or Flat Blade Screwdriver
- Phillips Screwdriver
- 1 Set of Torx Wrenches & Allen Wrenches
- 1 Pair of Pliers or similar tool
- Note: This intake kit may not fit with the following  
Aftermarket Parts installed: Body Lift or Lowering Kit,  
Custom Hood

## REQUIRED TOOLS

- 8mm, 10mm, 13mm Wrench & Socket
- Pin Removal Tool or Flat Blade Screwdriver
- 7/16" Wrench and Socket
- 5/16" Nut Driver or Flat Blade Screwdriver
- Phillips Screwdriver
- 1 Set of Torx Wrenches & Allen Wrenches
- 1 Pair of Pliers or similar tool



Hi. Need any help?

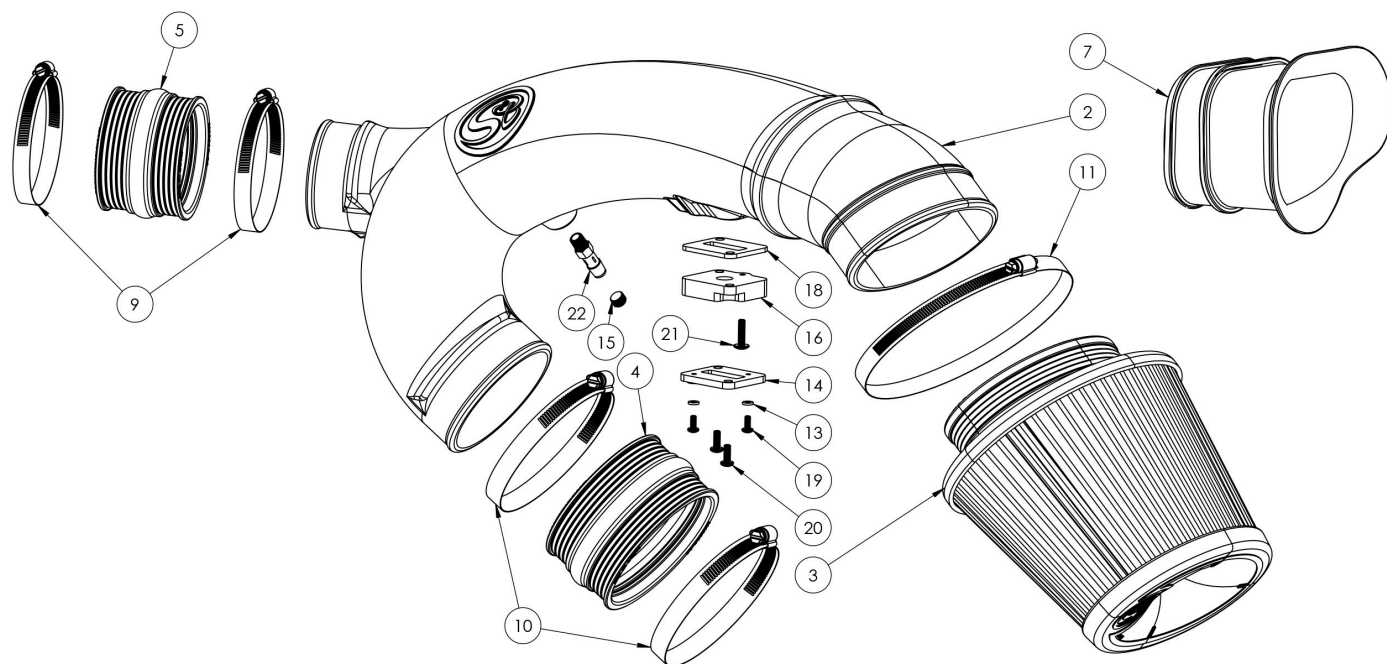

[Cookie Preferences](#)

ITEM NO.	PART NUMBER	DESCRIPTION	QTY.
1	AL1217-01	AIR BOX COVER	1
2	AL1216-00	INTAKE TUBE	1
3	KF-1058	AIR FILTER	1
4	AI1333C-00	HUMP COUPLER	1
5	AI1601C-00	COUPLER	1
6	AI1604C-00	RUBBER CUFF	1
7	AI1635C-00	FERNDER INLET	1
8	AI2537C-00	SNAP-IN LID SEAL	1
9	AG1007-00	HOSE CLAMP, #52	2
10	AG1009-00	HOSE CLAMP, #72	2
11	AG1011-00	HOSE CLAMP, #88	1
12	AG1012-00	HOSE CLAMP, #104	1
13	AI1200-00	RUBBER WASHER	2
14	AI1209-01	ADAPTER PLATE (EARLY MODELS)	1
15	AI1398-00	1/8" NPT HEX SOCKET PLUG	1
16	AI1605-00	ADAPTER PLATE (LATE MODELS)	1
17	AI1607-00	CLEAR LID	1

Cookie Preferences

	Part Number	Description	Quantity
18	AI1637-00	ADAPTER PLATE GASKET	1
19	AI1639-00	SCREW, #8-32 X 3/8"	2
20	AI1640-00	SCREW, 10-32 X 1/2"	2
21	AI1641-00	SCREW, 10-32 X 3/4"	1
22	AI1643-00	HOSE BARB 3/8" X 1/8"NPT	1

STEP 1

With the ignition switched off and the parking brake set, disconnect the negative battery cable on the passenger side.

IMPORTANT: Failure to disconnect the battery for a minimum of 2 hours may cause the Check Engine Light to illuminate upon completion of the installation or subsequent operation. DO NOT SKIP THIS STEP!



STEP 2

This vehicle is equipped with one of two different sensors

[Cookie Preferences](#) ling on which year  
your vehicle is.

### Older Models 2011

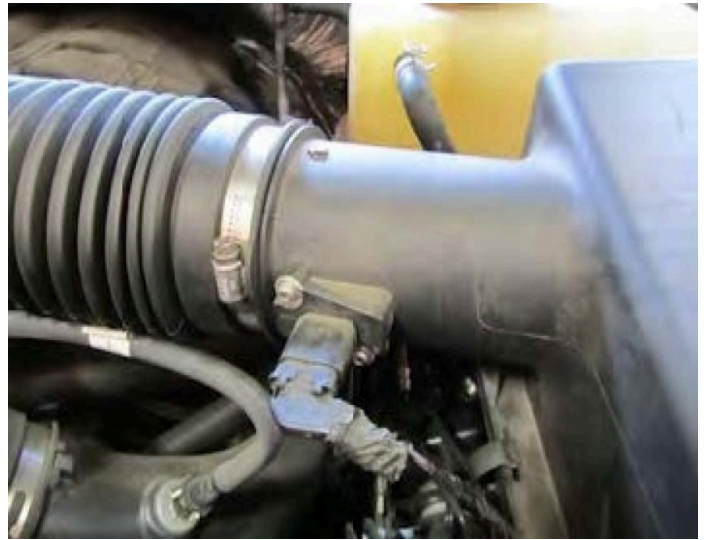

## STEP 2 (IMAGE 2)

### Newer Models 2012-14



## STEP 3

The sensor must be removed  
from the factory intake tube.

-The sensor for the older  
vehicles requires a Torx  
wrench to remove the sensor  
from the tube.

## STEP 3 (IMAGE 2)

-On newer vehicles use a pair of pliers or female Torx to unscrew the bolt and remove the sensor from the tube.

## STEP 3 (IMAGE 3)

-Be careful about the removal of the sensor to not damage the wiring connections on the harness.

## STEP 4

[Cookie Preferences](#)

When the sensor is removed from the tube it must be removed from the harness also.

**(Older Vehicle Sensor)** pull the **Red** tab out and press down on the release button while pulling out.

## STEP 4 (IMAGE 2)

**(Newer Vehicle Sensor)** press down on the release button and pull out to remove the sensor from the connector and harness.

## STEP 5

With the sensor removed loosen all three hose clamps that are on the factory intake tube.

## STEP 6

Remove the top tube by pulling out and away from the factory airbox.

## STEP 7

Pull the rest of the factory intake tube out by moving it to the side and lifting up.

**Note:** on some vehicles, there is a hose from the crankcase that also must be removed.

## STEP 8

Remove the factory airbox cover by disconnecting the three metal latches that are on the side of the factory airbox.

## STEP 9

Once all three latches are disconnected lift the cover-up and out to the side to remove.



## STEP 10

Remove the factory air filter.

## STEP 11

Remove the factory airbox by removing both bolts and lifting up on the box. The other connections to the box do not need to be removed to gain access to the side inlet.

## STEP 12

Once access is available to the side inlet remove by pushing down on the tabs. A screwdriver may be required to loosen the 2 tabs on top and 1 tab underneath.

## STEP 13

Install the S&B fender Inlet (X) by pushing in firmly, wait until it snaps into place.

## STEP 14

[Cookie Preferences](#)

ne S&B inlet is installed, lower the factory airbox back down and reinstall the factory bolts. Make sure the S&B inlet (X) is pushed through the side skirt.

## STEP 15

Attach coupler (T) to intake tube (C) using hose clamps (L). Only tighten the hose clamp on the S&B intake tube side while leaving the other hose clamp loose.

## STEP 16

Attach coupler (S) to intake tube (C) using hose clamps (M). Again only tighten the hose clamp on the tube side

[Cookie Preferences](#) leaving the other hose  
clamp loose.

## STEP 17

Attach the hose clamp (O) to  
the intake rubber cuff (R).

## STEP 18

Install the cuff (R) onto the  
S&B airbox cover (B) making  
sure that the tab on the cuff  
aligns with the notch on the  
S&B Airbox Cover.

## STEP 19

Insert the intake tube assembly into the cuff. Please make sure that the tube is pushed all the way to the stop hump of the tube. This will not be an air tight fit to allow for engine movement.

## STEP 20

Once the tube is pushed flush against the stop hump of the tube the hose clamp (○) on the cuff can be tightened down.

## STEP 21

Flip over the assembly and install the S&B air filter (Q) and tighten the hose clamp (N). Position the clamp so that it can be accessed through the lid in the future.

## STEP 22

Once the filter is installed, use the correct adapter plate for the correct model year.

-Early Models (U) 2011

-Newer Models (V) 2012-14

## STEP 23

[Cookie Preferences](#)

the adapter plate (U) or (V) and gasket (W) using the two 10-32 screws (G). Please make sure that the arrows are aligned to ensure proper installation.

## STEP 24

Once the adapter plate is connected install the factory sensor to the plate using the provided hardware (J) or (H & I).

## STEP 25

**Note:** Check to see if your vehicle has a hose connected to the crankcase from the intake tube. If so connect the Hose Barb (D) to the crankcase inlet on the S&B intake tube. If not install the

[Cookie Preferences](#)

ing Socket (K) into the crankcase inlet using the correct Allen wrench (use Teflon tape around whichever fitting is used).

## STEP 25 (IMAGE 2)

## STEP 26

The S&B intake is now ready for installation.



## STEP 27

Place the whole intake assembly and lower it down into the stock intake box. Please make sure that the tabs on the S&B airbox cover fit correctly into slots on the factory box on the right-hand side. Once the tabs are in the slots lower the whole intake assembly into place.

## STEP 27 (IMAGE 2)

## STEP 28

[Cookie Preferences](#)

the complete assembly and make sure the S&B Airbox Cover (B) sits inside the factory airbox slots. Proper installation into the slots will reduce movement.

## STEP 29

Attach the bottom tube to the bottom turbo inlet and push in completely. After the tube is pushed in all the way tighten the hose clamp.

## STEP 30

Attach the top turbo inlet tube completely and again tighten the hose clamp.

## STEP 31

After all the hose clamps are tightened remember to reconnect the three latches on the side of the intake box.

## STEP 32

Plug the harness into the sensor under the intake tube. Press in firmly till it locks.

**Note:** older vehicles must also press in the **Red** lock tab after

## STEP 33

**Note:** if your vehicle has a hose that connects from the intake tube to the crankcase remember to connect the hose firmly to the S&B hose fitting (D).

## STEP 34

Fasten the airbox lid (P) using the provided hardware (E & F).

## STEP 35

Reconnect the battery.  
Inspect your installation,  
make sure the kit is properly  
positioned and all fasteners  
are secure.

## STEP 36

Affix the CARB and ID label  
near the intake kit. Keep all  
stock parts in case you would  
ever need to reinstall the  
stock intake. The installation  
is now complete.

Cookie Preferences