

- Do not discard packaging until product has been successfully installed.
- When installing components, keep hardware snug; not tight.
- Passenger side shown in installation illustrations.

Item	Description
A	Left Front
B	Right Front
C	Left Rear Fixed
D	Right Rear Fixed
E	Left
F	Right



Clamp x 6

(remove Covers and hardware from Clamps)

90° Seal

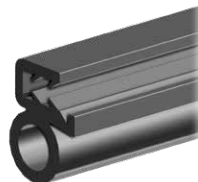

U-Seal



Seal

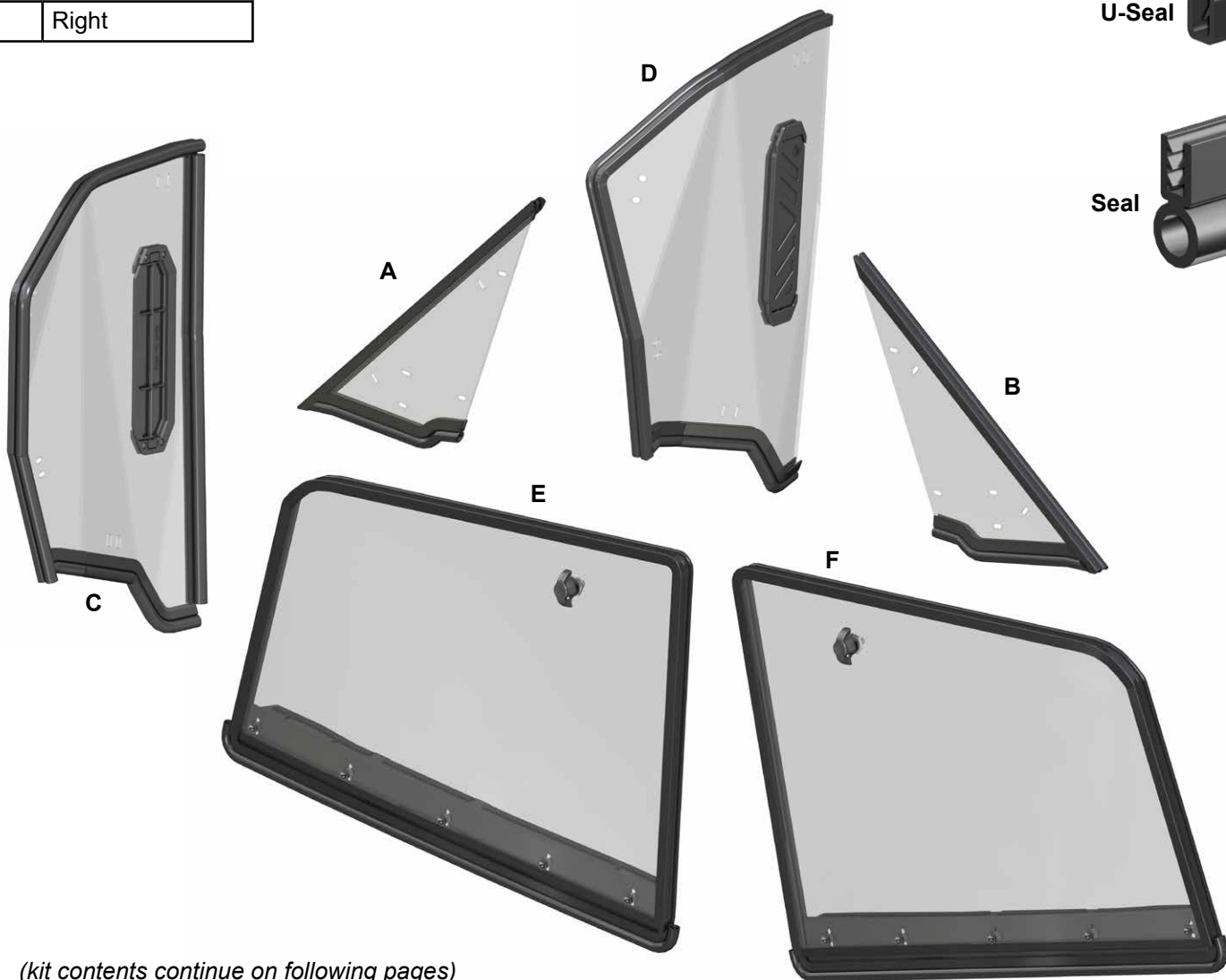

(kit contents continue on following pages)

Need help with your installation?



sales@superatv.com



www.superatv.com



1-855-743-3427



8:00am - 8:00pm EST M-Th
8:00am - 7:00pm EST Friday
9:00am - 2:00pm EST Saturday

Read instructions and view illustrations before beginning.

*Thank You
For Choosing*

SUPERATV.COM[®]

(kit contents continued)

Item	Description
QQ	Left Middle
RR	Left Rear
SS	Right Middle
TT	Right Rear

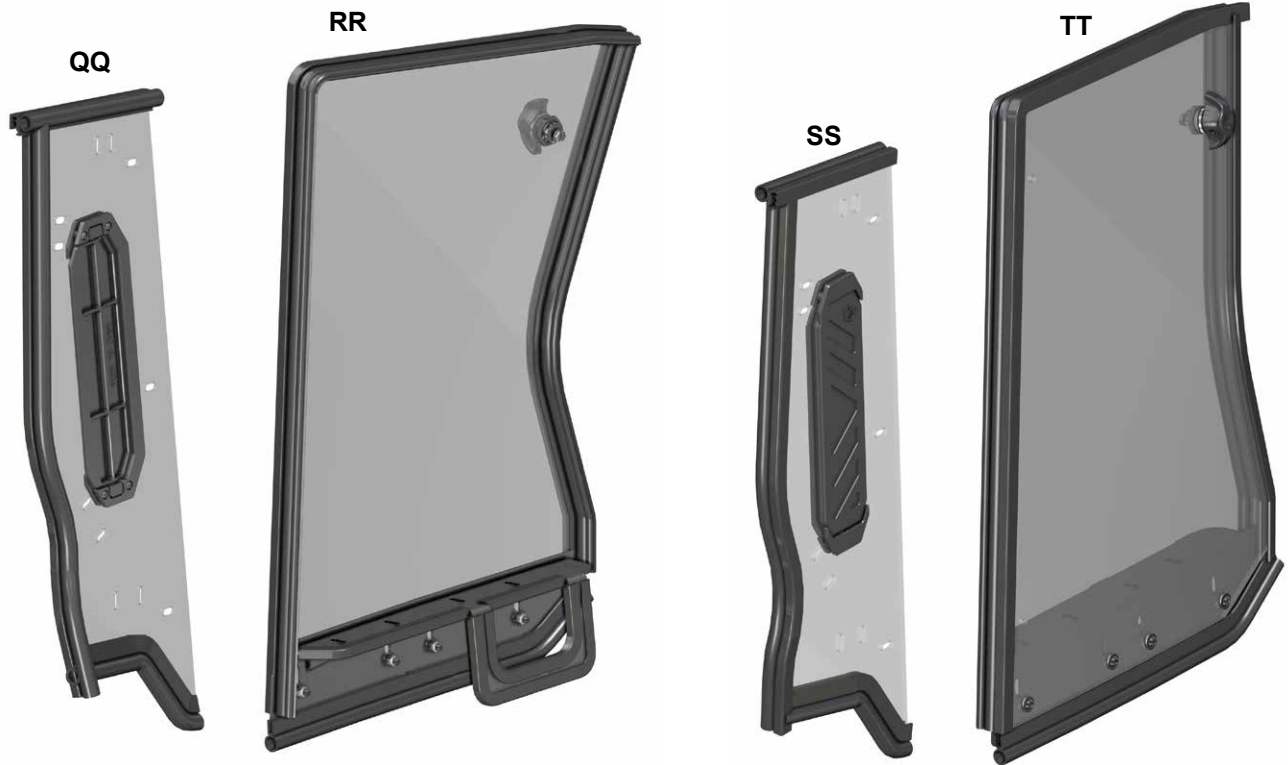

(kit contents continued)

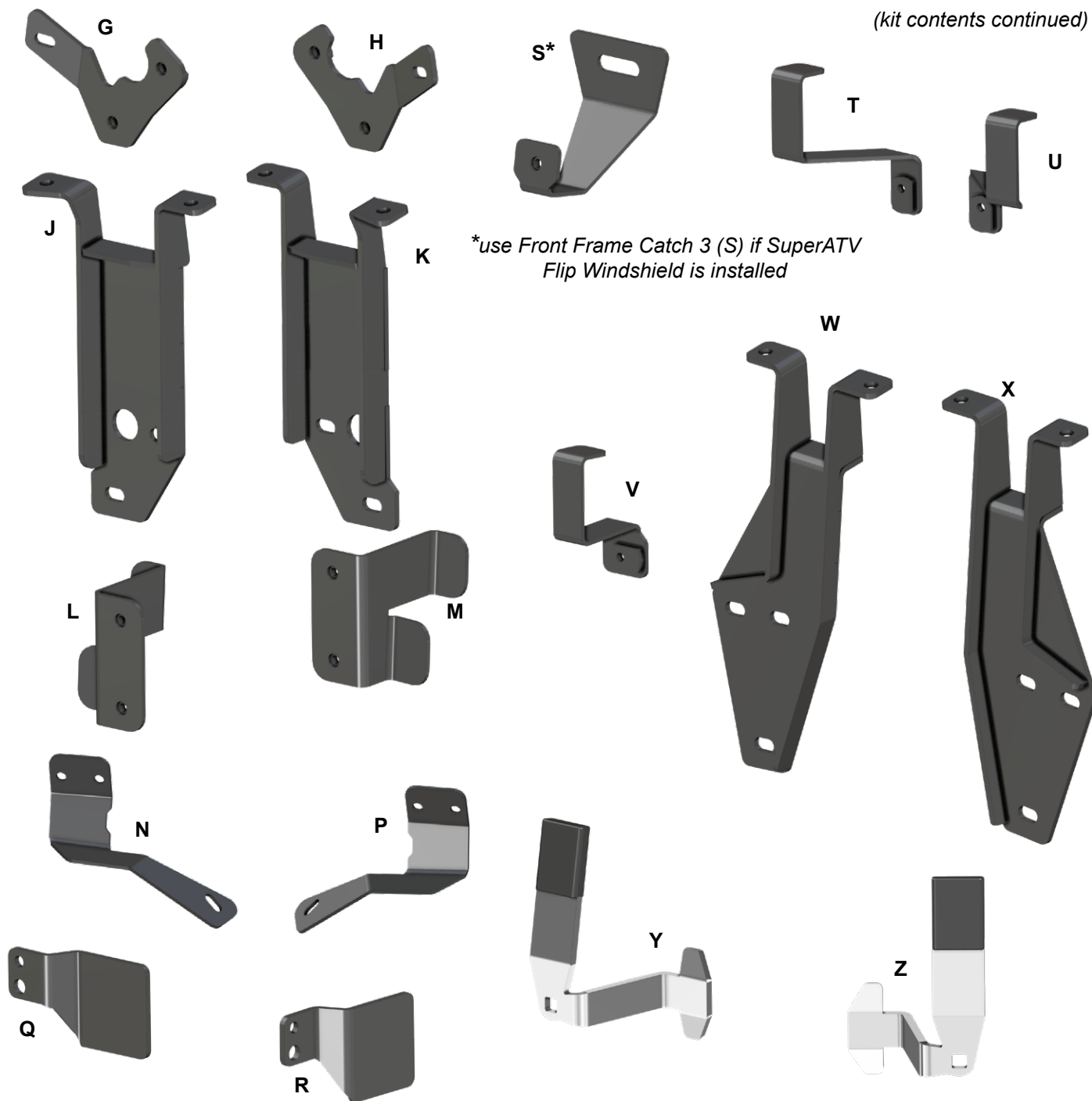

**use Front Frame Catch 3 (S) if SuperATV
Flip Windshield is installed*

Item	Description	Item	Description
G	Front Mount Plate - L	R	Latch Bracket - R
H	Front Mount Plate - R	S*	Front Frame Catch 3 x 2
J	Front Mount 2 - L	T	Front Frame Catch 2 - L
K	Front Mount 2 - R	U	Front Frame Catch 2 -R
L	Front Frame Catch 1 - L	V	Front Frame Catch 3 x 2
M	Front Frame Catch 1 - R	W	Front Mount 1 - L
N	Rear Mount - L	X	Front Mount 1 - R
P	Rear Mount - R	Y	Latch - L x 2
Q	Latch Bracket - L	Z	Latch - R x 2

(kit contents continued)

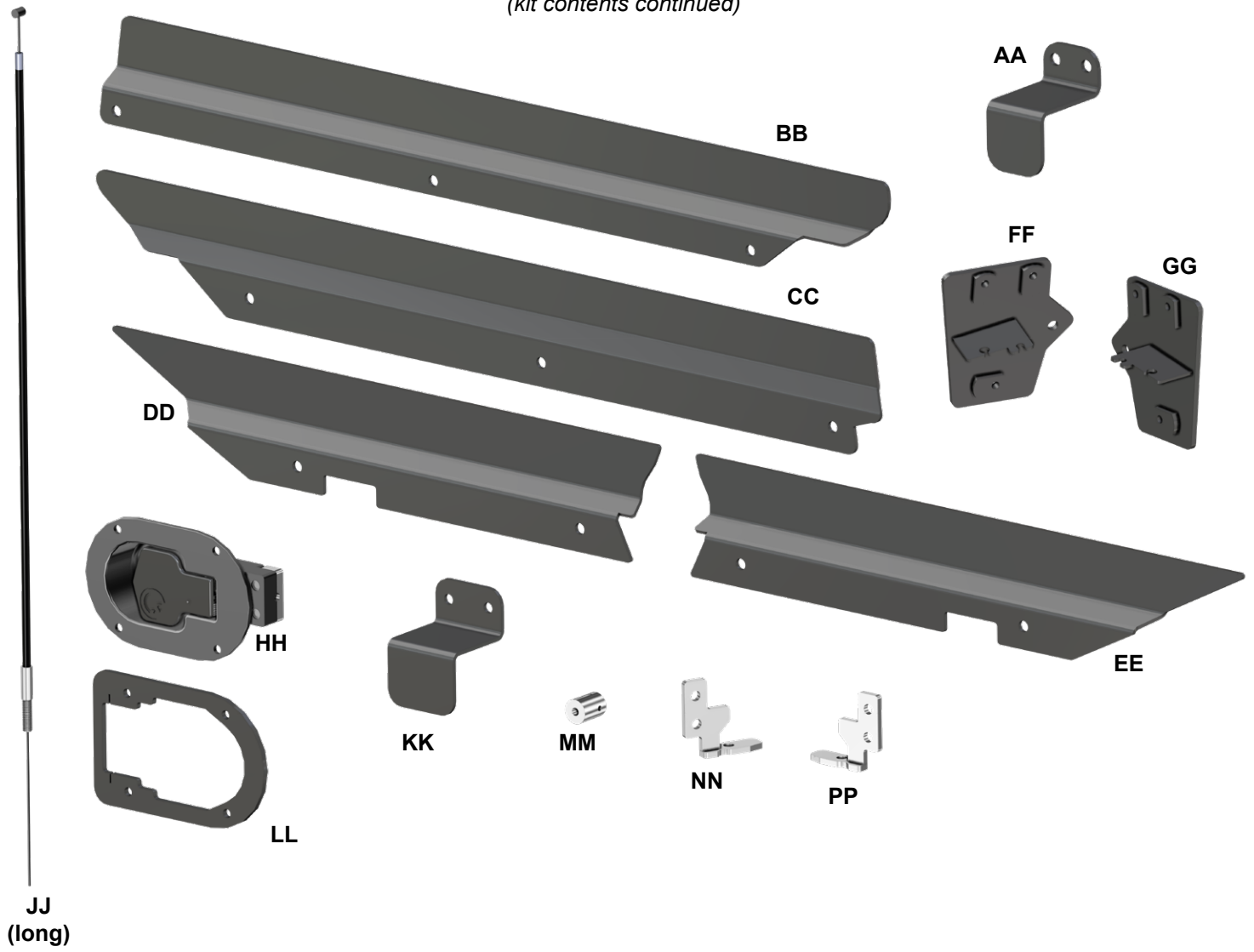

Item	Description	Item	Description
AA	Rear Frame Catch x 2	HH	Handle x 4
BB	Rear Middle Filler - R	JJ	Cable x 2
CC	Rear Middle Filler - L	KK	Rear Frame Catch 1 x 2
DD	Front Filler - L	LL	Backing x 4
EE	Front Filler - R	MM	Conduit x 4
FF	Front Mount - L	NN	Cable Latch - R
GG	Front Mount - R	PP	Cable Latch - L

(kit contents continued)

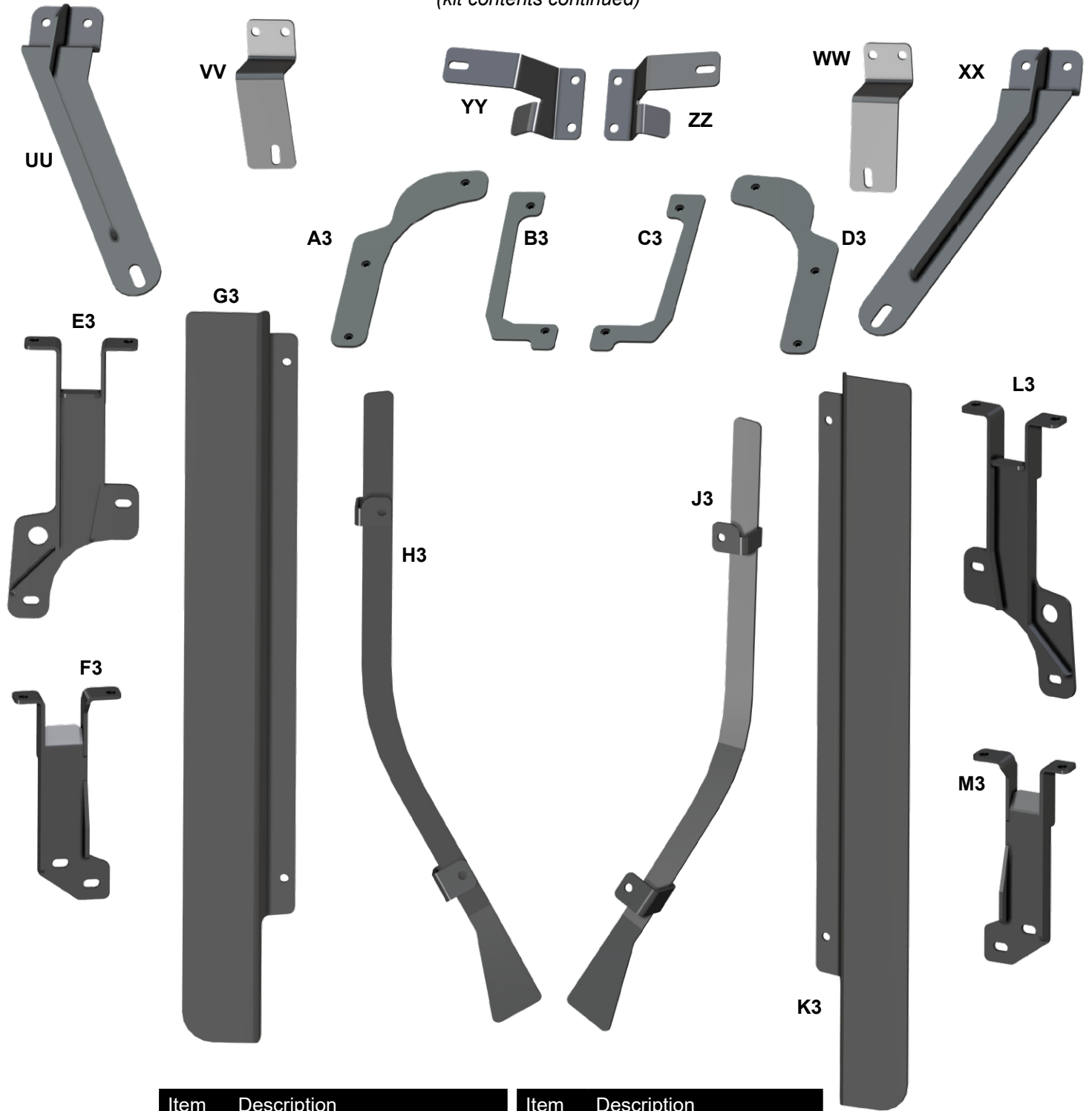

Item	Description	Item	Description
UU	Left Middle Mount	D3	Rear Mount 1 Plate - R
VV	Left Middle Frame Catch 1	E3	Rear Mount 1 - L
WW	Right Middle Frame Catch 1	F3	Rear Mount 2 - L
XX	Right Middle Mount	G3	Rear Filler - L
YY	Left Middle Frame Catch 2	H3	Left Rear Mount
ZZ	Right Middle Frame Catch 2	J3	Right Rear Mount
A3	Rear Mount 1 Plate - L	K3	Rear Filler - R
B3	Rear Mount 2 Plate - L	L3	Rear Mount 1 - R
C3	Rear Mount 2 Plate - R	M3	Rear Mount 2 - R

(kit contents continued)

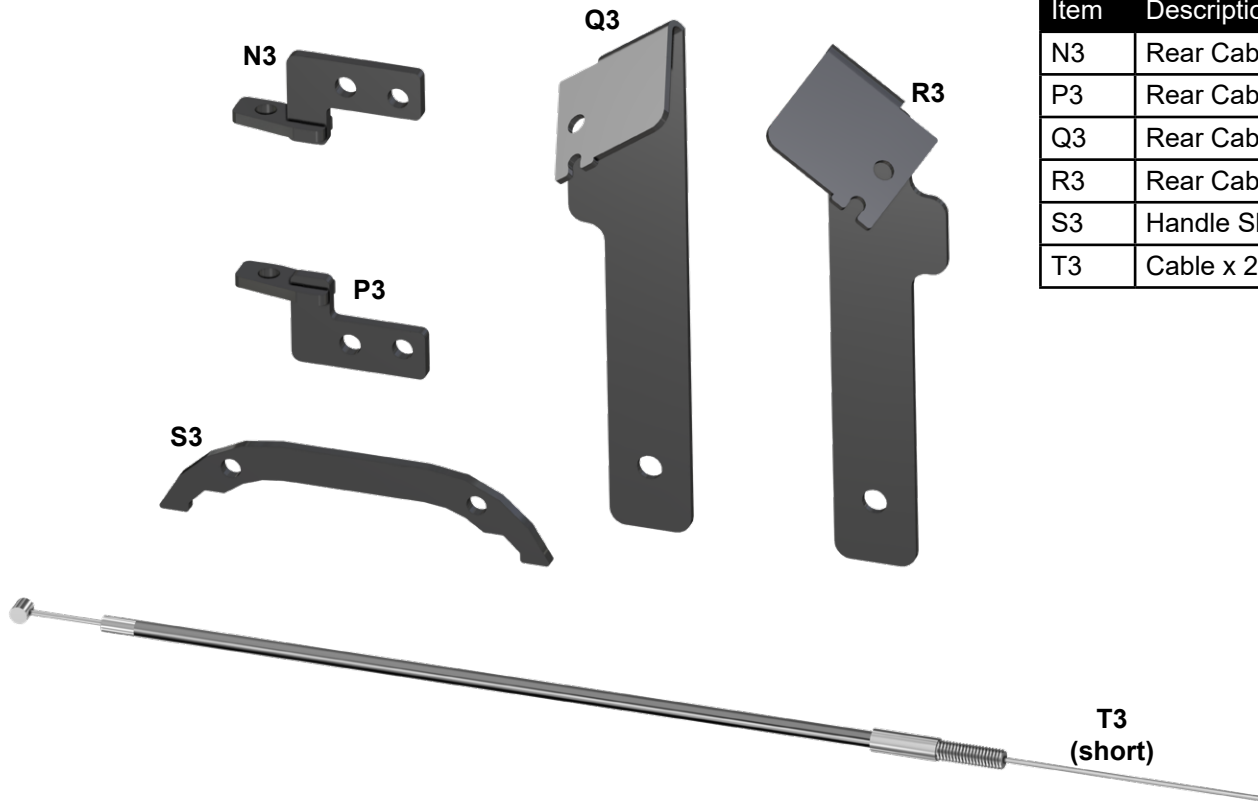

Item	Description
N3	Rear Cable Latch - L
P3	Rear Cable Latch - R
Q3	Rear Cable Guide - R
R3	Rear Cable Guide - L
S3	Handle Shim x 2
T3	Cable x 2

Door Cleaning:

- Do not use Rain-X®, Plexus® or any other protector, wax, or polish.
 - Do not use window cleaning fluids (Windex, 409, etc) or any solvents (gasoline, denatured alcohol, acetone, etc).
 - Never use abrasive cleaners, abrasive pads, or gritty cloths.
 - Never use razor blades, scrapers, squeegees, brushes, etc.
1. Thoroughly rinse Doors to float off dirt and mud.
 2. Using a soft cloth, or microfiber cloth, clean Doors with warm water and a gentle detergent. Baby shampoo, rubbing alcohol, or hand washing soap can also be used.
 3. To prevent water spots, use a chamois to blot Doors dry.

Liability Statement

SuperATV's® products are designed to best fit user's ATV/UTV under stock conditions. Adding, modifying, or fabricating any factory or aftermarket parts will void any warranty provided by SuperATV® and is not recommended. SuperATV's® products could interfere with other aftermarket accessories. If user has aftermarket products on machine, contact SuperATV® to verify that they will work together.

Although SuperATV® has thousands of satisfied customers, user should be aware that installing lift kits, long travel, or suspension kits, tires, etc. will change the ride of machine and may increase maintenance and part wear. Operating any off-road machine while, or after, consuming alcohol and/or drugs increases risk of bodily harm or death. No warranty or representation is made as to this product's ability to protect user from severe injury or death. SuperATV® urges operators and occupants to wear a helmet and appropriate riding gear at all times.

By purchasing and installing SuperATV® products, user agrees that should damages occur, SuperATV® will not be held responsible for loss of time, use, labor fees, replacement parts, or freight charges. SuperATV®, nor any 3rd party, will not be held responsible for any direct, indirect, incidental, special, or consequential damages that result from any product purchased from SuperATV®. The total liability of seller to user for all damages, losses, and causes of action, if any, shall not exceed the total purchase price paid for the product that gave rise to the claim.

SuperATV® will warranty only parts provided by SuperATV®. Any damage or problems with OEM housings, bearings, seals, or other manufacturers' products will not be covered by SuperATV®. SuperATV® parts and products are not warrantied if item was not installed properly, misused, or modified.

Installing, adding, modifying, or fabricating any factory or aftermarket product to your ATV/UTV may violate certain local, state, and federal laws. Be advised that laws vary depending on town, city, county, state, etc. Use of certain products on public streets, roads, or highways may be in violation law. The Buyer is solely and exclusively legally and personally responsible for any violation of the law by the installation or use of the product. You must abide by all local, state, and federal laws, including but not limited to vehicle safety, traffic laws, and ordinances. It is your responsibility to know the laws and how they apply to you.

The Buyer is responsible to fully understand the capability and limitations of his/her vehicle according to manufacturer specifications, warnings and instructions and agrees to hold SuperATV® harmless from any damage resulting from failure to adhere to such specifications, warnings and/ or instructions. The Buyer is also responsible to obey all applicable federal, state, and local laws and ordinances when operating his/her vehicle while using this product, and the Buyer agrees to hold SuperATV® harmless from any violation thereof.

- Install Front Filler - R (EE), Front Frame Catch 1 - R (M), Front Frame Catch 2 - R (U), and Front Frame Catch 3 (V) to Right Front (B) with hardware shown.

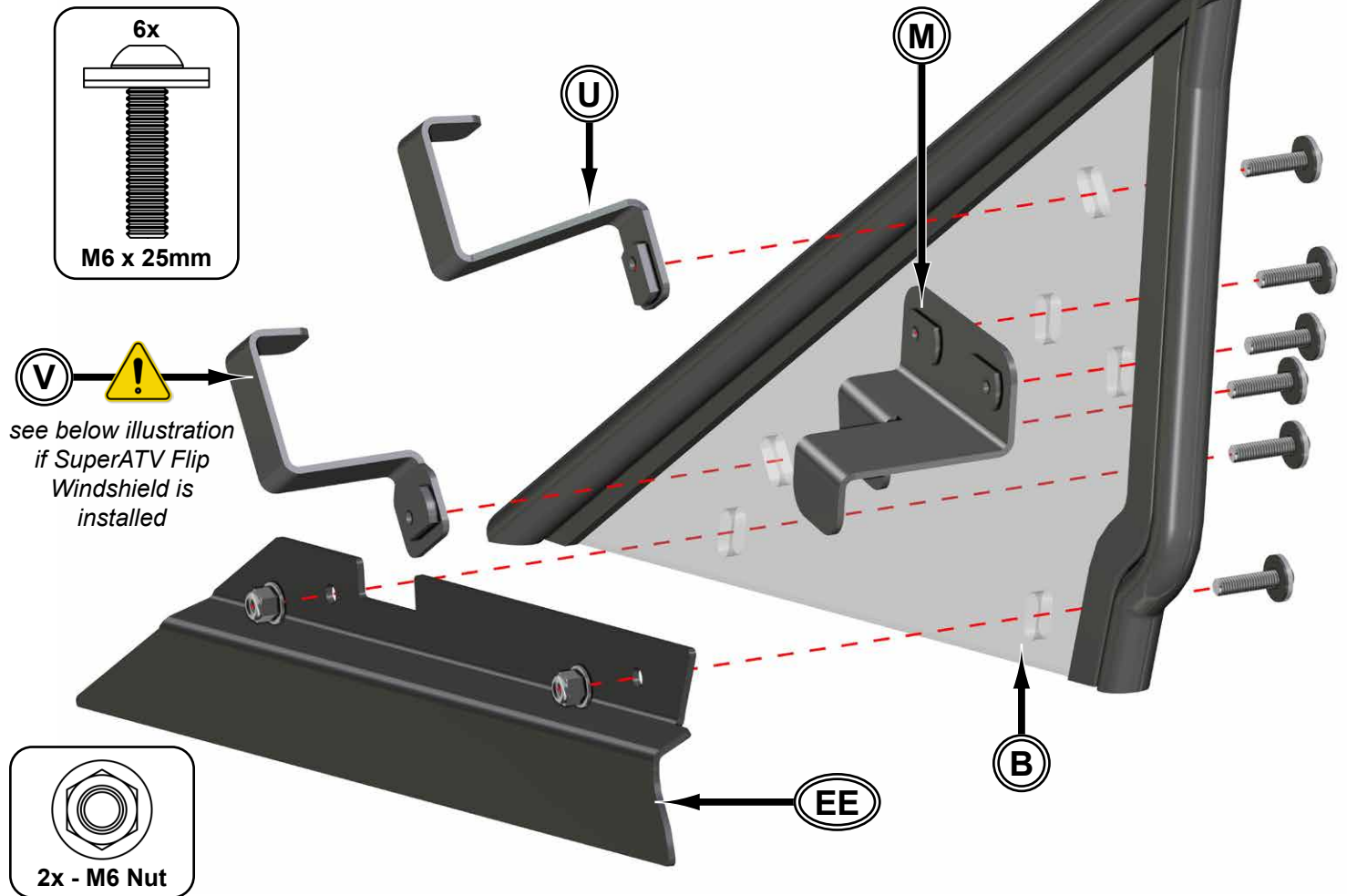

Install Front Frame Catch 3 (V) if SuperATV Flip Windshield is installed.

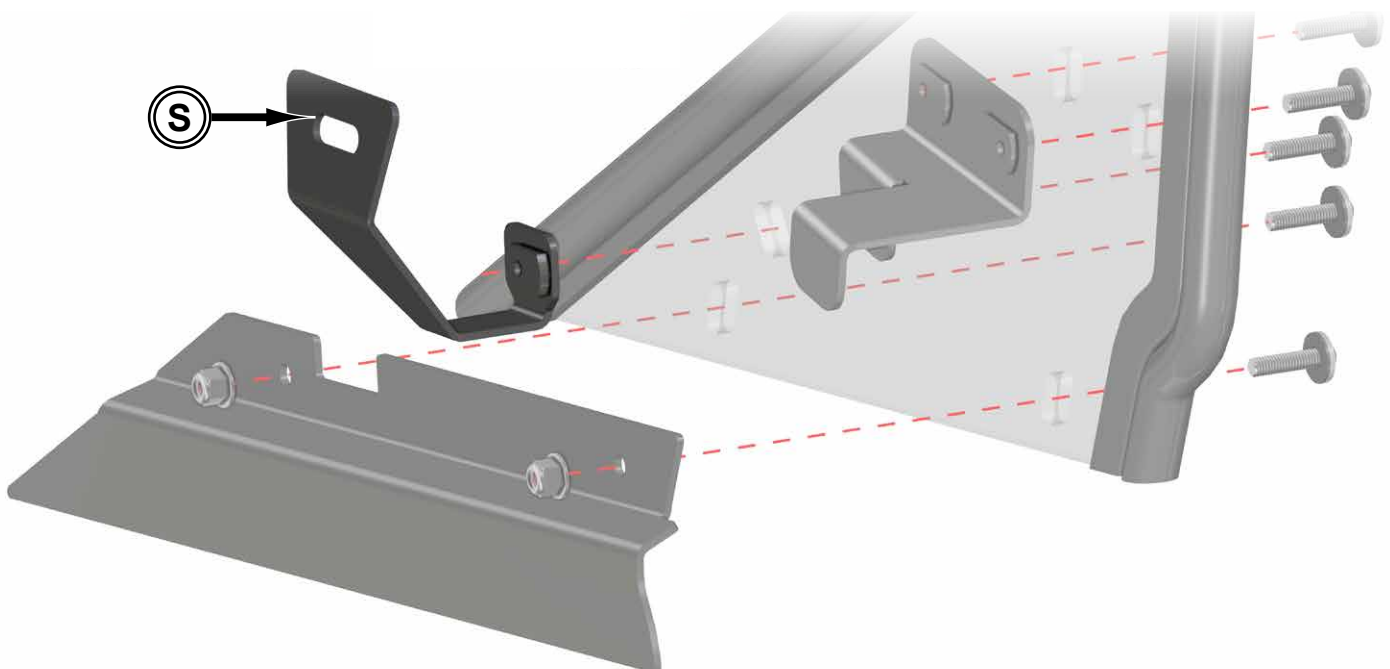

- Place Right Front assembly to machine and rotate Frame Catches around Frame.



SuperATV Flip Windshield variant

- Unbolt Strut From Clamp.
- Secure Front Frame Catch 3 (S) to Clamp with Strut.

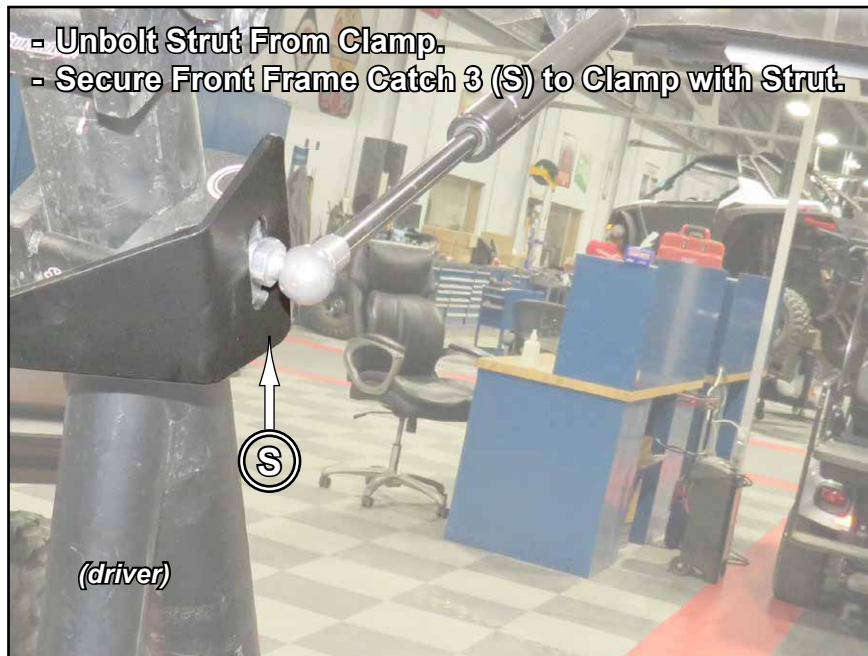

- Install Clamps to general locations shown; snug but not tight.



- Remove stock hardware shown and install Rear Mount - R (P).
- Secure with stock hardware.



- Install Rear Fixed Filler - R (BB), Rear Frame Catch (AA), and Rear Frame Catch 1 - R (KK) to Right Rear (D) with hardware shown.

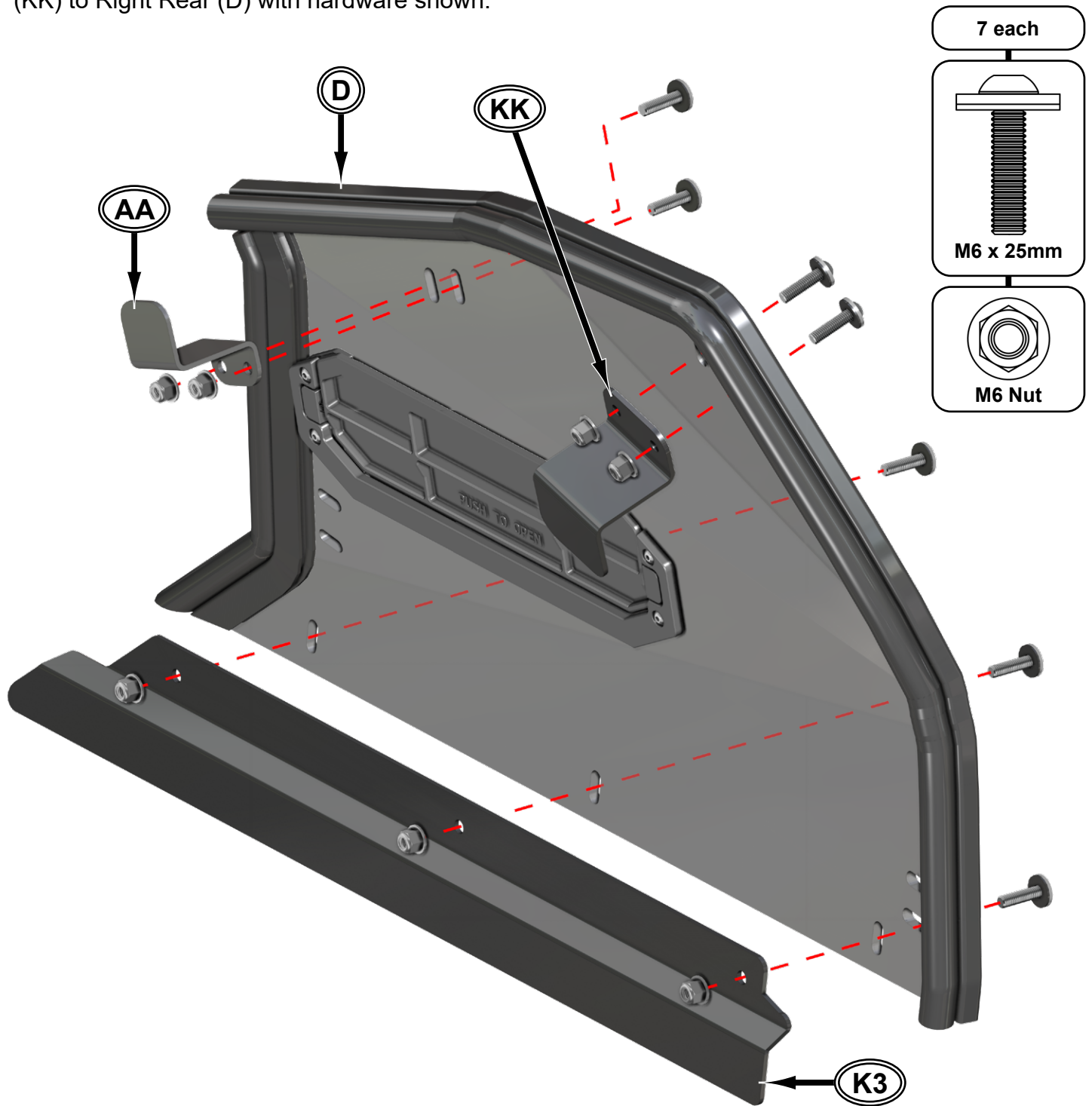

- Place Right Rear assembly to machine and rotate Frame Catches around Frame.
- Secure to Rear Mount - R (P) and Clamp with hardware shown.

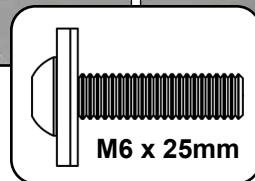
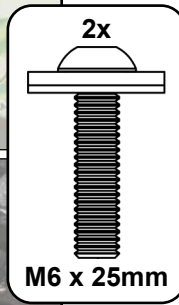

2 each



Install following components to Right Middle (SS) with hardware shown:

- Right Middle Frame Catch 1 (WW)
- Right Middle Frame Catch 2 (ZZ)
- Right Middle Mount (XX)
- Rear Middle Filler - R (BB)

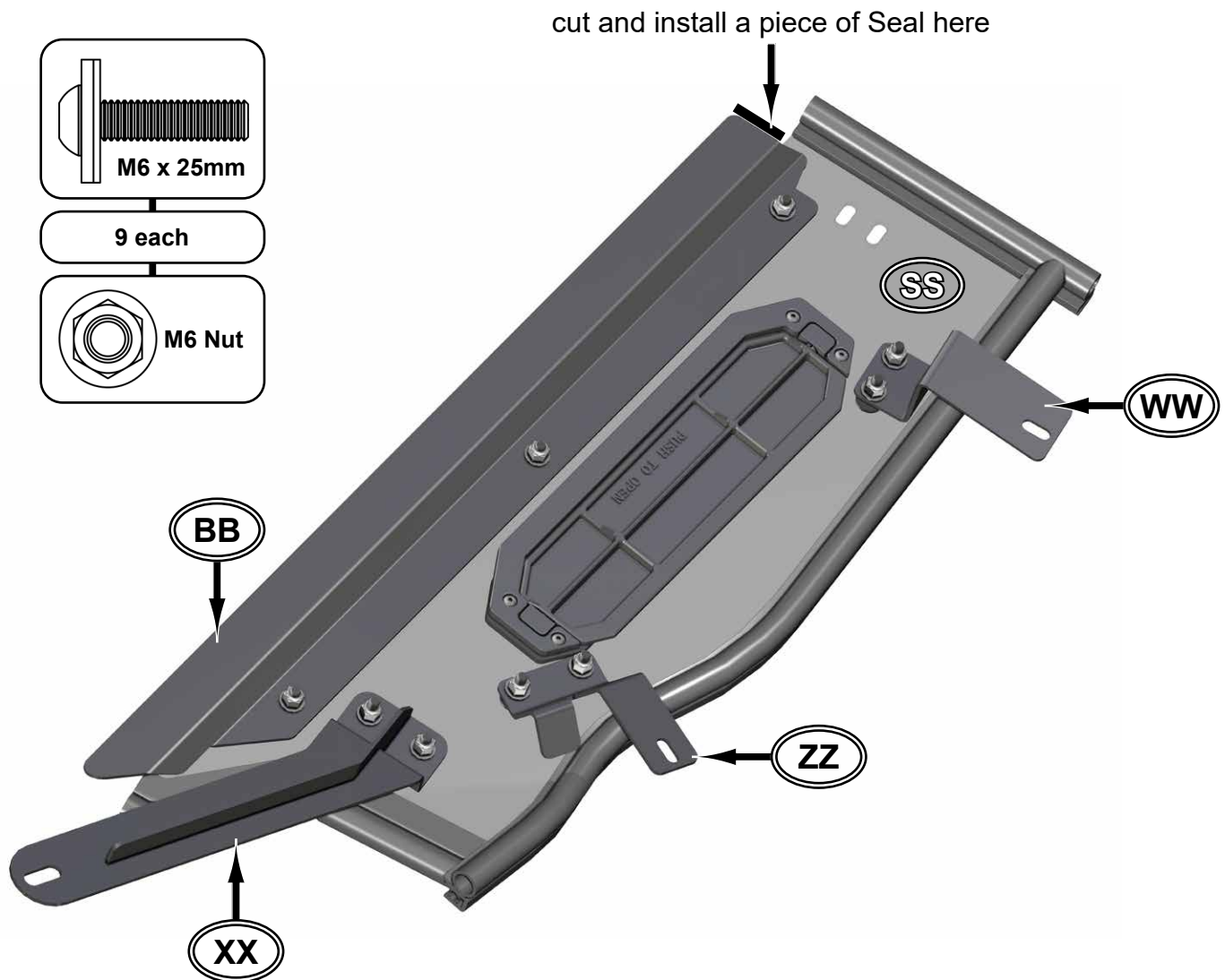

- Place Right Middle assembly to machine and place Frame Catches around Frame.
- Secure to Clamp with hardware shown.



- Secure Right Middle Mount (XX) to machine with hardware shown.

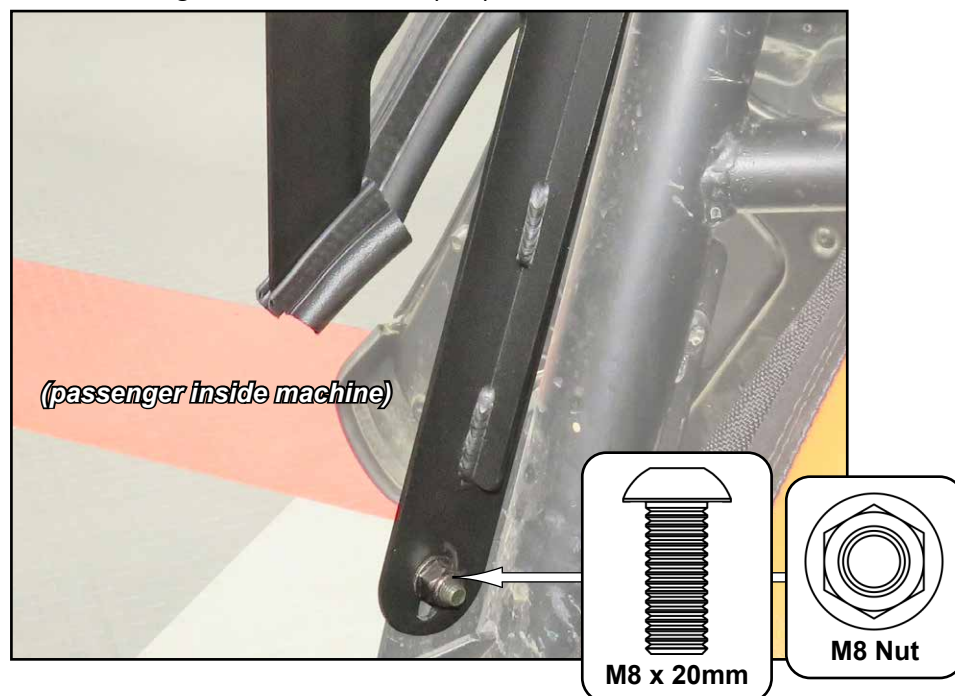

- Install Rear Fille (K3) to Right Rear (TT) with hardware shown.

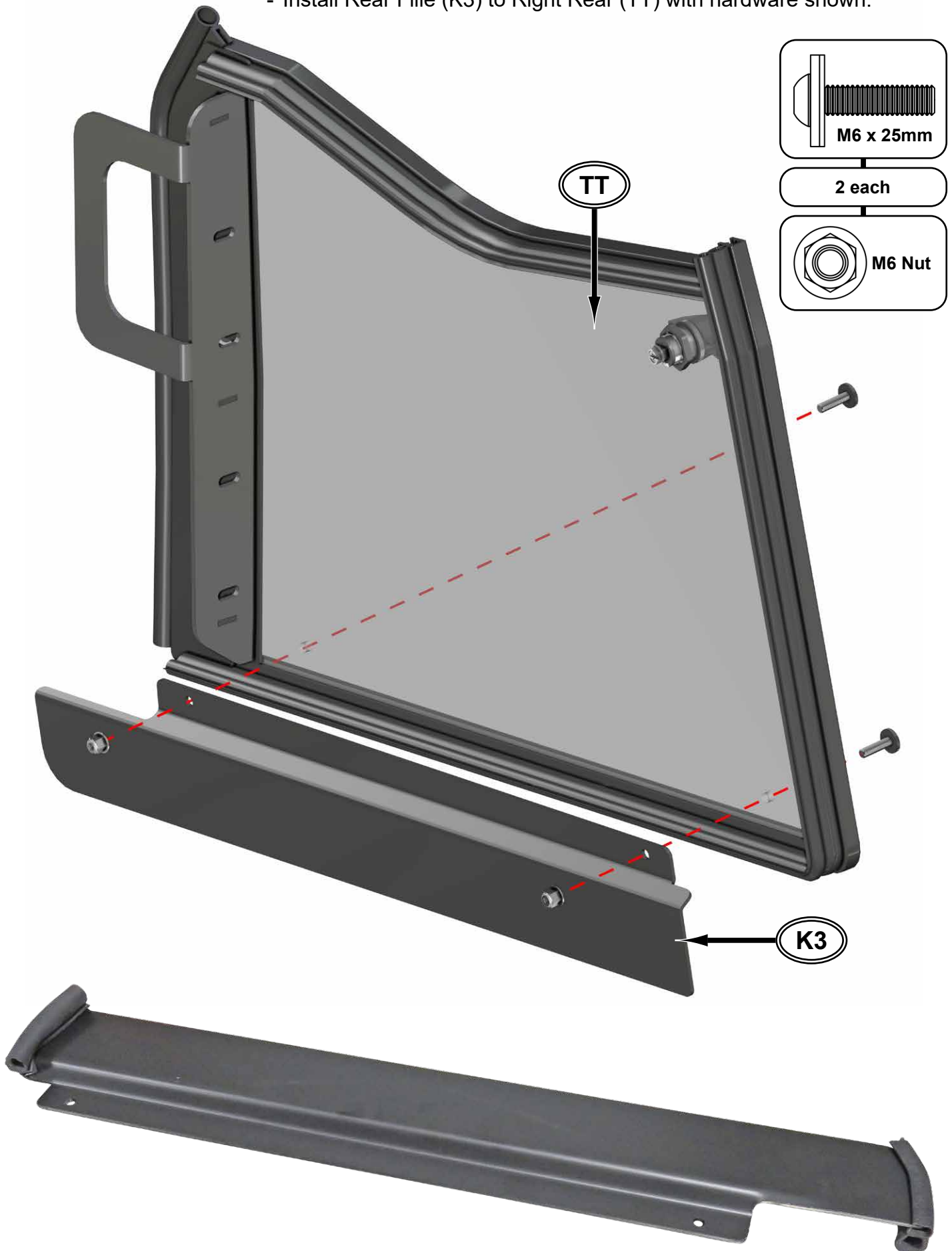
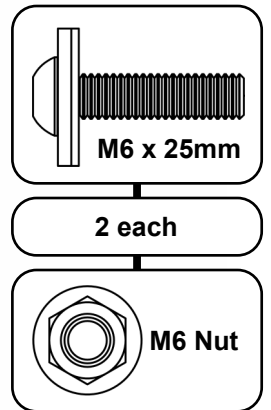

- Install Seal and U-Seal to locations shown on Right Rear Mount (J3).

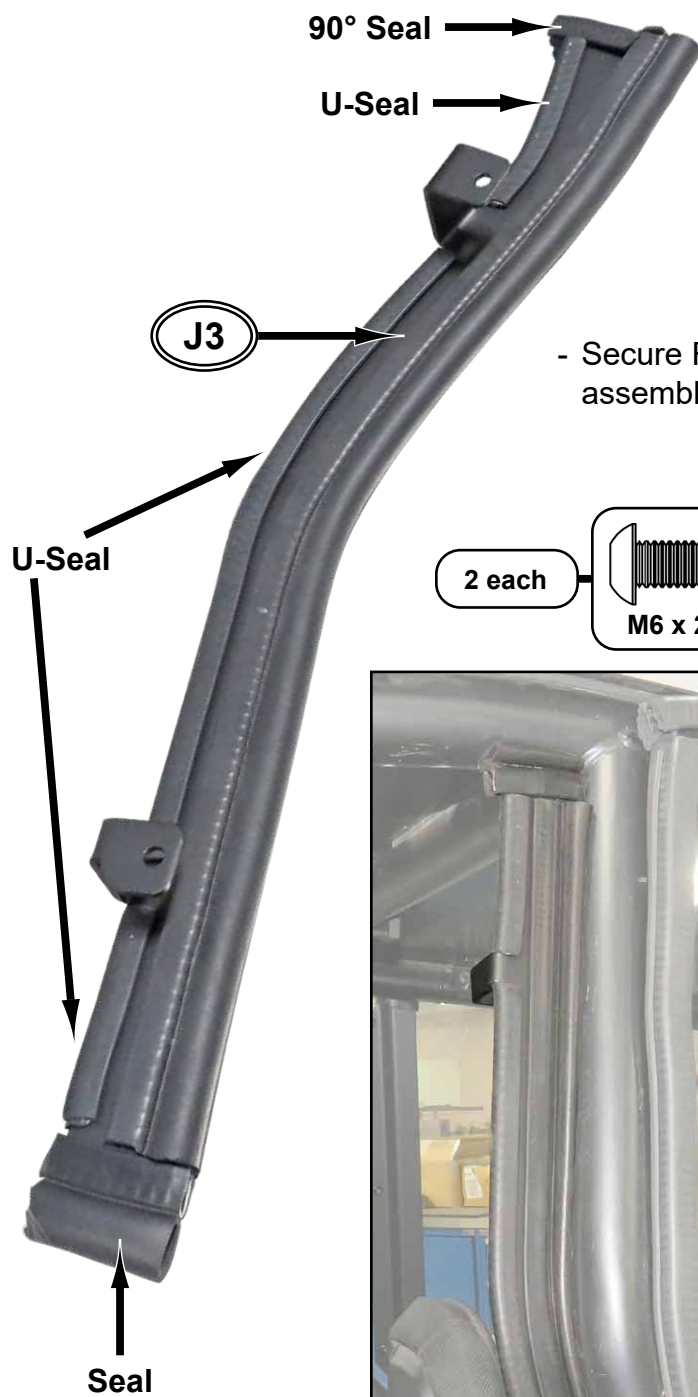

- Secure Right Rear Mount (J3) to Right Middle assembly with hardware shown.

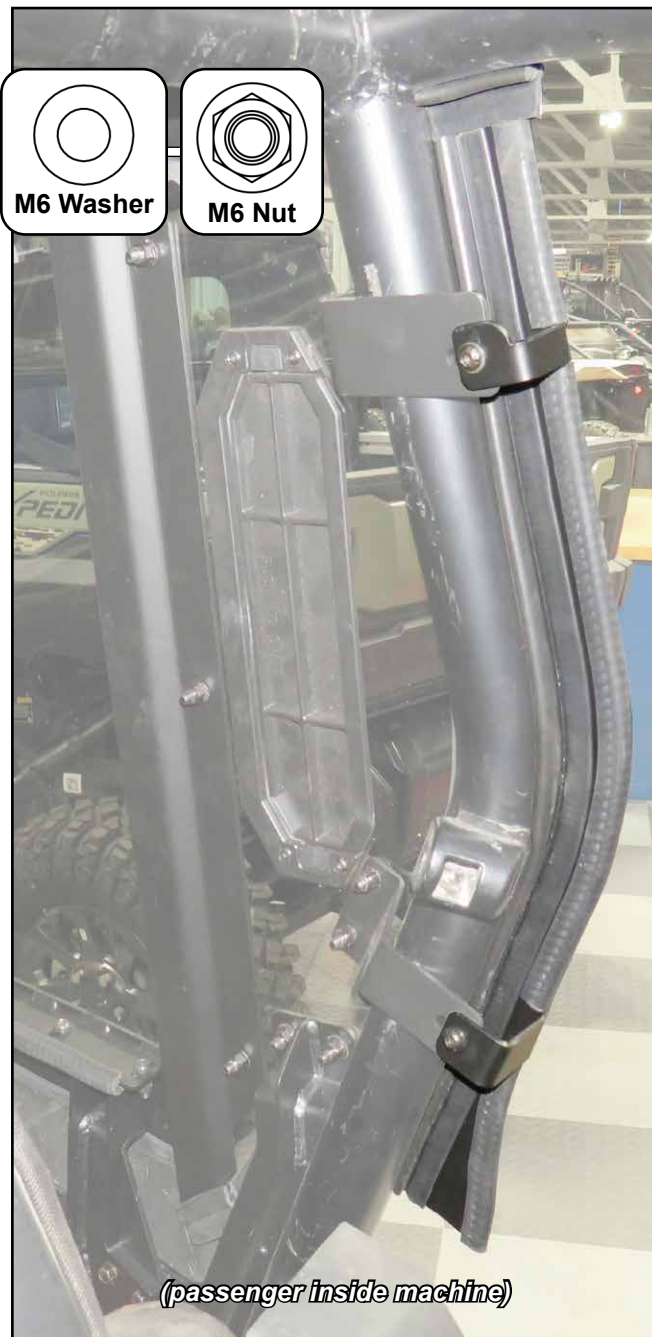
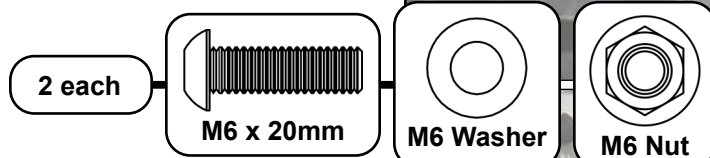

- Remove stock hardware shown and Front Door Panel.



- Install Front Mount - R (GG) to Door Frame with hardware shown; do not tighten.

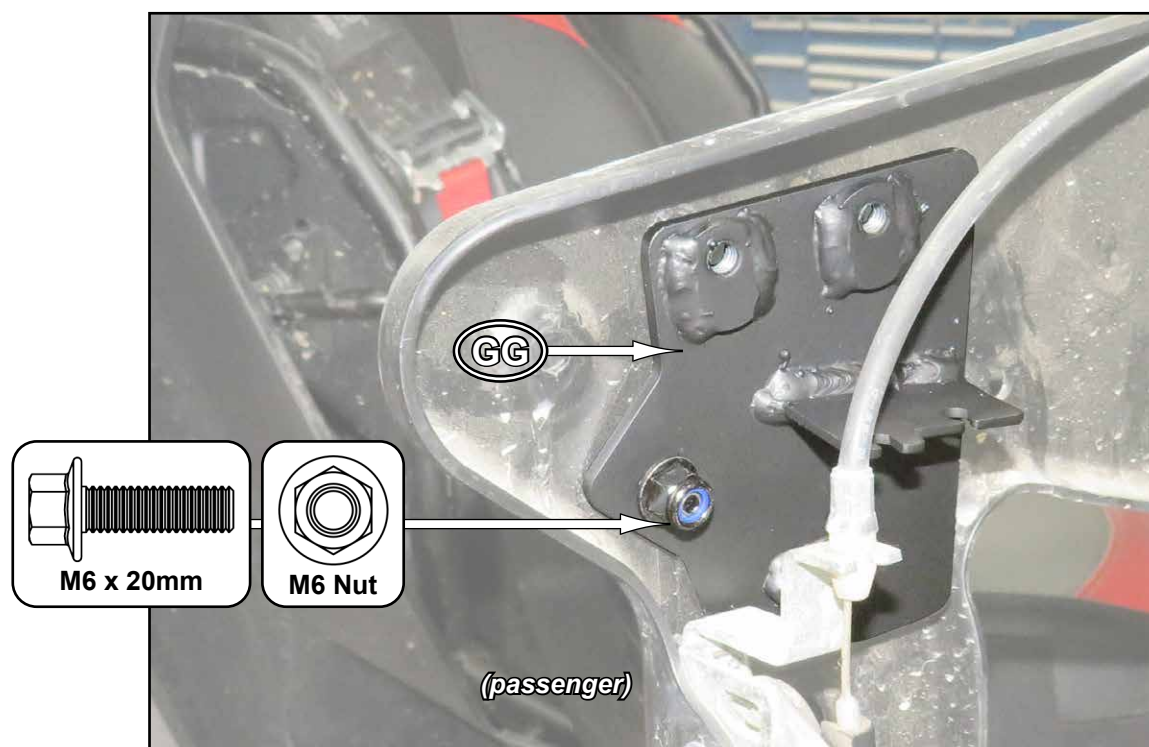

- Remove stock Cable from stock Latch.



- Install Cable Latch - R (NN) with hardware shown; tighten.

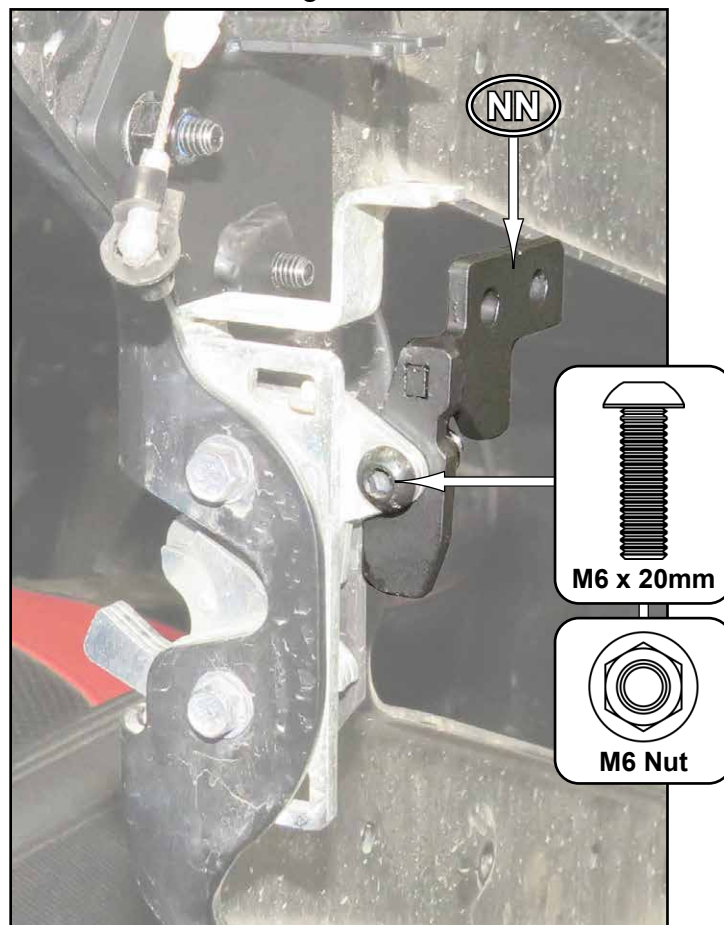

- Install stock Cable to Cable Latch - R (NN).

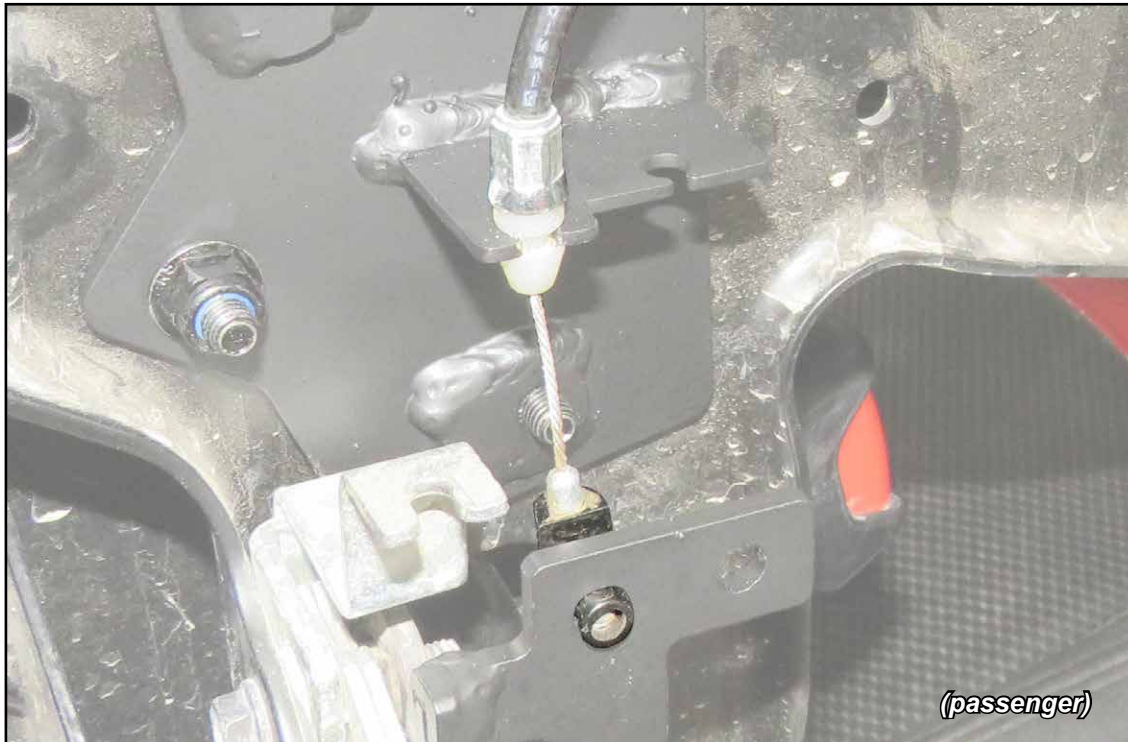

- Install Set Screw to Conduit (MM).

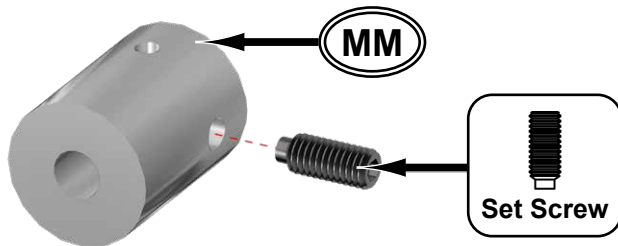

- Install Conduit (MM) to Cable Latch - R (NN) with hardware shown; tighten.

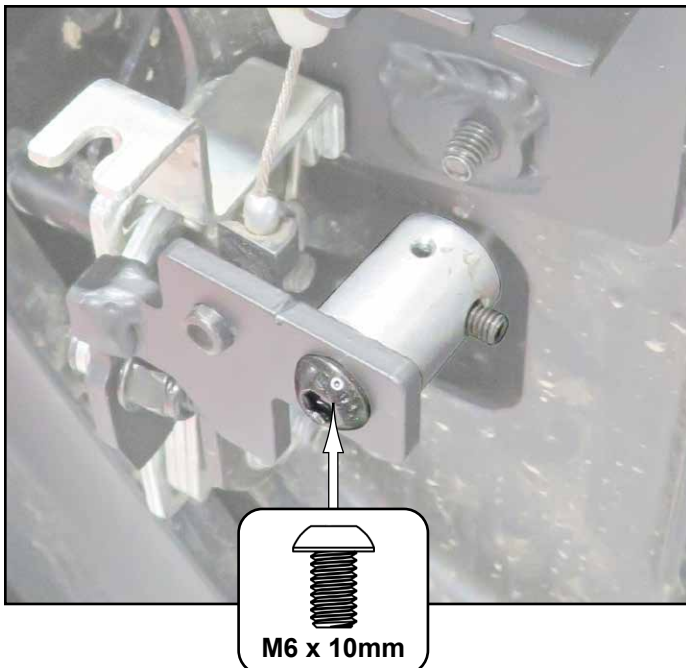

- Install Cable (JJ) into Conduit (MM) and secure to Cable Latch - R (NN).

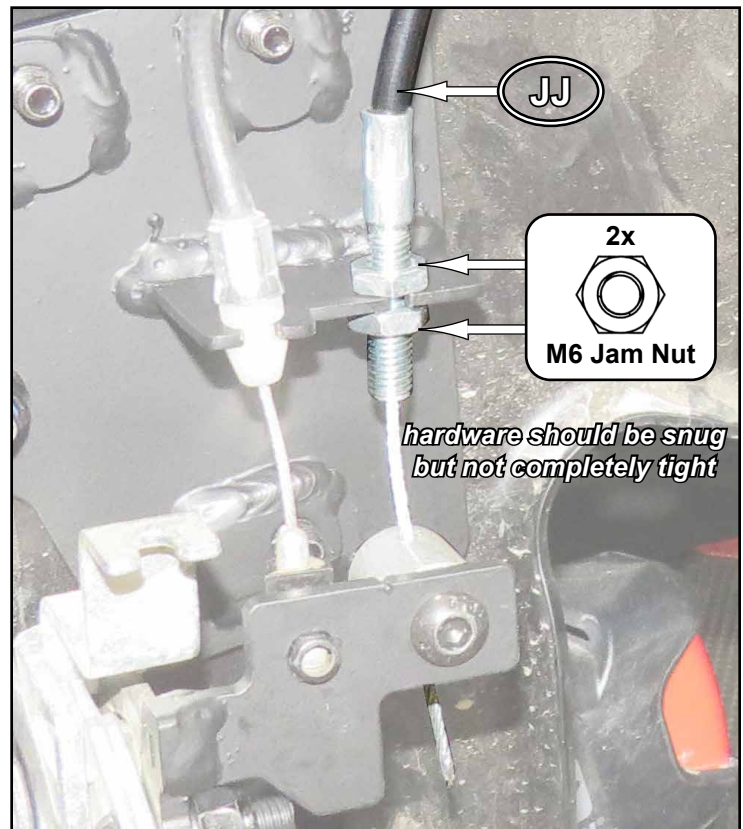

- Install Front Mount 1 - R (X) to Door Frame and Front Mount - R (GG) with hardware shown; tighten.

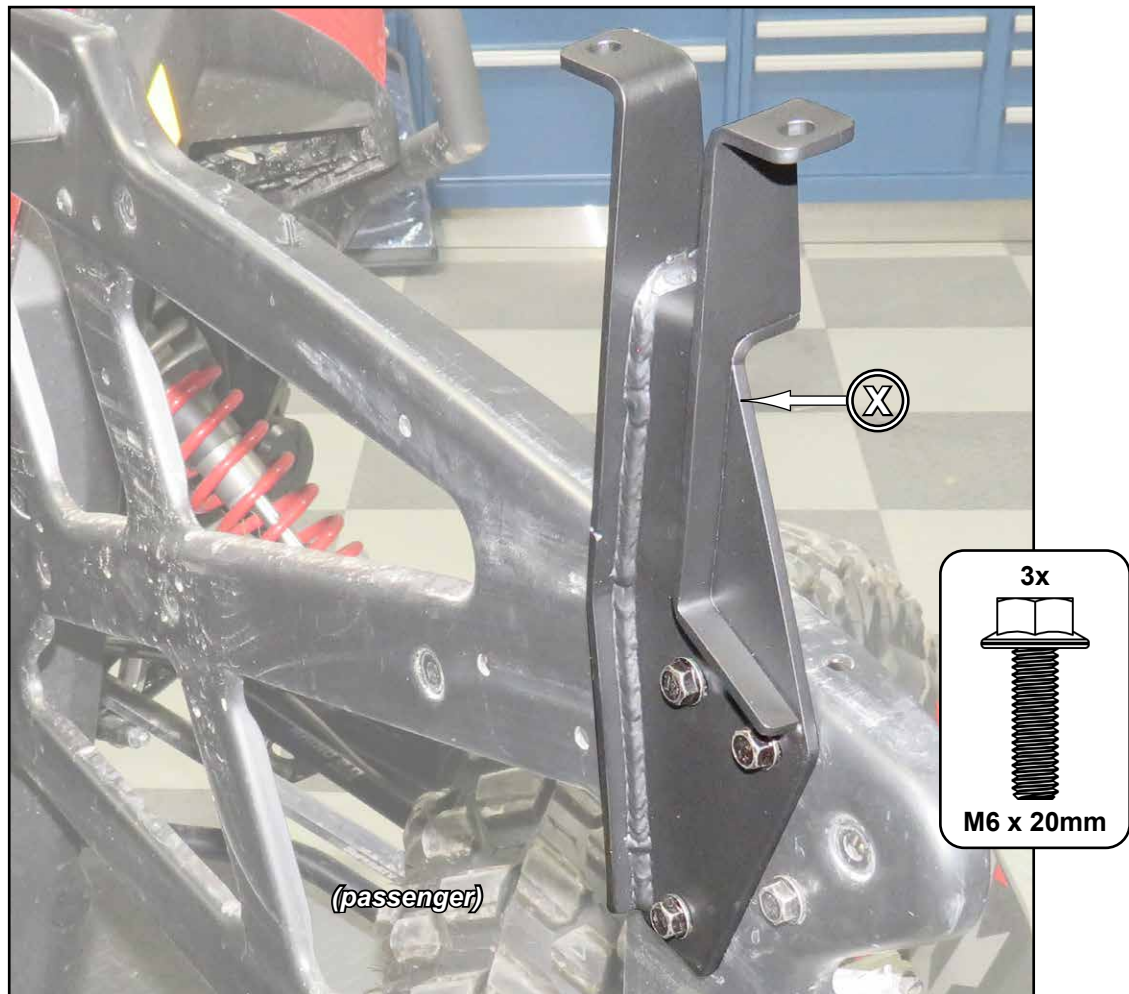

- Install Front Mount 2 - R (K) and Front Mount Plate - R (H) to Door Frame with hardware shown; tighten.

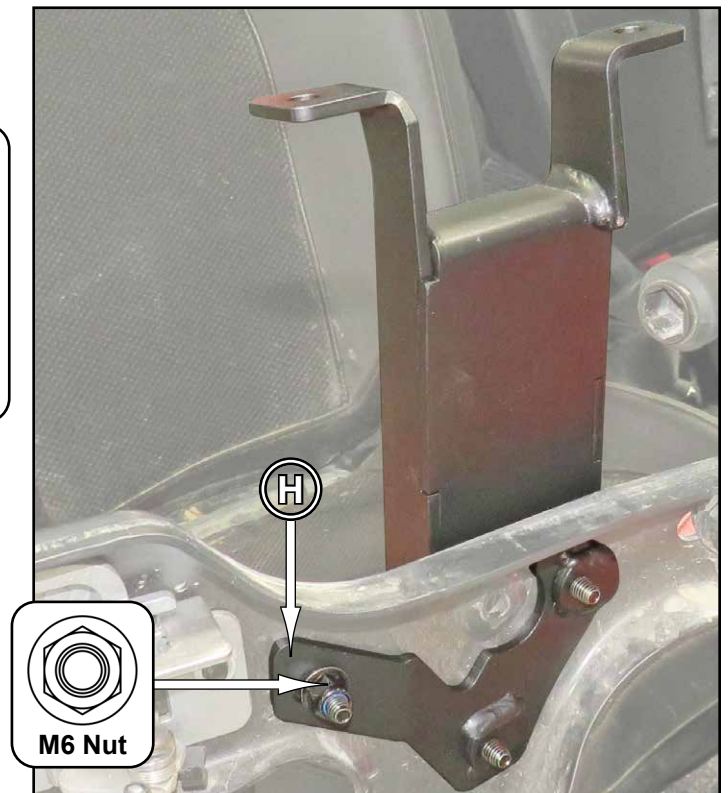
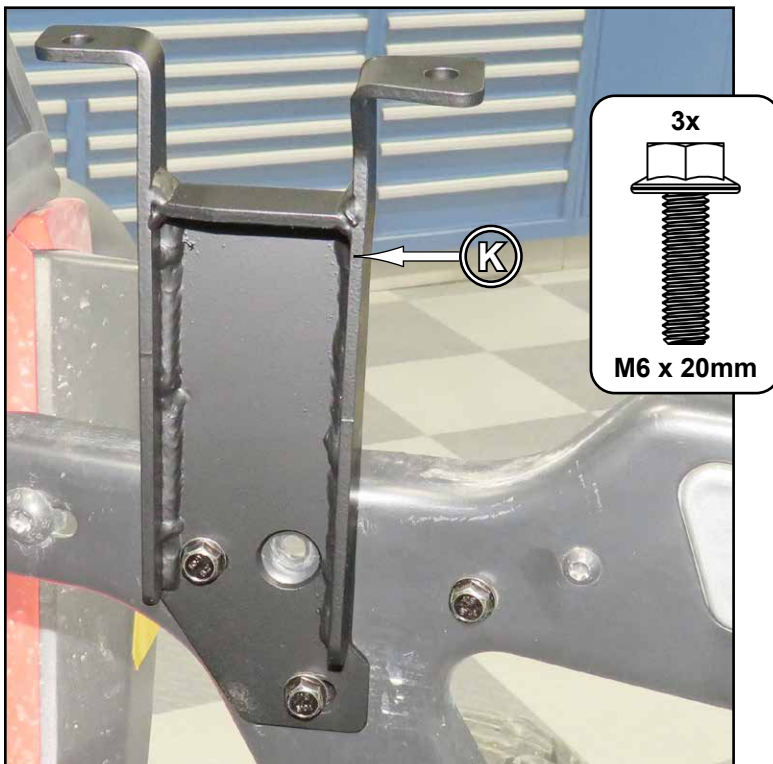

- Place Backing (LL) onto inside of Door Panel on location shown.



- Trace inside of Backing (LL) onto Door Panel.
- Mark holes in Backing (LL) onto Door Panel.



- Create cutout and drill holes. Holes to be large enough for M5 bolts.



- Install Handle (HH) and Backing (LL) to Door Panel with hardware shown; tighten.

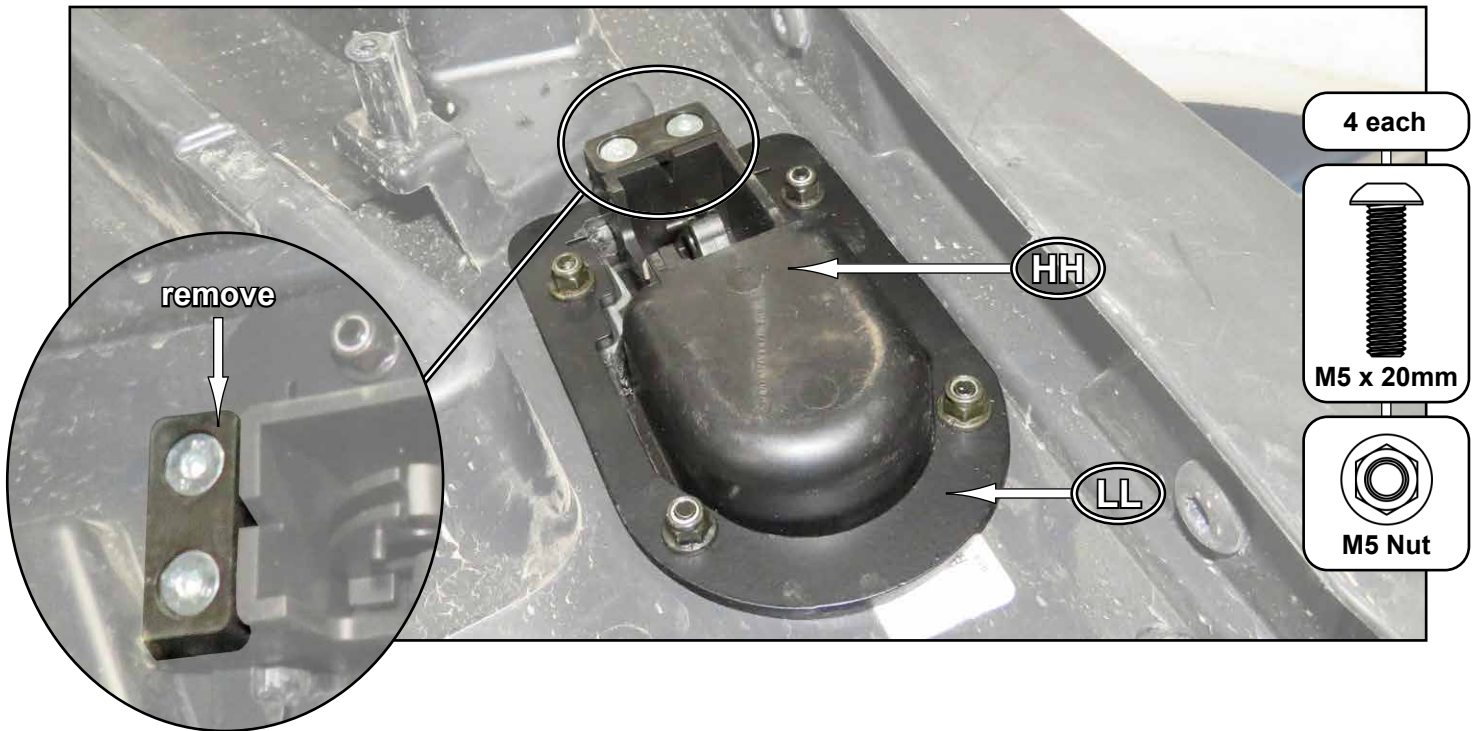

- Connect Cable (JJ) to Handle (HH).

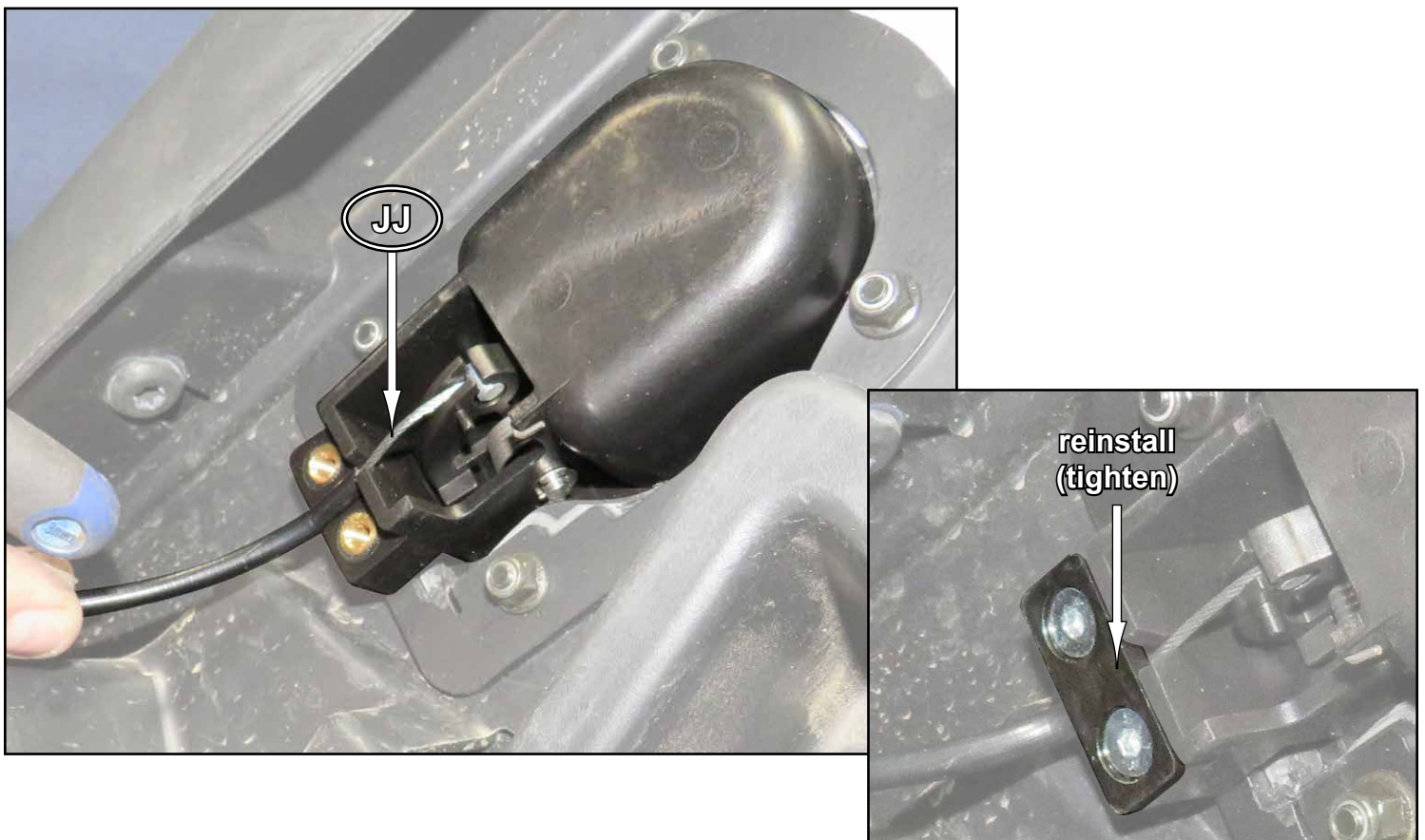

- Test Cables by operating Handle (HH). If Door unlatches properly, tighten all Cable hardware.
- If adjustment is required, adjust Nuts on Cable (JJ), page 11, and repeat above step.



- Reinstall Door Panel to Frame with stock hardware; tighten.



- Install Right (F) to Front Mount 1 - R (X) and Front Mount 2 - R (K) with hardware shown.



- Install Latch - R (Z) with previously removed hardware; tighten.



- Install Latch Bracket - R (R) to Clamp with hardware shown; tighten.

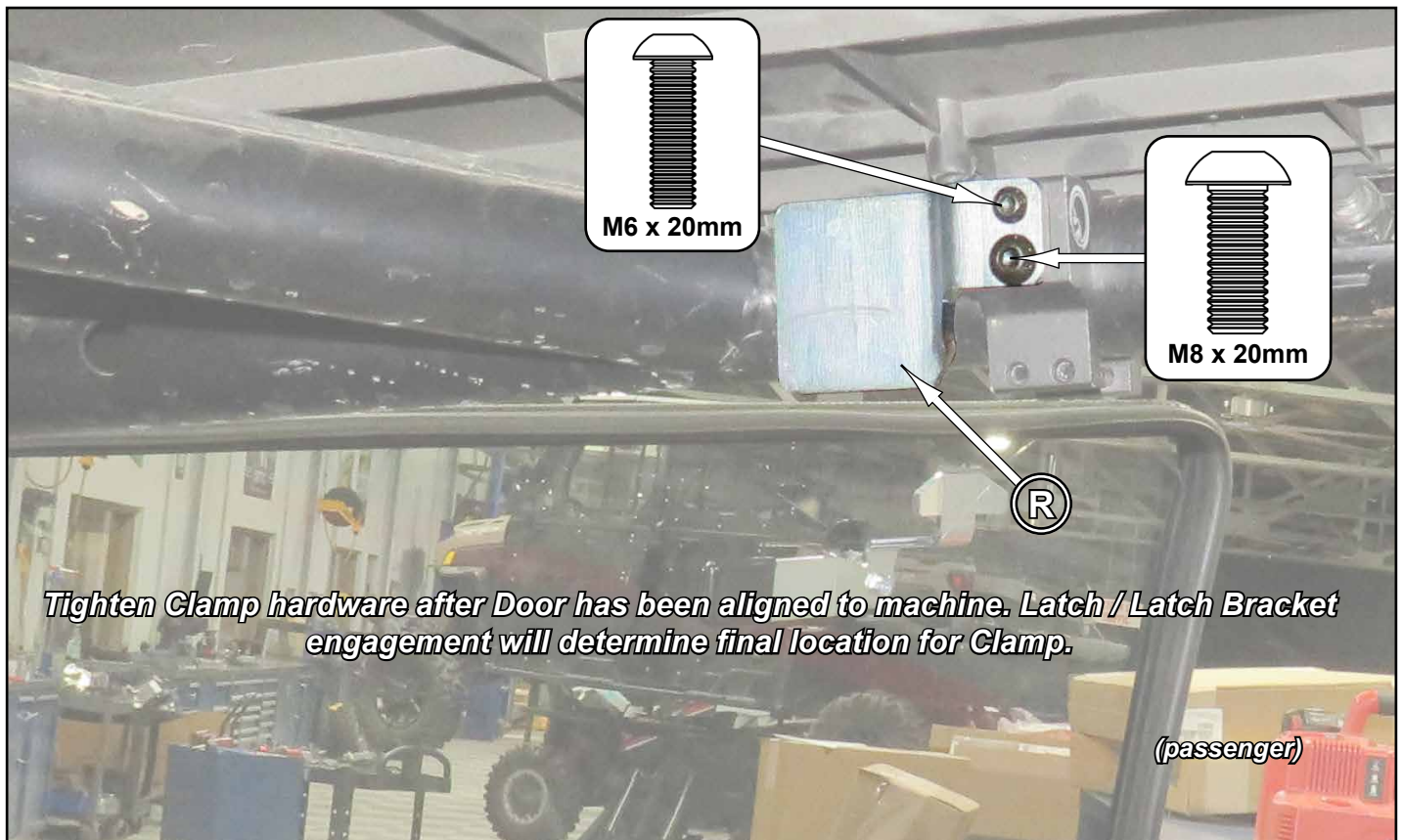

- Remove stock hardware shown and Rear Door Panel.

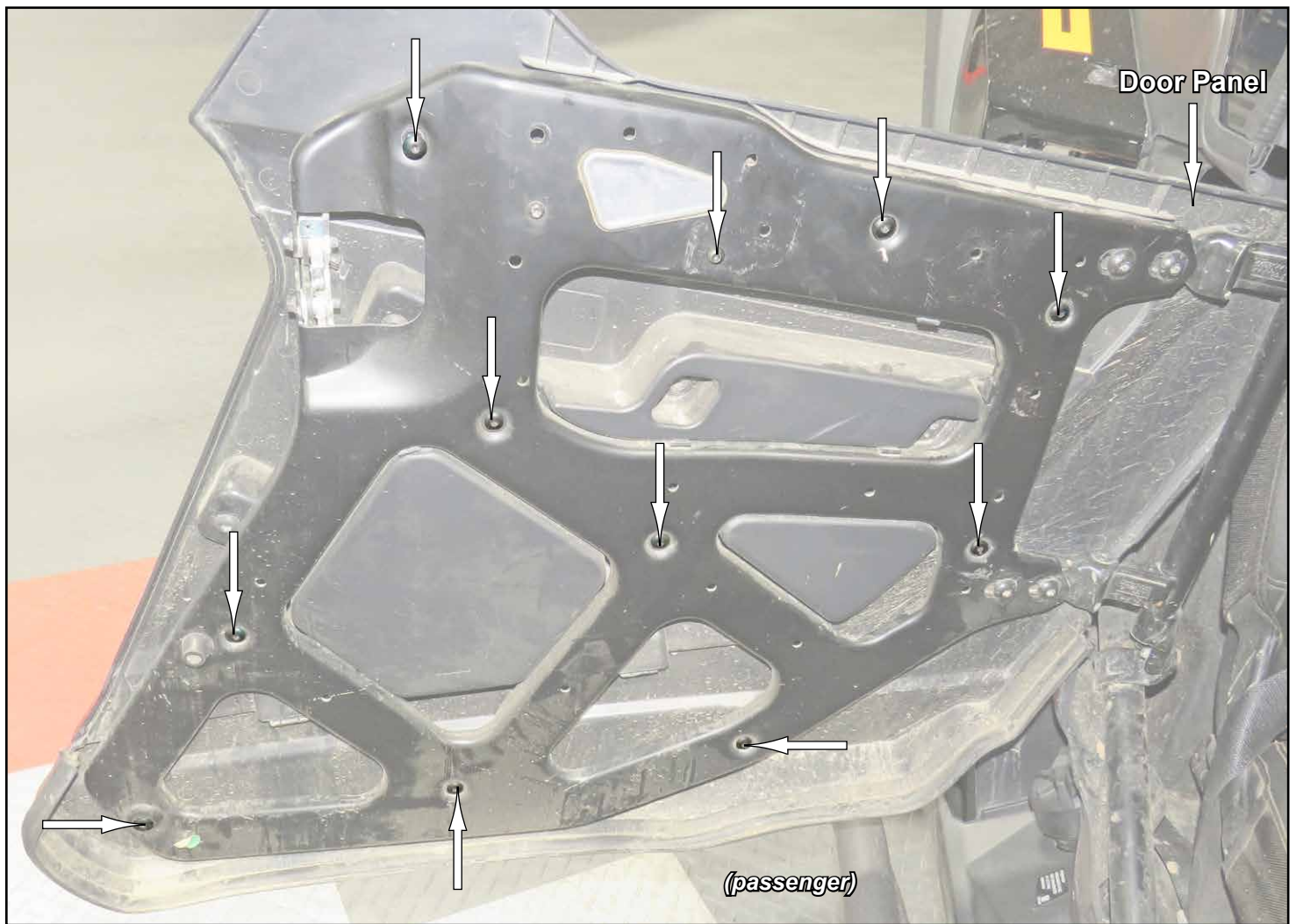

- Place Backing (LL) onto inside of Rear Door Panel on location shown.

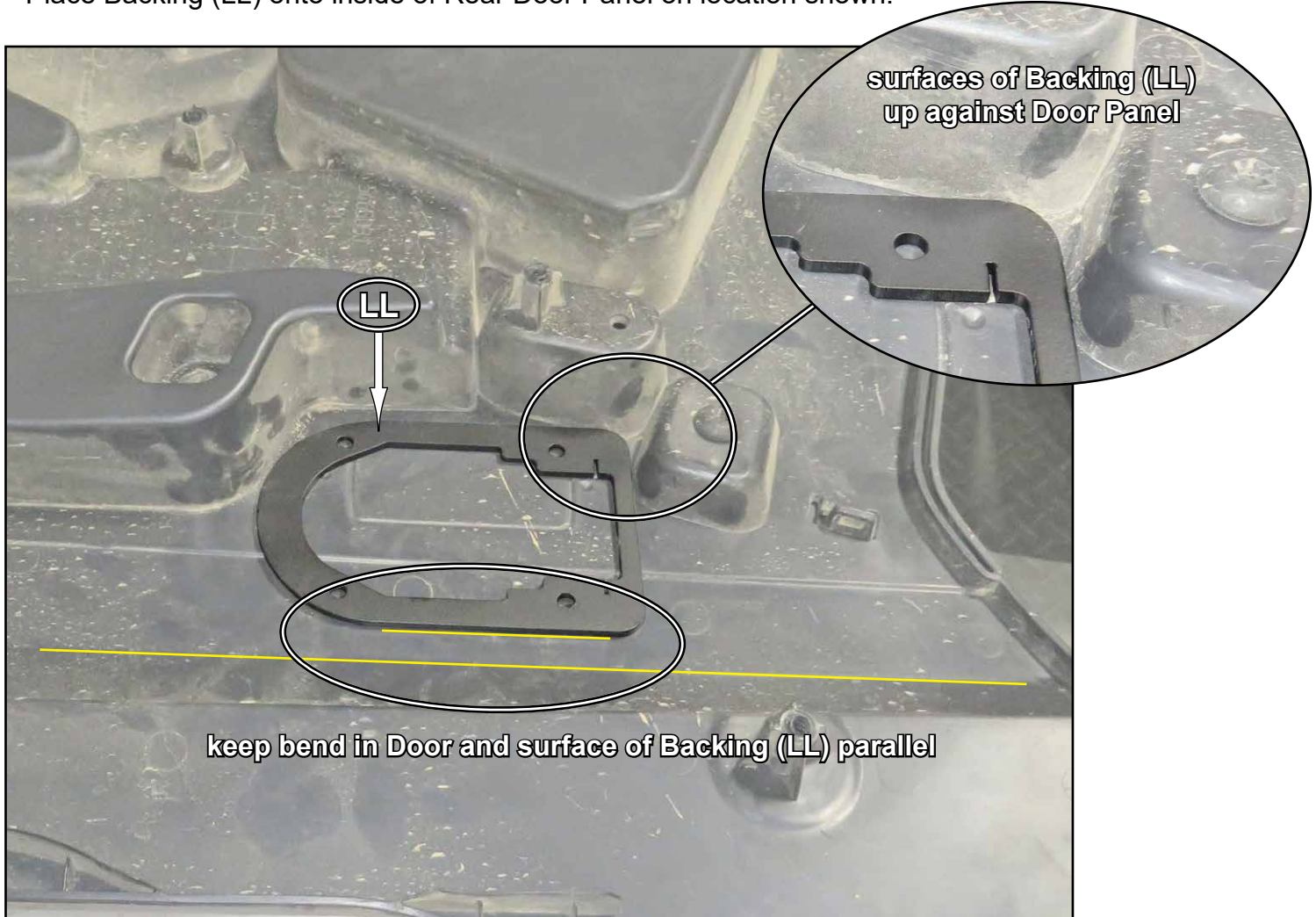

- Trace inside of Backing (LL) onto Rear Door Panel.
- Mark holes in Backing (LL) onto Rear Door Panel.
- Remove Backing (LL) and reate cutout and drill holes. Holes to be large enough for M5 bolts.



- Install Handle (HH), Handle Shim (S3) and Backing (LL) to Door Panel with hardware shown; tighten.

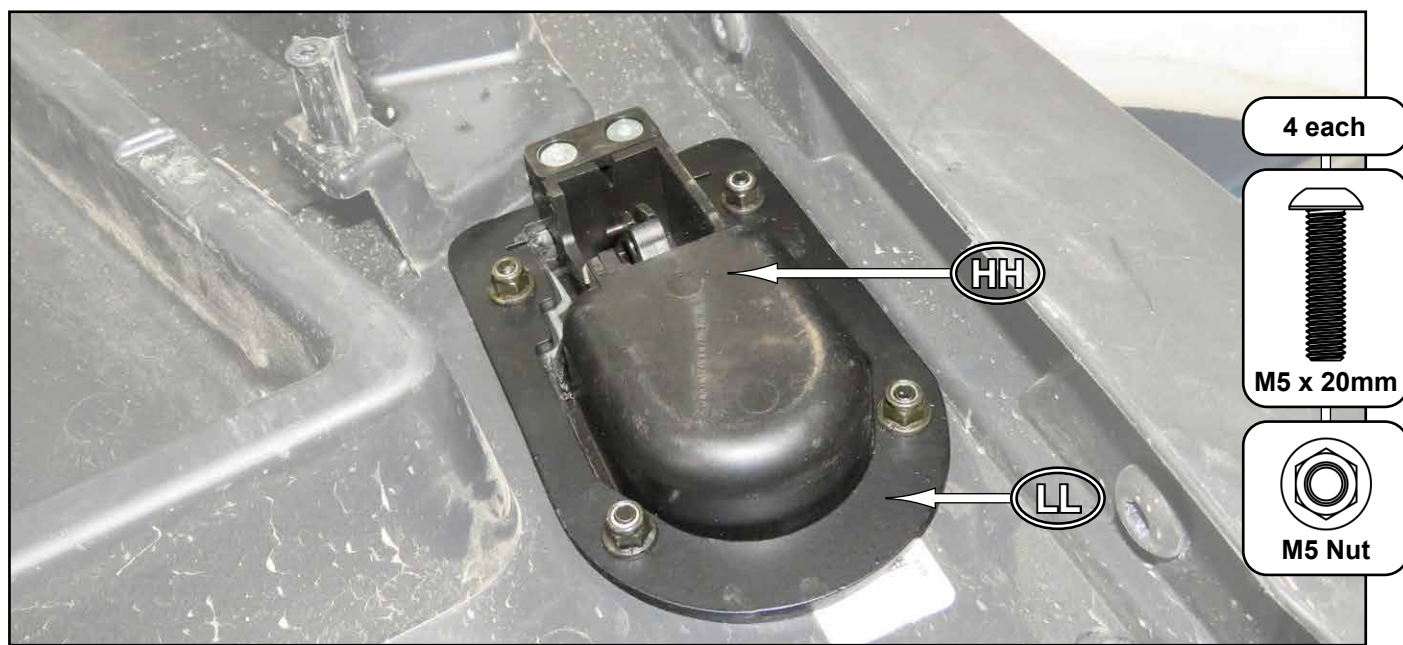

- Connect Cable (T3) to Handle (HH).

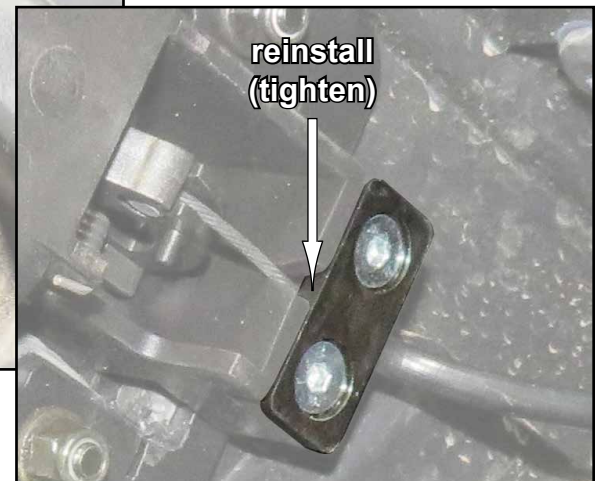
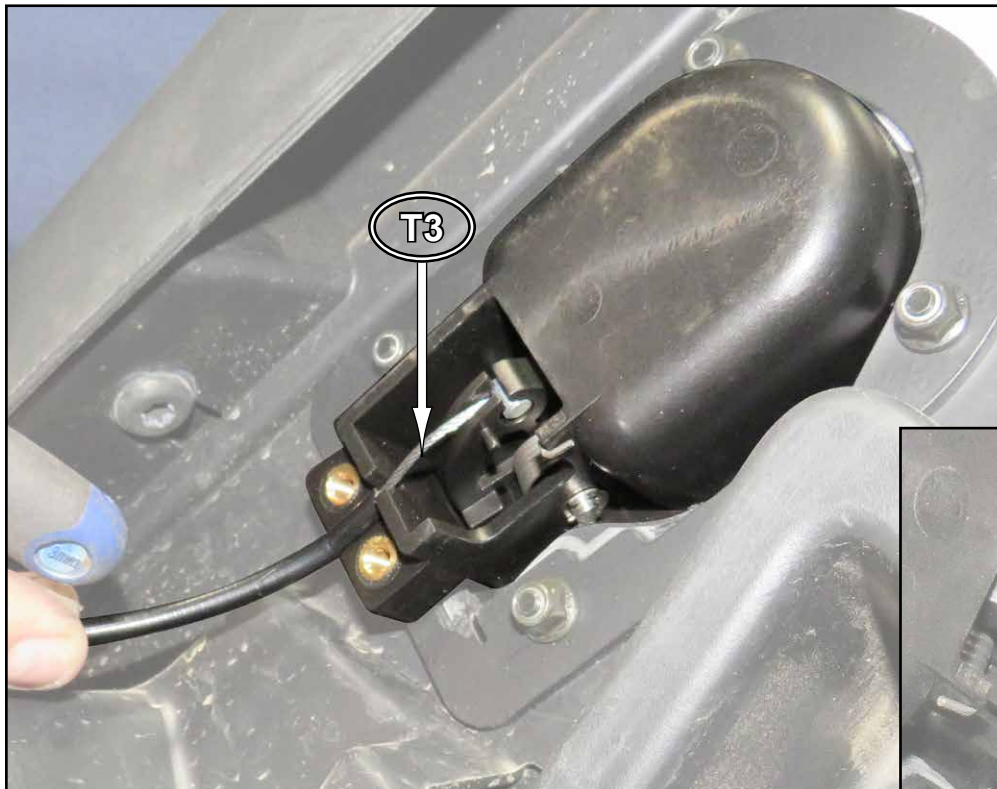
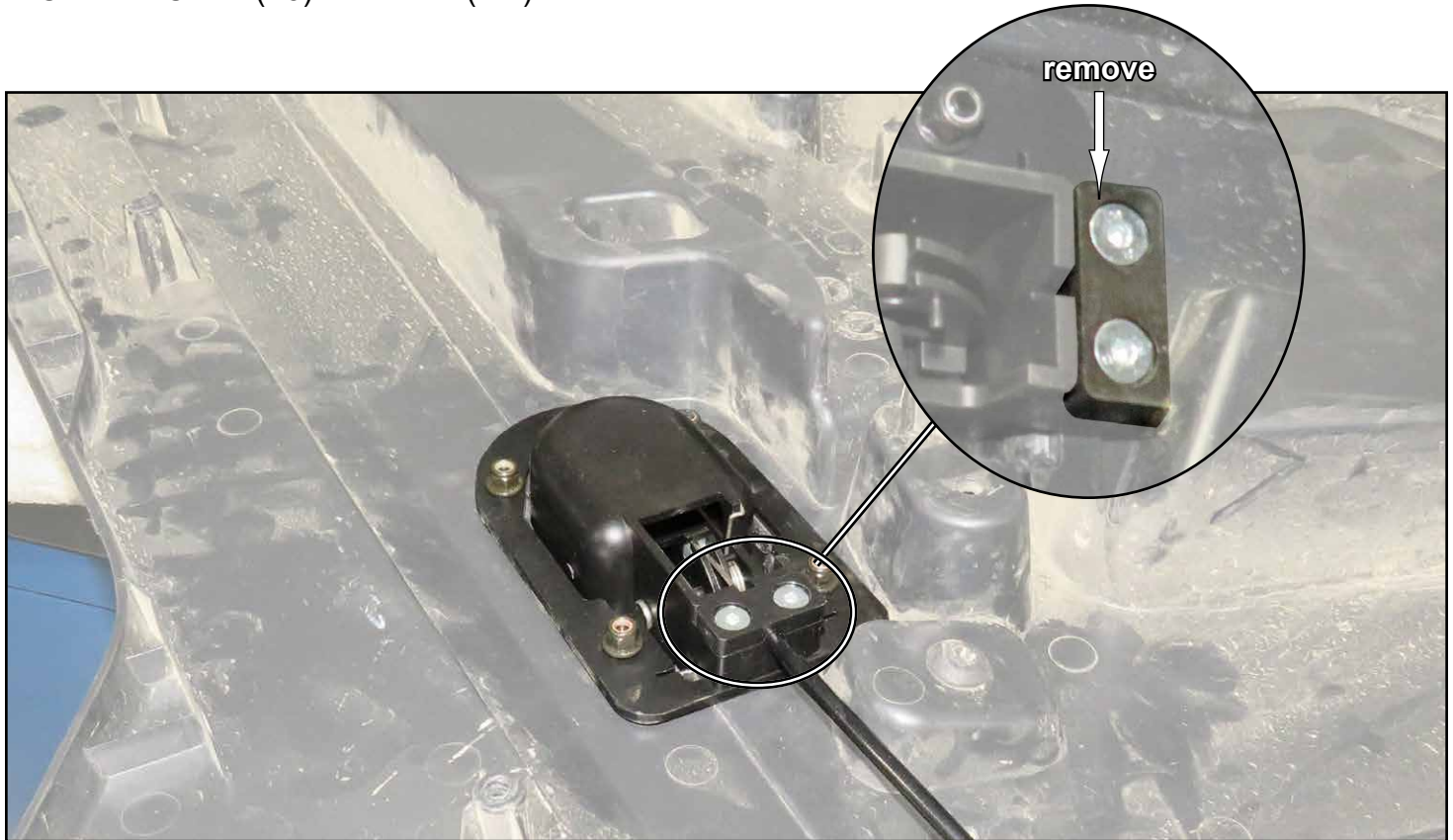

- Install Rear Mount 1 Plate - R (D3) and Rear Mount 2 Plate - R (C3).



- Secure with hardware shown. **Only tighten hardware shown.**
- Remaining hardware is used to locate Rear Mount Plates. Remove after securing Rear Mount Braces.

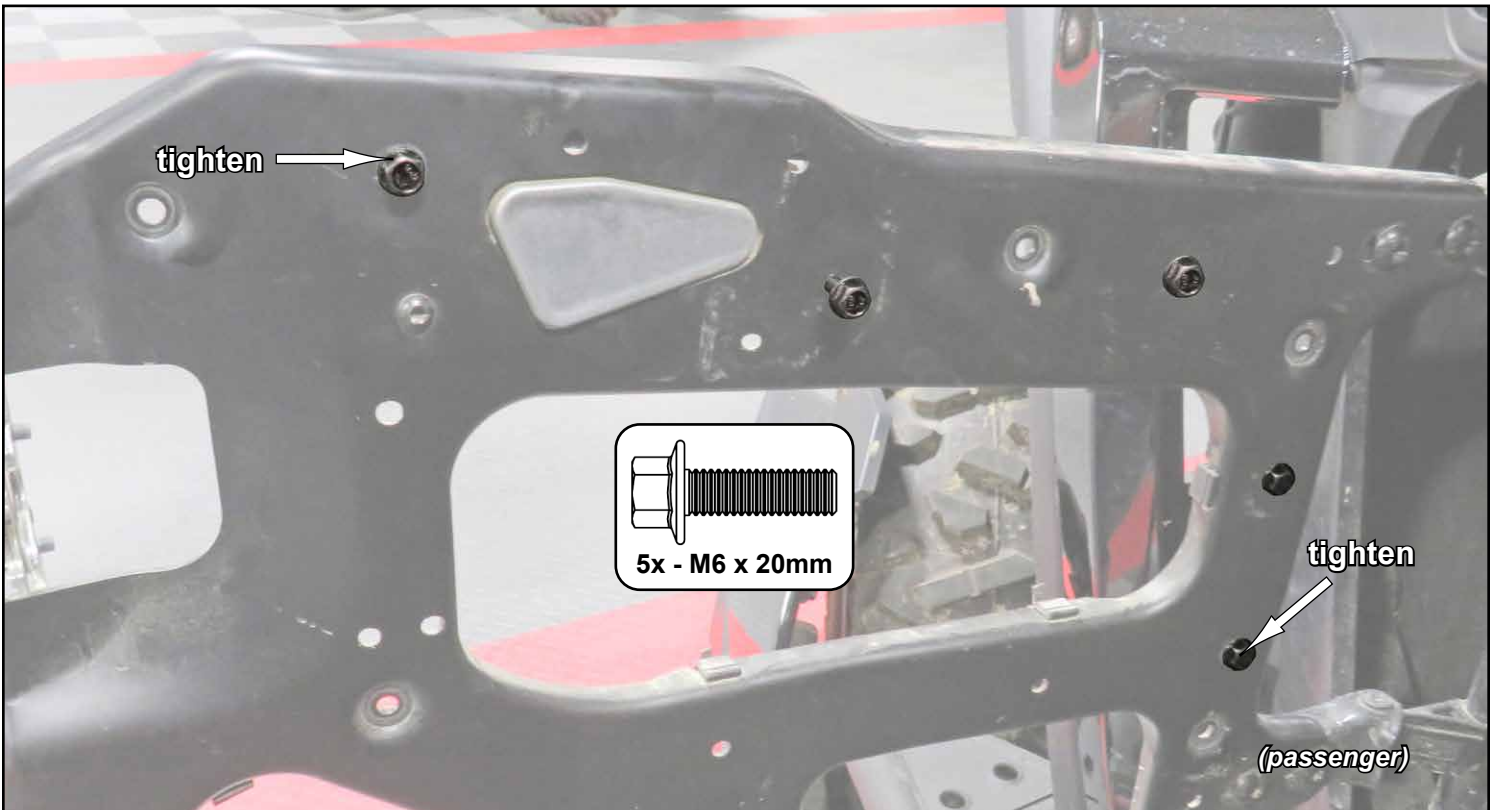

- Install Rear Mount 2 - R (M3) and Rear Mount 1 - R (L3) with hardware shown; tighten.

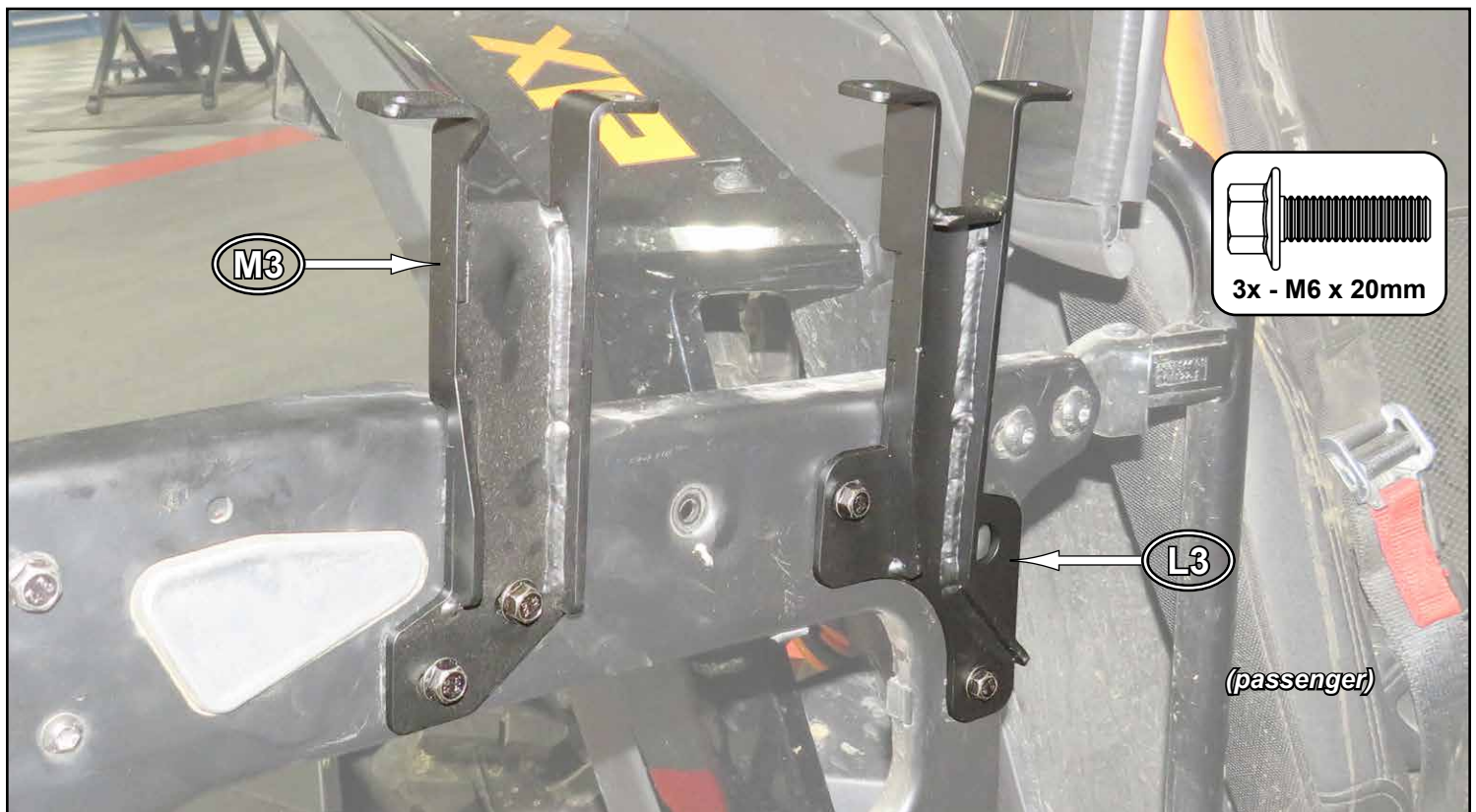

- Install Rear Cable Guide - R (R3) with hardware shown.

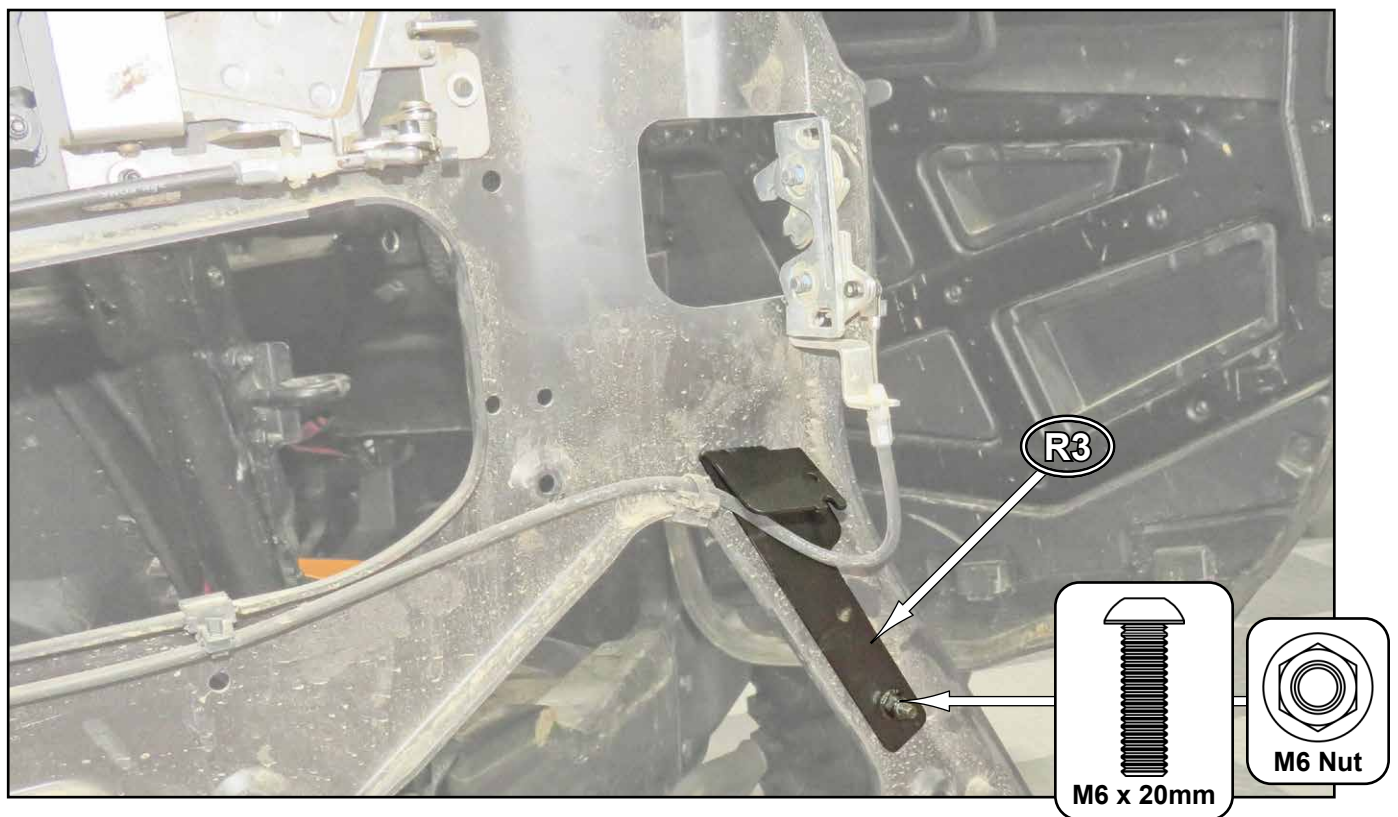

- Disconnect stock Cable.



- Install Rear Cable Latch - R (P3) with hardware shown; tighten.

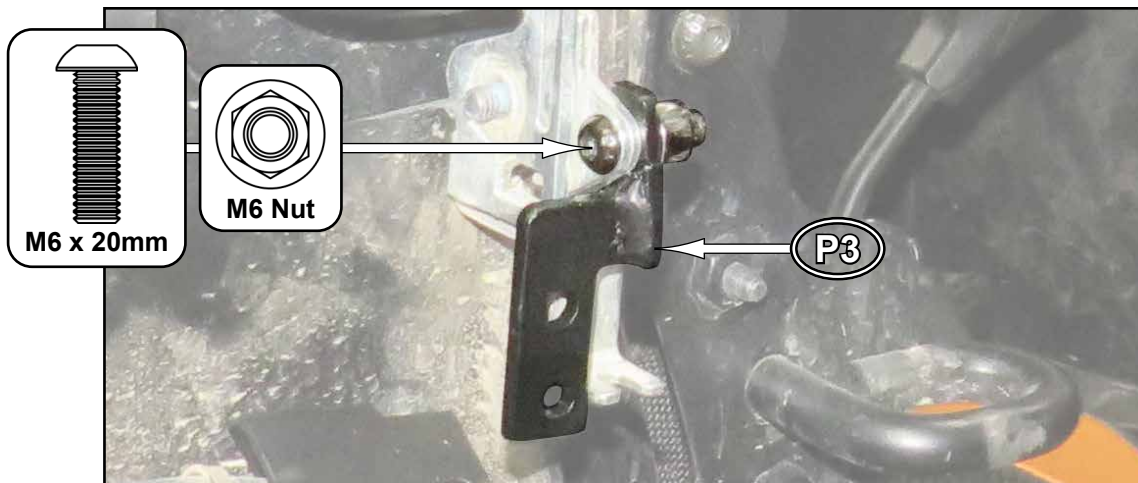

- Reconnect stock Cable to Rear Cable Guide - R (R3) and Rear Cable Latch - R (P3).

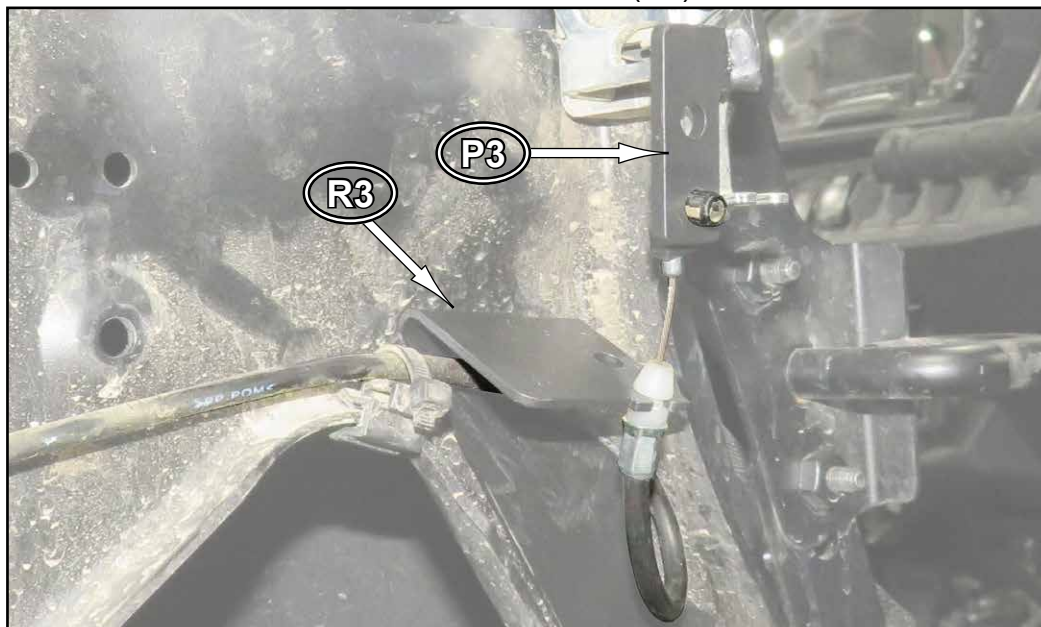

- Place Door Panel back onto machine as shown.



- Install Set Screw to Conduit (MM).

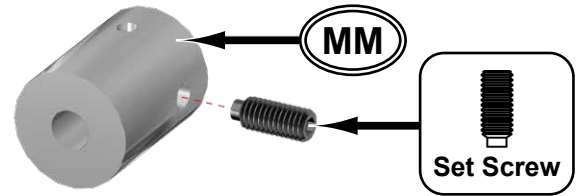

- Install Conduit (MM) to Rear Cable Latch - R (P3) with hardware shown; tighten.
- Install Cable (T3) into Conduit (MM) and secure to Cable Latch - R (P3).

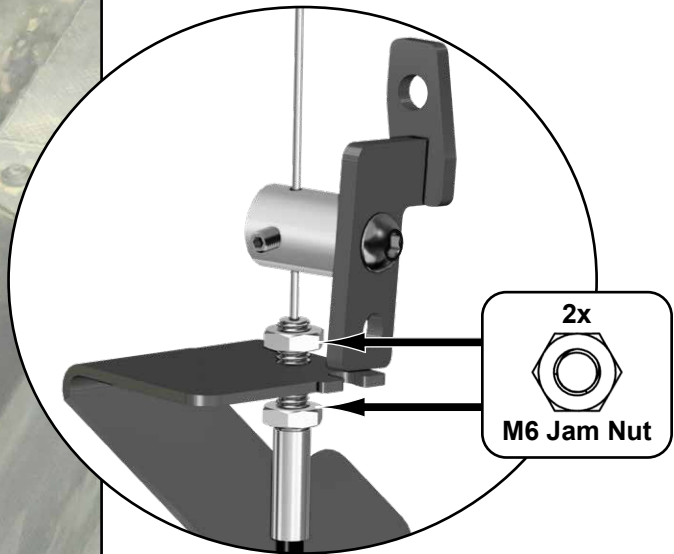
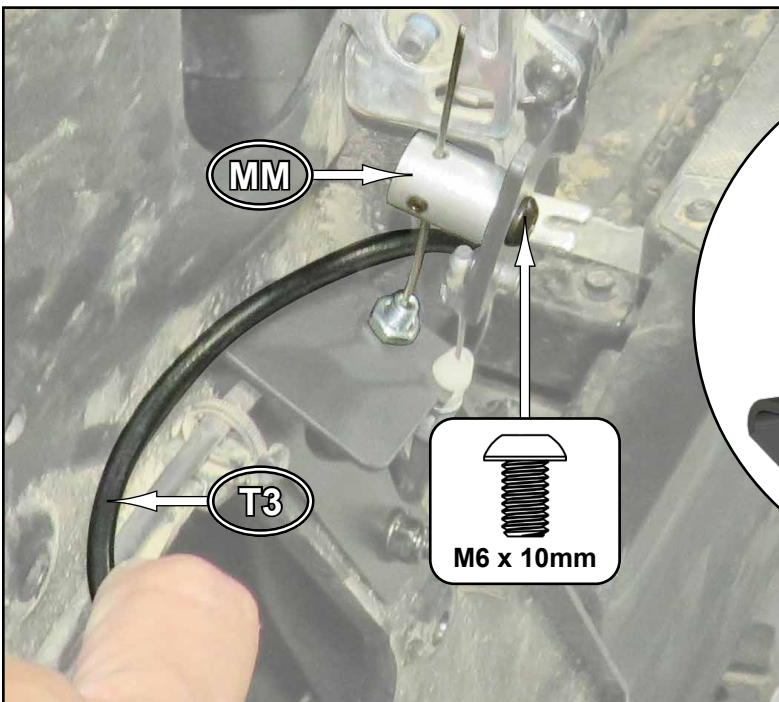

- Install Right Rear (TT) to Rear Mounts 1 and 2 with hardware shown.

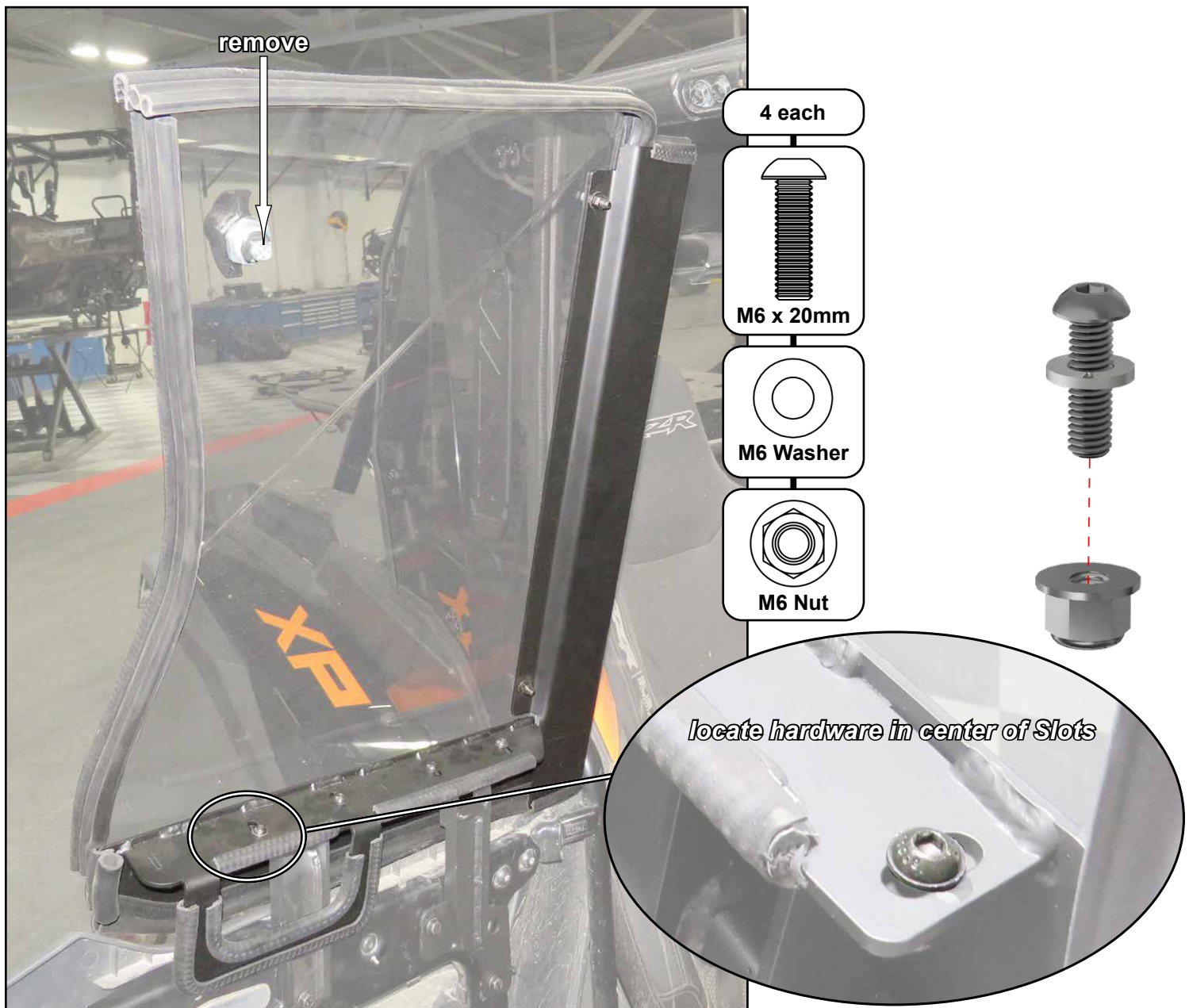

- Install Latch - R (Z) with previously removed hardware; tighten.



- Cut and install Seals to locations shown.

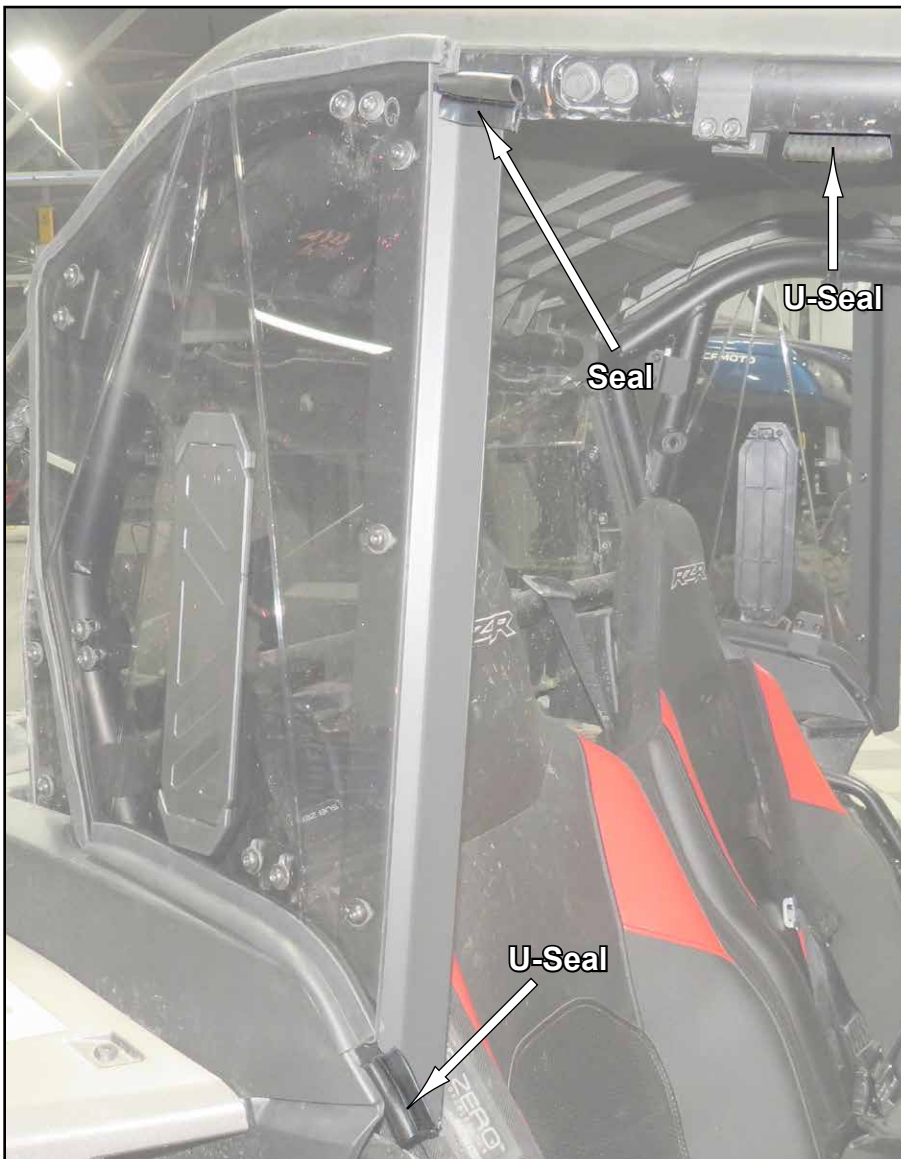

- Close Door, engage Latch, and align to machine. Tighten all hardware.

Repeat steps for driver side installation.