

INSTALLATION INSTRUCTIONS

FF-CA-DEF-001: Flat Fender Flares

- ⓘ Please look through and read these instructions BEFORE starting so you understand what processes you'll be doing, and possible extra tools you may need.
- ⓘ Do Not discard product packaging until installation is complete and functioning properly.

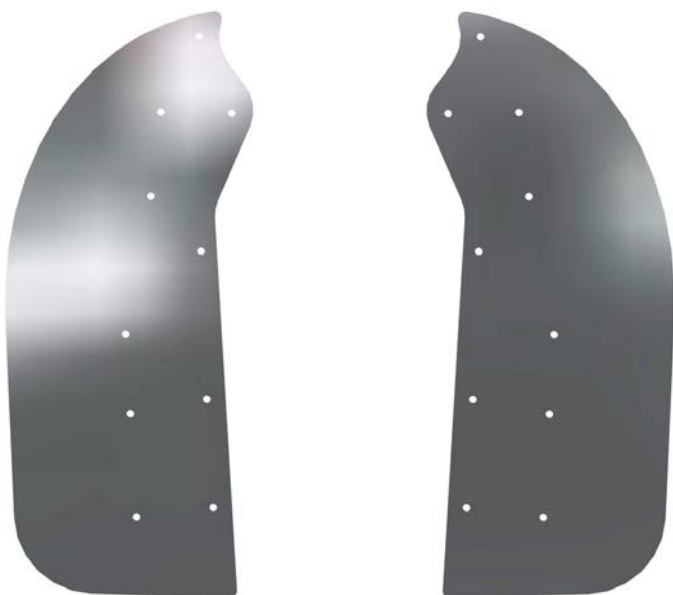

L & R Front Upper Flares

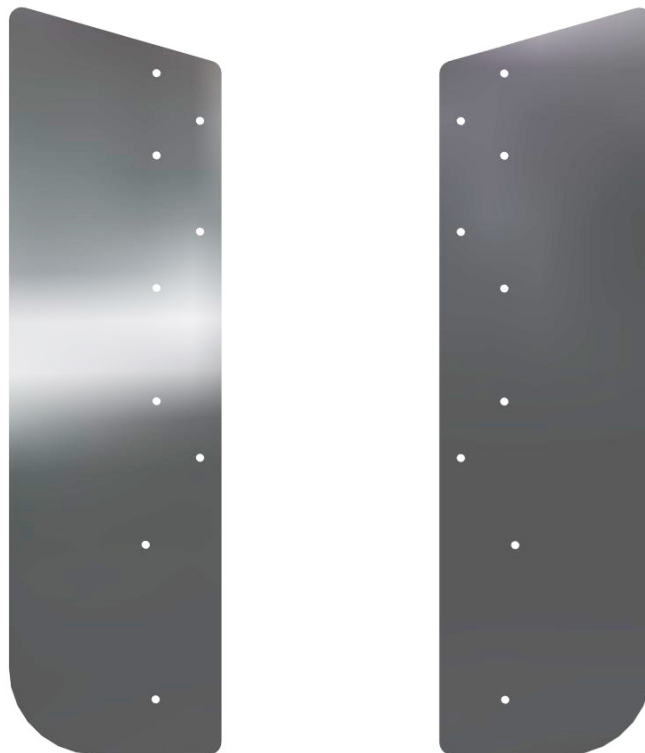

L & R Rear Upper Flares



**11/32"
High Speed
Bit
(1pc)**



**M8
Pry
Rivets
(54pcs)**

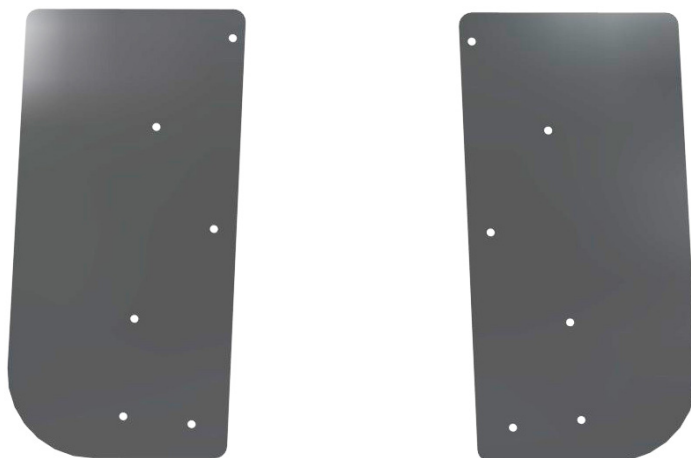

L & R Rear Lower Flares

NOTE: We will be working on the Passenger's Side of the vehicle for this installation.
The process is the same for the Driver's Side, so just repeat the step shown here.

1. The first thing you need to do is **Remove** the existing **Three (3) Factory Fender Screws** as shown in **Fig.1a**. You will **Reuse** the **Top Screw** on the new Fender Flare but will be using new **Pry Rivets** on the rest of the flare. See **Fig.1a**. Then you will Install the **Front Upper Flare** shown in **Fig.1b**.



Fig.1a



Fig.1b

2. Then starting with the bottom fender flare hole, attach using the **Pry Rivets** in your kit, and then the next one up also takes the Pry Rivet as shown in **Fig.2a**. Then **Reinstall** the **Factory Screw** you removed previously in the upper hole as shown in **Fig.2b**.



Fig.2a

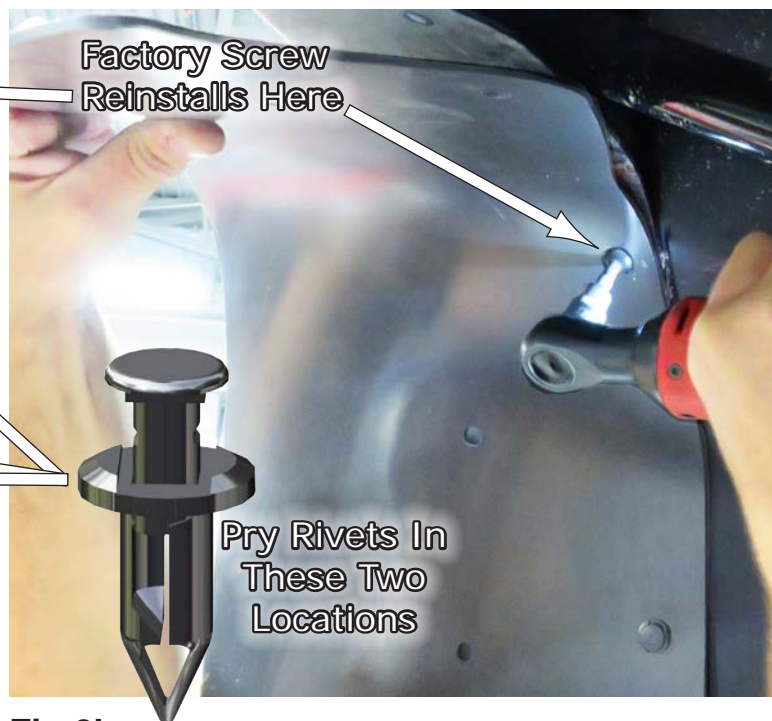

Fig.2b

3. Once you have the two rivets and factory screws installed, now you can start to mark some holes to drill. First we'll start with the front edge or tip of the Flare. In it's natural resting position you'll see it doesn't line up with the fender contour as shown in **Fig.3a**. So just pull it over to the fender lip matching the hole in the flare to somewhere in the middle of the fender lip. This is where you will mark the hole location with a marker or paint pen and drill thru to be able to install a fastener there. **Fig.3b** shows the flare pulled over to the fender lip and marking our location with a pen. And **Fig.3c** shows our location marked.

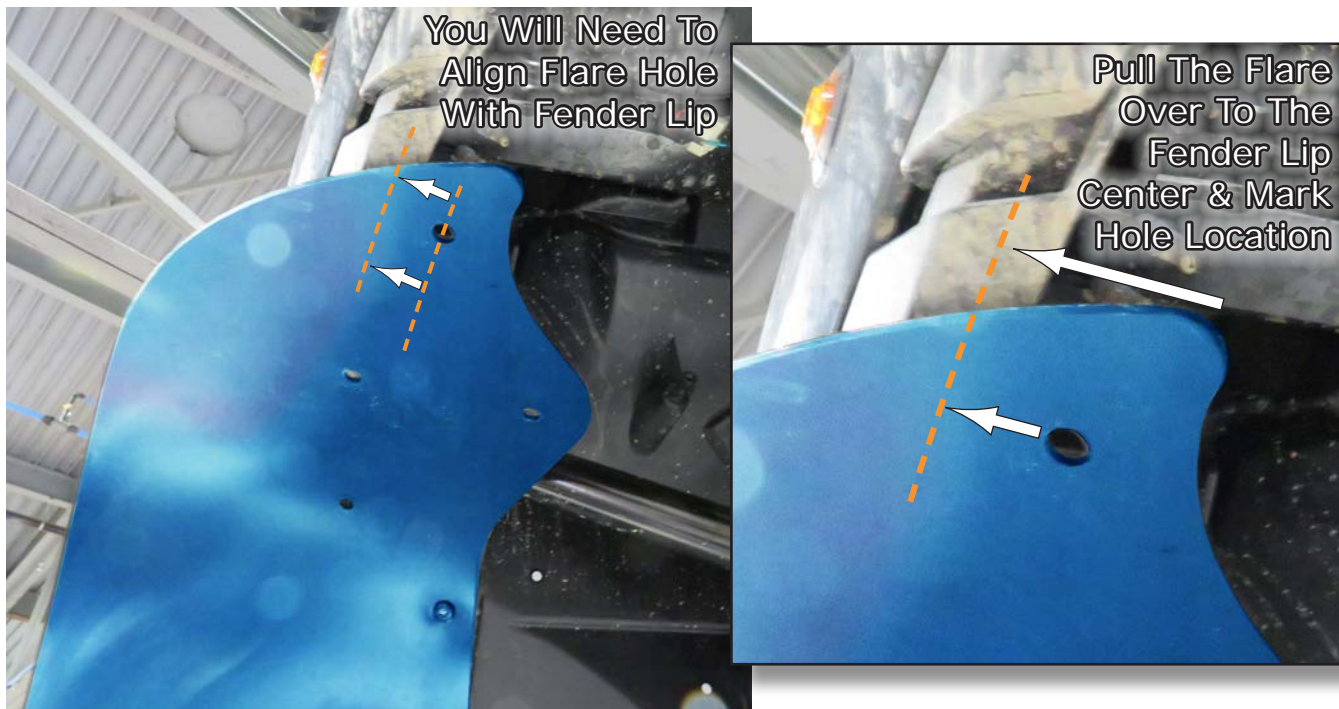

Fig.3a



Fig.3b

Fig.3c

4. Now **Drill** the **Marked Hole** location using the **11/32" Drill Bit** provided in your kit as shown in **Fig.4a**. Then insert one of the **Pry Rivots** from your kit to secure that hole location as shown in **Fig.4b**. Then **Mark** the **Remaining Holes** from the Flare to the machine and **Drill Those Out** as well. Then secure using the **Pry Rivets** provided in your kit. See **Fig.4c-e**.



Fig.4a



Fig.4b



Fig.4c



Fig.4d



Fig.4e



5.Next we will move to the Passenger's Side Rear wheel well to install the Two (2) pc Flares there. **Fig.5a** shows the area you will install them at. So first **Remove the Three (3) Factory Screws** along the top as shown in **Fig.5b**.

NOTE: You will reuse all factory screws for the rear installation and all pry rivets will be replaced by the new rivets provided in your kit.

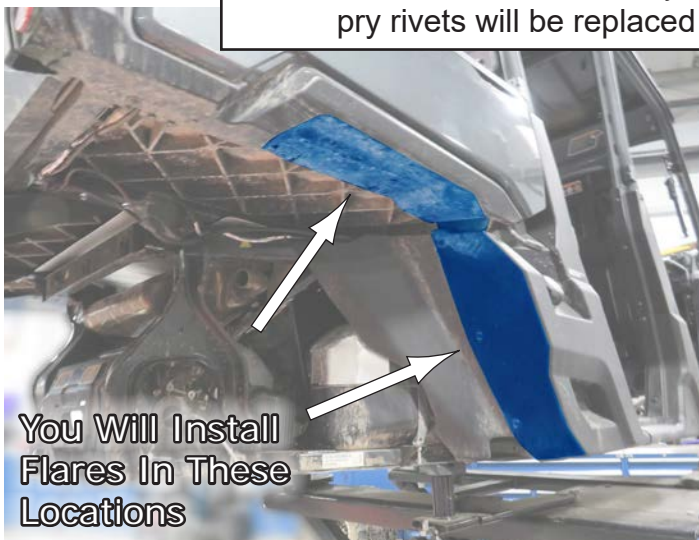

Fig.5a



Fig.5b

6. Then **Remove** the **Factory Pry Rivets** as shown in **Fig.6a**. Now take the **Rear Upper Flare** and **Insert** one of the **Factory Screws** you previously removed into the end hole of the flare as shown in **Fig.6b** and install it into the factory screw hole on the end as shown in **Fig.6c**. Then repeat for the remaining two (2) factory screws removed earlier as shown in **Fig.6d**.

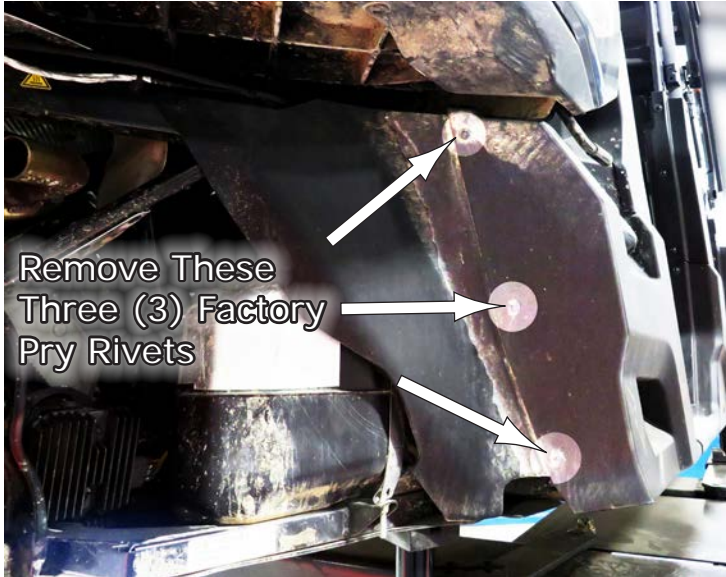

Fig.6a

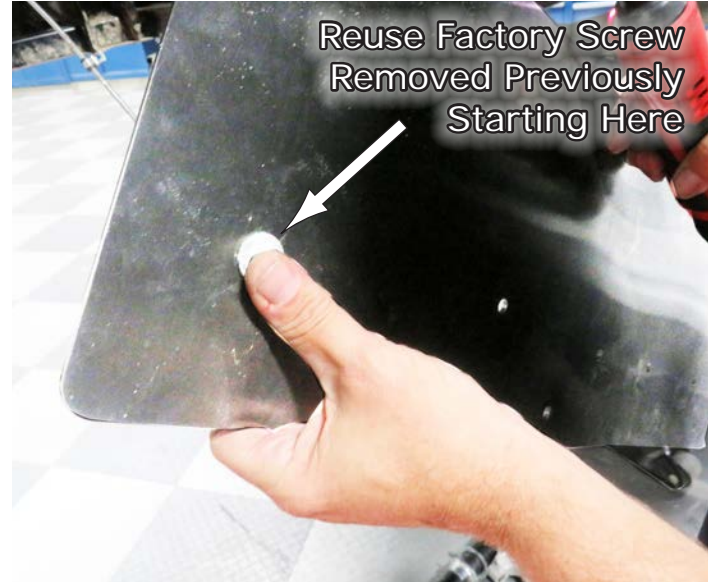

Fig.6b



Fig.6c



Fig.6d

7. Once the three screws are in place, now you will need to **Drill** out the **Remaining Holes** in the Flare. **Fig.7** shows the remaining drilling locations.



Fig.7

8. Then **Install New Pry Rivets** as shown in **Fig.8a-b**. Next we'll install the Rear Lower Flare.



Fig.8a



Fig.8b

9. Next, you will **Install the Rear Lower Flare** on this same Passenger's Side. First Install the Flare oriented as shown in **Fig.9a**, and align the holes in the flare to the holes in the machine and secure using the **New Pry Rivets** also shown in **Fig.9a**. Then **Drill the Remaining Holes** and also secure with **New Pry Rivets** as shown in **Fig.9b**.

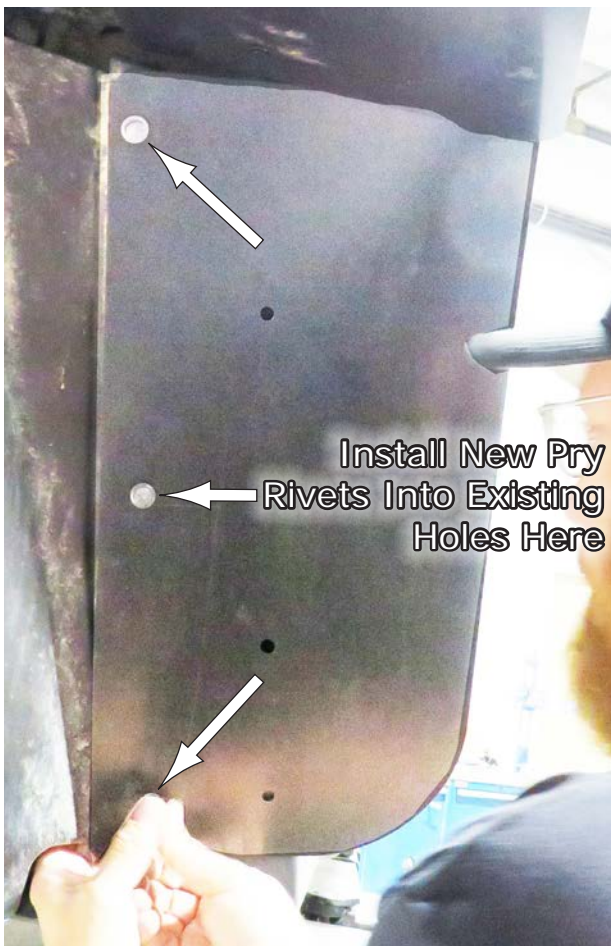

Fig.9a

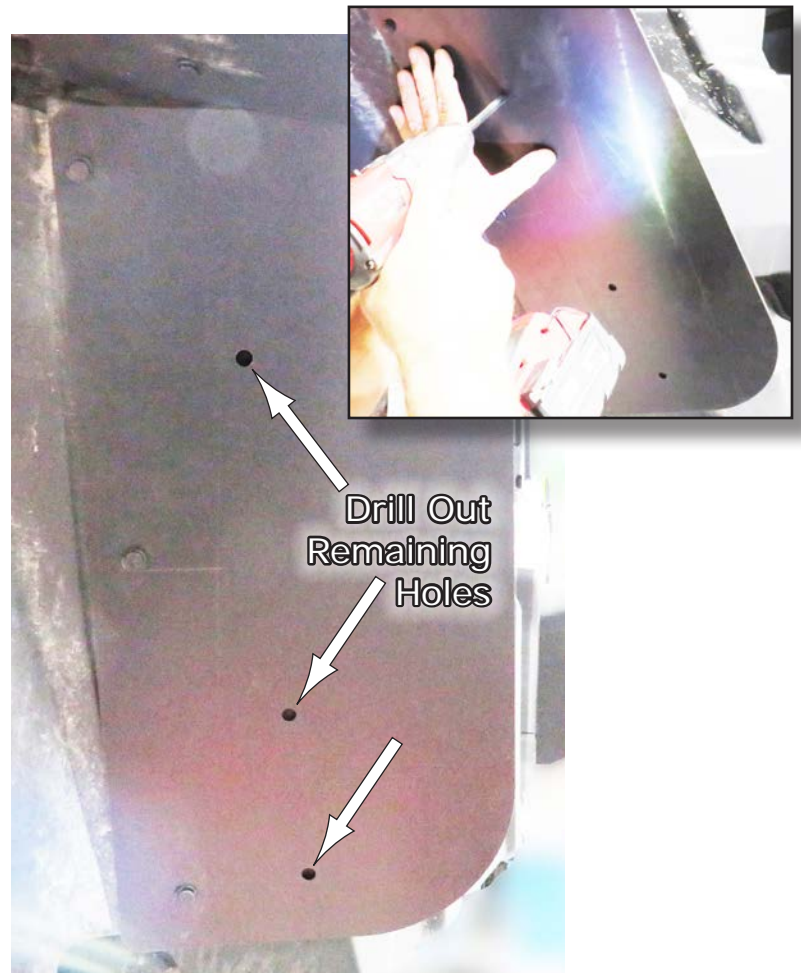

Fig.9b

10.Fig.10a shows the rivet in place completing the rear fender flares. **Fig.10b** also shows complete. Repeat these instructions fro the opposite side installation.



Fig.10a



Fig.10b

Liability Statement

SuperATV's® products are designed to best fit user's ATV/UTV under stock conditions. Adding, modifying, or fabricating any factory or aftermarket parts will void any warranty provided by SuperATV® and is not recommended. SuperATV's® products could interfere with other aftermarket accessories. If user has aftermarket products on machine, contact SuperATV® to verify that they will work together.

Although SuperATV® has thousands of satisfied customers, user should be aware that installing lift kits, long travel, or suspension kits, tires, etc. will change the ride of machine and may increase maintenance and part wear. Operating any off-road machine while, or after, consuming alcohol and/or drugs increases risk of bodily harm or death. No warranty or representation is made as to this product's ability to protect user from severe injury or death. SuperATV® urges operators and occupants to wear a helmet and appropriate riding gear at all times.

By purchasing and installing SuperATV® products, user agrees that should damages occur, SuperATV® will not be held responsible for loss of time, use, labor fees, replacement parts, or freight charges. SuperATV®, nor any 3rd party, will not be held responsible for any direct, indirect, incidental, special, or consequential damages that result from any product purchased from SuperATV®. The total liability of seller to user for all damages, losses, and causes of action, if any, shall not exceed the total purchase price paid for the product that gave rise to the claim.

SuperATV® will warranty only parts provided by SuperATV®. Any damage or problems with OEM housings, bearings, seals, or other manufacturers' products will not be covered by SuperATV®. SuperATV® parts and products are not warranted if item was not installed properly, misused, or modified.

Installing, adding, modifying, or fabricating any factory or aftermarket product to your ATV/UTV may violate certain local, state, and federal laws. Be advised that laws vary depending on town, city, county, state, etc. Use of certain products on public streets, roads, or highways may be in violation law. The Buyer is solely and exclusively legally and personally responsible for any violation of the law by the installation or use of the product. You must abide by all local, state, and federal laws, including but not limited to vehicle safety, traffic laws, and ordinances. It is your responsibility to know the laws and how they apply to you.

The Buyer is responsible to fully understand the capability and limitations of his/her vehicle according to manufacturer specifications, warnings and instructions and agrees to hold SuperATV® harmless from any damage resulting from failure to adhere to such specifications, warnings and/ or instructions. The Buyer is also responsible to obey all applicable federal, state, and local laws and ordinances when operating his/her vehicle while using this product, and the Buyer agrees to hold SuperATV® harmless from any violation thereof.

If you have any problems/questions on this kit, contact us by email at [Superatv.com](mailto:sales@superatv.com).

Need help with your installation?



sales@superatv.com



www.superatv.com



1-855-743-3427



8:00am - 9:00pm EST M-Th
8:00am - 7:00pm EST Friday
9:00am - 2:00pm EST Saturday

*Thank You
For Choosing*



Like SuperATV on Facebook to keep up to date on new products!