



INSTALL INSTRUCTIONS FOR 75-5176/75-5176D

[PRINT](#)

BEFORE YOU START

VEHICLE FITMENT: 2024+ Ford Ranger Raptor
3.0L V6

DEVICE NAME: COLD AIR INTAKE

This intake kit may not fit with the following aftermarket parts installed: Body Lift or Lowering Kit, Custom Hood.

REQUIRED TOOLS

10mm, T30 Torx Bit, Panel Clip Removal Tool or Flat Head Screwdriver, 8mm or 5/16" Nut Driver, Phillips Screwdriver, 1 Pair of Pliers or Vice Grip.

Note: Approximate Install Time: 1 hour



Hi. Need any help?



Cookie Preferences

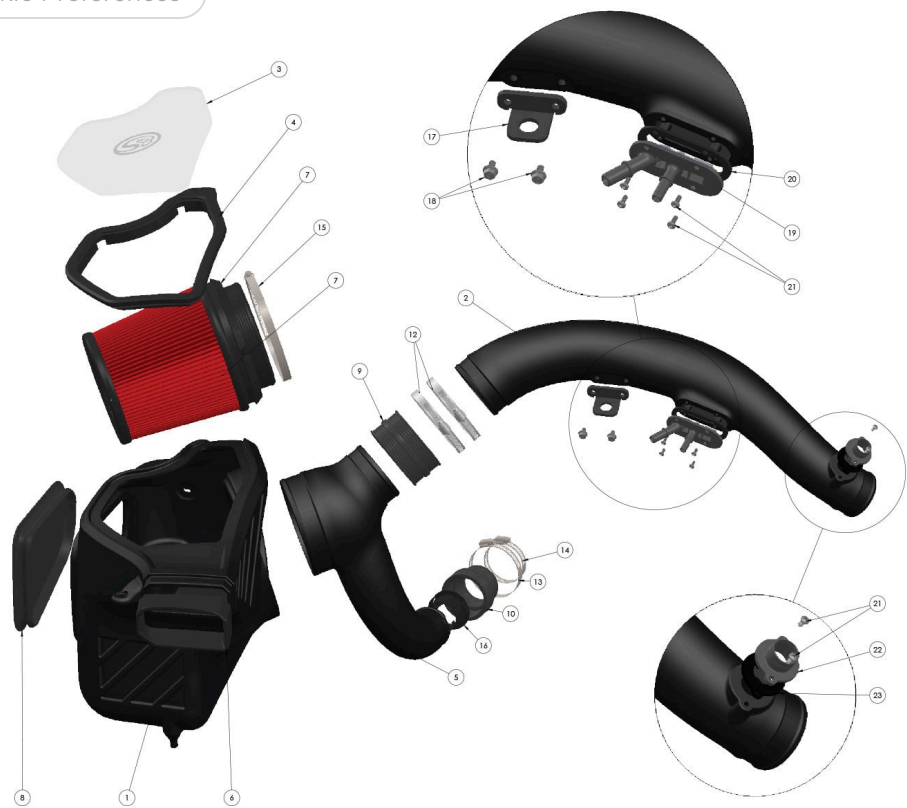

ITEM NO.	PART NUMBER	DESCRIPTION	QTY.
1	AI1498B-00	Air Box (Ranger Raptor)	1
2	AI1499-00-Tube	Intake Tube	1
3	AI3522-00	Clear Lid	1
4	AI3521C-00	Snap-In Lid Seal	1
5	AI1500-00-TUBE-Y	Intake Tube Y	1
6	AI3520C-00	Silicone Scoop	1
7	KF-1087	Filter, 6.0" ID	1
8	AI1957C-00	Air Box Plug	1
9	AI1129C-00	Straight Coupler, 3.75" ID x 2.0" Long, Silicone, Comp. Molded (2 cav.)	1
10	AI2933C-00	Step Coupler, Hump, 2.5" x 1.5" x 1.25" long	1
11	AI1948c-00	Grommet	1
12	AG1018-00	Hose Clamp, #64	2
13	AG1006-00	Hose Clamp, #44	1
14	AG1003-00	Hose Clamp, #32	1
15	AG1026-00	Hose Clamp, #96	1
16	AI2970-00	Anti-Ring Insert	1
17	AI344P-01	Mounting Bracket, Intake Tube, 75-5176	1
18	AI2452-00	Hex Flange Bolt, Steel, Zinc Pltd	2
19	AI2635-00	Dual Quick Connect, Assembly	1
20	AI2639-00	Gasket, for Quick Connect Assembly - AI2635-00	1
21	AI1639-00	Pan Head Philips Machine Screw, #8-32 x 3/8" Long, 18-8 SS	6
22	AI2787-00	Adapter, Bypass Valve	1
23	AI2838-00	Gasket, for Adapter, Bypass Valve	1

STEP 1

Disconnect the negative battery cable by loosening the negative terminal and removing it from the battery post.

Tip: You will need a 10mm Wrench or Socket.

DO NOT SKIP THIS STEP!



STEP 2

Disconnect the blowoff hose from the intake tube by squeezing the tabs at the bottom of the connector.



STEP 3

Disconnect the 2 PCV hoses from the intake tube.

For the yellow tab connector, press on the button located on the bottom, then pull.

For the orange tab connector, pull down on the orange safety clip then press down on the grey tab. Once done, pull the connector off.

STEP 4

Disconnect the temp sensor from the intake tube.

STEP 5A

Loosen the two hose clamps on the intake tube. One located on the drivers side and the other ([Step 5b](#)) next to the air box.

Tip: Use a flat head screwdriver or a 7mm socket.

STEP 5B

STEP 6

Remove the bolt holding the intake tube down.

Tip: You'll need an 8mm or 5/16 socket.

STEP 7

Now you can remove the stock intake tube.

STEP 8

Remove the screw holding the air scoop.

Tip: You will need a flat head screwdriver or a T30 Torx bit.

STEP 9

Remove the 2x clips holding the Temp Sensor wiring harness to the air box.

Tip: You'll need a body panel clip removal tool or a flat head screwdriver.

STEP 10

Loosen the hose clamps from the air box end of the turbo intake tube.

Tip: You will need an 8mm or 5/16 socket.

STEP 11

Remove the air box and air scoop assembly.

STEP 12

Remove the tube from the Turbo inlet side by using a set of needle nose pliers or vice grips to expand the ring holding the tube.

STEP 13

Install the vortex tube insert into the smaller Y-intake tube.

STEP 14

Install the temp sensor grommet into the small y-intake tube.

STEP 15

Remove the hat washer and grommet from the stock intake tube.

STEP 16

Install the stock grommet and hat washer (from the stock

[Cookie Preferences](#) tube) on the Mounting
Bracket (17).

**Tip: Install the hat washer
from the bottom of the
bracket.**

STEP 17A

Next, mount the bracket from
the previous step onto the
large intake tube and tighten
bolts till they are snug.

**Tip: Use the 10mm screws
provided.**

STEP 17B

Here is the bracket orientation when installed.

STEP 18

Install the blowoff valve connector to the longer intake tube.

Tip: The placement order goes connector, gasket, tube as seen in the image to the right. Once done, tighten down with the provided longer screws.

STEP 19

Install the PCV hose connector with corresponding gasket to the long intake tube.

STEP 20

Install the cuppler down at the turbo, with the smaller diameter end going onto the turbo's inlet. Once installed, tighten the hose clamp that is closest to the turbo and leave the other one loose.

Tip: We recommend orientating the clamps to a position where it will be easy to access.

STEP 21A

Install the air filter into the air box and pull on the base of the filter to snap it into the air box.

Tip: We recommend installing it vertically while compressing the sides of the filter to make it fit inside the box. Once inside, rotate the air filter to lay it in the box.

STEP 21B

STEP 22

Install the silicone air scoop on the front of the air box.

STEP 23

Install the air box plug. You must install this air box plug if your vehicle is a 2025 or newer. The air box plug is optional on 2024 trucks. You will get a P2C90 code and check engine light on a 2025+ truck if the air box plug is not installed.

Tip: We recommend doing this if you live in a hot/dusty area.

STEP 24

Install the air box into the stock location.

Tip: Line up the prongs on the bottom of the air box with the stock grommets on the wheel-well and push down to install.

STEP 25

Install the air scoop assembly.

Tip: You will need a flat head screw driver or a T30 Torx bit.

STEP 26

Remove the temp sensor from the stock intake tube.

[Cookie Preferences](#)

remove, lift the sensor above the lip of the socket and turn counter-clockwise then pull out.

STEP 27

Install the temp sensor into the grommet on the small intake tube.

Tip: There is an arrow on the grommet showing you which way to turn the sensor. At the end of that arrow is a raised lip (green arrow). Push down and turn the sensor until it gets passed that lip.

STEP 28

Install the small intake tube assembly to the air box and turbo on the passenger side.

Tip: Once installed, tighten both the turbo and air filter hose clamps.

STEP 29

Install the long intake tube.

Tip: We recommend pre-installing the cuppler and clamps onto the air box side of the intake tube.

STEP 30

Once the intake tube is installed into the driver side

[Cookie Preferences](#), now it's time to
connect it to the air box.

Tip: Go ahead and tighten the hose clamps in the air filter side first, then work your way down to the driver side.

STEP 31

Re-install the OE bolt to the grommet on the long intake tube's L-bracket.

Tip: You'll need an 8mm or 5/16 socket.

STEP 32

Install both PCV hoses and the blowoff valve back onto the intake tube.

Tip: Once connected, make sure the locking tabs are back in place to prevent them from popping off.

STEP 33A

Re-connect your temp sensor
and clip it's wiring harness
onto the S&B air box.

STEP 33B

STEP 34

Remove the protective film from you air box window. Once done, install the window into the provided snap-in lid seal.

STEP 35

Install the snap-in lid onto the air box.

STEP 36

Re-install the negative battery terminal.

Tip: You will need a 10mm socket or wrench.

Your installation is now complete. Double check that all your connection points are tightened & secure.

Cookie Preferences