

*FREE SHIPPING ON ORDERS OVER \$98 (EXCLUSIONS APPLY)



SHOP CATEGORIES

WHY S&B

SHOP BY VEHICLE



0

INSTALL INSTRUCTIONS FOR 10-1031



PRINT

BEFORE YOU START

- Please read the entire product guide before proceeding
- Ensure all parts are present.
- If you are missing any parts, please call or text us at (909)-675-1313
- Do not work on your vehicle while the underbody components are hot.
- Make sure the vehicle is in park or the parking brake is set if you plan on working on the ground. If working on a lift, make sure the vehicle is lifted safely and securely.
- Disconnect and isolate both of the negative battery cables
- Before installing S&B Tank, conduct pressure test to ensure o'ring is properly seated.
- Auxiliary Fuel Tanks will void the Lifetime Warranty.

DIESEL FUEL ONLY

REQUIRED TOOLS

- Flathead Screwdriver or 5/16" Nut Driver
- Mallet/Hammer
- 11mm Socket
- 3/4" Socket
- Ratchet
- 12" Driver Extension

[Cookie Preferences](#)

Hi. Need any help?



S&B Sprinter Tank: How The Gauge Works



[Cookie Preferences](#)

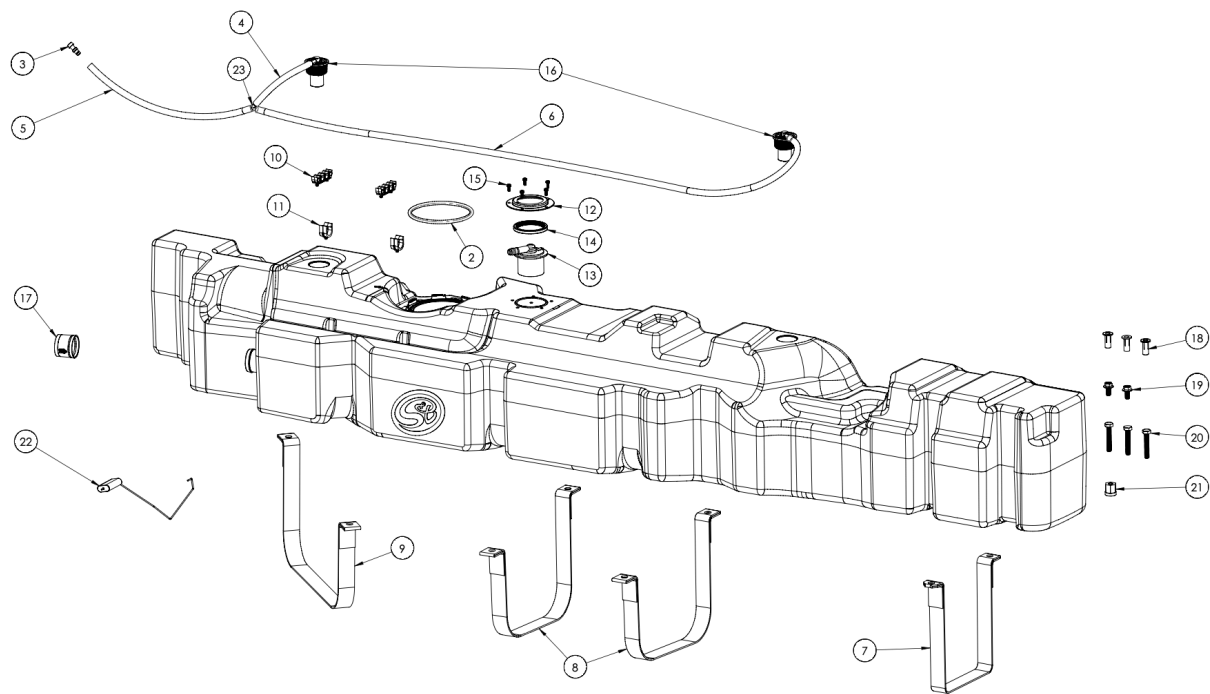

ITEM NO.	PART NUMBER	DESCRIPTION	QTY.
1	10-1031	HIGH CAPACITY REPLACEMENT TANK	1
2	TI1094C-00	O-RING, 8mm CS, NBR, 50 DURO	1
3	TI1141-00	ROLLOVER VENT CAP	1
4	TI1149-06	FUEL HOSE, 5/16" x 6", BK	1
5	TI1149-40	FUEL HOSE, 5/16" x 40", BK	1
6	TI1149-53	FUEL HOSE, 5/16" x 53", BK	1
7	TI1213-00	REAR STRAP FOR 10-1025	1
8	TI1214-00	MIDDLE STRAP FOR 10-1025	2
9	TI1216-00	FRONT STRAP FOR 10-1025	1
10	TI1217-00	FUEL LINE HOLDER (4 LINES)	2
11	TI1218-00	FUEL LINE HOLDER (1 LINE)	2
12	TI1219-00	FLVV METAL RING	1
13	TI1220-00	FILL LIMIT VENTING VALVE	1
14	TI1223-00	FLVV GASKET	1
15	TI1225-00	SCREW, 10-24 x 3/8"	5
16	TI1226-00	OE STYLE ROLLOVER VENT	2
17	TI1237-00	2" INLET CHECK VALVE	1
18	TI1245-00	M10x1.50 Plus Nut	3
19	TI1246-00	M10 x 1.50mm, 20mm LONG SCREW	2
20	TI1247-00	M10 X 1.50mm .60mm LONG	3
21	TI1248-00	PLUS NUT INSTALLING TOOL	1
22	TI1383-00	Fuel Float Rod for Sprinter Fuel Tank	1
23	TI1388-00	"Y" HOSE BARB CONNECTOR, 5/16" ID	1

IMPORTANT NOTE 1

Please check to make sure your van has the lateral crossmember behind the original tank. The image in the step below shows what it would look like if you van didn't have the crossmember



IMPORTANT NOTE 2

No lateral crossmember behind fuel tank

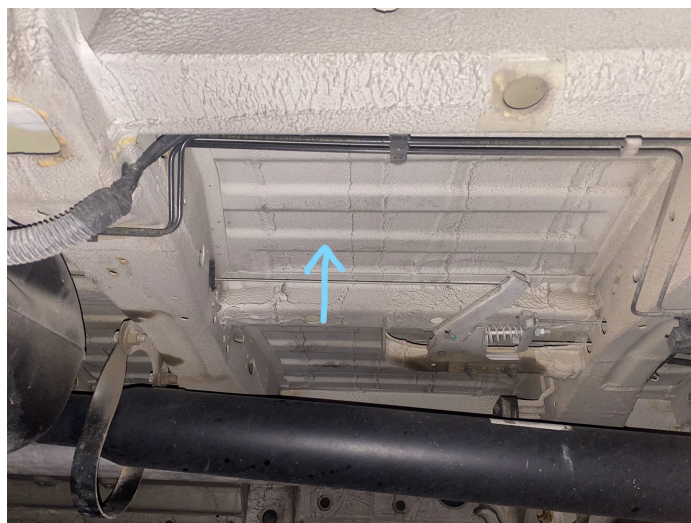

STEP 1

Inspect the underside of the Vehicle for any obstructions. The S&B Tank extends further forward and further back, please make sure there is not anything mounted that will interfere with the tank

STEP 2

Remove the filler door cover with a T30 Torx

STEP 3

Close the metal door then swing it back open with the plastic door to remove the plastic door.

STEP 4

Create a loop around the square hole

STEP 5

Fish the included 40" of 5/16" black down down the space next to the filler. The end with the white/green dust cap should be the backside of the metal plate. If it's not zip tied to

[Cookie Preferences](#)

the backside of the plate, it will interfere with the plastic filler door. If you need help with this step, please see minute 3 of our install video in the link below.

<https://www.youtube.com/watch?v=wq5jHfJgwcc>

STEP 6

Reinstall the plastic filler door and diesel fuel cap

STEP 7

Remove the Styrofoam cover and pull the end of the 5/16" through. This end will be connected to the T fitting on the hose attached to the S&B Tank

[Cookie Preferences](#)

STEP 8

Loosen the hose clamp attaching the rubber hose to the plastic filler. There is a check valve inside of the tank so fuel from the tank will not come out through the hose but there will be fuel trapped in the filler. Slightly remove the hose from the plastic filler so fuel trickles out into a bucket. There may be up to a gallon of fuel that comes out. To make a future step easier, you can also loosen the hose clamp on the tank side of the hose.

STEP 9

Slide the safety lock out on the blue and white connectors and disconnect the fuel lines. If you need help disconnecting these, please see 5:30 of the install

[Cookie Preferences](#)

video below. If you can have a aux fuel tap connected to a heater, please remove this connection as well.

<https://www.youtube.com/watch?v=wq5jHfJgwcc>

STEP 10

Depress the tab on the electrical connector and remove the connector

STEP 11

Cookie Preferences

with a 1/4" socket, remove the 3 tank straps. Support the

tank with a jack or ratchet straps during this step. You do not need to drill or open up any holes for these plus nuts. Insert, the the plus nuts into the crossmember holes.

STEP 12

With the included steel tool and long bolt. Hand tighten the bolt with the steel piece in between the plus nut and bolt.

STEP 13

With pressure applied up on the plus nut hold the steel piece with a 7/8" open end and tighten the bolt with a 17mm socket until the plus nut is completely opened

[Cookie Preferences](#)

up and "activated". Then remove the bolt and repeat the steps with the other plus nut. It helps to have someone help the wrench while ratcheting in the bolt. We included an extra plus nut just incase one doesn't get installed correctly.

STEP 14

Either with a special fuel locking ring tool or a dead blow and pry bar, rotate the locking ring counterclockwise to remove the fuel pump. Pop out the fuel lines and electrical line from the holder on the OEM tank and remove the fuel pump from the tank. Pour out the fuel from the bucket into the OEM tank and be careful to not damage the fuel float when removing. This tool can be purchased on Amazon or your local auto parts store by searching "Universal Fuel Tank Lock Ring Tool Fuel Sender Tank"

STEP 15A

Place the S&B oring into the oring groove and rotate the ring clockwise until it passes under the ring indentation.

Snap in the fuel lines and electrical connector into the fuel line holders on the S&B Tank.

STEP 15B

Remove the 5 bolts holding down the main vent and remove the vent so you can see inside.

STEP 15C

Use a flash light or take a picture in the tank to make sure there is separation between the float and venturi tube.

STEP 15D

This is what it looks like if the sending unit is installed incorrectly and the tube is hitting the float. This would lead to the gauge getting stuck and the gauge eventually falling and not moving from empty.

STEP 16

Transfer over the main vent line from the OEM tank to the S&B Tank.

STEP 17

[Cookie Preferences](#)

Remove the filler hose from the OEM tank. Before installing the filler onto the S&B Tank, insert the included check valve into the filler with the arrow facing the tank.

STEP 18

Now the S&B Tank is ready to be installed. Use a lift or straps to lift the tank into place. Before the S&B Tank is all the way installed, push the 5/16" hose that's coming from the filler door onto the T fitting on the S&B Tank. Make sure this line does not get pinched when the S&B Tank is fully in place.

STEP 19

Cookie Preferences

Starting with the rear strap, install all 4 S&B Tank straps. The rear strap will use the included gold bolts and the other 3 straps will use the OEM bolts.

STEP 20

Reconnect the blue/white fuel lines and electrical connector. After connecting the fuel lines and locking them, gently tug on them to make sure they are fully connected.

STEP 21

Reinstall the Styrofoam cover and cut out a small section on the top so the 5/16" hose can go through. Reconnect the fuel filter hose.

[Cookie Preferences](#)

STEP 22 CHECKLIST

This final checklist is very important.

#1 Make sure all nuts are safely fastened and torqued.

#2 Ensure there is proper driveshaft clearance and the straps are tight

#3 Double check fuel line connections, the electrical connection as well as the vent and fill lines.

#4 Lastly, fill the tank full and check for any leaks. If you have any questions, call or text us at 909.675.1313

Cookie Preferences

Cookie Preferences