



**baja designs**<sup>®</sup>  
THE SCIENTISTS OF LIGHTING

## 25-On Toyota 4Runner TRD Pro Replacement Kit (44-8293, 44-8294)



2950 Norman Strasse • San Marcos • CA • 92069

Phone 760-560-2252 X3 • Fax 760-560-0383

info@bajadesigns.com • [www.bajadesigns.com](http://www.bajadesigns.com)



**baja designs**<sup>®</sup>  
THE SCIENTISTS OF LIGHTING

## LIMITED LIFETIME WARRANTY

Baja Designs proudly offers a LIFETIME WARRANTY against manufacturer's defect on all the products that we manufacture.

These are comprehensive warranties; other than the exclusions below – you're covered. If your LED or HID bulb burns out, you're covered. Additionally, cutting off our connector or changing your lenses does not automatically void your warranty.

### **Exclusions:**

Installation errors, abuse, misuse or crash damage. You must be the original owner of the product and can supply proof of purchase.

Baja Designs manufactures its own products as well as resells products manufactured by others. Baja Designs makes no express or implied warranties on products not manufactured by Baja Designs including without limitation any warranties or merchantability and fitness for a purpose. We will, however, pass on all warranties made by the manufacturer, who has sole responsibility for performing such warranties.

Baja Designs will pay the freight if your product is less than 90 days old, otherwise defective products must be returned to Baja Designs, Inc., freight prepaid. At our option, we will repair or replace items in question and return them at no charge. If the identical product is no longer available, we will replace with a similar product of equal value. Baja Designs Inc. will not be responsible for any indirect or consequential damages in connection with defective merchandise.

Items purchased through a Baja Designs authorized dealer must be returned through the dealer. Only available on LED auxiliary lights and product must be in sellable condition at MSRP. Product that has been damaged in any way after the original purchase date will be excluded from this guarantee.

### **Indemnification:**

**Buyer hereby acknowledges off-roading, racing and driving at night are dangerous activities and that the products and/or supplies purchased from Baja Designs are used in an inherently dangerous activity that may endanger life and limb; and in no event shall the seller, or seller's heirs and assigns, be held liable for consequential damages, nor shall seller's liability on any claim for damages arising out of or connected with the sale, delivery, or use of purchased products and/or supplies exceed the purchase price of the products and/or supplies.**

**Buyer is responsible for ensuring that it uses the products (and its vehicle) in accordance with all applicable laws, regulations, guidelines, and standards of care. Buyer acknowledges that some products may only be used when off-roading, and Buyer will comply with all vehicle and road safety guidelines. Buyer is solely responsible for (and will indemnify and hold Bestop harmless for) any claims, losses, damages, fines, fees, costs, or other amounts arising out of Buyer's non-compliance with these provisions.**

## Tools Required

\* 4mm Allen wrench  
\* Trim removal tool

\*9/16" wrench and socket  
\*Phillips head screwdriver

\*10mm socket and ratchet

**To begin, make sure the vehicle is in park, on level ground and the parking brake is engaged.**

1. With a 10mm socket, disconnect the negative battery cable. Remove the three forward most bolts in the driver's front fender well (circled). With a trim removal tool, pop the plastic screw fitting out freeing the felt from the fender.



2. On the bottom of the front lip, remove the 6 bolts securing the front clip (circled) with a 10mm socket. There are 2 bolts per corner and 2 along the bottom edge.



3. Disconnect the electrical connectors (2-3) on the passenger side of the front clip and repeat for the one on the driver side (arrowed).



4. Partially remove the front fender flare by pulling it directly outward. Gently pull the sides of the front clip out and forward to disconnect them from the vehicle. A small trim removal tool or flathead screwdriver may be needed to disconnect the first two clips. The furthest in clip will be behind the grill vent trim pieces under the headlight. Repeat on the opposite side of the vehicle.



5. Remove the seven push rivets (circled 5a) securing the top radiator fascia to the vehicle and remove it. With a 10mm socket, remove the 3 bolts holding the top of the grill to the core support (circled 5b). Gently lift up and out on the front clip to remove it from the vehicle and place it face down on a soft work surface.



6. Disconnect the electrical connector on the back of the TRD Pro light bar (circled) and using a Phillips head screwdriver, remove the seven small screws securing the light bar (arrowed).

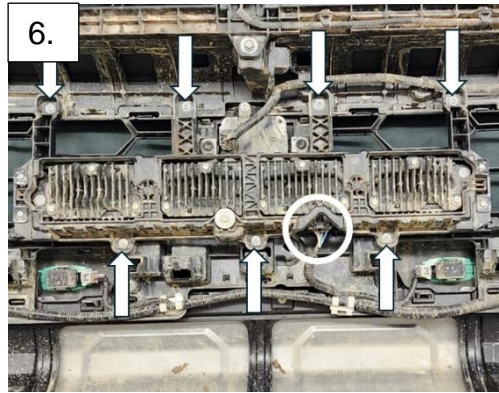

7. Use a 4mm Hex tool and the 4X 6mm Button head bolts to install the mounting brackets to the two provided S2 Pros. Install the brackets in the orientation shown below. Make sure the 3/8 bolts and washers are already on the U bracket.

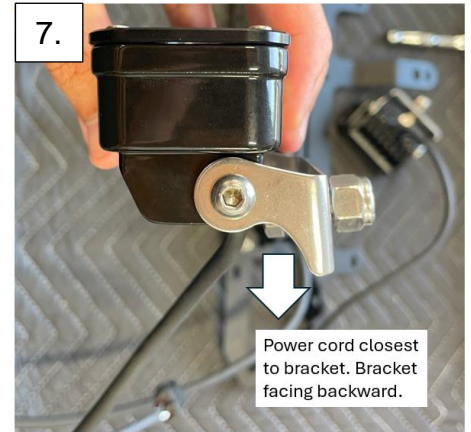

8. Use a 10mm wrench and socket to install the two small S8 brackets onto the larger bracket using the black M6 bolts, black washers and nuts. Install them such that the two legs are facing inward towards the center (See photo below). **Leave loose for now. Make sure the black bolt heads are on the side the light is facing.**

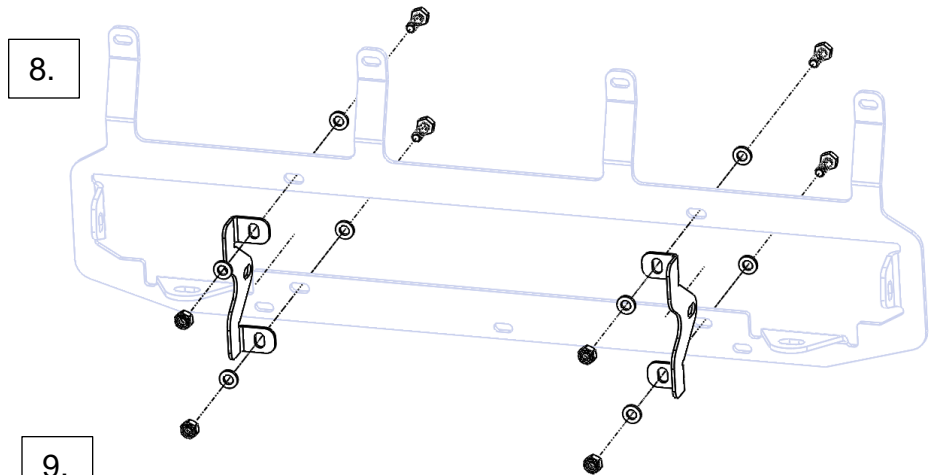

9. Use a 7/16" socket and ratchet to install your S8 light bar with the 2X 1/4"-20 Hex bolts and 1/4" washers provided with your light. **Leave loose for now.**

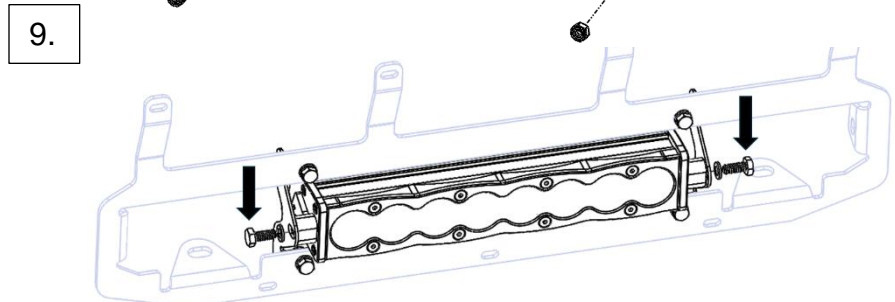

10. Using a 9/16" wrench & socket install the two S2s with the 3/8" bolts, washers, and nuts provided. **Leave loose for now.**

11. Slide the bezel piece over the front of the lights until the mounts line up with the holes on the main bracket. Adjust the lights so they are parallel to the bezel and straight. This is **crucial** as any further adjustments will be difficult.

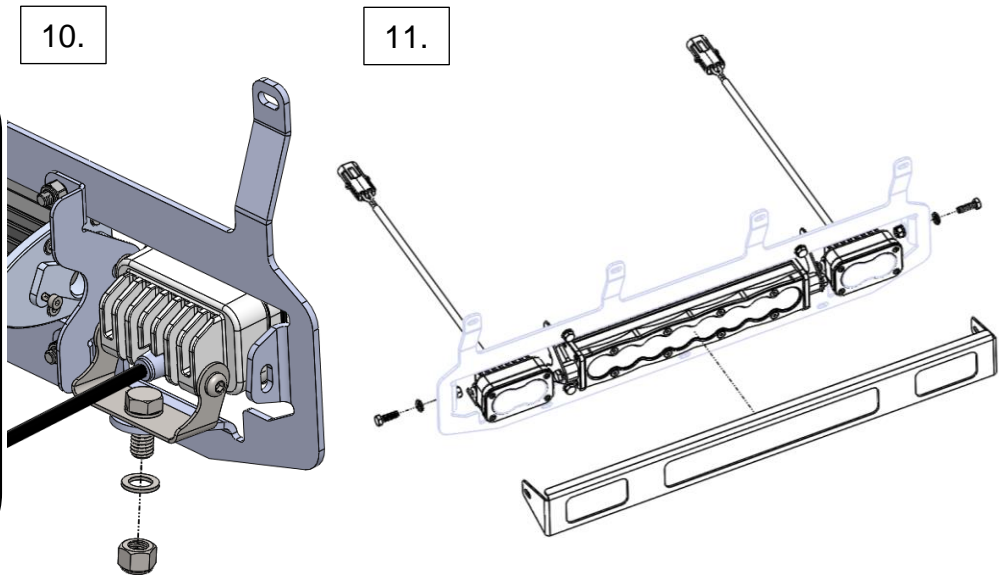

12. Use a Phillips screwdriver and 7 of the screws removed in step 6 (circled) to install the light bar as seen in the photo. Route the power cables down and secure them to the main wiring loom running towards the passenger side of the grill.

13. Check the alignment of the light assembly with the grill. Loosen the Phillips head screws to fix the alignment as needed. Tighten the hardware when satisfied.

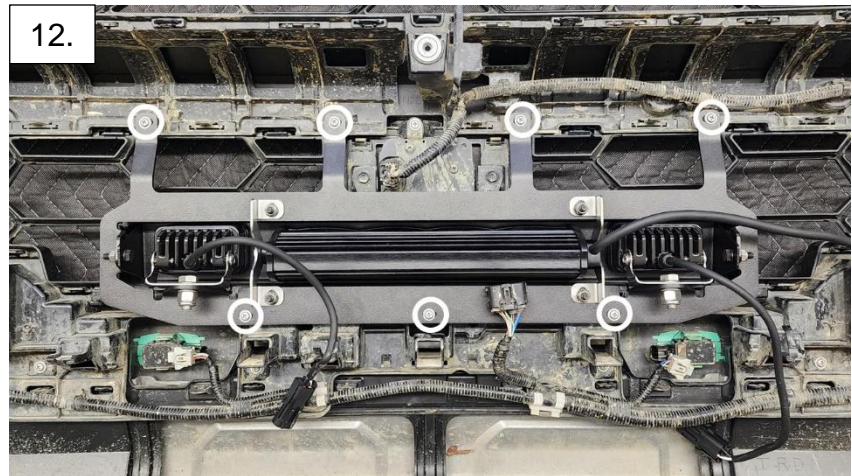

14. Secure both harnesses to the battery terminals. Loosely secure them around the passenger side fuse box. Run the switch lead along the firewall towards the driver side. Run the three connector leads underneath and in front of the driver side headlight. **DO NOT RECONNECT THE VEHICLE BATTERY.**

For upfitter instructions, skip to step 22

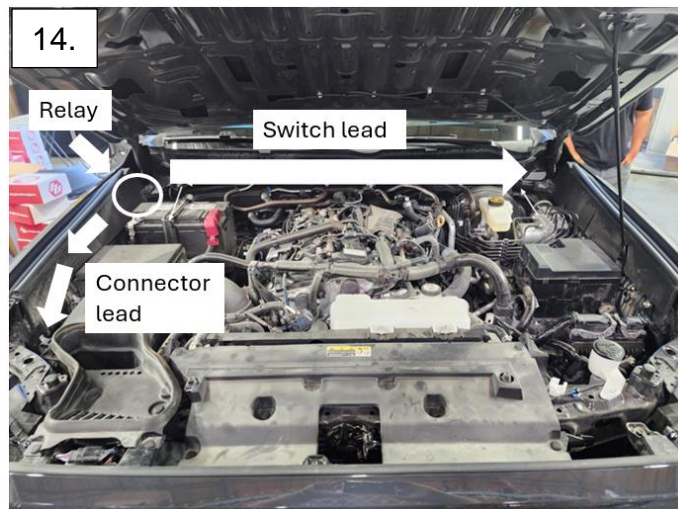

16. Disconnect the white connector on the switch lead and remove the connector from the switch side leaving the pins exposed.

17. Make a small hole in the firewall passthrough and pass the switch lead connector through the boot into the engine bay (pin side first). Wire emerges below the brake booster (driver side).

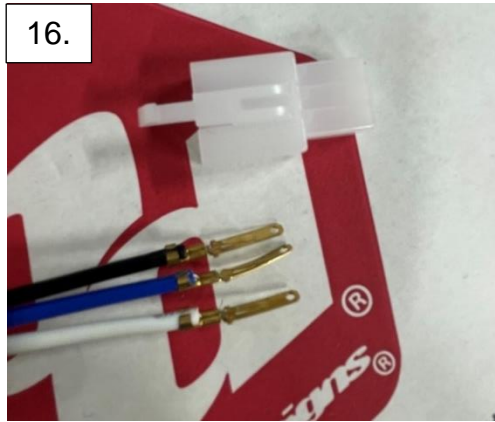

18. Pull the switch lead into the engine bay until it is long enough to be reconnected to the original harness. Re-install the white connector onto the exposed pins using the format below and then reconnect the two harnesses.

19. Remove the door seal. Remove the driver's side and the trim panel off the side of the dashboard by starting at the top edge and gently pulling away from the dash.

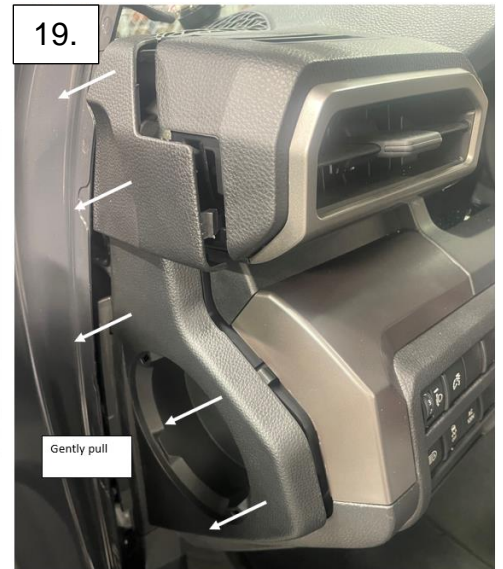
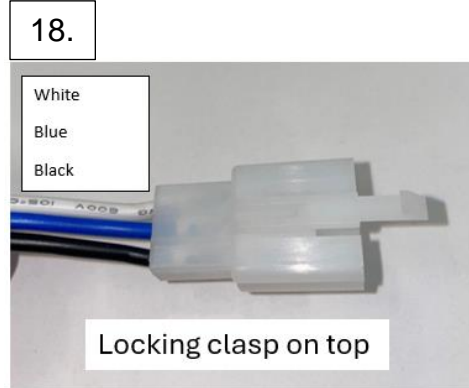

20. Remove the chrome trim panel by pulling parallel to the arrows pictured.

21. Drill a hole .75" in diameter at the location specified. Remove the button from the switch harness leaving only the exposed pins. Run the harness up from the footwell behind the dash and into the newly made hole. Re-install the button onto the harness and place it into the dashboard. Re-install all trim panels.

**For this installation, check the clearance behind the panel and add an additional hole for the other switch.**

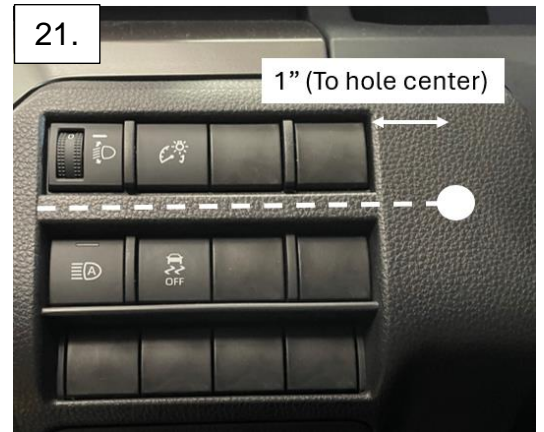

BD Lighted Rocker

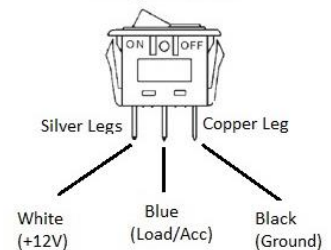

22. Remove the OEM connector plug A from the harness behind the driver side headlight

**For vehicles without upfitter switches, skip to step 25.**

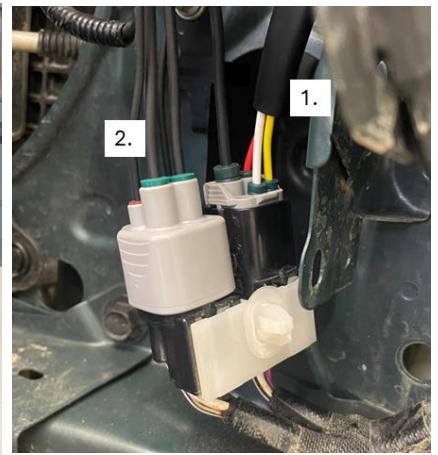

23. Plug in the adapter and run the harness to the end of the toggle harness in step 23. Connect the two harnesses using the appropriate connector from the chart below. Tie away any slack using the zip ties provided.

IGN: Connect your harness to yellow wire (Baja Designs adapter #1)  
Aux 1: Connect your harness to red wire (Baja Designs adapter #2)  
Aux 2: Connect your harness to yellow wire (Baja Designs adapter #2)  
Aux 3: Connect your harness to red wire (Baja Designs adapter #1)  
Aux 4: Connect your harness to white wire (Baja Designs adapter #1)

24. Take the additional backlight harness provided and swap the splice connector to the appropriate fuse tap provided. For upfitters, tap into the yellow wire on adapter #1. With the splice connector

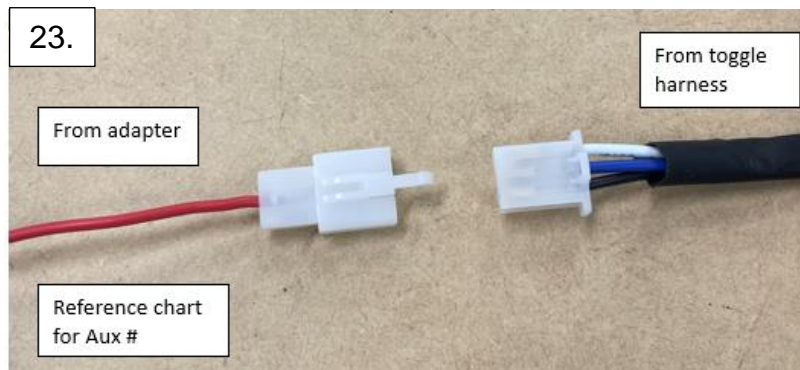

25. Run the harness to the front of the vehicle and install it into the 3-pin weather pack as seen below. The connector is labeled with A-B-C. The pinout is as follows:  
A- Black/Ground  
B- White/ Power  
C- Green (S8 Light Bar Only)  
Connect your harness to the light power cords.

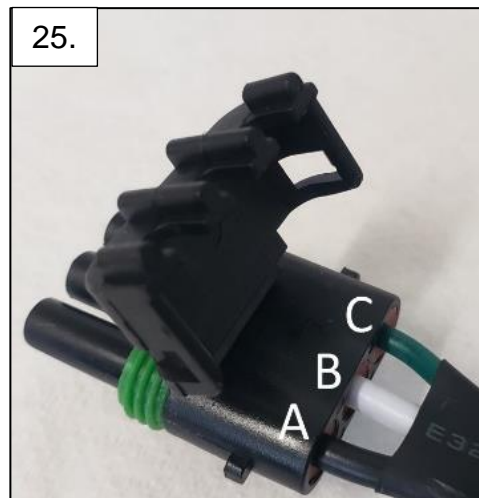

26. Reinstall the grill loosely and proceed to testing.

27. Re-connect the 5X connectors from step 12. Re-connect the battery. Test the light functionality for S8 and S2's independently as well as the backlight feature (comes on with vehicle ignition).

28. Fully clip the grill in place. Install all fasteners. Complete steps 1-5 in reverse.

Installation complete!



\*Tie all wires away from sharp, hot, and/or rotating components.

\* Re-torque all the fasteners after 100 miles.

\*Your install is now complete! Thank you for choosing Baja Designs.