

PROPRIETARY AND CONFIDENTIAL  
THE INFORMATION CONTAINED IN THIS DRAWING IS THE SOLE PROPERTY  
OF S&B FILTERS, INC. ANY REPRODUCTION IN PART OR AS A WHOLE  
WITHOUT THE WRITTEN PERMISSION OF S&B FILTERS, INC. IS PROHIBITED.

REVISIONS			
REV.	DESCRIPTION	DATE	APPROVED
A	INITIAL RELEASE	02/27/2024	A. CRUZ
B	ADDED EXTRUDED STRAP COVER	09/04/2024	A. CRUZ

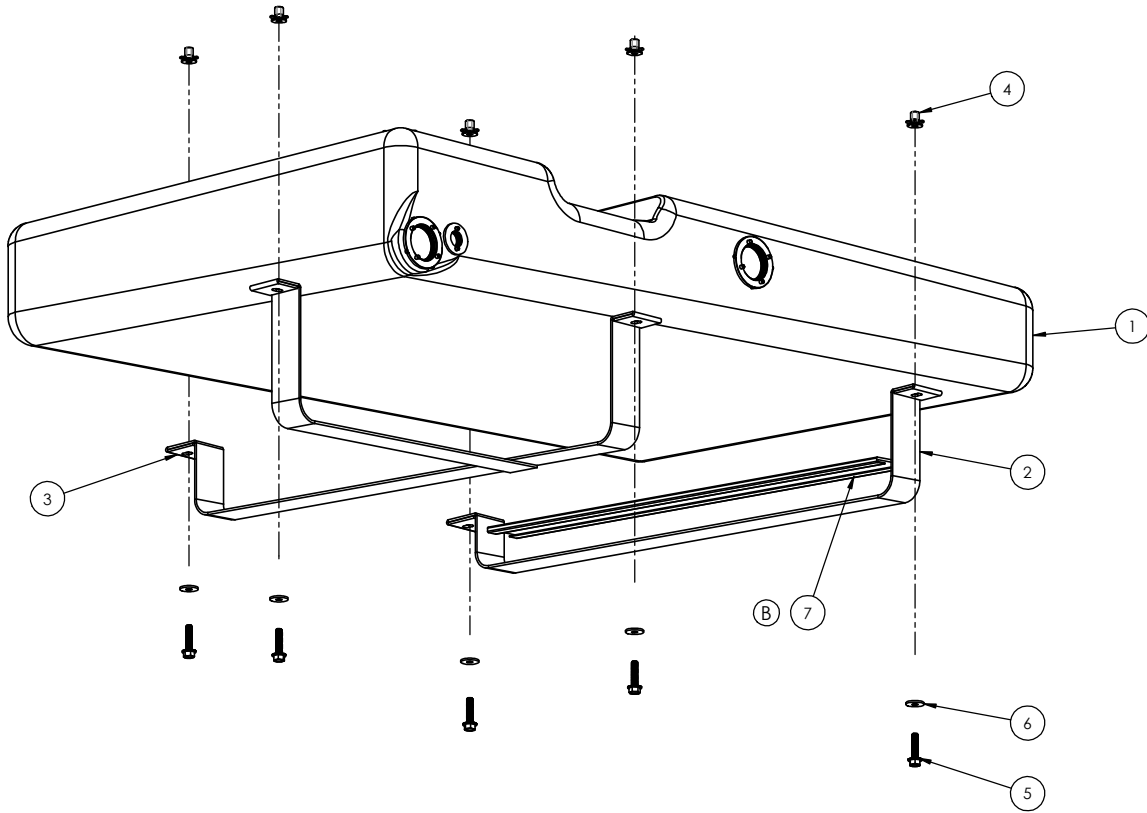

ITEM NO.	PART NUMBER	DESCRIPTION	QTY.
1	TL10-3021UT	ProMaster undercarriage 36 Gal Water Tank	1
2	TI1392-00	10-3027 Frontal Water Tank Strap	1
3	TI1393-00	10-3027 Mid Water Tank Strap	1
4	AI3414-00	Rivet Nut M8 x 1.25mm Internal Thread, 0.5 to 7.1 mm Material Thickness ( MCM#97217A461)	5
5	97646A334	18-8 Stainless Steel Serrated-Flange Hex Head Screw	5
6	AI1742-00	Fender Washer, M8, SS	5
7	255863AA-28	Strap cover extrusion - Skyjack Tanks, 28" cut.	1

UNLESS OTHERWISE SPECIFIED:		NAME	DATE	TITLE:	
DIMENSIONS ARE IN INCHES		DRAWN	A.C.	02/27/2024	ProMaster undercarriage 36 Gal Water Tank
TOLERANCES:		CHECKED	R.T.		
FRACTIONAL: $\pm 1/16$		MATERIAL			
ANGULAR: WAGON $\pm .25^\circ$ BEND $\pm 1^\circ$		SEE BOM			
TWO PLACE DECIMAL $\pm .005$		FINISH		SIZE	DWG. NO.
THREE PLACE DECIMAL $\pm .0005$		N/A		C	10-3021
INTERPRET GEOMETRIC TOLERANCING PER: ASME Y14.5M-1994		REV		A	
FIRST ANGLE PROJECTION		S&B FILTERS		SCALE: 1:5 DO NOT SCALE DRAWING	
SHEET 1 OF 1		www.sbfilters.com			