

- Do not discard packaging until product has been successfully installed.
- While routing wires, follow factory wiring when possible and avoid rotating and/or hot components.
- Use provided wire ties and secure wires and Harnesses as needed.
- SuperATV does not recommend keeping Windshield installed while transporting on an open air trailer. Remove or secure with straps.
- Before beginning Power Flip Windshield installation, refer to optional Windshield Wiper Kit instructions. Some installation steps between products will occur.

Liability Statement

SuperATV's[®] products are designed to best fit user's ATV/UTV under stock conditions. Adding, modifying, or fabricating any factory or aftermarket parts will void any warranty provided by SuperATV[®] and is not recommended. SuperATV's[®] products could interfere with other aftermarket accessories. If user has aftermarket products on machine, contact SuperATV[®] to verify that they will work together.

Although SuperATV[®] has thousands of satisfied customers, user should be aware that installing lift kits, long travel, or suspension kits, tires, etc. will change the ride of machine and may increase maintenance and part wear. Operating any off-road machine while, or after, consuming alcohol and/or drugs increases risk of bodily harm or death. No warranty or representation is made as to this product's ability to protect user from severe injury or death. SuperATV[®] urges operators and occupants to wear a helmet and appropriate riding gear at all times.

By purchasing and installing SuperATV[®] products, user agrees that should damages occur, SuperATV[®] will not be held responsible for loss of time, use, labor fees, replacement parts, or freight charges. SuperATV[®], nor any 3rd party, will not be held responsible for any direct, indirect, incidental, special, or consequential damages that result from any product purchased from SuperATV[®]. The total liability of seller to user for all damages, losses, and causes of action, if any, shall not exceed the total purchase price paid for the product that gave rise to the claim.

SuperATV[®] will warranty only parts provided by SuperATV[®]. Any damage or problems with OEM housings, bearings, seals, or other manufacturers' products will not be covered by SuperATV[®]. SuperATV[®] parts and products are not warranted if item was not installed properly, misused, or modified.

Installing, adding, modifying, or fabricating any factory or aftermarket product to your ATV/UTV may violate certain local, state, and federal laws. Be advised that laws vary depending on town, city, county, state, etc. Use of certain products on public streets, roads, or highways may be in violation law. The Buyer is solely and exclusively legally and personally responsible for any violation of the law by the installation or use of the product. You must abide by all local, state, and federal laws, including but not limited to vehicle safety, traffic laws, and ordinances. It is your responsibility to know the laws and how they apply to you.

The Buyer is responsible to fully understand the capability and limitations of his/her vehicle according to manufacturer specifications, warnings and instructions and agrees to hold SuperATV[®] harmless from any damage resulting from failure to adhere to such specifications, warnings and/ or instructions. The Buyer is also responsible to obey all applicable federal, state, and local laws and ordinances when operating his/her vehicle while using this product, and the Buyer agrees to hold SuperATV[®] harmless from any violation thereof.

Need help with your installation?



sales@superatv.com



www.superatv.com



1-855-743-3427



8:00am - 8:00pm EST M-Th
8:00am - 7:00pm EST Friday
9:00am - 2:00pm EST Saturday

Read instructions and view illustrations before beginning.

Thank You

For Choosing





B

(right side)

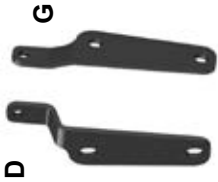

D

G



F

H

(left side)



E

loosen Clamp hardware



J

Item	Description
A	Windshield
B	Hinge x 2
C	Wire Guide x 2
D	Actuator Bracket 2
E	Clamp x 4
F	Actuator Bracket 4
G	Actuator Bracket 1
H	Actuator Bracket 3
J	Actuator x 2

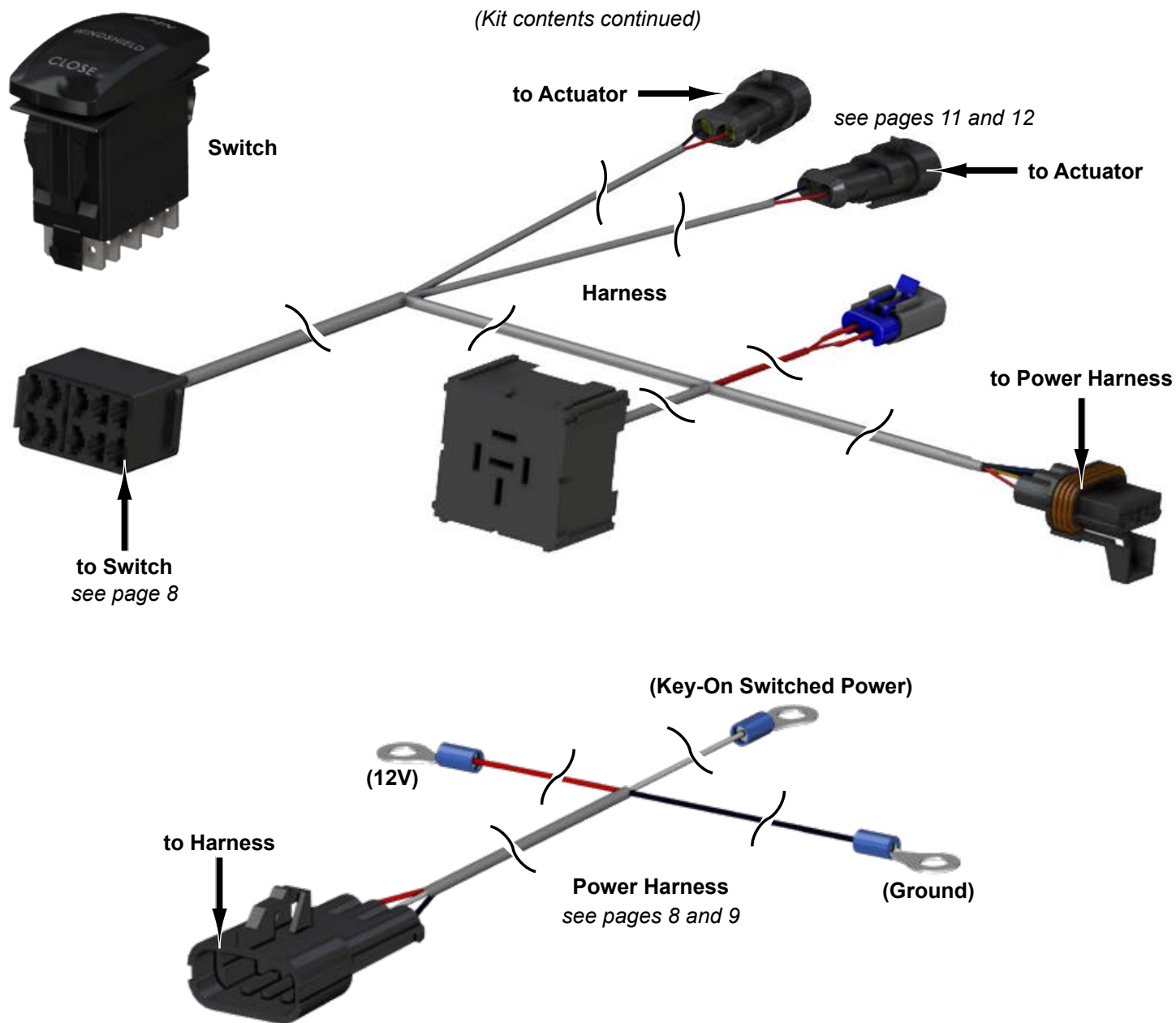

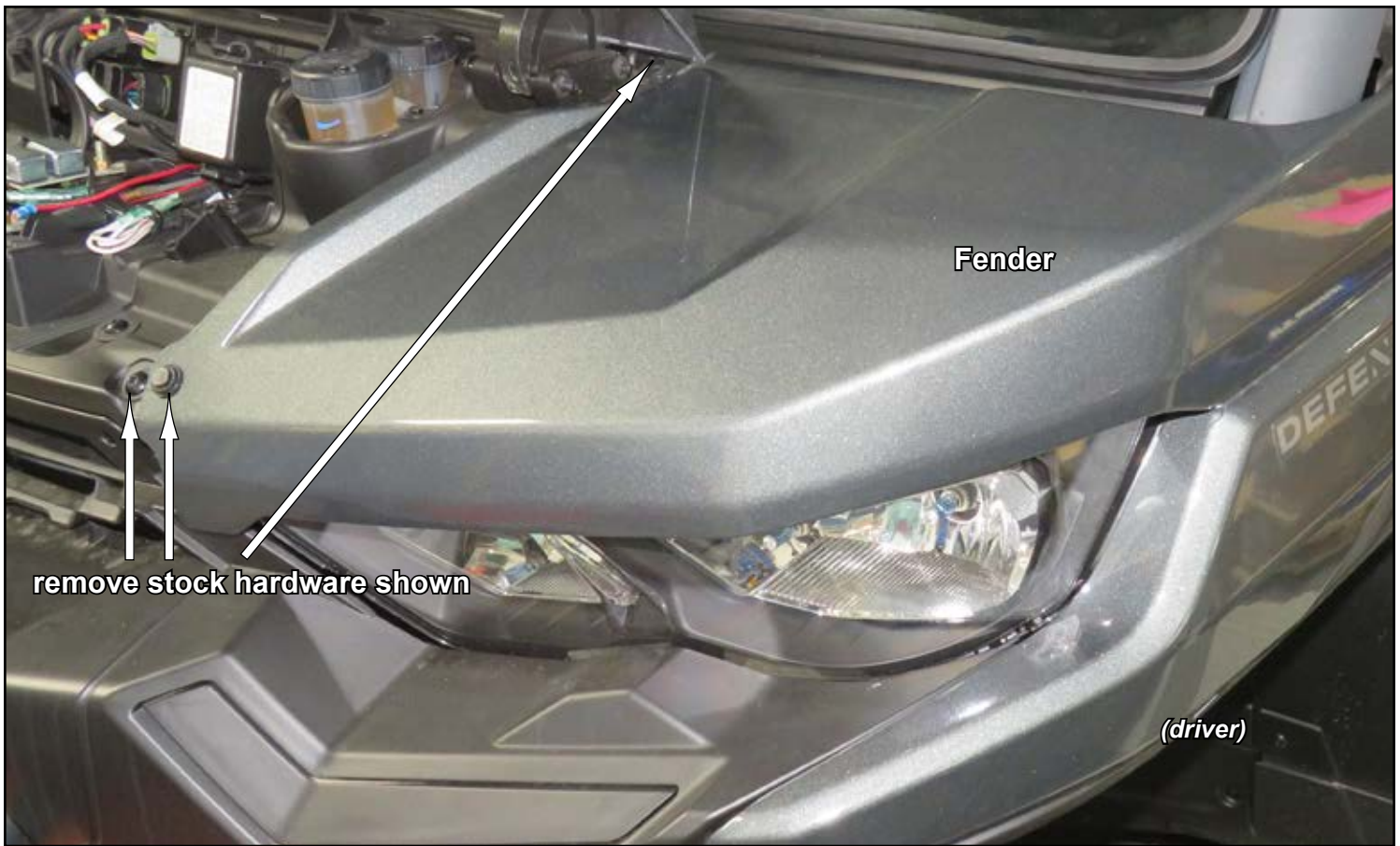

- Remove Fender from machine.
- Repeat for passenger side.

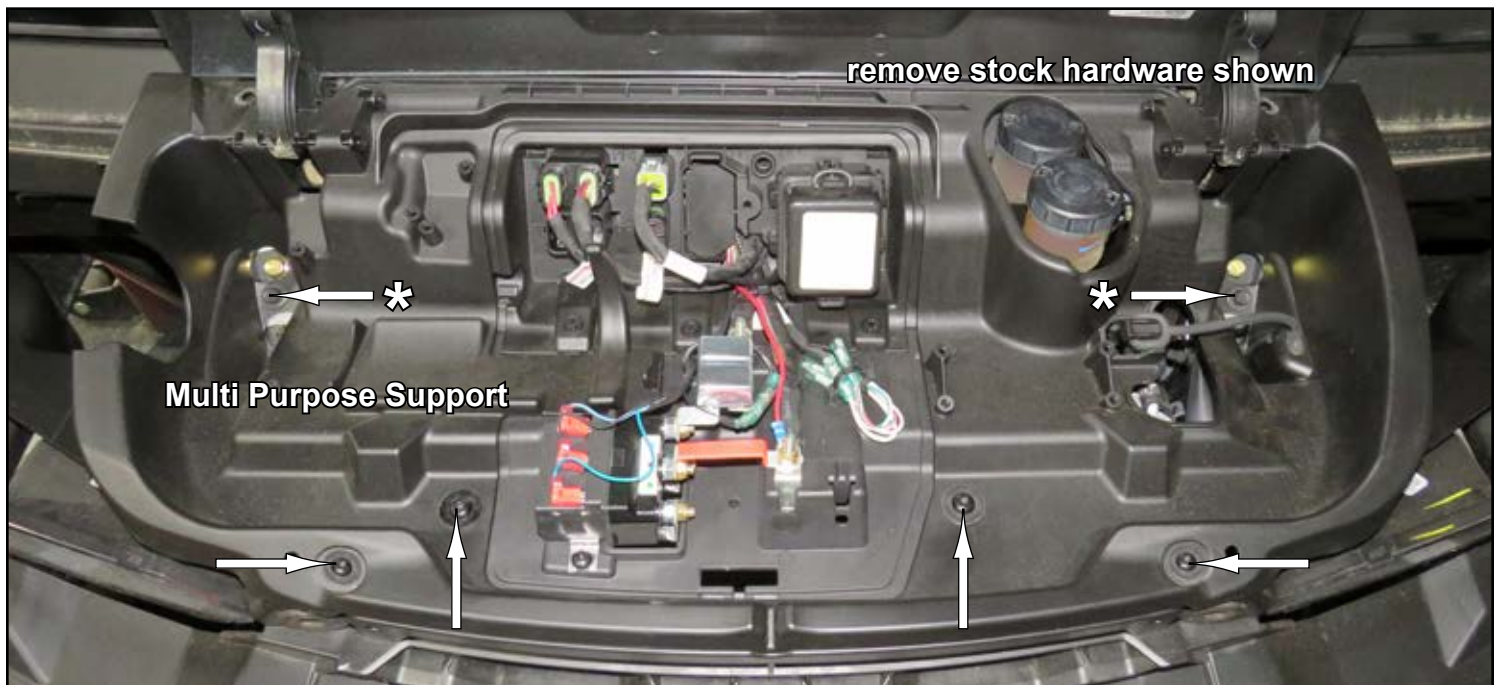

- Remove Multi Purpose Support from machine.

✱ Spacers will fall out of machine when removing Multi Purpose Support hardware. Follow steps shown when reinstalling Multi Purpose Support.

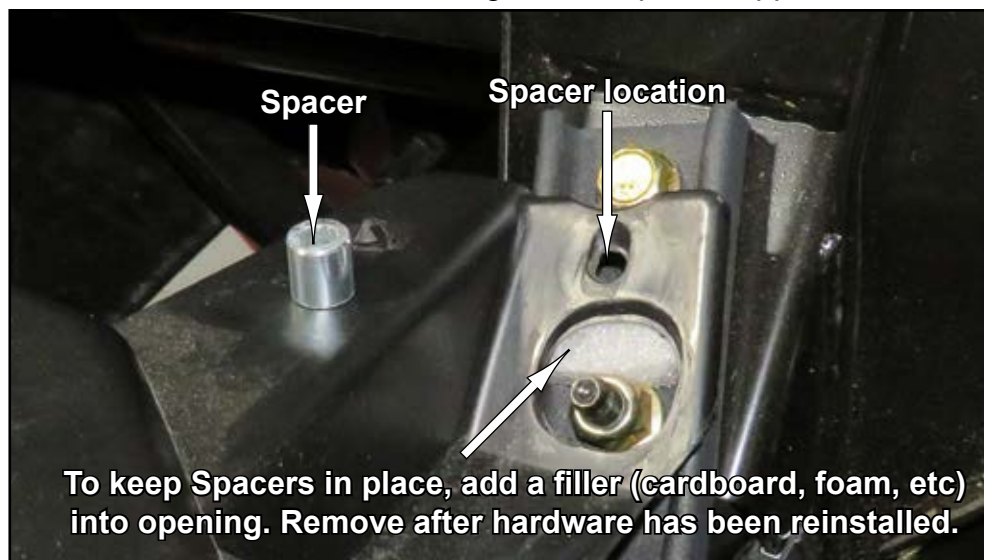

- Install Hinges (B) to Windshield (A) with hardware shown.
- Tighten hardware.

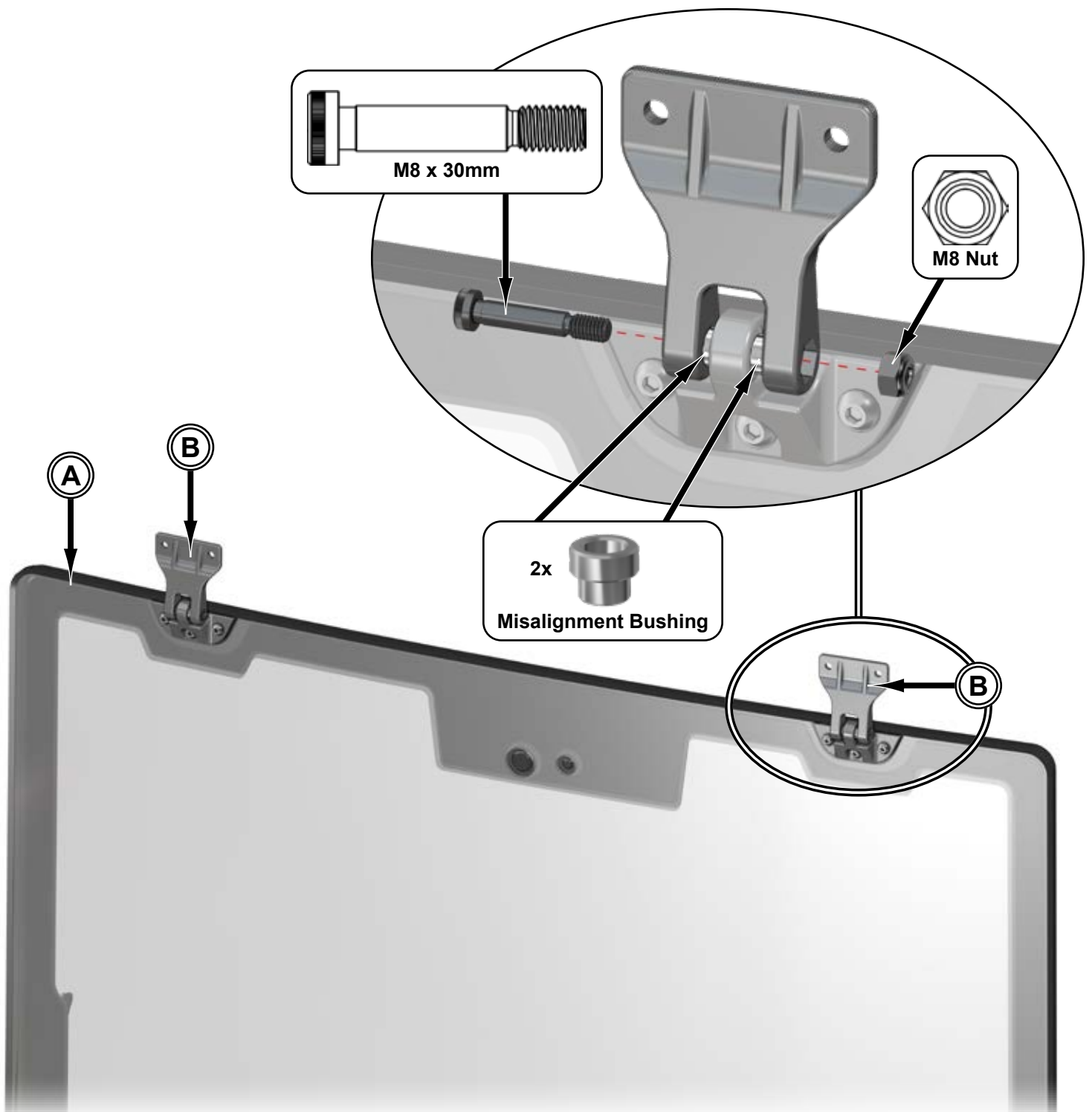

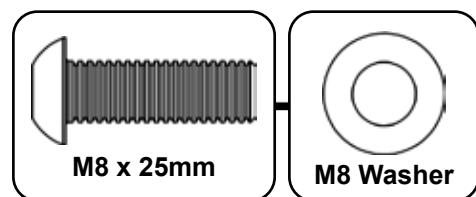

2 each

- Install Actuator Brackets (F)(H) to Clamps (E) with hardware shown.
- Secure Actuator (J) with hardware shown.
- Repeat for passenger side.
- Do not tighten hardware.

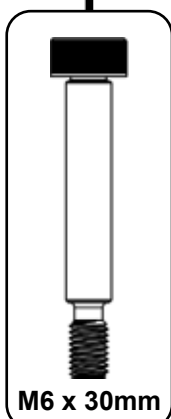
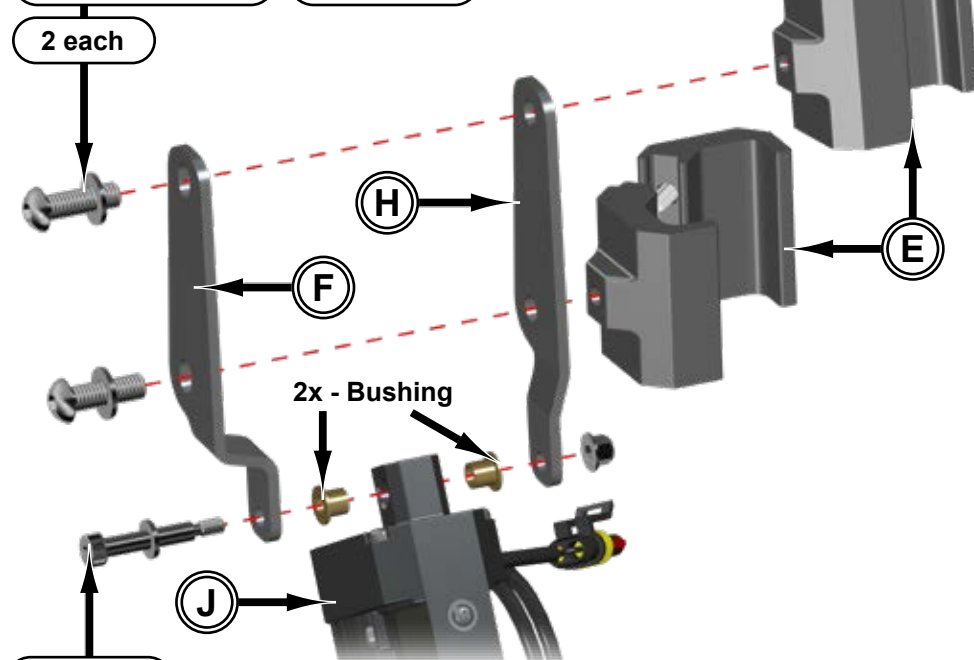

- Install Clamp / Actuator assembly to machine as shown.



- User may install Switch in location different than shown.
- Verify that Harnesses will reach Switch before mounting.
- Remove stock Knockout or cut a new location. ***If cutting a new location, check behind area to be cut for any interference.***
- Connect wiring and secure Switch.

Before permanently mounting Switch, SuperATV recommends testing after all components have been installed.



- Connect Power Harness to stock Bus Bar as shown.



Power Harness Wiring





- Place Windshield (A) onto machine.
- Secure Hinges to machine; do not tighten.



- Secure Actuator (J) to Windshield (A) with hardware shown; tighten.
- Repeat for passenger side.

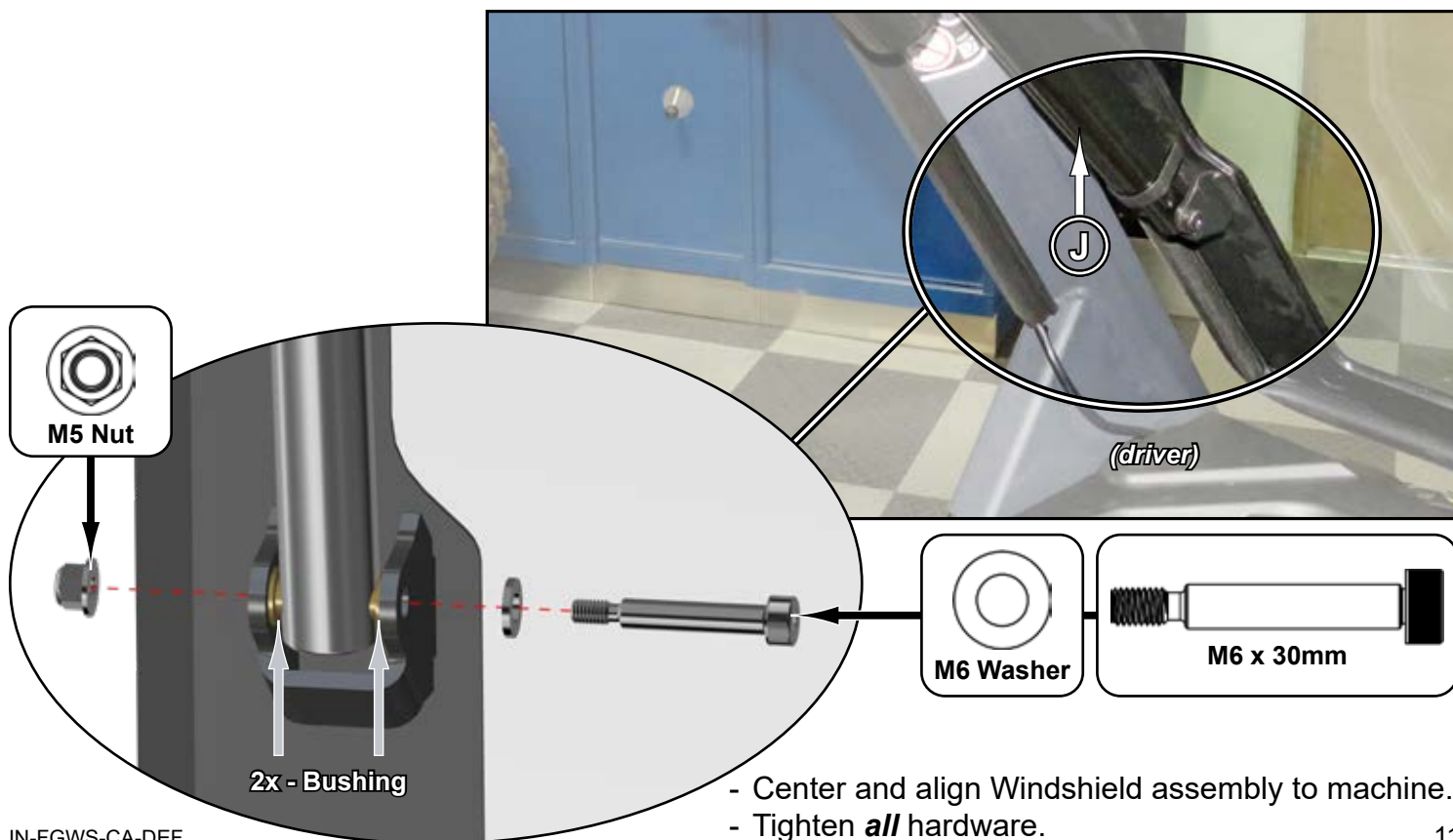

- Center and align Windshield assembly to machine.
- Tighten **all** hardware.

- Route Actuator connection from Harness to Actuator.

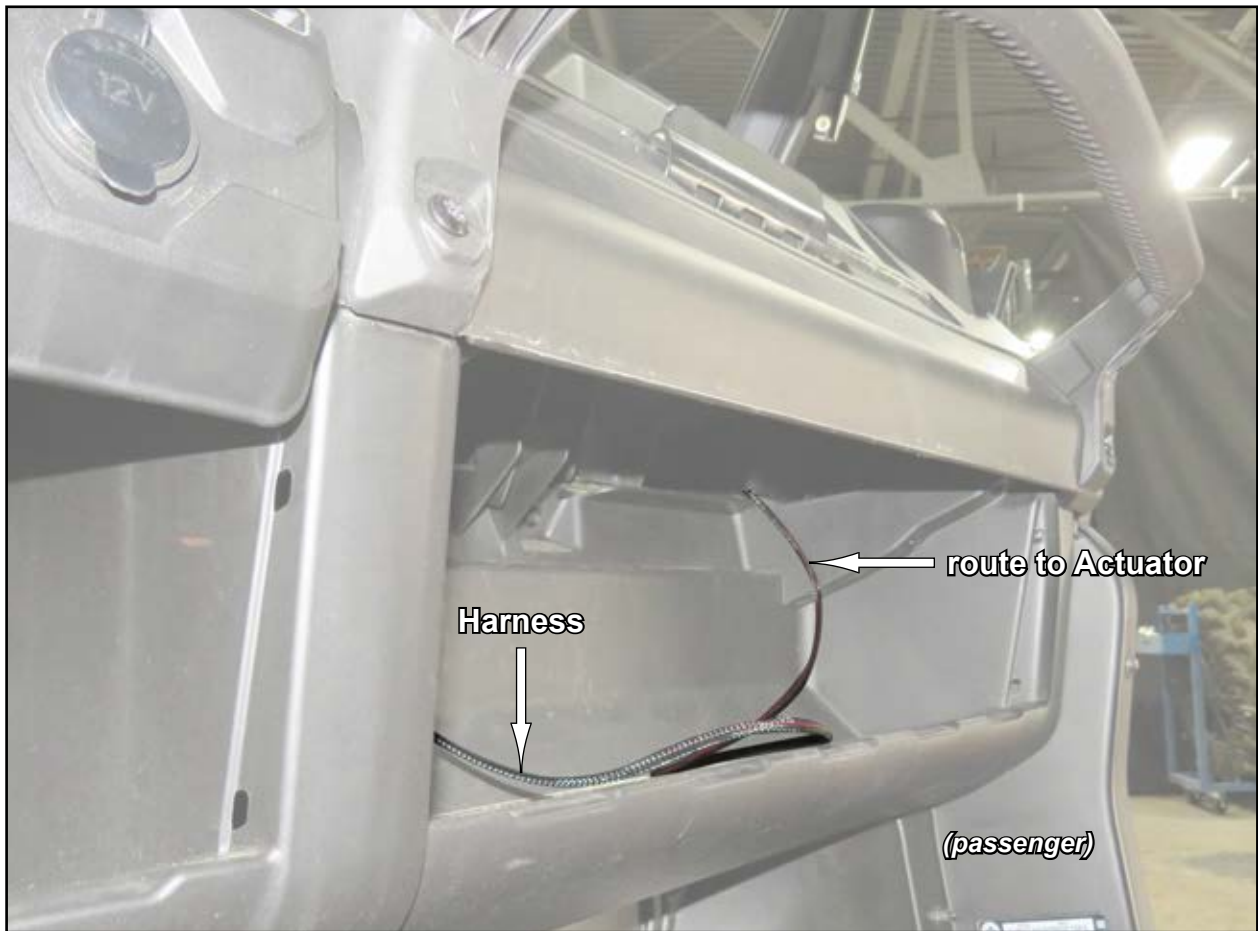

- Pass wiring through hole and connect Acuator to Harness.

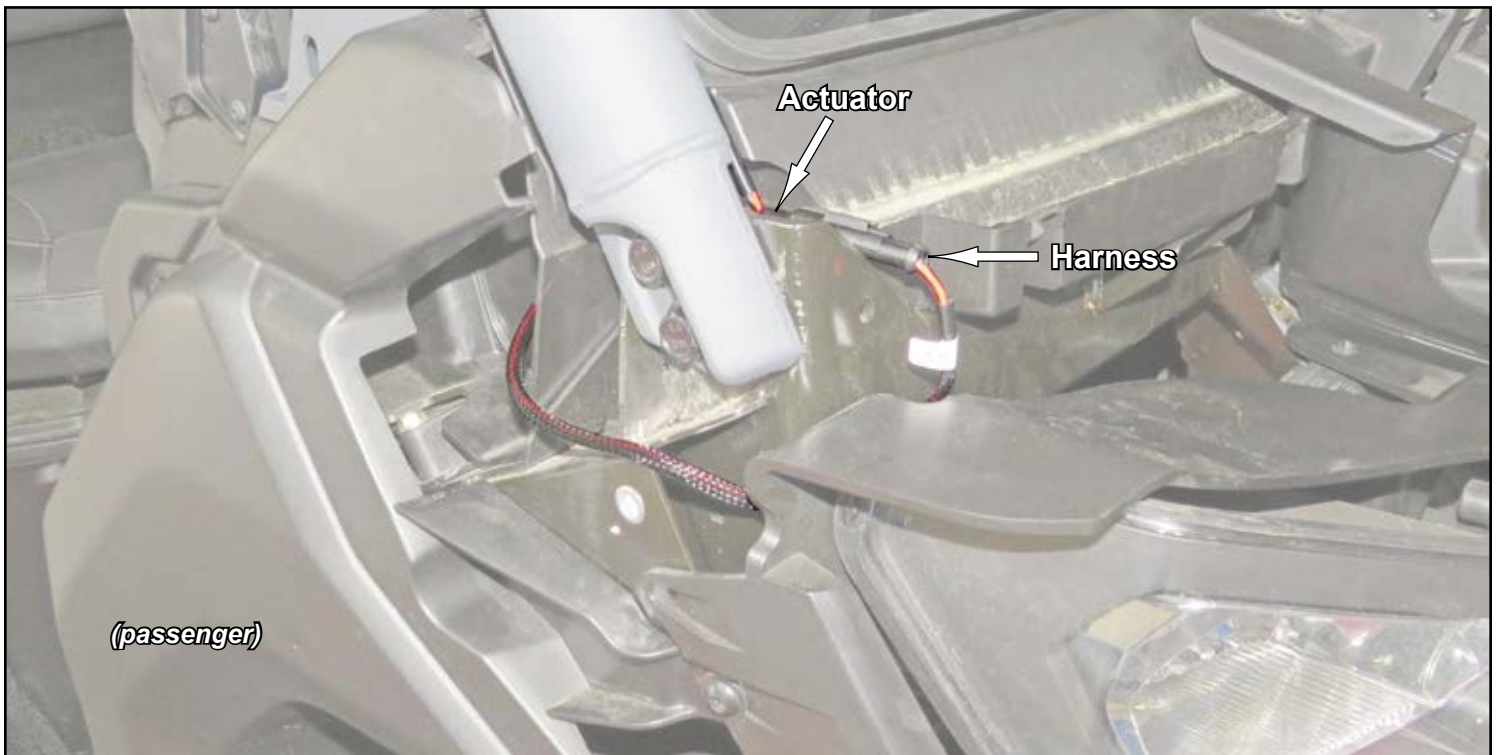

- Repeat steps for driver side.



- Place Actuator Wire into Wire Guide (C) and secure Wire Guide (C) to machine as shown.



Reinstall all previously removed stock components.