



2753 Michigan Road • Madison, Indiana 47250 • 855-743-3427

INSTALLATION INSTRUCTIONS

Power Flip Windshield for Polaris® General™

- Do not discard packaging until product has been successfully installed.
- While routing wires, follow factory wiring when possible and avoid rotating and/or hot components.
- Use provided wire ties and secure wires and Harnesses as needed.
- SuperATV does not recommend keeping Windshield installed while transporting on an open air trailer. Remove or secure with straps.

Optional WWK-004 Wiper Kit is shown being installed. Disregard all Wiper Kit references if not installing Wiper Kit at this time.

Liability Statement

SuperATV's® products are designed to best fit user's ATV/UTV under stock conditions. Adding, modifying, or fabricating any factory or aftermarket parts will void any warranty provided by SuperATV® and is not recommended. SuperATV's® products could interfere with other aftermarket accessories. If user has aftermarket products on machine, contact SuperATV® to verify that they will work together.

Although SuperATV® has thousands of satisfied customers, user should be aware that installing lift kits, long travel, or suspension kits, tires, etc. will change the ride of machine and may increase maintenance and part wear. Operating any off-road machine while, or after, consuming alcohol and/or drugs increases risk of bodily harm or death. No warranty or representation is made as to this product's ability to protect user from severe injury or death. SuperATV® urges operators and occupants to wear a helmet and appropriate riding gear at all times.

By purchasing and installing SuperATV® products, user agrees that should damages occur, SuperATV® will not be held responsible for loss of time, use, labor fees, replacement parts, or freight charges. SuperATV®, nor any 3rd party, will not be held responsible for any direct, indirect, incidental, special, or consequential damages that result from any product purchased from SuperATV®. The total liability of seller to user for all damages, losses, and causes of action, if any, shall not exceed the total purchase price paid for the product that gave rise to the claim.

SuperATV® will warranty only parts provided by SuperATV®. Any damage or problems with OEM housings, bearings, seals, or other manufacturers' products will not be covered by SuperATV®. SuperATV® parts and products are not warranted if item was not installed properly, misused, or modified.

Installing, adding, modifying, or fabricating any factory or aftermarket product to your ATV/UTV may violate certain local, state, and federal laws. Be advised that laws vary depending on town, city, county, state, etc. Use of certain products on public streets, roads, or highways may be in violation law. The Buyer is solely and exclusively legally and personally responsible for any violation of the law by the installation or use of the product. You must abide by all local, state, and federal laws, including but not limited to vehicle safety, traffic laws, and ordinances. It is your responsibility to know the laws and how they apply to you.

The Buyer is responsible to fully understand the capability and limitations of his/her vehicle according to manufacturer specifications, warnings and instructions and agrees to hold SuperATV® harmless from any damage resulting from failure to adhere to such specifications, warnings and/ or instructions. The Buyer is also responsible to obey all applicable federal, state, and local laws and ordinances when operating his/her vehicle while using this product, and the Buyer agrees to hold SuperATV® harmless from any violation thereof.

Need help with your installation?



sales@superatv.com



www.superatv.com



1-855-743-3427



8:00am - 8:00pm EST M-Th
8:00am - 7:00pm EST Friday
9:00am - 2:00pm EST Saturday

Read instructions and view illustrations before beginning.

*Thank You
For Choosing*



Item	Description
A	Windshield
B	Hinge x 2
C	Actuator Bracket R
D	Actuator Bracket L
E	Clamp x 4
F	Wire Guide x 2
G	Actuator x 2

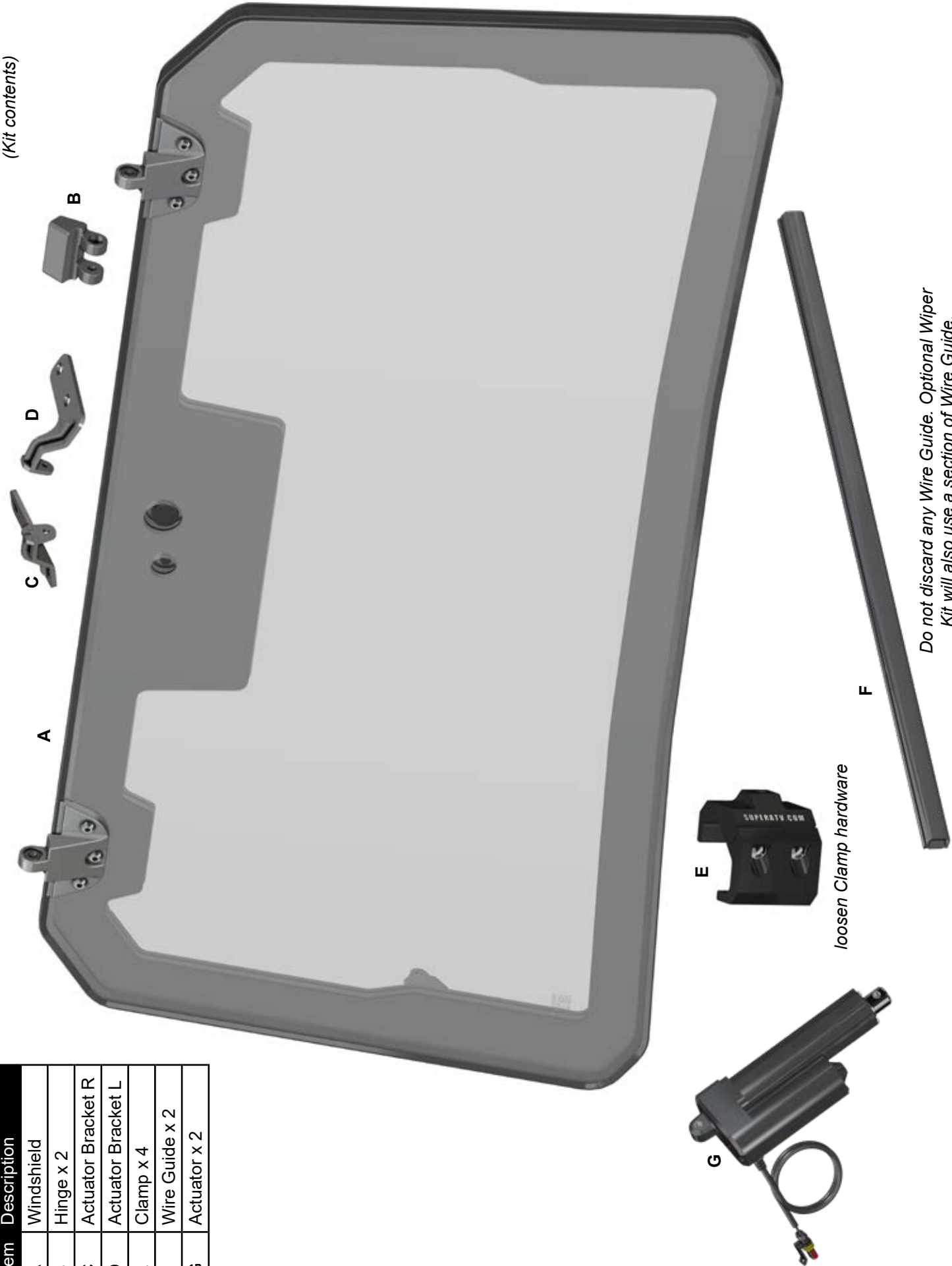

Switch Harness

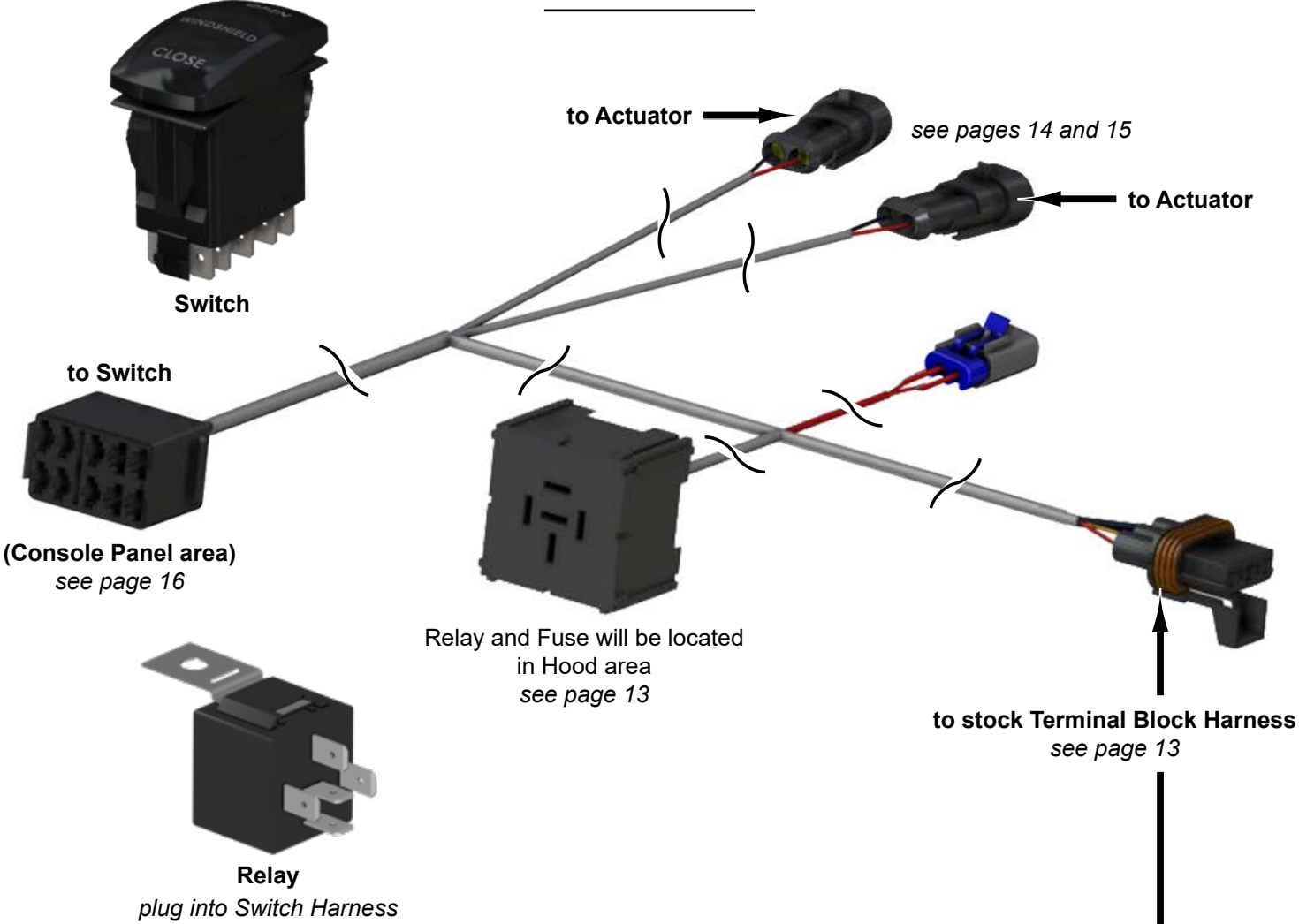

Alternate Power Harness

will only be used if installation is performed on older models

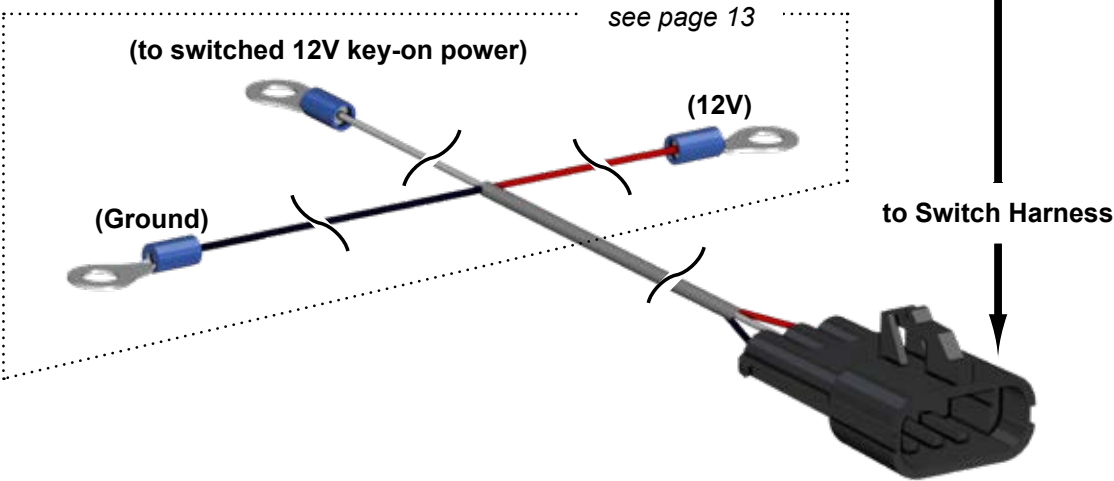

Windshield Wiper Kit:

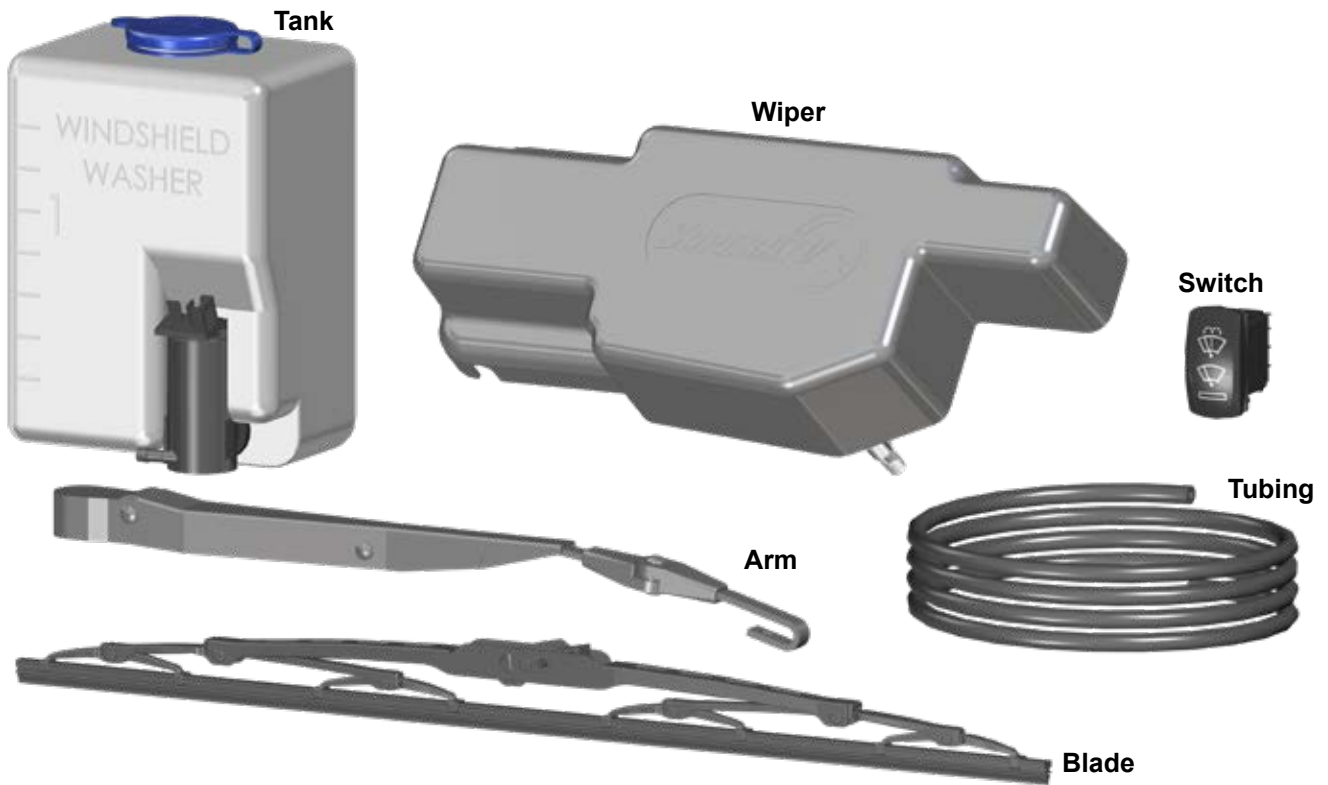

remove Tank Bracket from Tank →



Windshield Wiper Kit Switch Harness

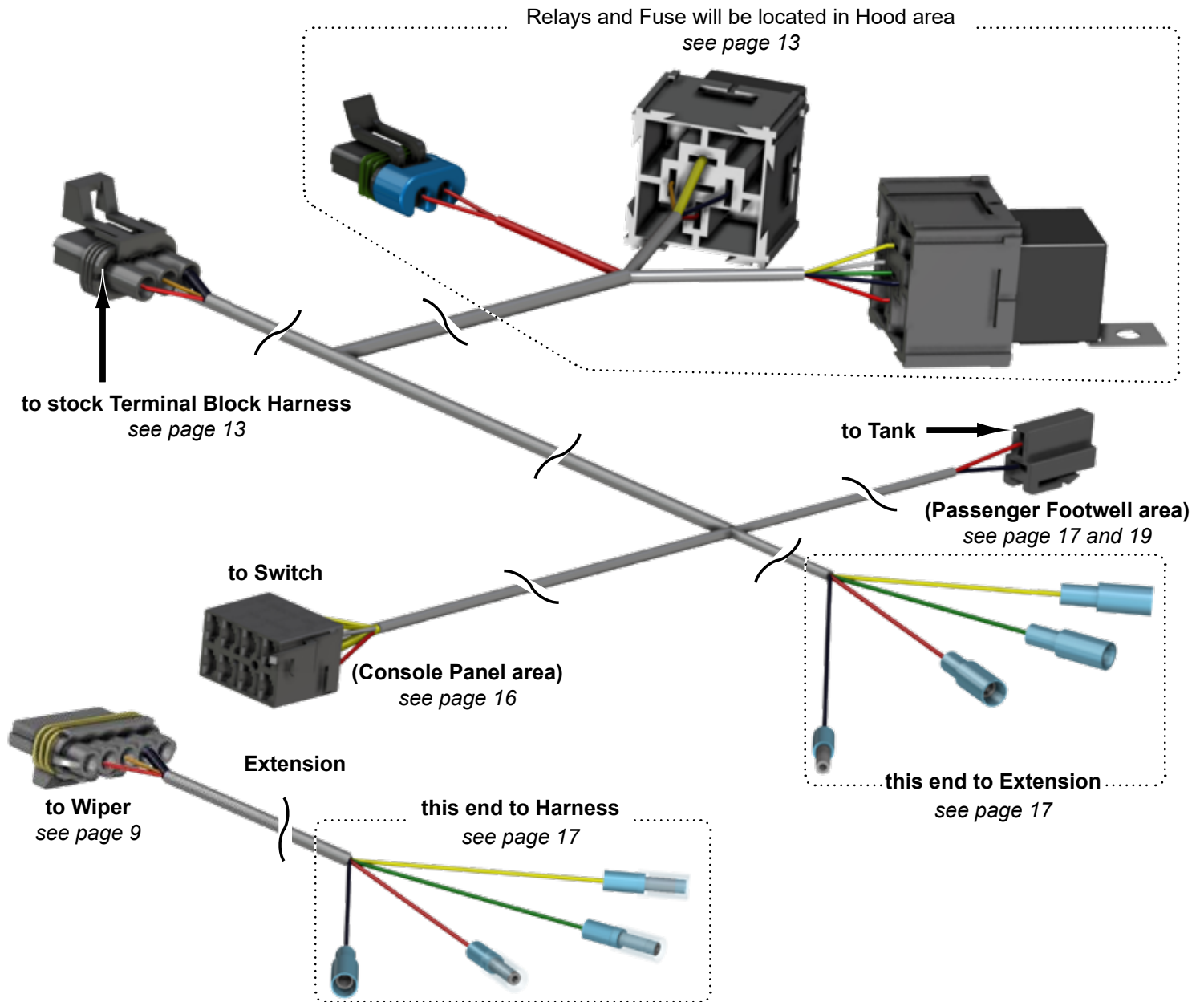

Windshield Wiper Kit Alternate Power Harness

will only be used if installation is performed on older models

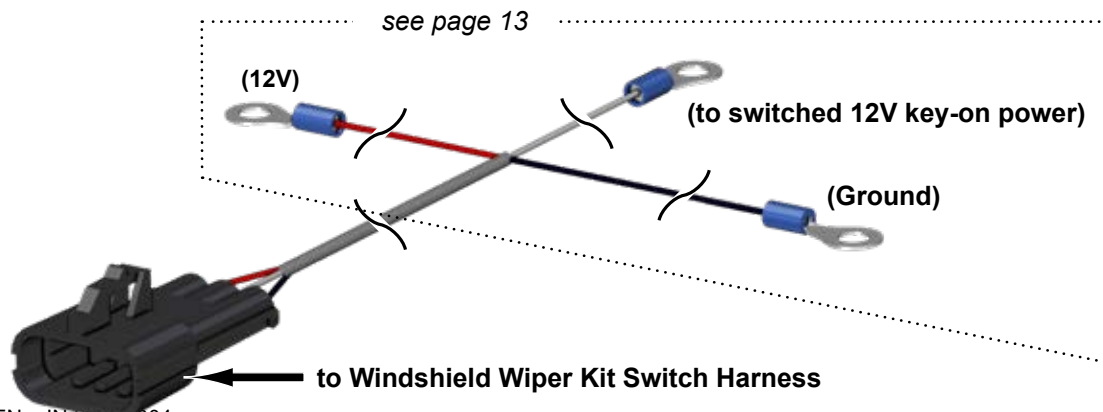

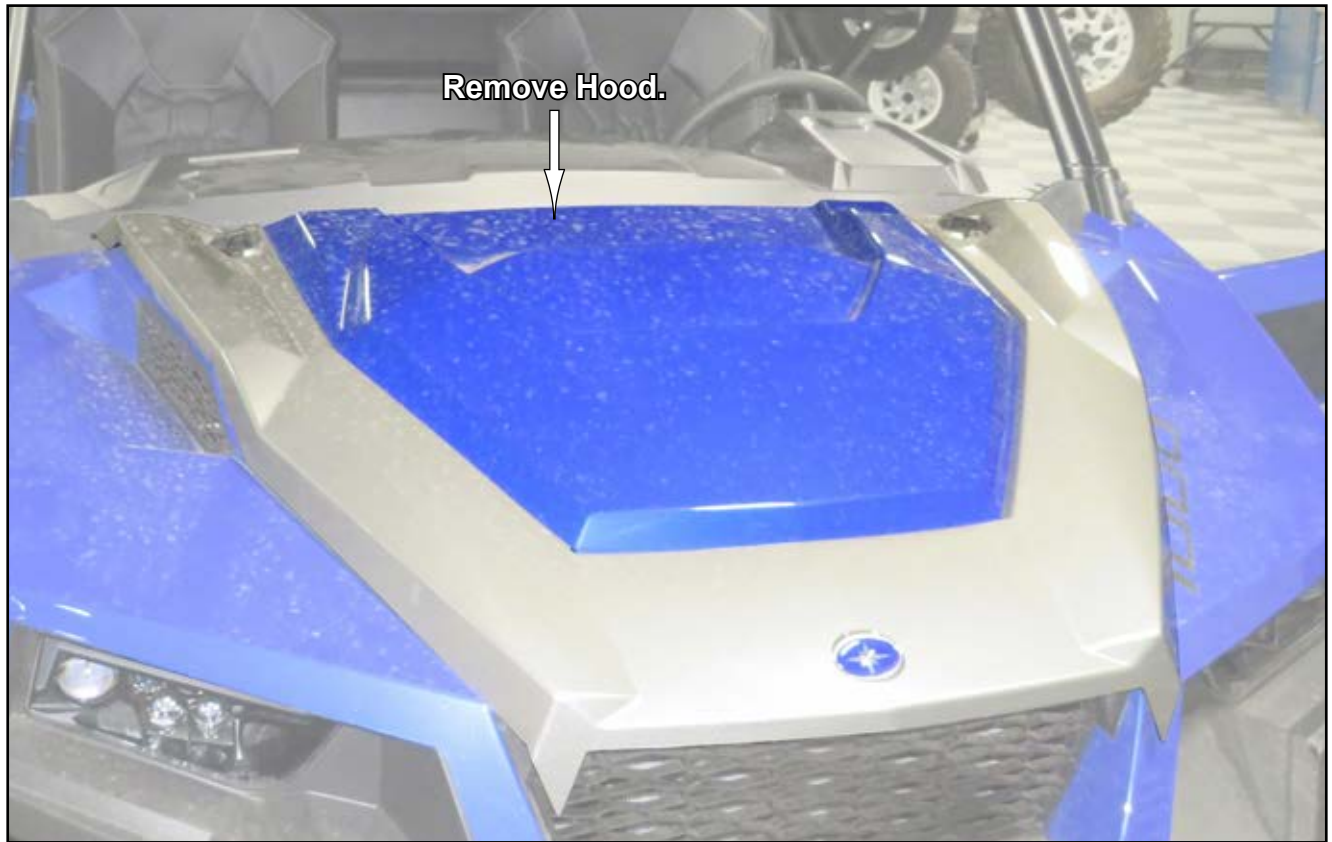

- Install Actuator Brackets (C)(D) to Clamps (E) with hardware shown; do not tighten.

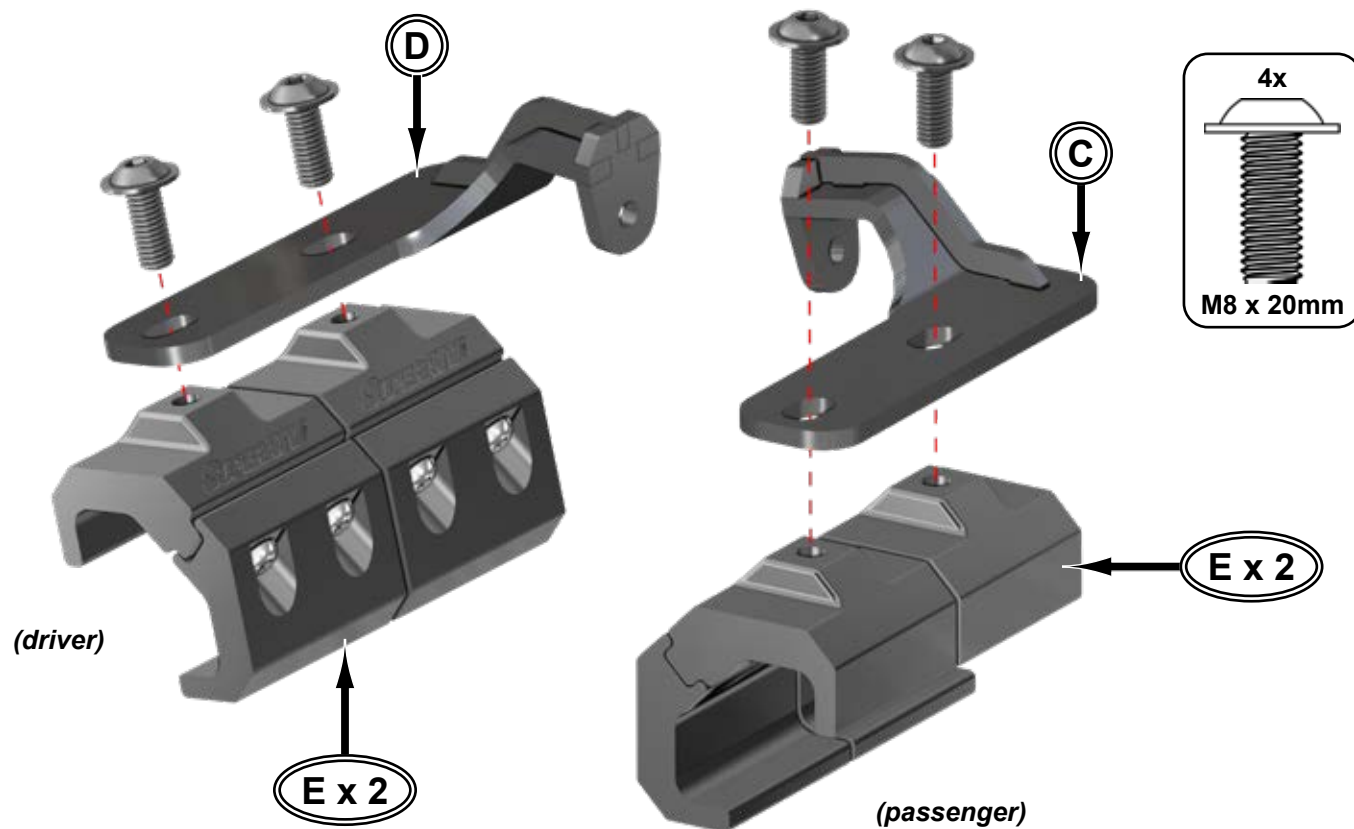

- Install Actuator Brackets / Clamps to machine.
- Clamp hardware should be snug but not completely tight.



- Install Hinges (B) to Windshield (A) with hardware shown.
- Tighten hardware.

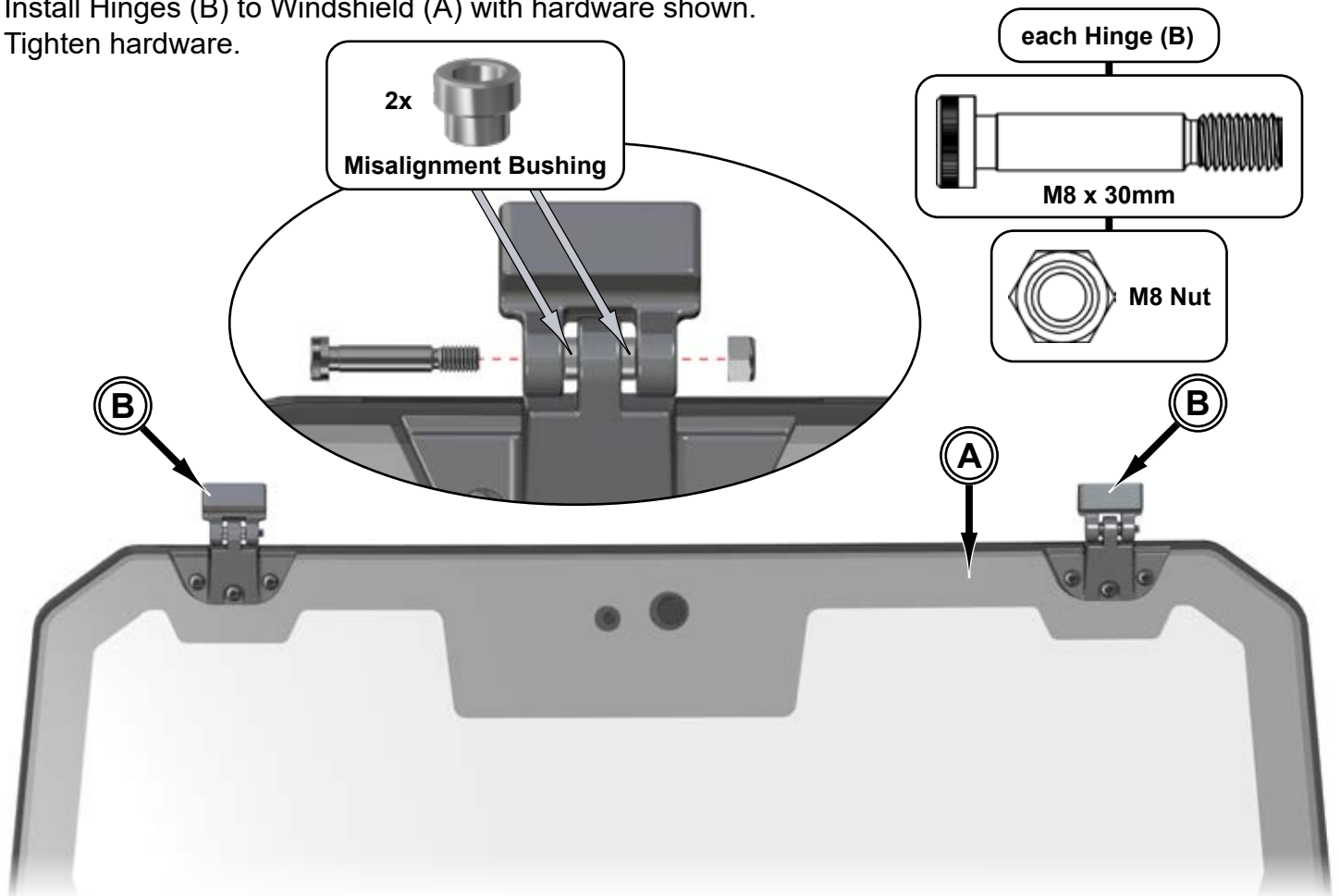

Windshield Wiper Kit only

Prep Wiper as shown.

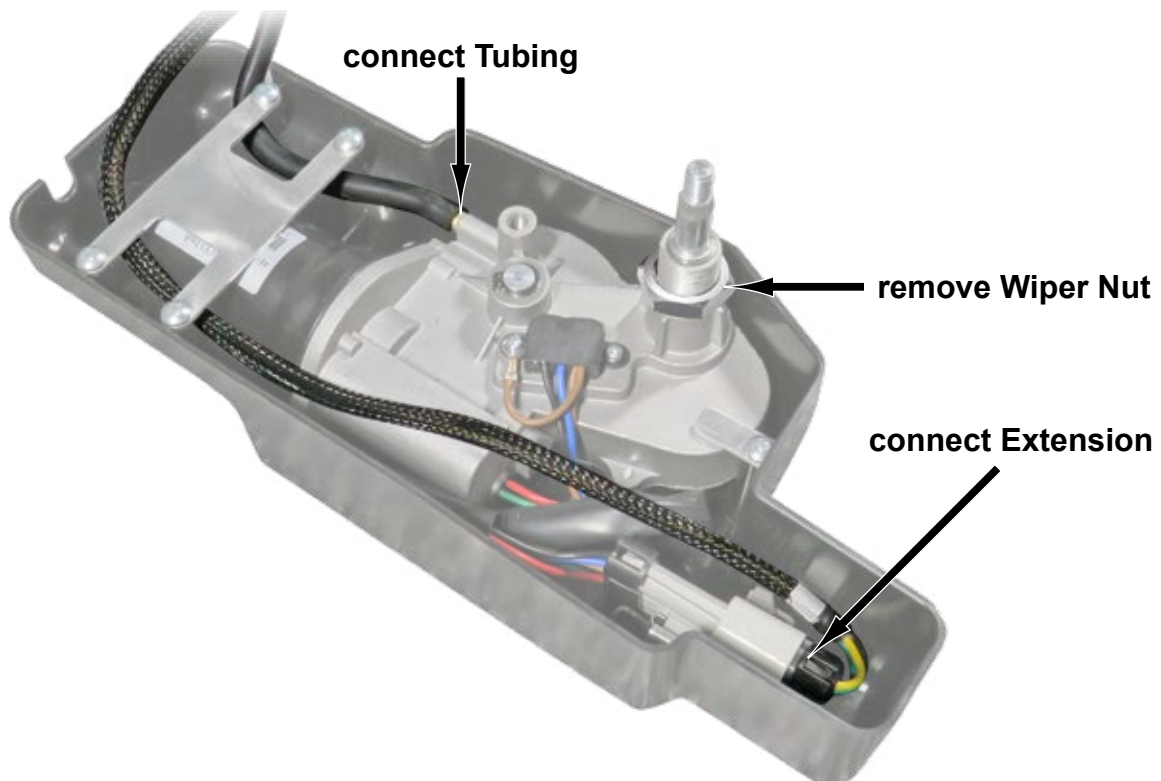

Windshield Wiper Kit only

- Remove Plugs from Windshield (A).
- Install Wiper to Windshield with components shown.
- Tighten hardware.

Nozzle should face bottom of Windshield and stick out approximately 13/16".

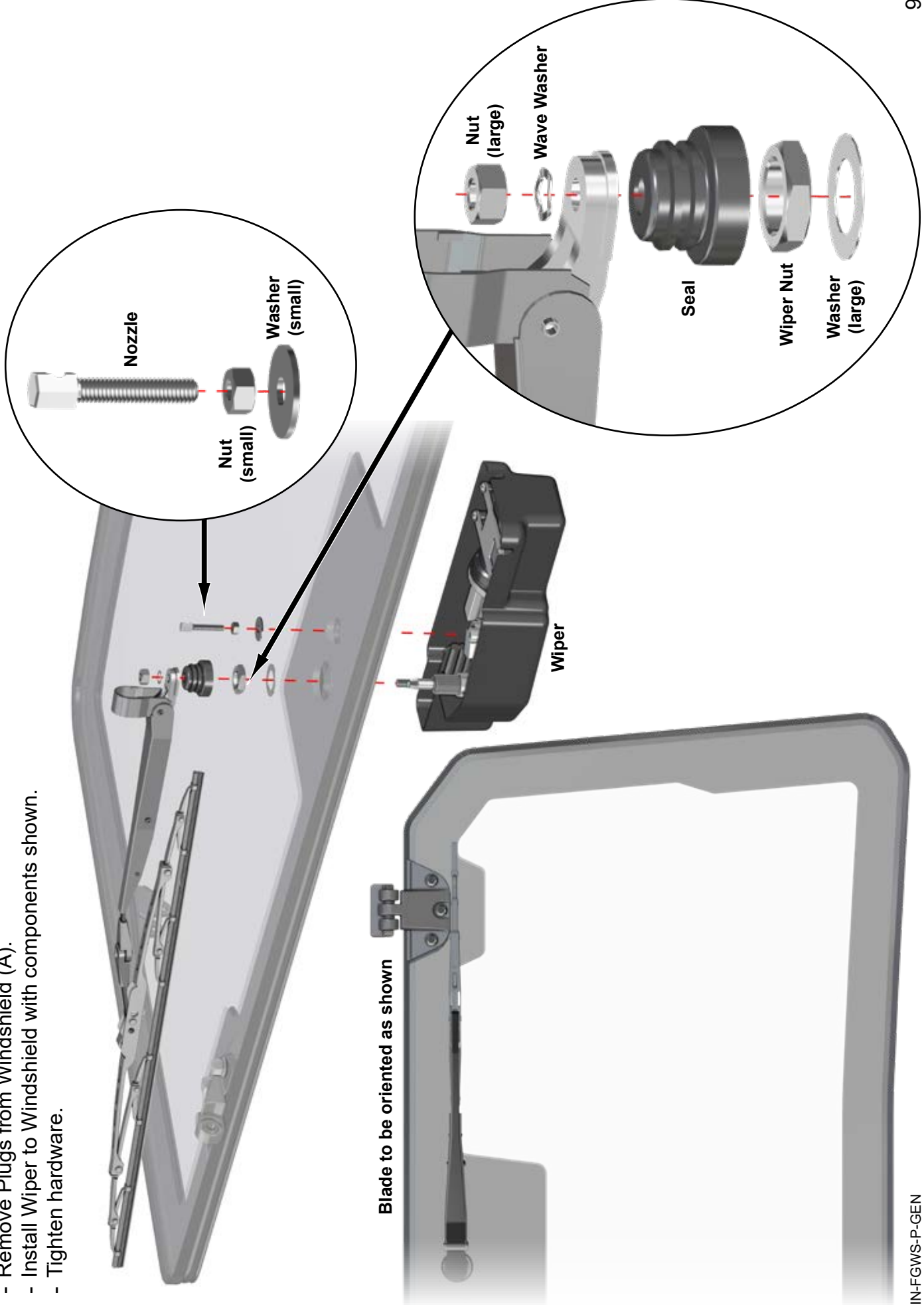

- Place Windshield (A) onto machine.



- Secure Hinges to Frame with hardware shown; do not tighten.
- Center and align Windshield assembly to machine.
- Tighten hardware.



- Secure Actuator (G) with hardware shown; tighten.
- Repeat for driver side.

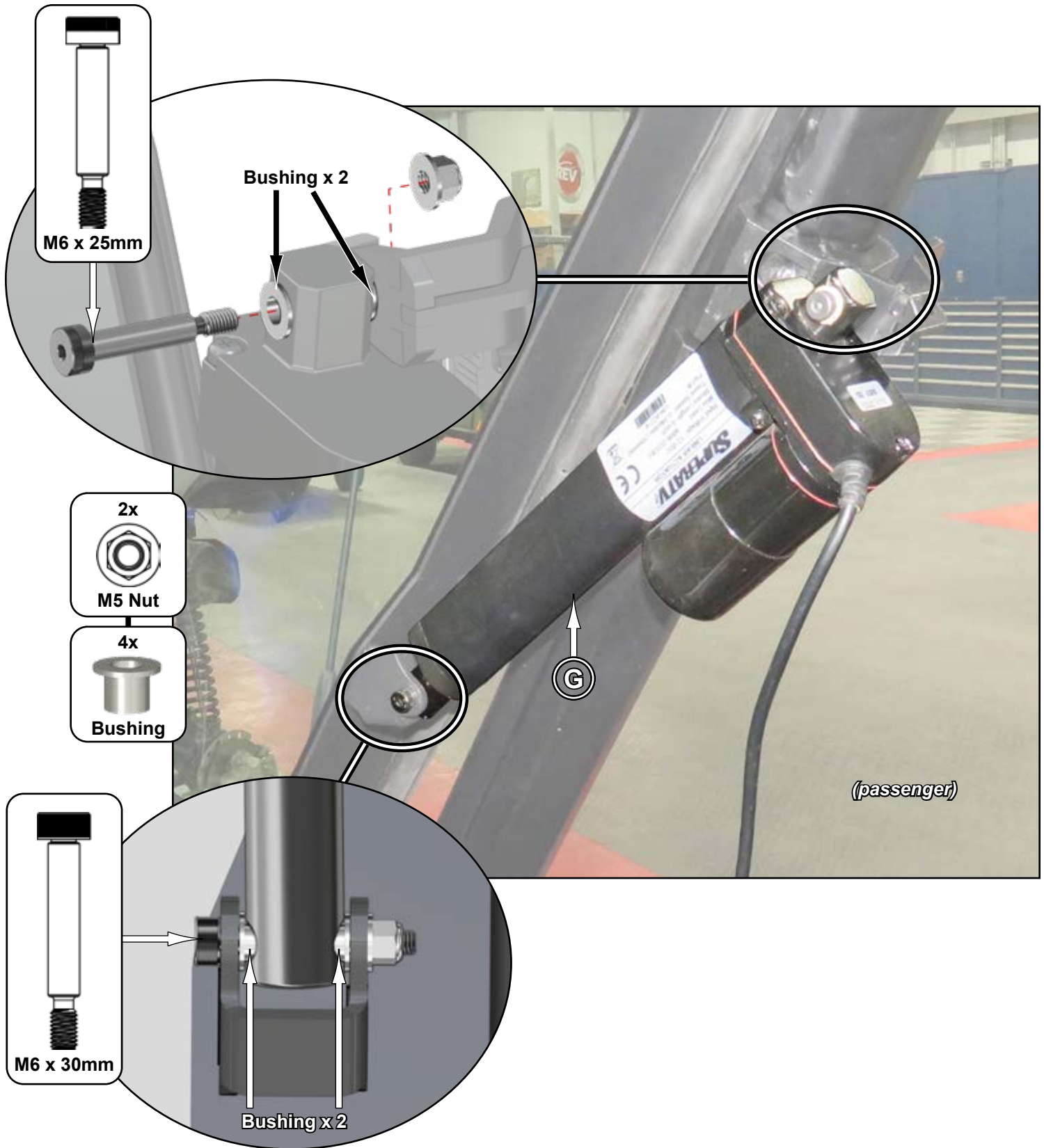



route Connectors shown through Grommet and into Upper Dash area





Older models will not have a Terminal Block and will use a stock Power Supply as shown.

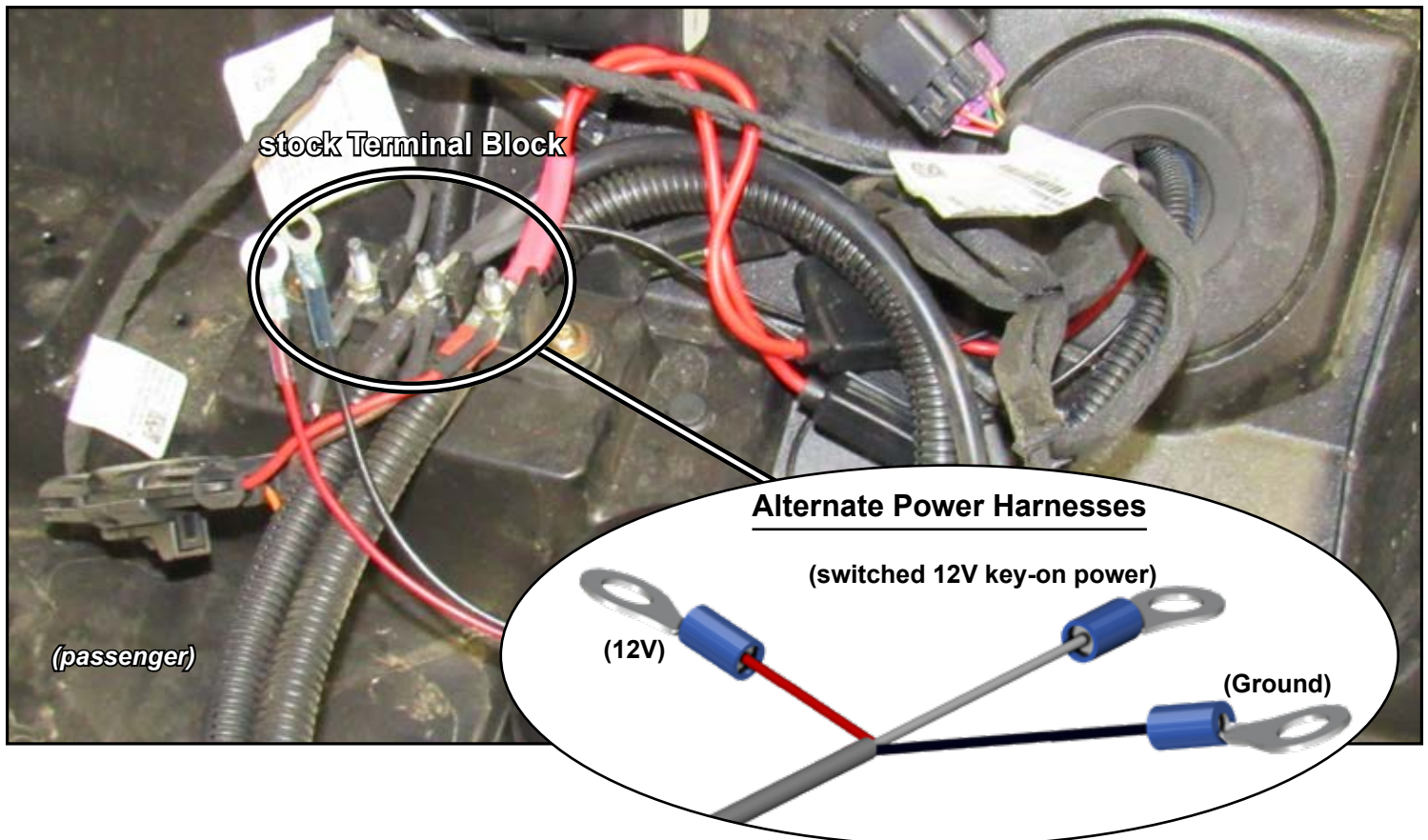

- Route Actuator connections to locations shown.

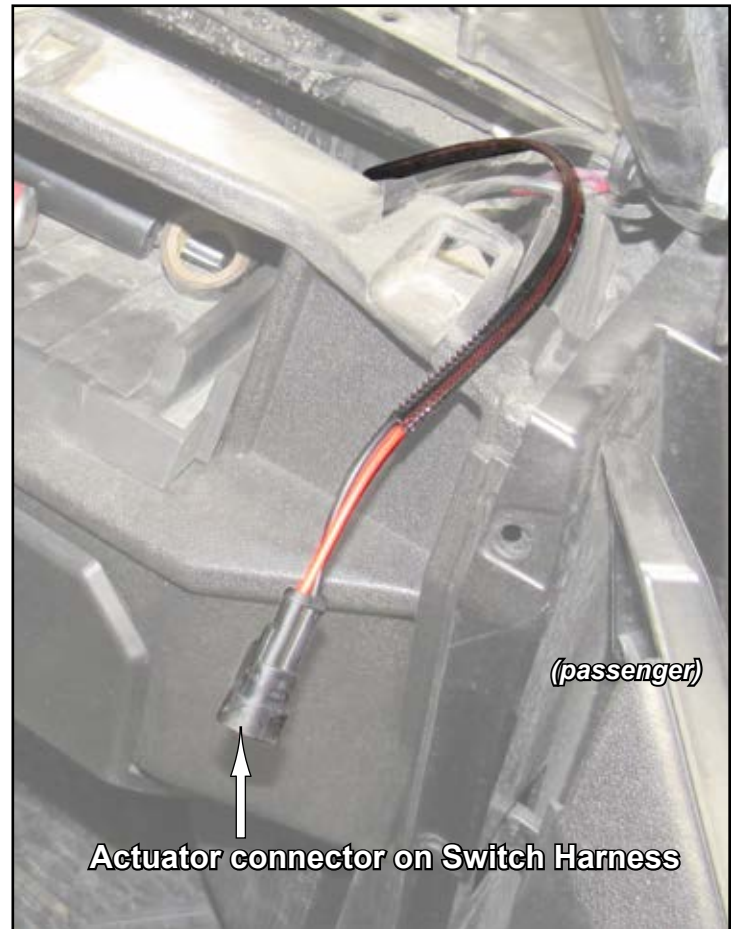



- Repeat for driver side.



Switch Mounting:

- Remove stock Knockouts or cut new locations.
- User may install Switches in locations different than shown.
- Verify that Harnesses will reach Switches before mounting and check behind areas to be cut for any interference.

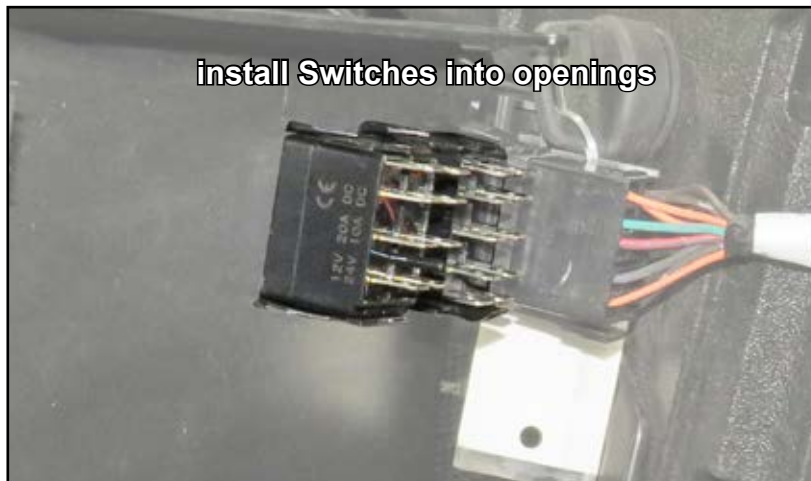

**if installing Windshield Wiper Kit, ensure that Switches match Harnesses;
don't connect Wiper Harness to Windshield open and close Switch**



Windshield Wiper Kit only



Windshield Wiper Kit only



Tank Bracket

(passenger footwell)



#8 x 3/4"

approximately 7"

approximately 1-3/4"

- Place Tank Bracket onto Firewall in locations shown.
- Install screw through hole in Tank Bracket; snug but not completely tight.
- Ensure that Tank Bracket is at 1-3/4" dimension shown and install remaining Screw through Slot in Tank Bracket.
- Tighten all hardware.

Windshield Wiper Kit only

- Connect Tank connector to Tank.
- Trim excess Tubing and connect to Tank.



- Slide Tank onto Tank Bracket.



- Cut Wire Guide (F) into 4 pieces; dimensions shown below.
- Place Actuator Wire into Wire Guide (F) and secure Wire Guide (F) to machine in location shown.

