

INSTALLATION INSTRUCTIONS

Half Door Kit: DOOR-CA-DEF-004

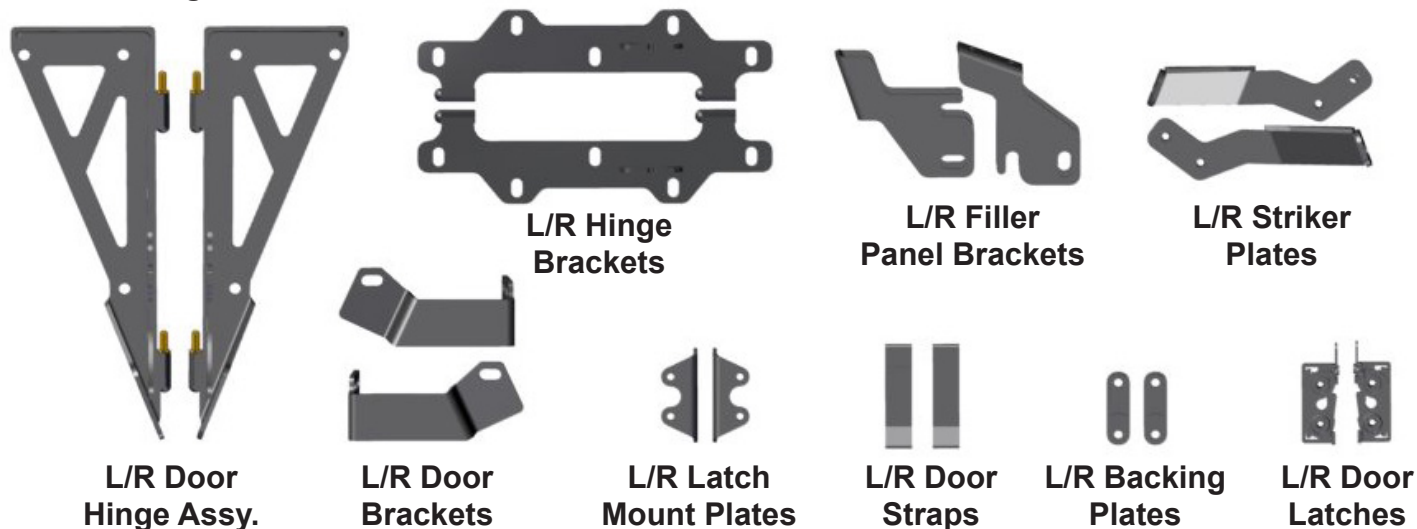
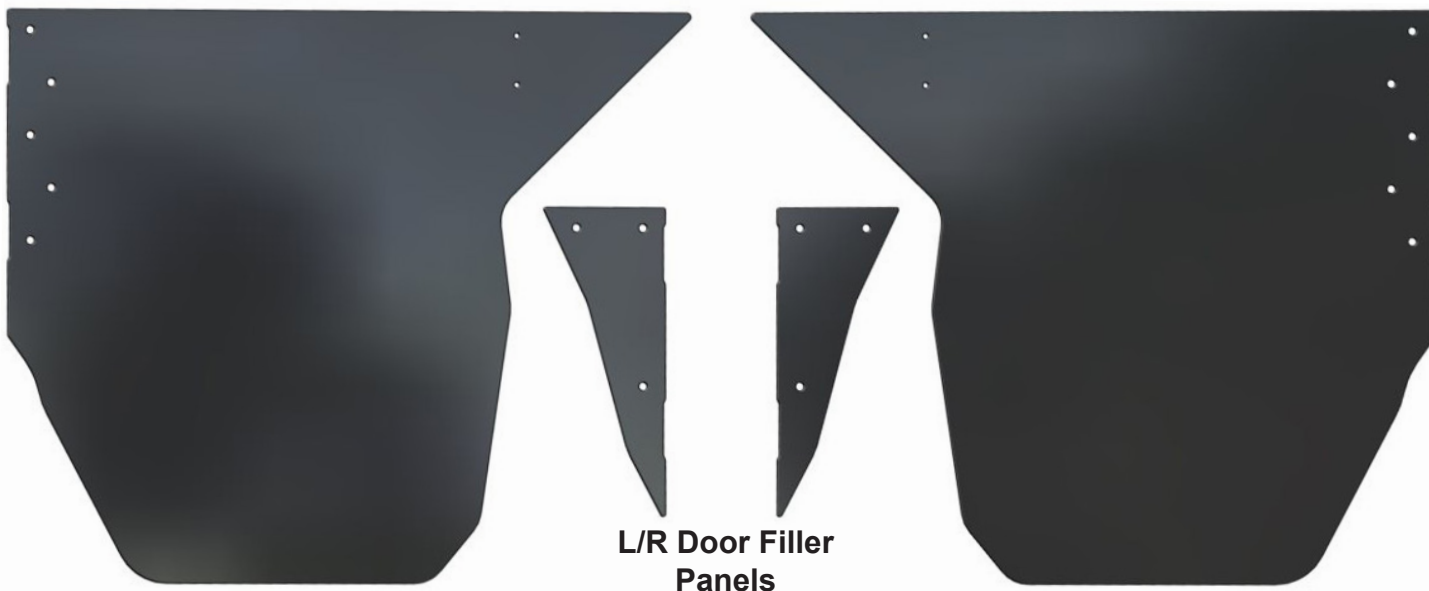

Bulb Seal-4050 (1pc)

Bulb Seal-1500 (1pc)

D-Shaped Adhesive Seal (1pc)



- 🕒 Please look through and read these instructions BEFORE starting so you understand what processes you'll be doing, and possible extra tools you may need.
- 🕒 Do Not discard product packaging until installation is complete and functioning properly.

NOTE: *We will be installing the Passenger's Side Door in these instructions. Repeat these same instructions for the Driver's Side as well.*

1. The first thing you need to do is install the Seals around the **Door Skins** and **Door Panels** as shown in **Fig.1a-d**. The **"D" shaped seal** is an adhesive backed seal. The **Bulb Seals** will simply slide onto the panels and skins.

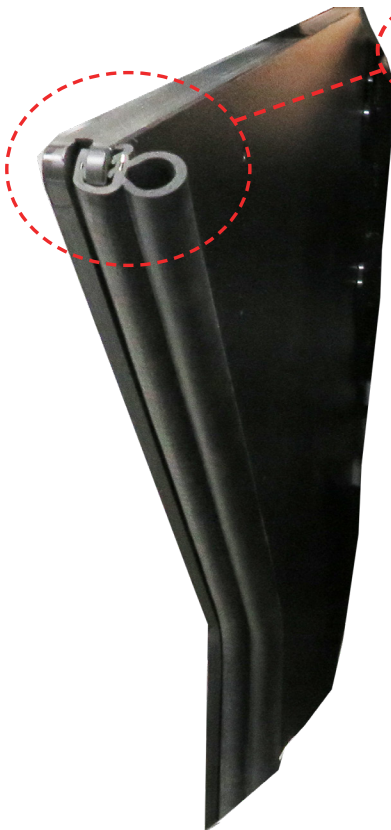

Fig.1a



Fig.1b

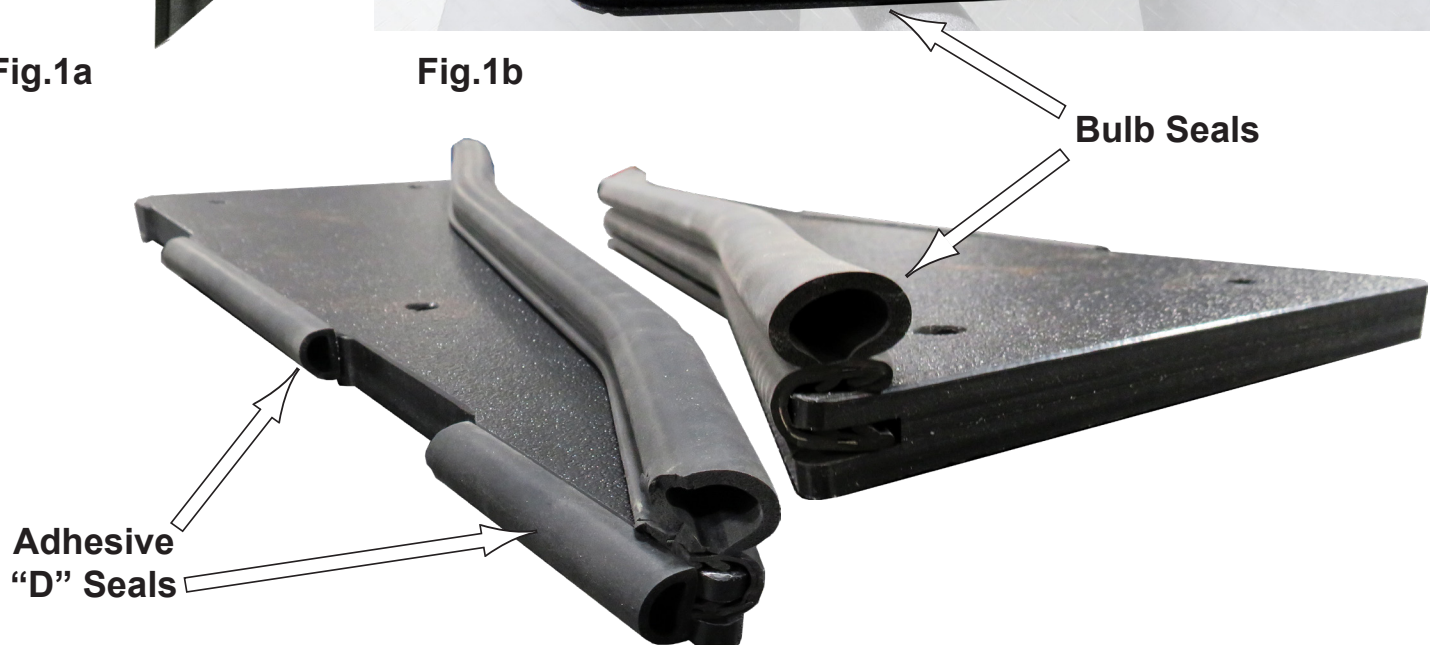

Fig.1c

2.Now you need to remove the side frame cover as shown in **Fig.2a**. Keep all screws as you will be reusing them to reinstall the cover.



Fig.2a



Fig.2b

3.Next you will need to remove the two (2) bolts on the lower frame as shown in **Fig.3a-c**. You will be installing the **Filler Panel Brackets** in this location next. See **Fig.3a-c**. Keep factory bolts as you will reuse them.

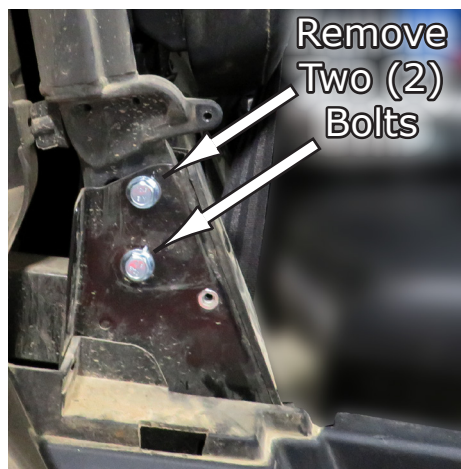

Fig.3a



Fig.3b

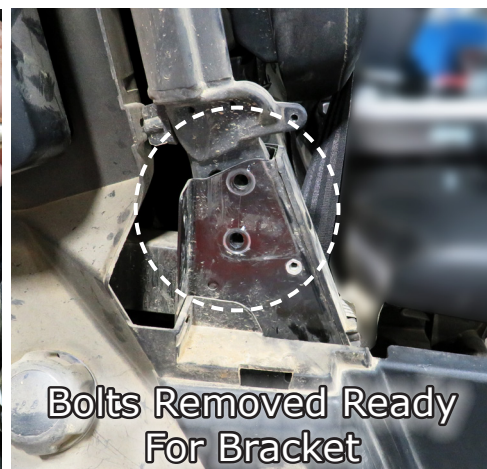

Fig.3c

4.Now locate the **Right Filler Panel Bracket** in your kit. You will be installing it over the exposed area of the frame as shown in **Fig.4a**. Also find the small **Backing Plate**, **M10x80 Hex Flanged** bolt and the **Black Zinc Spacer** all provided in your kit. **Fig.4b** shows these components and also the order in which they will be installed.

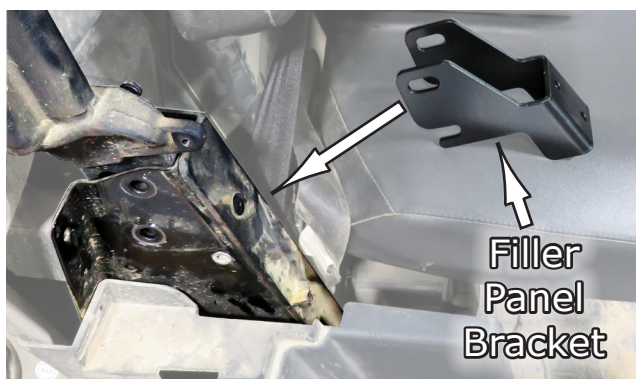

Fig.4a

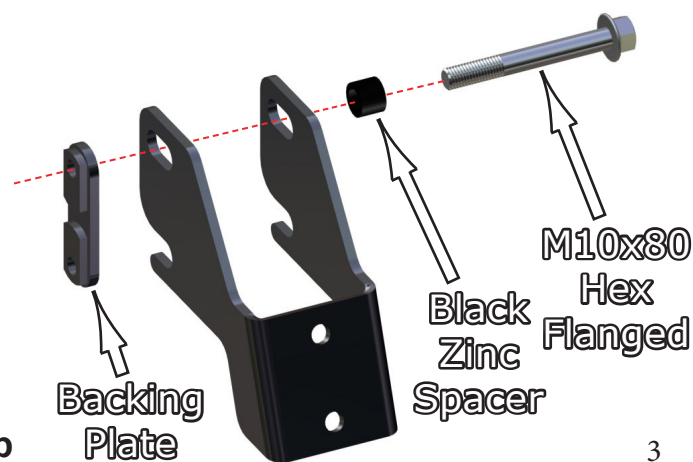

Fig.4b

5. So now install the **Black Spacer** onto the **M10x80 Bolt** and insert it into the bottom hole from the inside out as shown in **Fig.5a**. Run it all the way through and then take the **Backing Plate** with the welded nut facing out and thread the bolt onto the plate enough to hold the plate as shown in **Fig.5b**. Then slide the **Filler Panel Bracket** over the framing between the **Backing Plate** and the frame as shown in **Fig.5c**. Then install the other bolt in the top location. Tighten Securely. **Fig.5d**.

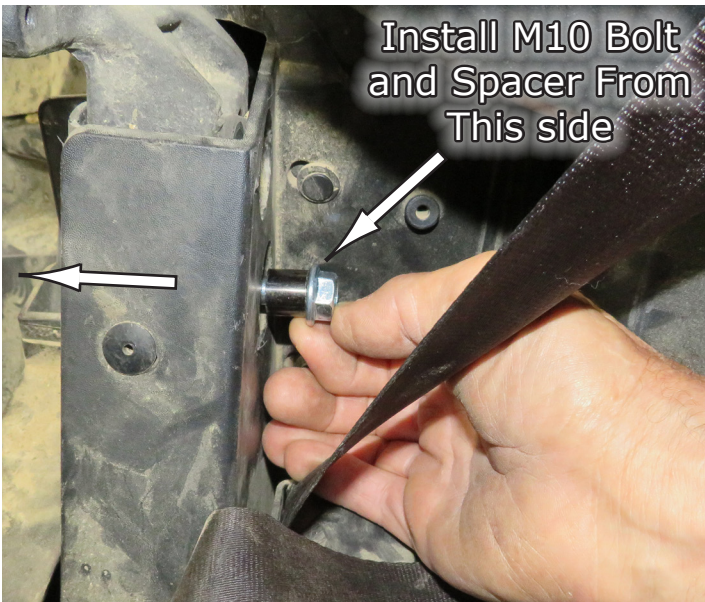

Fig.5a



Fig.5b



Fig.5c



Fig.5d



6. Now install the Cover back onto the machine using the same factory screws you removed previously. See **Fig.6**.



Fig.6

7. Next you need to install the **Door Bracket** from your kit. Install this using the factory bolts that come from those existing locations as shown in **Fig.7a-c**.

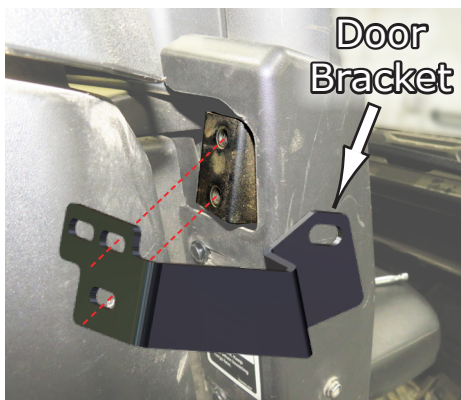

Fig.7a



Fig.7b

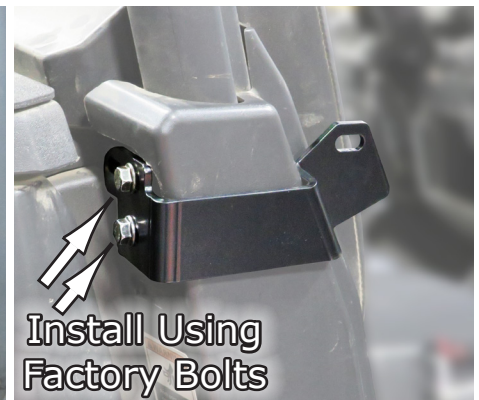

Fig.7c

8. After the **Door Bracket** is installed, you can now assemble the **Door Hinge Assembly** with the **Hinge Bracket**. The **Hinge Bracket** slides onto the **Hinge Assembly Pins** as shown in **Fig.8a-b**.



Fig.8a



Fig.8b

9. Now mount the **Hinge Assembly** onto the lower **Panel Bracket** you previously installed using the **M8x20 Hex Flanged** bolts provided in your kit as shown in **Fig.9a-c**. Do not tighten but just snug them a little so you can move the assembly around to adjust it when installing the other bolts and screws in the coming steps. See **Fig.9a-c**.



Fig.9a



Fig.9b

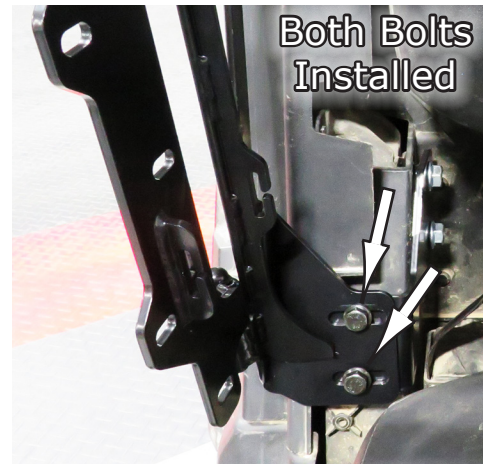

Fig.9c

10. Align the top hole as shown in **Fig.10a** as you will next be installing the **Door Filler Panel** over top of these brackets. See **Fig.10**.

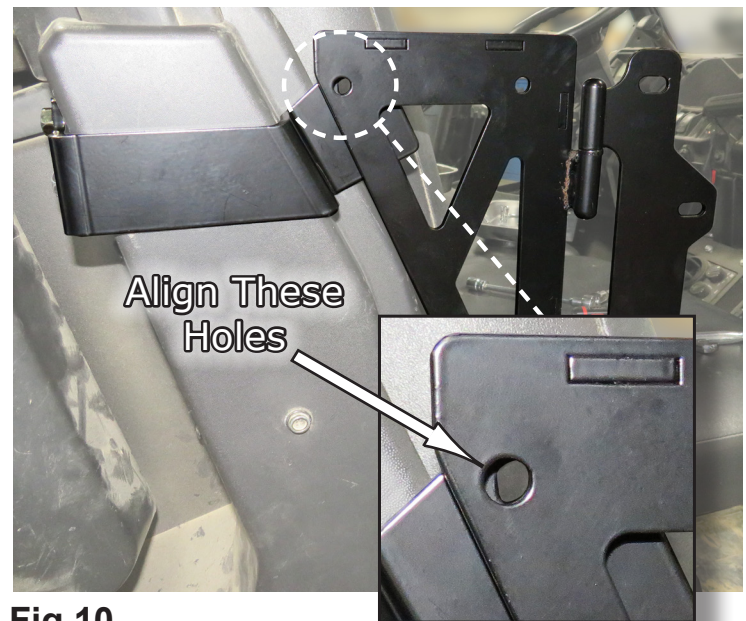

Fig.10

11. Then find the **Right Door Filler Panel** and install it to the **Hinge Assy.** using **(3) M8x16 Button Flanged** screws and **(3) Barrel Nuts** provided in your kit. Once all screws are installed with the Filler Panel, tighten all screws and bolts securely. See **Fig.11a-d**.

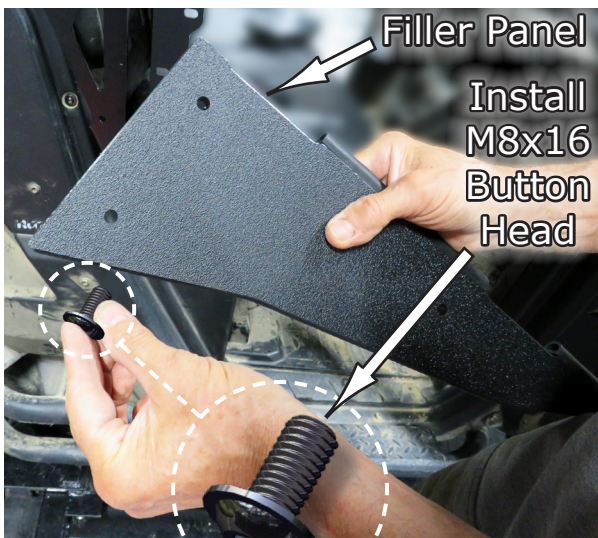

Fig.11a



Fig.11b

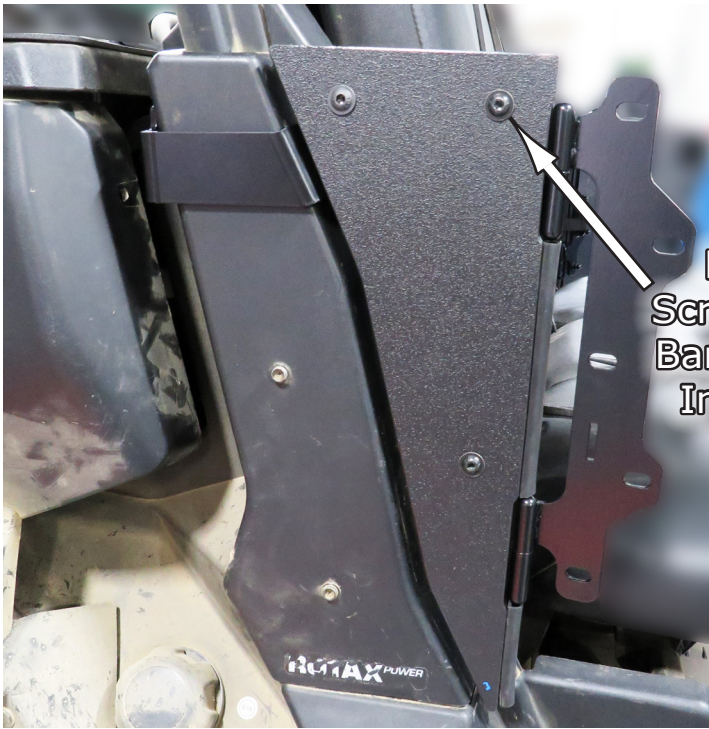

Fig.11c



Fig.11d

NOTE: After you have mounted the **Filler Panel**, you may notice that the **Bulb Seal** is pinched up against the bracket, as shown in **Fig.A-1**, and doesn't allow the seal to properly seal against the body. If this is not desirable to you, you can cut the bulb off or around the bracket to make a better fit. See **Fig.A-2**.

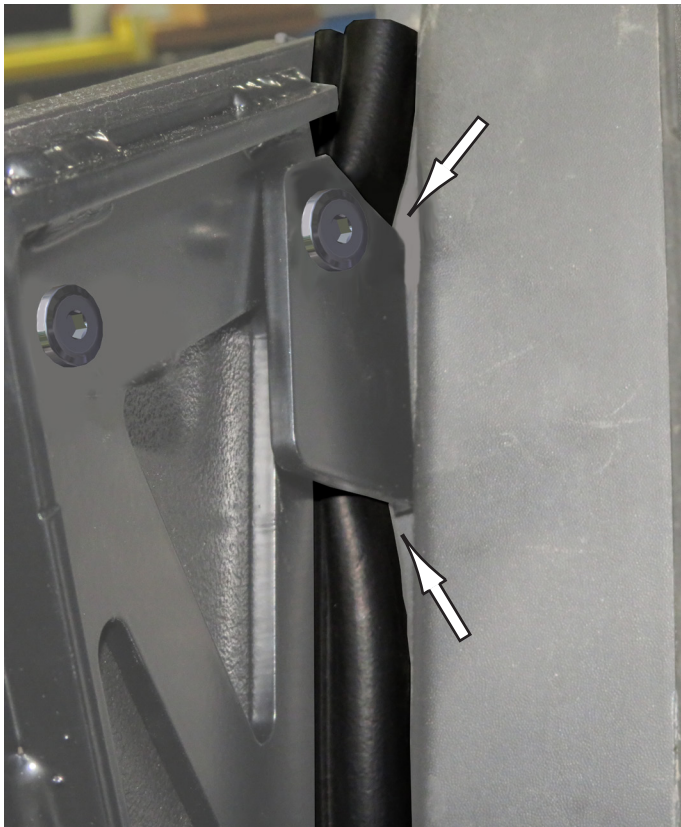

Fig.A-1

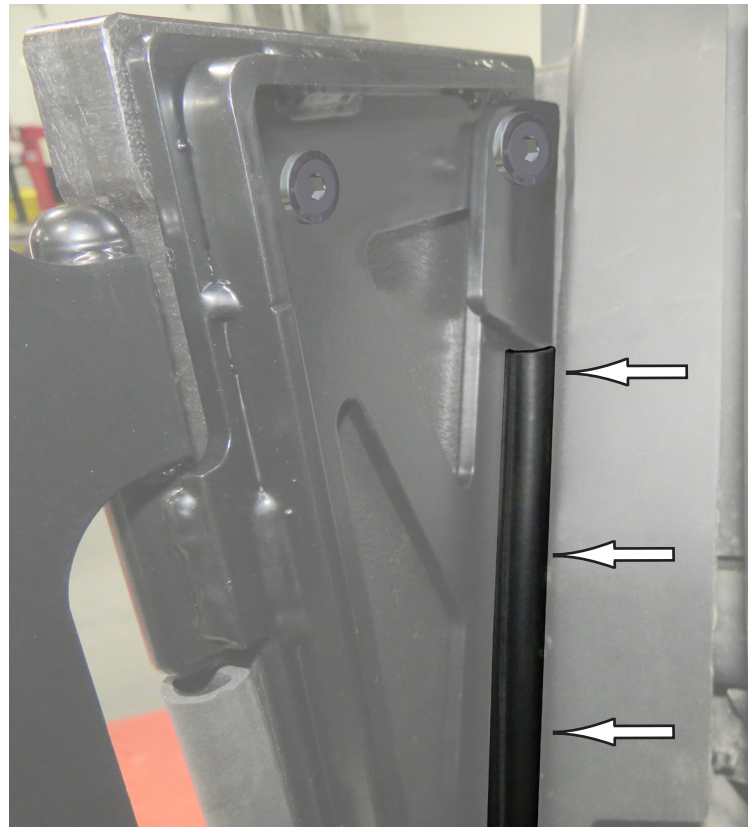

Fig.A-2

12. After the **Filler Panel** is installed, you can now install the main **Door Skin**. Install using (5) **M8x12 Flanged Button Head** screws and (5) **Barrel Nuts** provided in your kit. See **Fig.12a**. You may want to get a spacer 1/2"-3/4" or so to hold the door skin up on a more level plane while installing the screws especially if installing by yourself. See **Fig.12b**. After inserting all the screws in the **Door Skin** with them a little loose, lift up on the front end of the door and push it back towards the rear as to close any gaps between the **Door Skin** and the **Filler Panel**. This will help give a more straight alignment visually. Then Tighten all screws. See **Fig.12c-d**.

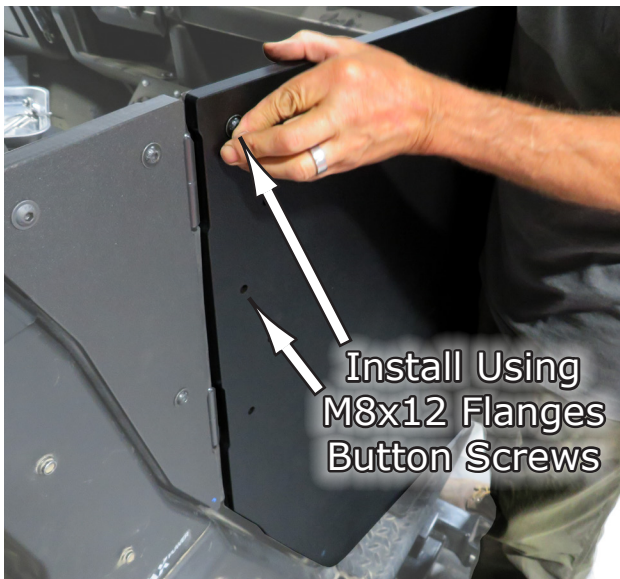

Fig.12a

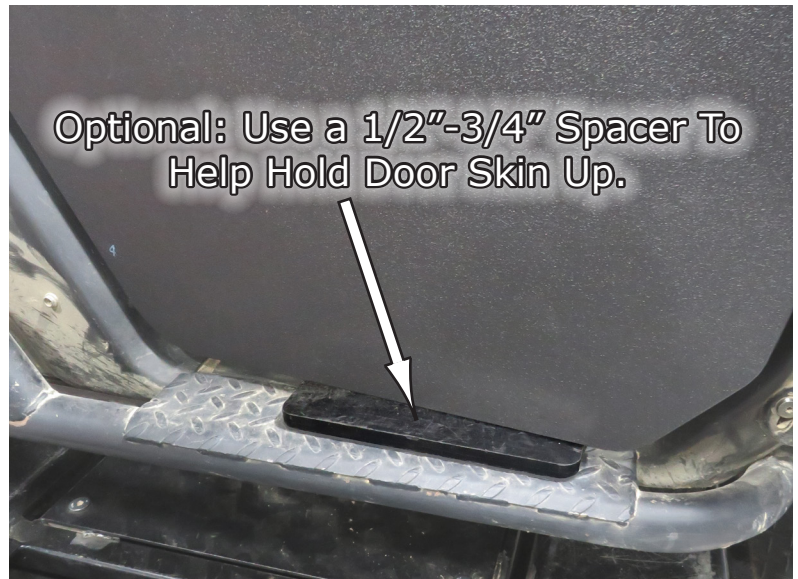

Fig.12b

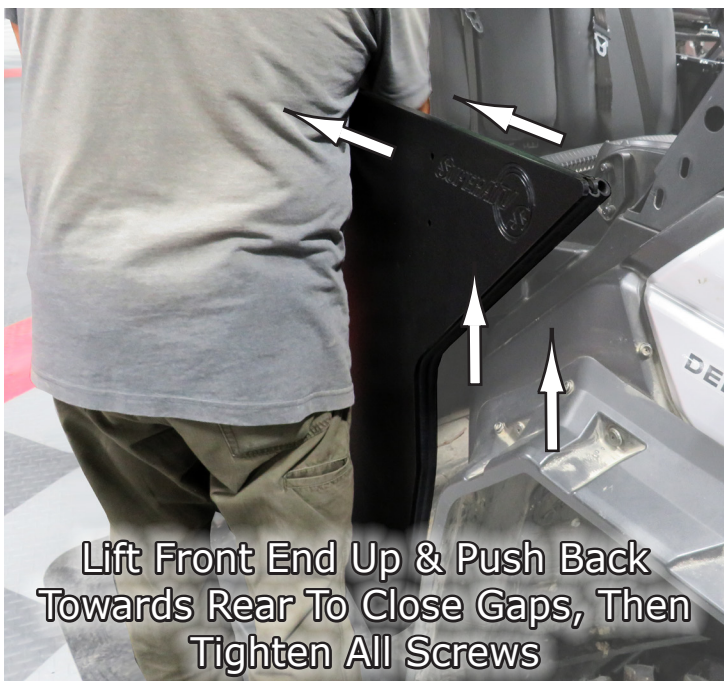

Fig.12c

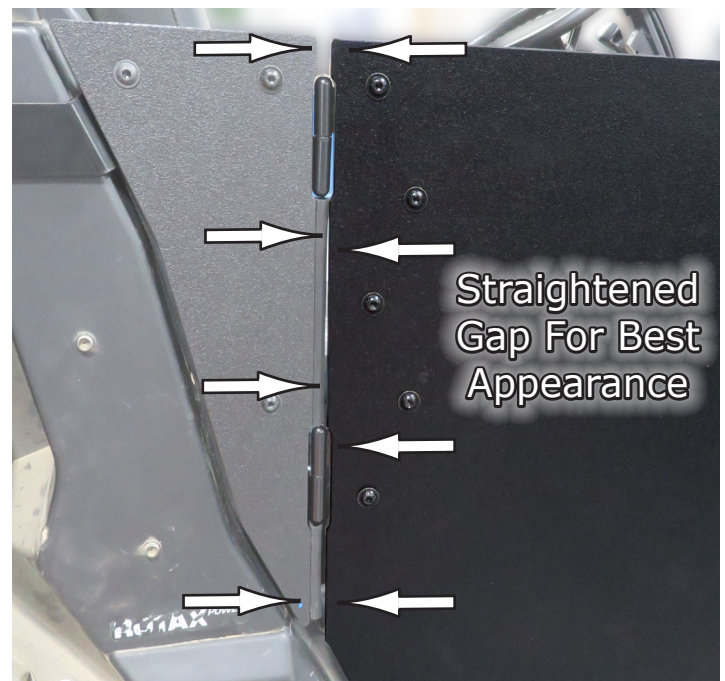

Fig.12d

13. Once the **Door Skin** is installed, open and shut it to see that it fits properly when in the closed position without the latch installed yet. Make any adjustments at this point if needed. Yours should look like the one in **Fig.13**.

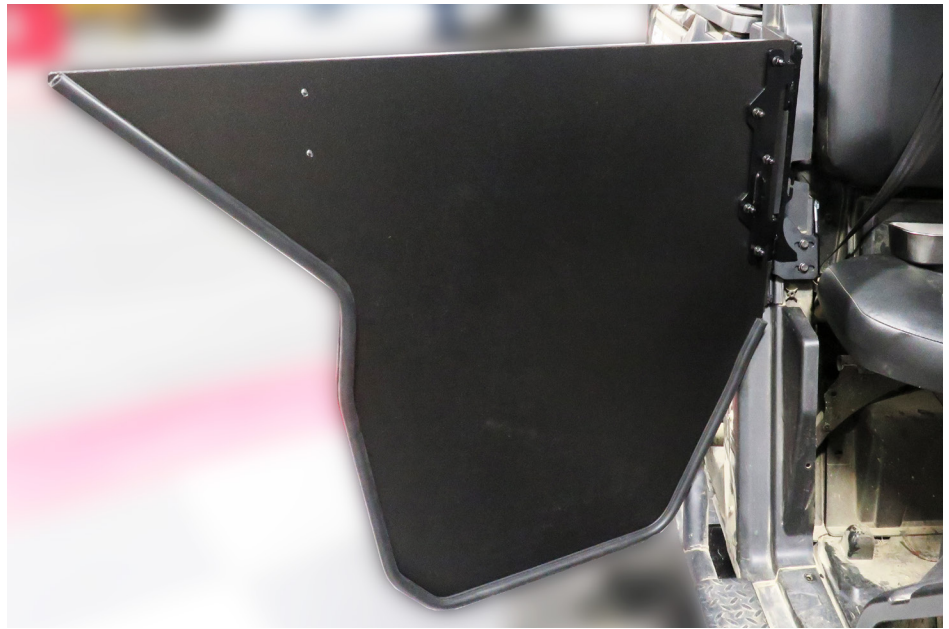

Fig.13

14. Next you will need to install the Right **Striker Plate** into the frame as shown in **Fig.14a-c**. Install it using the **M8x16 Button Flanged** screw provided in your kit. Then install the **Striker Bolt**, **M10 Jam Nut** and **M10 Flat Washers** (if needed), also provided in your kit, onto the **Striker Plate** as shown in **Fig.14d**.



Fig.14a



Fig.14b



Fig.14c

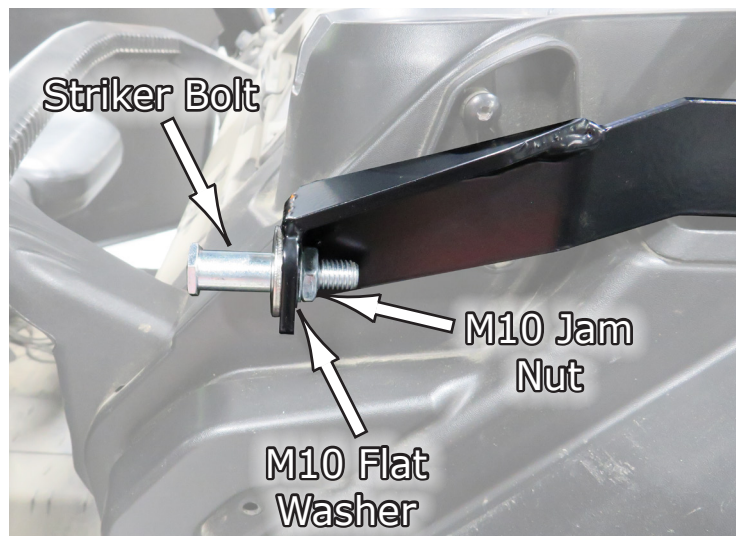

Fig.14d

15. Now you are ready to install the **Door Latch Assembly** to the Door. However, you need to assemble the latch before installing it. Below shows the components in your kit to assemble together. Assemble and tighten **Nylock Nuts** securely. See **Fig.15**.

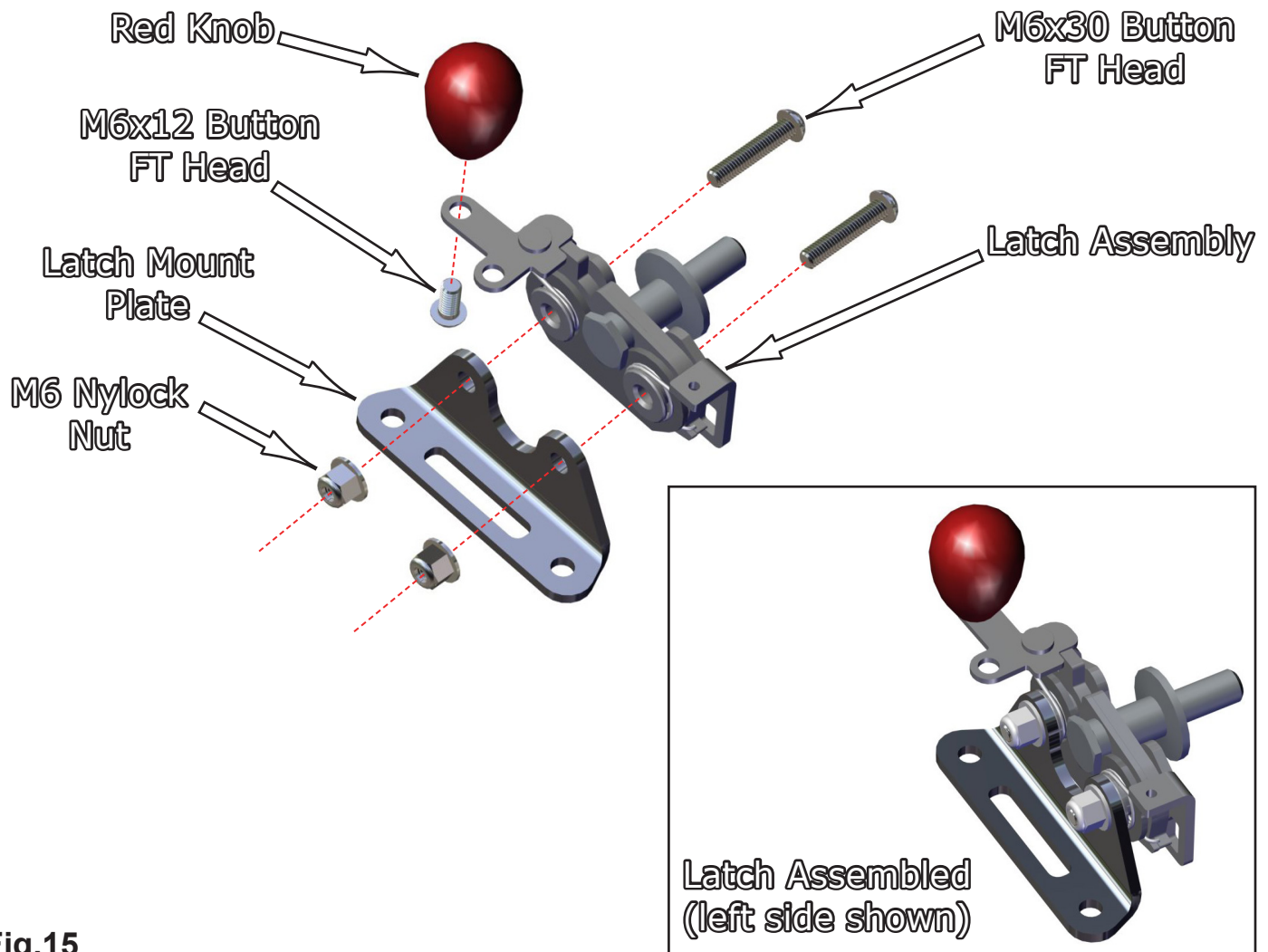

Fig.15

16. First, find the two (2) holes in the **Door Skin Panel** as shown in **Fig.16a**, then mount the assembly on the inside of the door and attach using the **M6x30 Button FT Head** screws and **M6 Nylock Nuts** as shown in **Fig.16b-c**.



Fig.16a

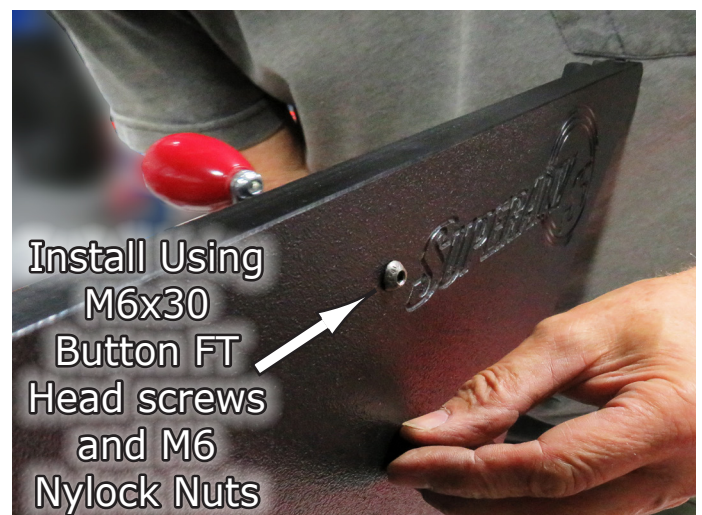

Fig.16b



Fig.16c

17. Once the **Latch Assy** is installed, now test it out by shutting and opening the door, making sure that the Latch catches onto the **Striker Bolt** and that you can open it easily without it catching or holding up. If alignment isn't correct, use washers or spacers to move the Striker Bolt forward or if needed, and adjust any other areas needed to make it function properly. See **Fig.17**.

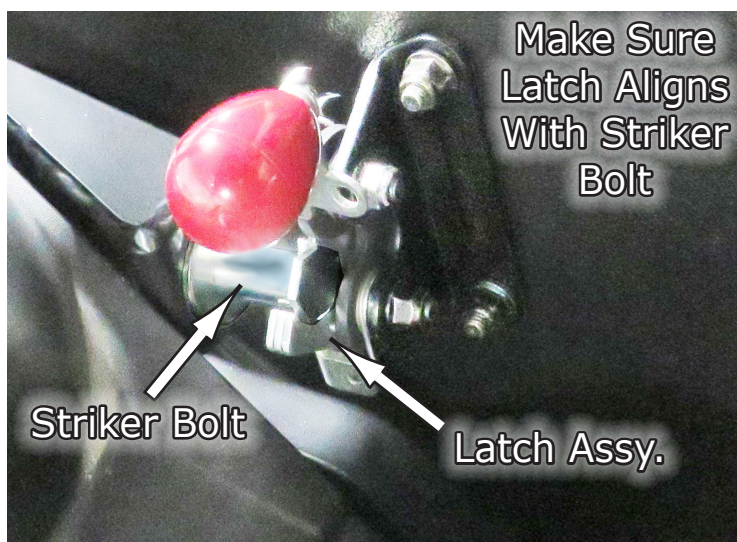

Fig.17





Liability Statement

SuperATV's® products are designed to best fit user's ATV/UTV under stock conditions. Adding, modifying, or fabricating any factory or aftermarket parts will void any warranty provided by SuperATV® and is not recommended. SuperATV's® products could interfere with other aftermarket accessories. If user has aftermarket products on machine, contact SuperATV® to verify that they will work together.

Although SuperATV® has thousands of satisfied customers, user should be aware that installing lift kits, long travel, or suspension kits, tires, etc. will change the ride of machine and may increase maintenance and part wear. Operating any off-road machine while, or after, consuming alcohol and/or drugs increases risk of bodily harm or death. No warranty or representation is made as to this product's ability to protect user from severe injury or death. SuperATV® urges operators and occupants to wear a helmet and appropriate riding gear at all times.

By purchasing and installing SuperATV® products, user agrees that should damages occur, SuperATV® will not be held responsible for loss of time, use, labor fees, replacement parts, or freight charges. SuperATV®, nor any 3rd party, will not be held responsible for any direct, indirect, incidental, special, or consequential damages that result from any product purchased from SuperATV®. The total liability of seller to user for all damages, losses, and causes of action, if any, shall not exceed the total purchase price paid for the product that gave rise to the claim.

SuperATV® will warranty only parts provided by SuperATV®. Any damage or problems with OEM housings, bearings, seals, or other manufacturers' products will not be covered by SuperATV®. SuperATV® parts and products are not warrantied if item was not installed properly, misused, or modified.

Installing, adding, modifying, or fabricating any factory or aftermarket product to your ATV/UTV may violate certain local, state, and federal laws. Be advised that laws vary depending on town, city, county, state, etc. Use of certain products on public streets, roads, or highways may be in violation law. The Buyer is solely and exclusively legally and personally responsible for any violation of the law by the installation or use of the product. You must abide by all local, state, and federal laws, including but not limited to vehicle safety, traffic laws, and ordinances. It is your responsibility to know the laws and how they apply to you.

The Buyer is responsible to fully understand the capability and limitations of his/her vehicle according to manufacturer specifications, warnings and instructions and agrees to hold SuperATV® harmless from any damage resulting from failure to adhere to such specifications, warnings and/ or instructions. The Buyer is also responsible to obey all applicable federal, state, and local laws and ordinances when operating his/her vehicle while using this product, and the Buyer agrees to hold SuperATV® harmless from any violation thereof.

If you have any problems/questions on this kit, contact us by email
at Superatv.com.

Need help with your installation?



sales@superatv.com



www.superatv.com



1-855-743-3427



8:00am - 9:00pm EST M-Th
8:00am - 7:00pm EST Friday
9:00am - 2:00pm EST Saturday

*Thank You
For Choosing*



Like SuperATV on Facebook to keep up to date on new products!