



**DOWNLOAD COLOUR  
INSTALL MANUALS AT  
[www.bddiesel.com](http://www.bddiesel.com)**



# **LB7 INJECTOR FEED LINE**

**Duramax High Pressure Injector Line**

**1050140**





**Chevrolet Silverado HD 2001-2004  
GMC Sierra HD 2001-2004  
Chevrolet Kodiak 2003-2004  
GMC Topkick 2003-2004**

**1050141**

**Injector Install Kit; Duramax LB7**

**WARNING: WEAR SAFETY GLASSES WHEN WORKING WITH HIGH  
PRESSURE FUEL SYSTEMS**

## Kit Contents

1501140	1501141
	
Fuel Line Cylinder 1/8	Fuel Line Cylinder 2/7
<b>Qty: 2</b>	<b>Qty: 2</b>
1501142	1501143
	
Fuel Line Cylinder 3/6	Fuel Line Cylinder 4/5
<b>Qty: 2</b>	<b>Qty: 2</b>

## Table of Contents

Kit Contents .....	2
Table of Contents.....	2
Introduction .....	2
Tools Required for Installation .....	2
Installation.....	3
Removal .....	3

## Introduction

This kit is designed by BD Diesel to give you true to OEM fuel line fitment to allow for easy installation. Every single line is checked for quality and fitment at BD Diesel to guarantee fit to the LB7 engine.

## Tools Required for Installation

- 5/16" Wrench
- 5mm Allen Bit
- 19mm Wrench (3/4" Can be used)
- 8mm Allen Bit
- Torque Wrench

## Installation

### Removal

Disconnect both vehicle batteries before installation.

Drain coolant and remove upper radiator hose.

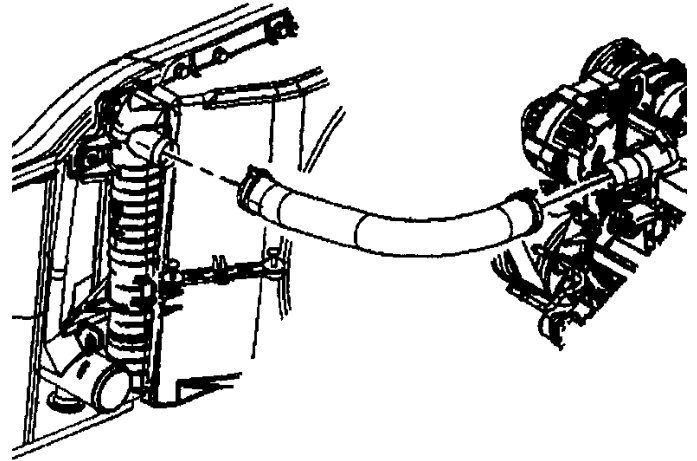

Remove air inlet and outlet hose, and battery junction box positive cable.

**NOTE:** Cover turbocharger to keep foreign materials out.

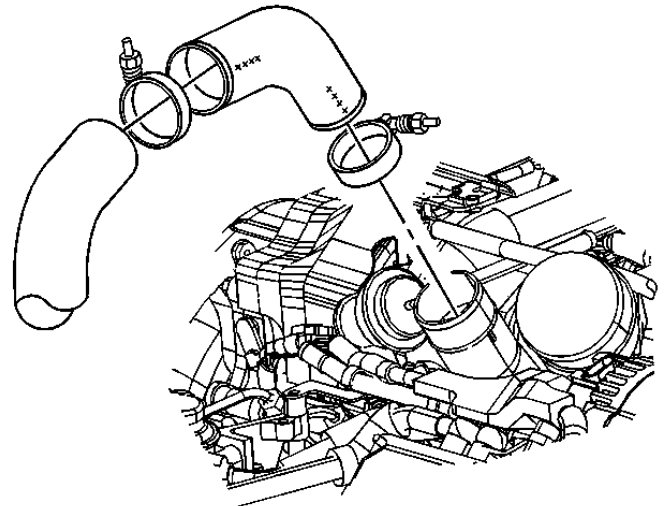

Disconnect the 3 glow plug relay connectors from the driver side valve cover.

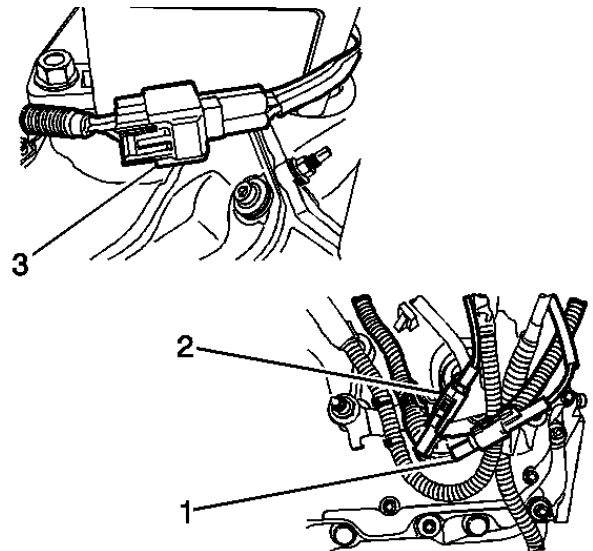

Remove the glow plug bracket, and disconnect both 40 and 24 pin engine connectors from the driver side valve cover.

Remove the engine connector bracket and set aside.

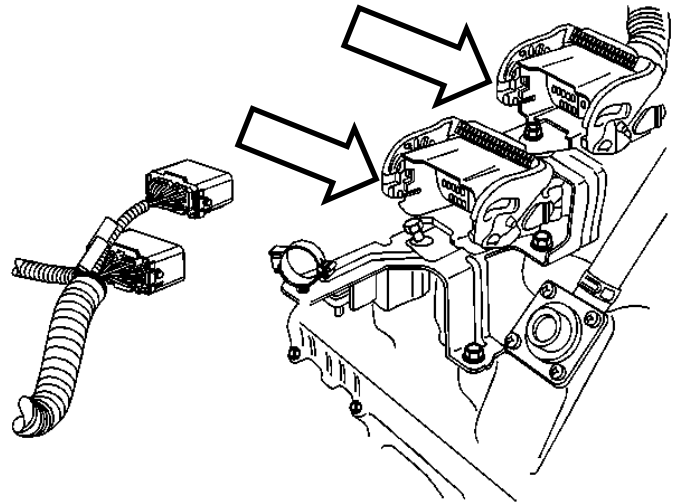

Disconnect fuel supply line and return lines.

Remove L-bracket holding fuel tubes.

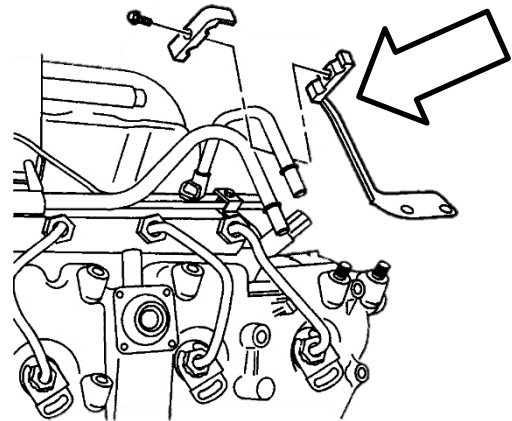

Remove the PCV hose and clamp from the driver and passenger side valve cover.

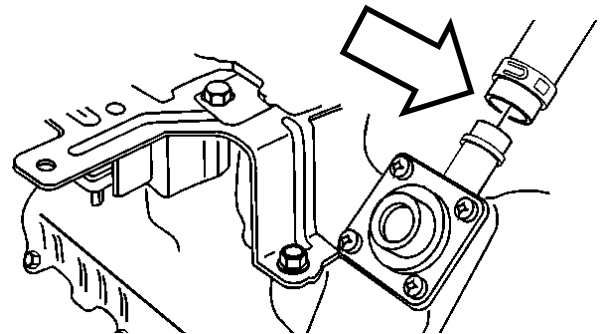

Remove the fuel injection control module from the passenger side valve cover.

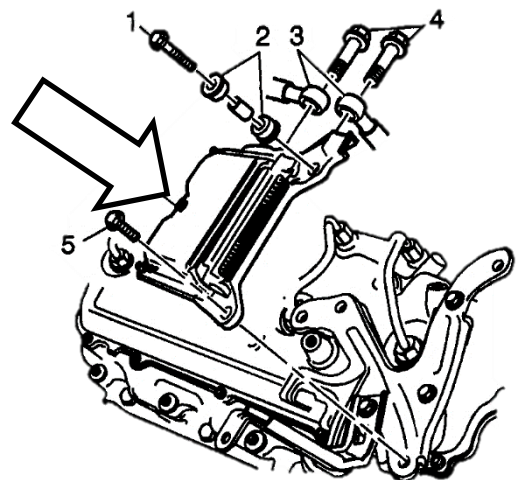

Disconnect and remove the fuel filter and housing.

**NOTE:** Drain fuel from the fuel filter prior to removal

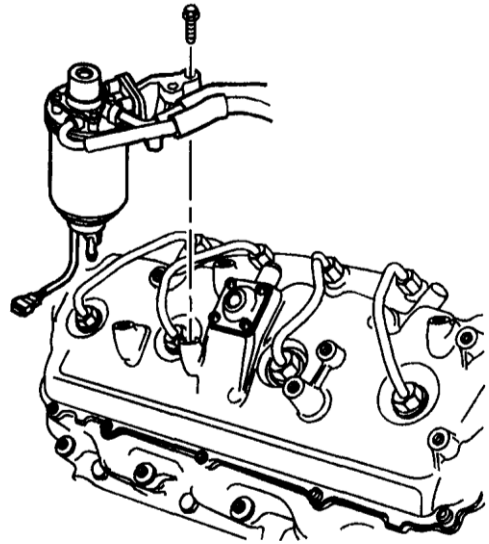

**\*CALIFORNIA MODEL TRUCKS ONLY\***

Remove EGR valve from passenger side.

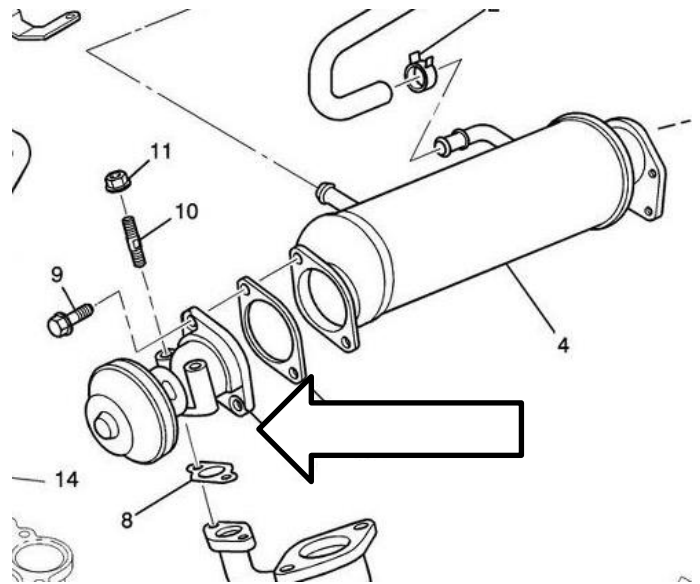

Remove water pipe outlet from the thermostat housing

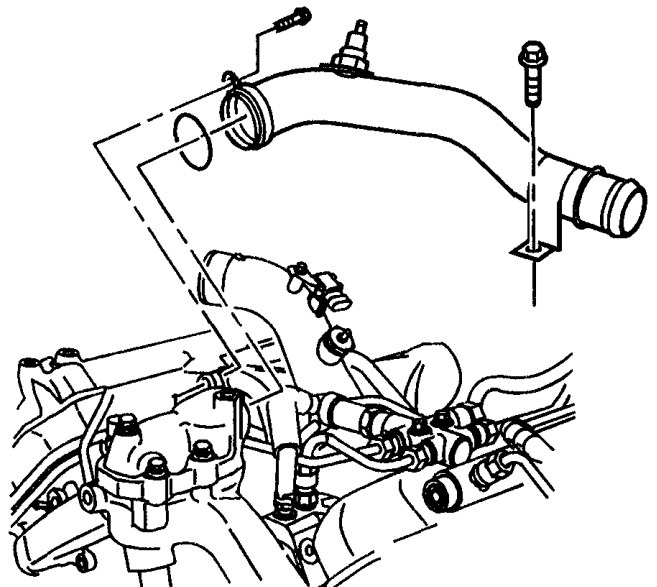

Loosen and remove serpentine belt.

Remove the 4 bolts holding A/C compressor.

**NOTE:** Flip unit aside and out of the way. This is done as it is unnecessary to disconnect the compressor and drain the refrigerant.

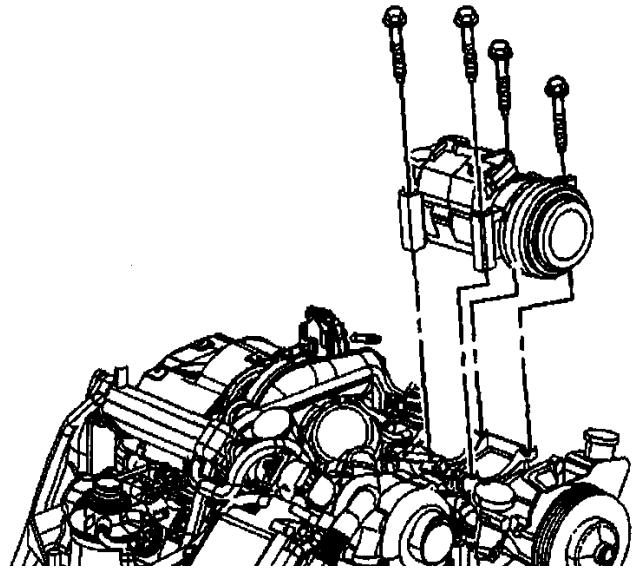

Remove the anti-rotation locks, and high-pressure injection lines.

**NOTE:** Loosen fittings on the injector side of the line first.

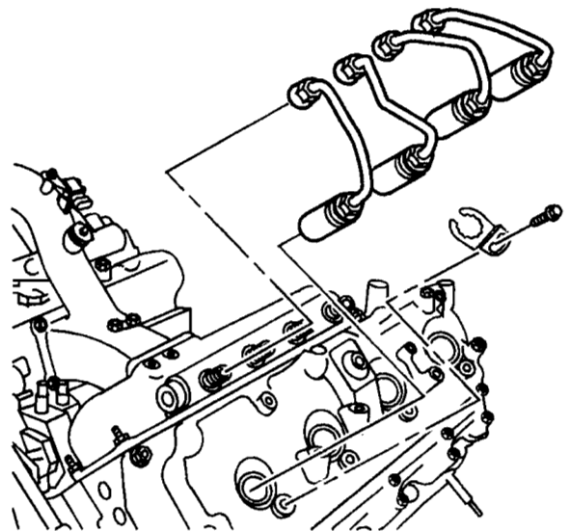

**IF INSTALLING INJECTORS, PLEASE INSTALL THEM NOW**

Installation is reverse of removal.

### Torque Specs:

Injector Lines: 41 N.m (30 ft-lbs)

Anti-rotation lock screws:  
4 N.m (35 in-lbs)

**IMPORTANT** - Clean area around injector lines prior to removal to prevent dirt from falling into the engine, if necessary, use compressed air.

**WARNING** - Improper torque methods will result in fuel leaks and possible engine damage.

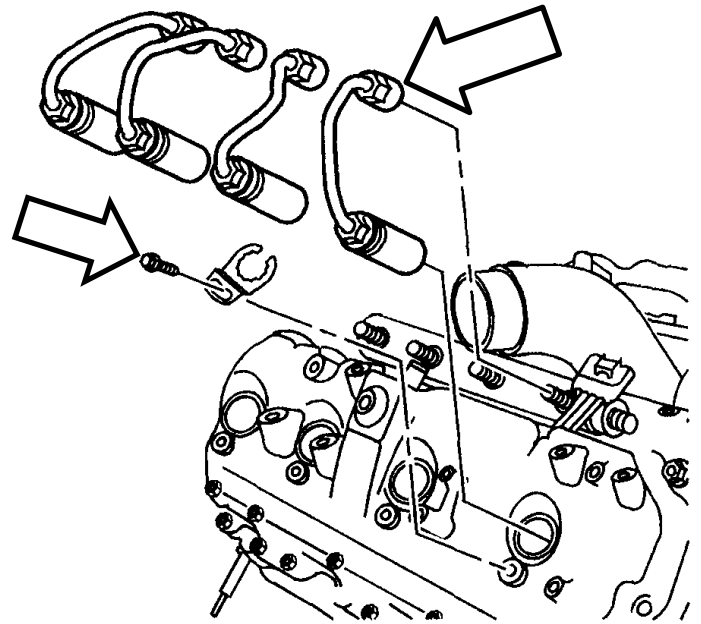

Once all components have been reinstalled, be sure to check all connection points are tight and inspect for leaks.

