

- Do not discard packaging until product has been successfully installed.

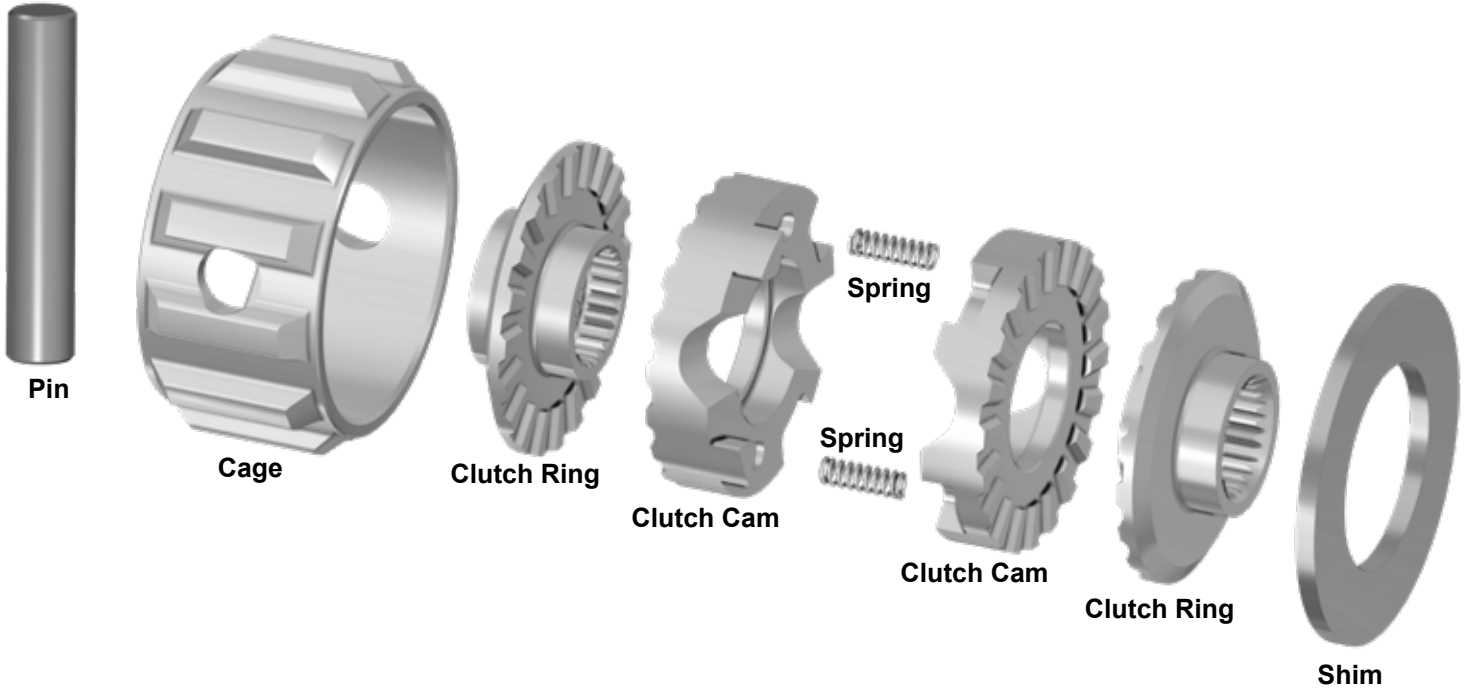

Liability Statement

SuperATV's[®] products are designed to best fit user's ATV/UTV under stock conditions. Adding, modifying, or fabricating any factory or aftermarket parts will void any warranty provided by SuperATV[®] and is not recommended. SuperATV's[®] products could interfere with other aftermarket accessories. If user has aftermarket products on machine, contact SuperATV[®] to verify that they will work together.

Although SuperATV[®] has thousands of satisfied customers, user should be aware that installing lift kits, long travel, or suspension kits, tires, etc. will change the ride of machine and may increase maintenance and part wear. Operating any off-road machine while, or after, consuming alcohol and/or drugs increases risk of bodily harm or death. No warranty or representation is made as to this product's ability to protect user from severe injury or death. SuperATV[®] urges operators and occupants to wear a helmet and appropriate riding gear at all times.

By purchasing and installing SuperATV[®] products, user agrees that should damages occur, SuperATV[®] will not be held responsible for loss of time, use, labor fees, replacement parts, or freight charges. SuperATV[®], nor any 3rd party, will not be held responsible for any direct, indirect, incidental, special, or consequential damages that result from any product purchased from SuperATV[®]. The total liability of seller to user for all damages, losses, and causes of action, if any, shall not exceed the total purchase price paid for the product that gave rise to the claim.

SuperATV[®] will warranty only parts provided by SuperATV[®]. Any damage or problems with OEM housings, bearings, seals, or other manufacturers' products will not be covered by SuperATV[®]. SuperATV[®] parts and products are not warranted if item was not installed properly, misused, or modified.

Installing, adding, modifying, or fabricating any factory or aftermarket product to your ATV/UTV may violate certain local, state, and federal laws. Be advised that laws vary depending on town, city, county, state, etc. Use of certain products on public streets, roads, or highways may be in violation law. The Buyer is solely and exclusively legally and personally responsible for any violation of the law by the installation or use of the product. You must abide by all local, state, and federal laws, including but not limited to vehicle safety, traffic laws, and ordinances. It is your responsibility to know the laws and how they apply to you.

The Buyer is responsible to fully understand the capability and limitations of his/her vehicle according to manufacturer specifications, warnings and instructions and agrees to hold SuperATV[®] harmless from any damage resulting from failure to adhere to such specifications, warnings and/ or instructions. The Buyer is also responsible to obey all applicable federal, state, and local laws and ordinances when operating his/her vehicle while using this product, and the Buyer agrees to hold SuperATV[®] harmless from any violation thereof.

Need help with your installation?

	sales@superatv.com		www.superatv.com
	1-855-743-3427		8:00am - 8:00pm EST M-Th 8:00am - 7:00pm EST Friday 9:00am - 2:00pm EST Saturday

Read instructions and view illustrations before beginning.

Thank You
For Choosing
SUPERATV.COM[®]

- Raise machine off ground and secure with jack stands; Wheels to be off ground.
- Engage Parking Brake, place machine in 4WD, and remove Wheels.
- Drain oil from Front Differential.
- Remove applicable components (front Axles, Springs, etc) and Front Differential from machine.

Remove Differential from Case.



**SPACERS MUST REINSTALL TO EXACT
REMOVAL LOCATIONS.
DO NOT SWAP LOCATIONS.**



Remove Bolts and Differential Case Half.

When reinstalling, torque Bolts to 74 ft/lbs.



Remove **all** stock components from Differential Case Half.



Apply a thin coating of grease to high lighted areas on Clutch Rings and Cams.

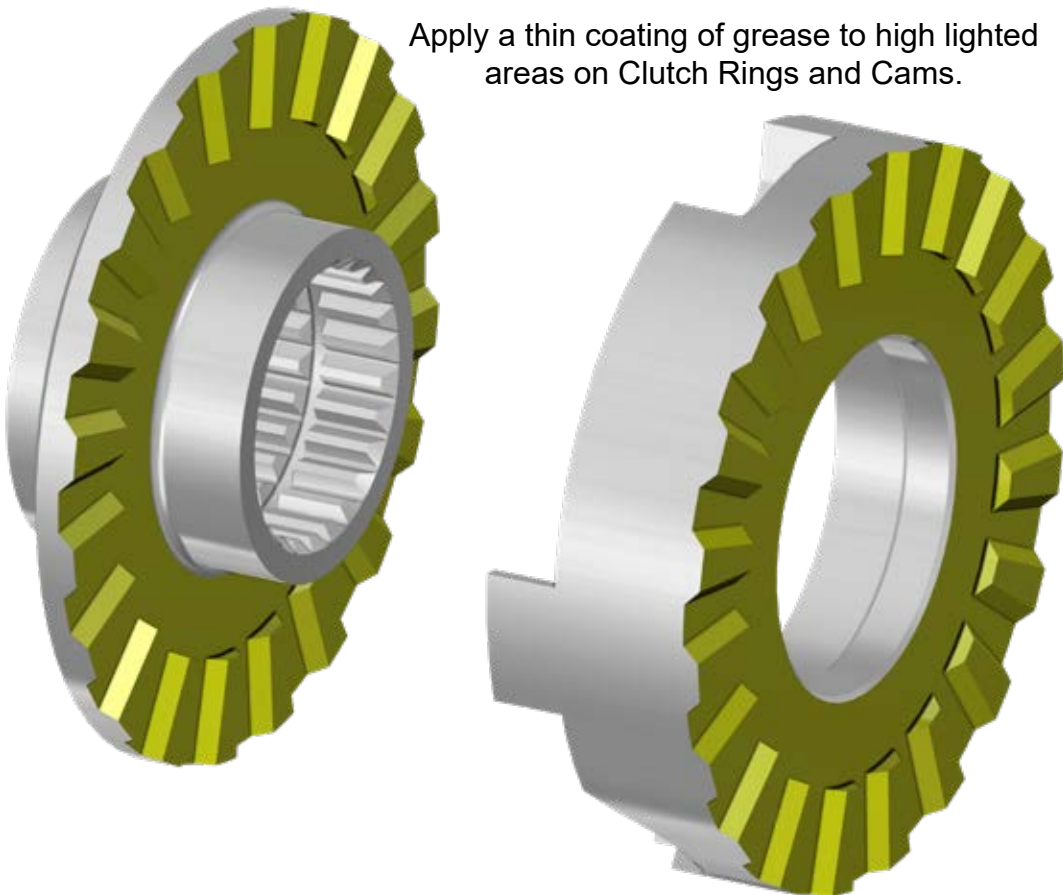

Install new components shown into Differential Case Half.

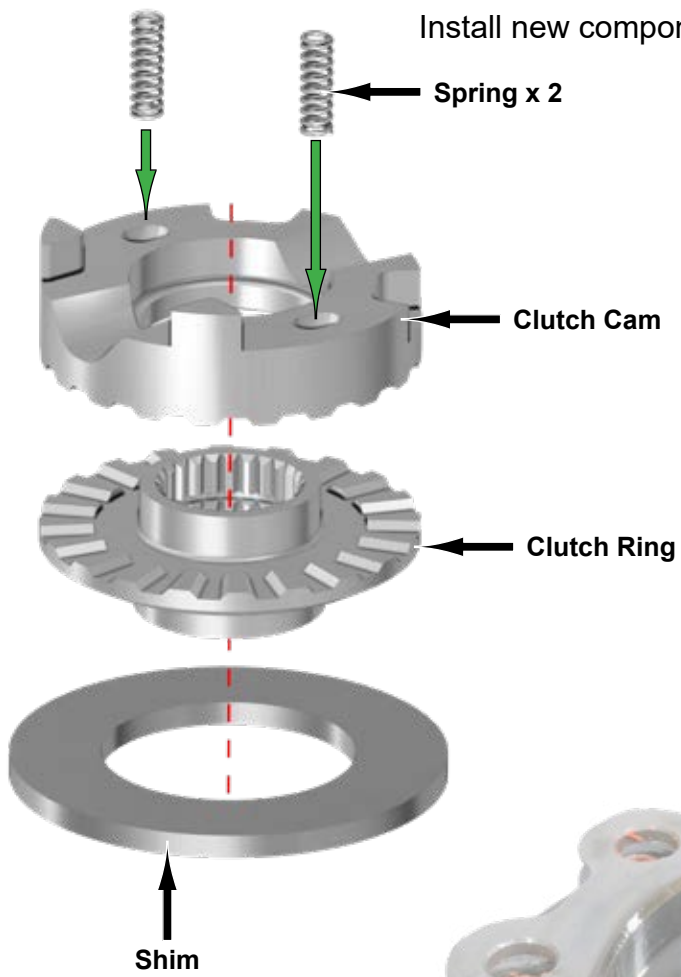

Install Cage onto previously installed Clutch Cam.

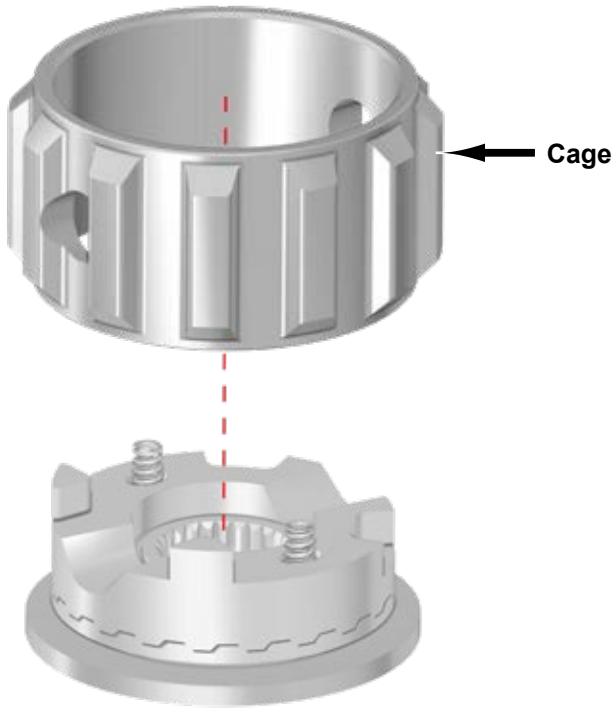

Insert Pin into Cage.

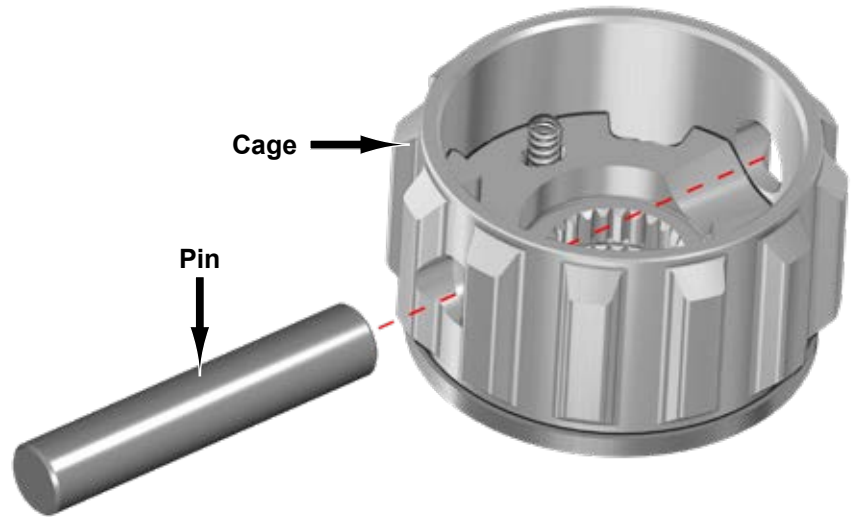

Install new components shown.

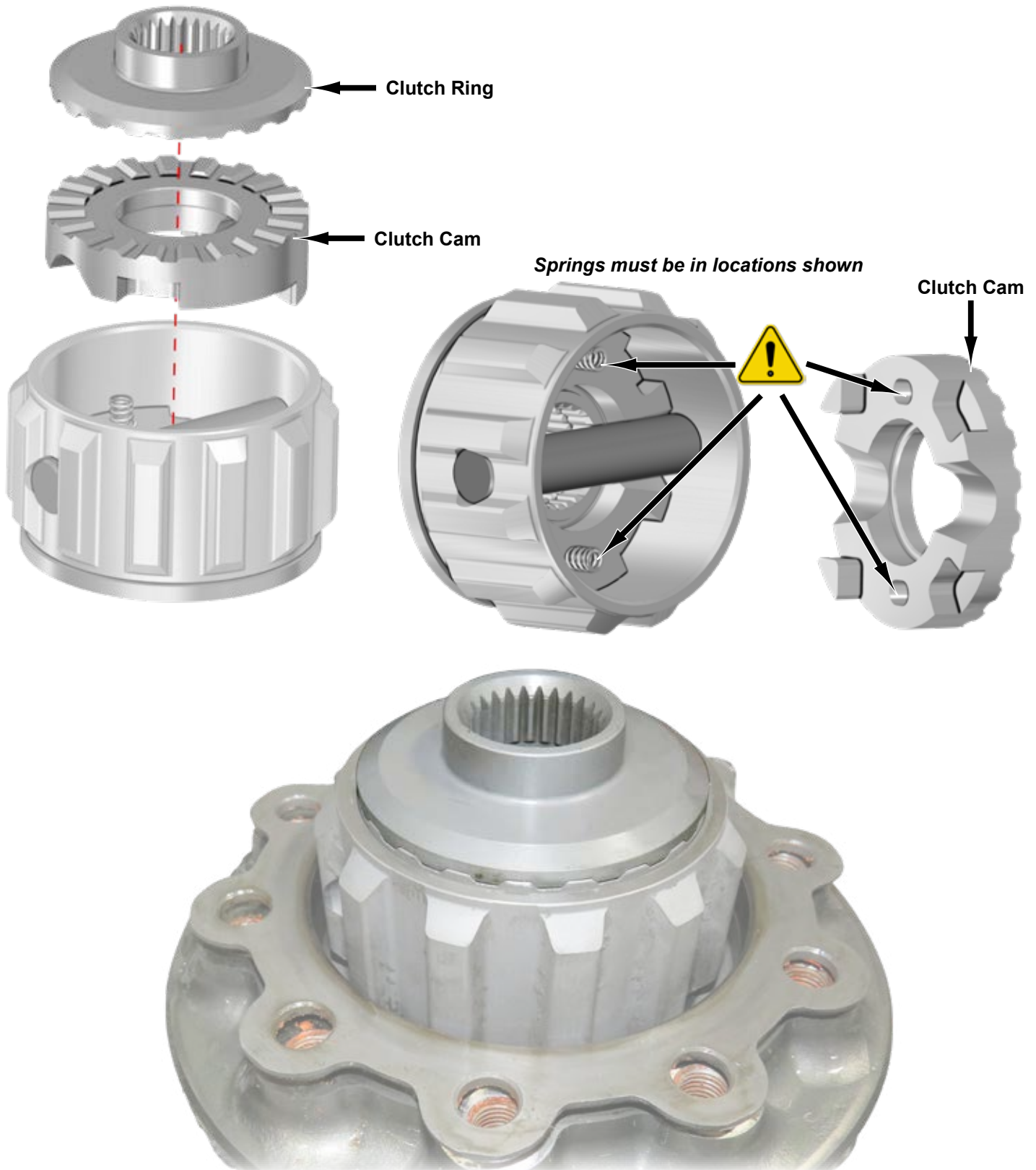

- Reinstall Bolts and secure Differential Case Halves. Use, not included, Loctite 242 Red Threadlocker.
- Fill Front Differential with manufacturers recommended Gear Oil.
- Reverse removal steps and reinstall applicable components to machine.
- Reinstall Wheels.

Case Halves torque settings: M8 Bolts to 18 ft/lbs and M10 Bolts to 35 ft/lbs.

SuperATV recommends two people for Wheel Spin testing.

Testing Steps:

- Ensure that key is “ON” and 4WD is engaged.
- Rotate Wheels forward until they stop against locked Drive Shaft. Apply pressure and hold Wheels in position.
- Have helper rotate passenger side Wheel backward. Wheel should ratchet smoothly, with Locking Differential clicking as Wheel rotates.
- Rotate driver side Wheel backward until it stops against locked Drive Shaft. Apply pressure and hold Wheel in position.
- Have helper rotate passenger side Wheel forward. Wheel should ratchet smoothly, with Locking Differential clicking as Wheel rotates.
- Repeat previous steps but start with passenger side Wheel.
- If Locking Differential ratchets smoothly, Wheel Spin testing is complete.
- Place machine back on ground.

Final Notes:

- When engaged in 4WD, machines equipped with a Locking Differential will handle different than a stock machine.
- Operator should familiarize themselves with new handling differences. SuperATV recommends testing in loose gravel; do not test on dry pavement.