

INSTALLATION INSTRUCTIONS
STC-CF-ZF950: Spare Tire Carrier

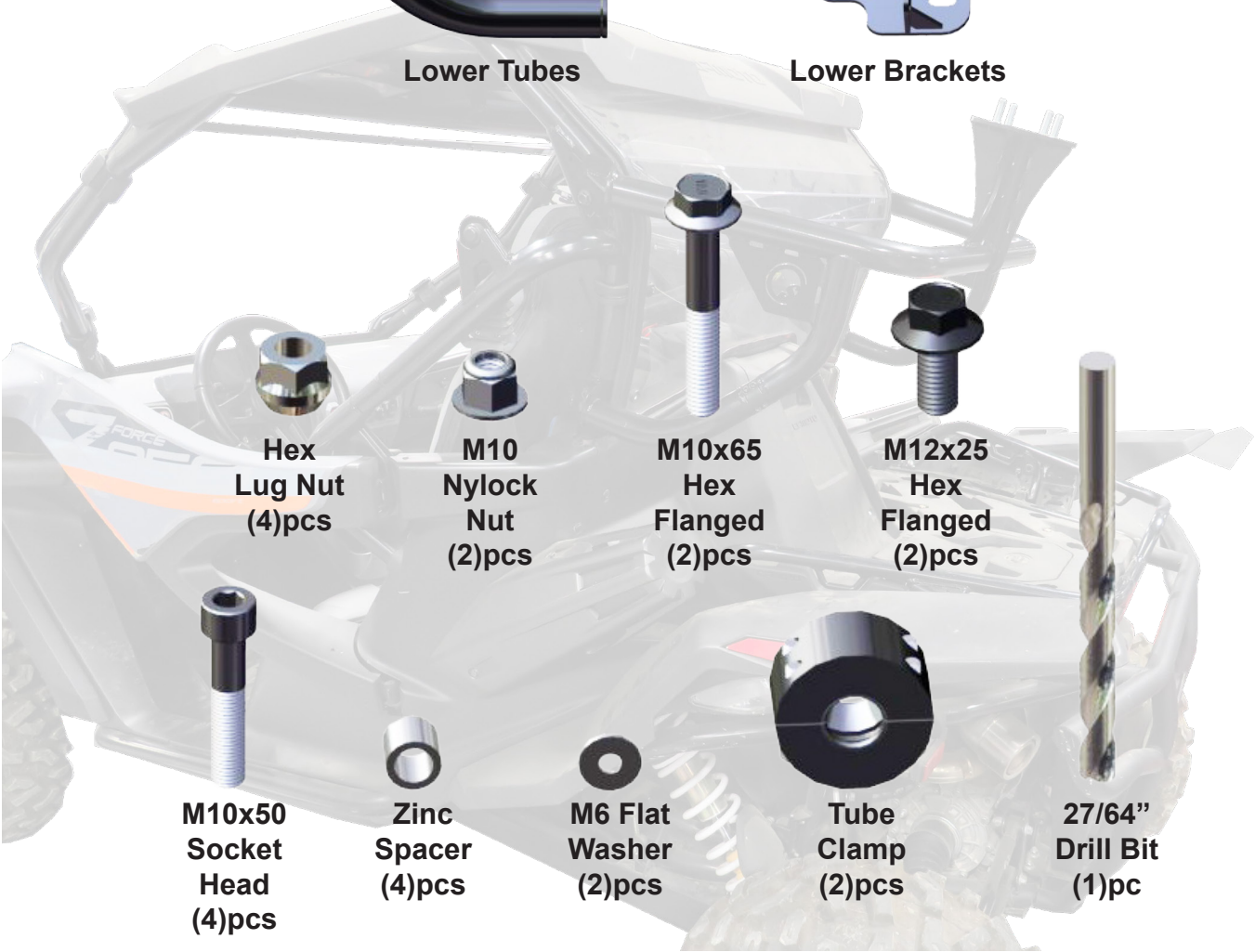

1. To start the installation, and if you have a rear Window already installed, you will need to remove the lower Tube Clamp from both Left & Right sides as it will be replaced with another type of clamp included in your kit. However, **DO KEEP** the hardware from the clamps you remove as you will be re-using it in the following steps to come. See **Fig.1**. Repeat for opposite side.

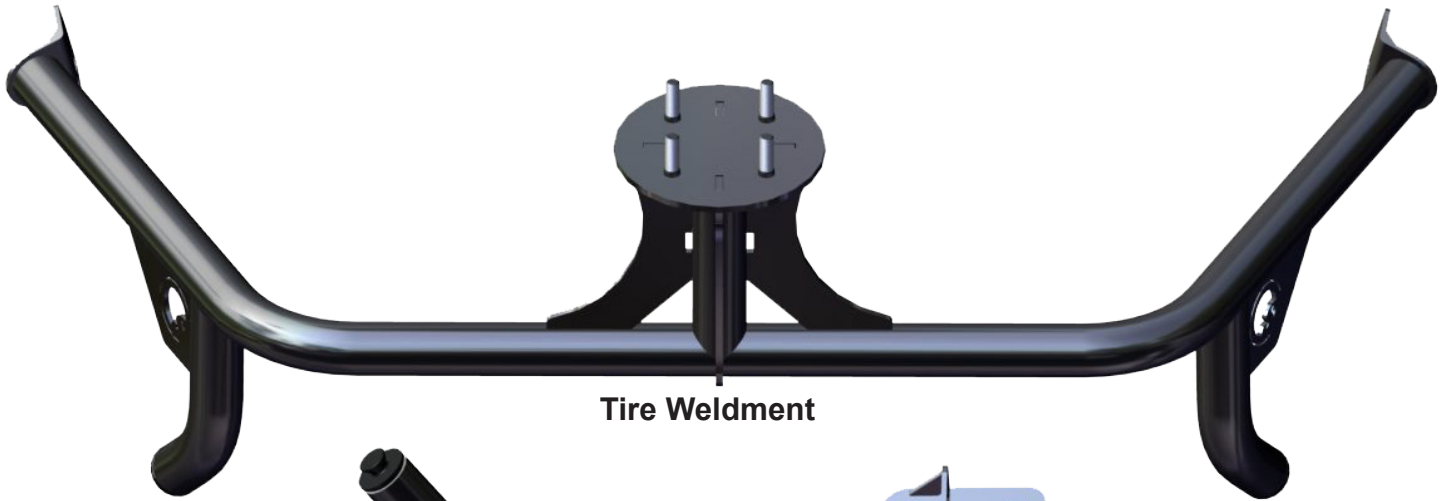
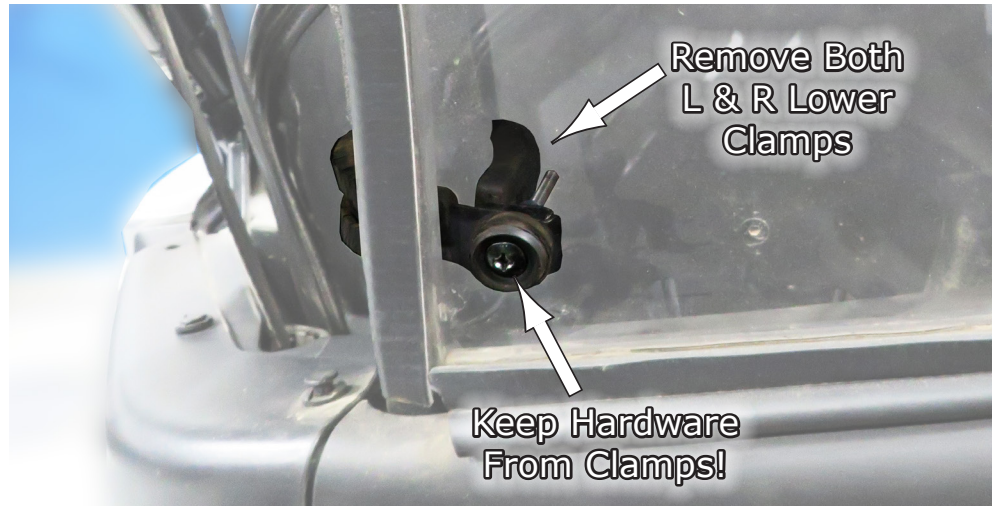

Fig.1

2. Next you need to remove the **Cage Bolts** to install the **Lower Brackets** as shown in **Fig.2a-b**. Then you install the **Lower Bracket** using the provided **Zinc Spacer** and the **M10x50 Socket Head** bolts provided in your kit. **Fig.2a-b** shows removing the cage bolts. **Fig.2c** shows the order of components going together, and **Fig.2d** shows them assembled. Repeat for the opposite side. **NOTE:** Leave Cage Bolts a little loose until all parts are assembled together, then tighten.



Fig.2a

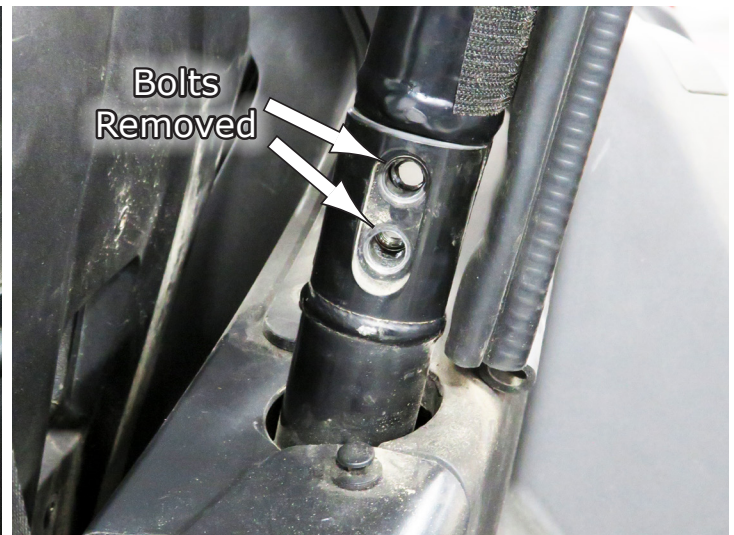

Fig.2b

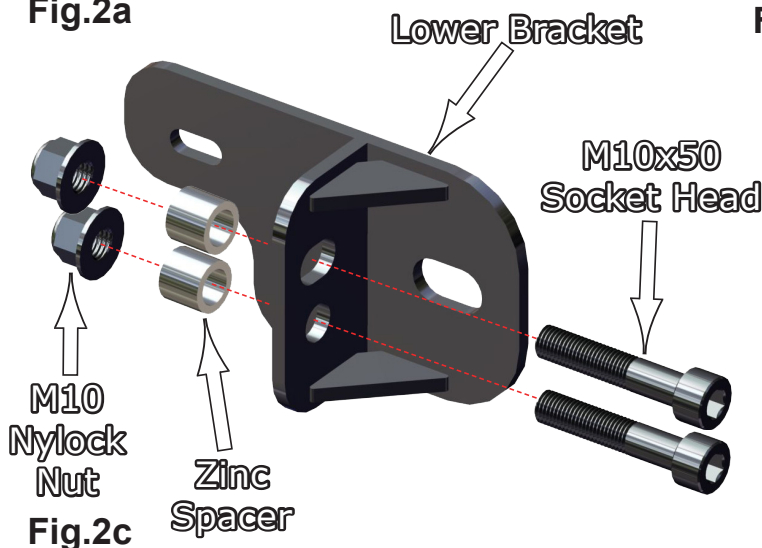

Fig.2c

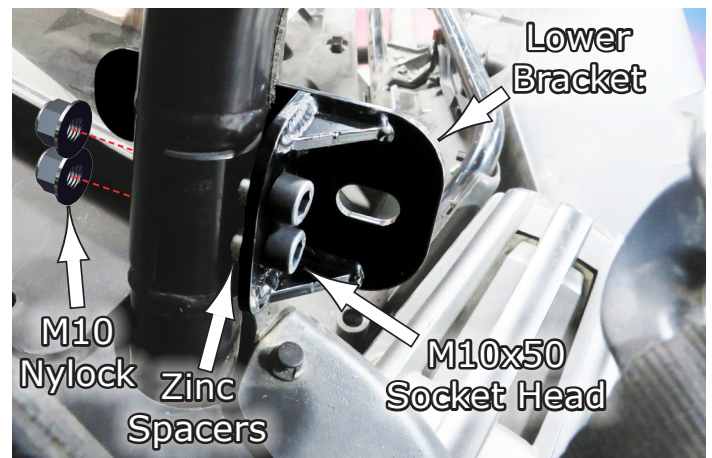

Fig.2d

3. Next, attach the **Lower Tube** section to the **Lower Bracket** using the **M12x25 Hex Flanged** as shown in **Fig.3a-b**. Repeat for the opposite side.



Fig.3a

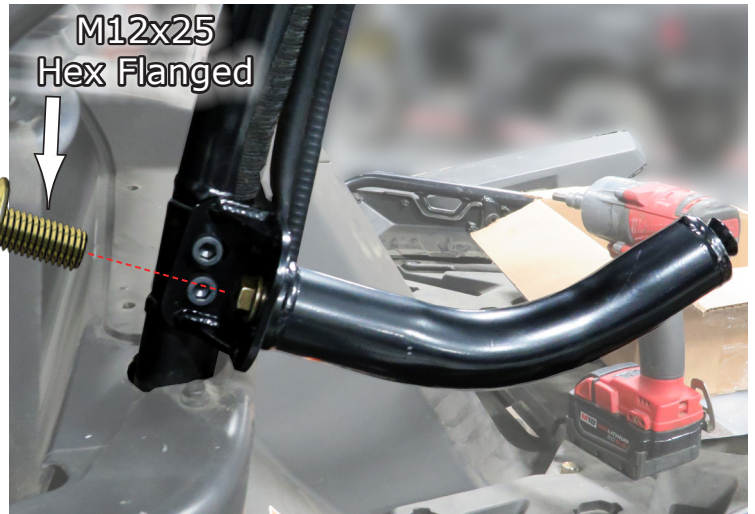

Fig.3b

4. After the Lower Tubes are in place, then you can install the main Tire Weldment.

NOTE: *You will probably need another person to help with this next step as it will need to be held in place while bolting it on.*

But first you will need to drill an existing hole in the frame to a larger diameter by using the **27/64" Drill Bit** provided in your kit. **Fig.4a-c** shows this location of the hole and drilling it out. Repeat for the opposite side.



Fig.4a



Fig.4b



Fig.3c

5. Now you can install the main **Tire Weldment**. You will probably need another person to help when mounting the rack as it's pretty cumbersome. But to do that, it simply bolts onto the frame where you just drilled the hole larger at using the **M10x65 Hex Flanged bolts** and **M10 Nylock Nuts** provided in your kit. Keep them loose for now until all of the rack assembly is assembled together. See **Fig.5a-c**. Repeat for the opposite side.

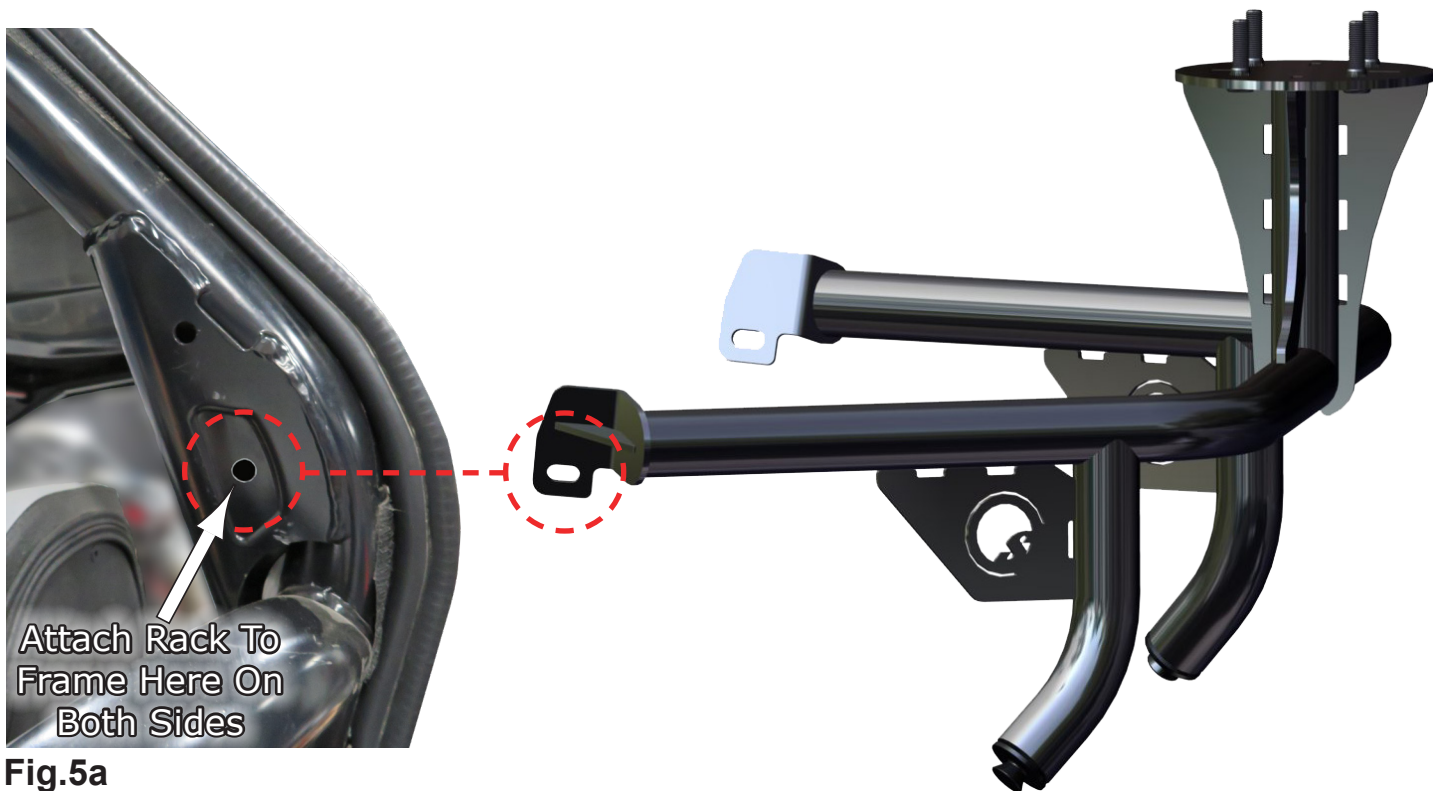

Fig.5b

Fig.5c

6. Next is to join the **Tire Weldment** to the **Lower Tubes** you mounted previously. To do this, place the **Tube Link Ends** from the **Tire Weldment** together face to face with the one on the **Lower Tubes** you previously installed, and secure them together using the **Tube Clamps** also provided in your kit, and tighten securely. See **Fig.6a-b**. Repeat for the opposite side.



Fig.6a



Fig.6b

7. After both sides have been installed, then go back and tighten up all bolts and nuts securely.

Then the last thing is to re-install the corner bolts on the back windshield (that you first removed) with the supplied **M6 Flat Washers** supplied in your kits. Repeat for opposite side. See **Fig.7**.



Fig.7

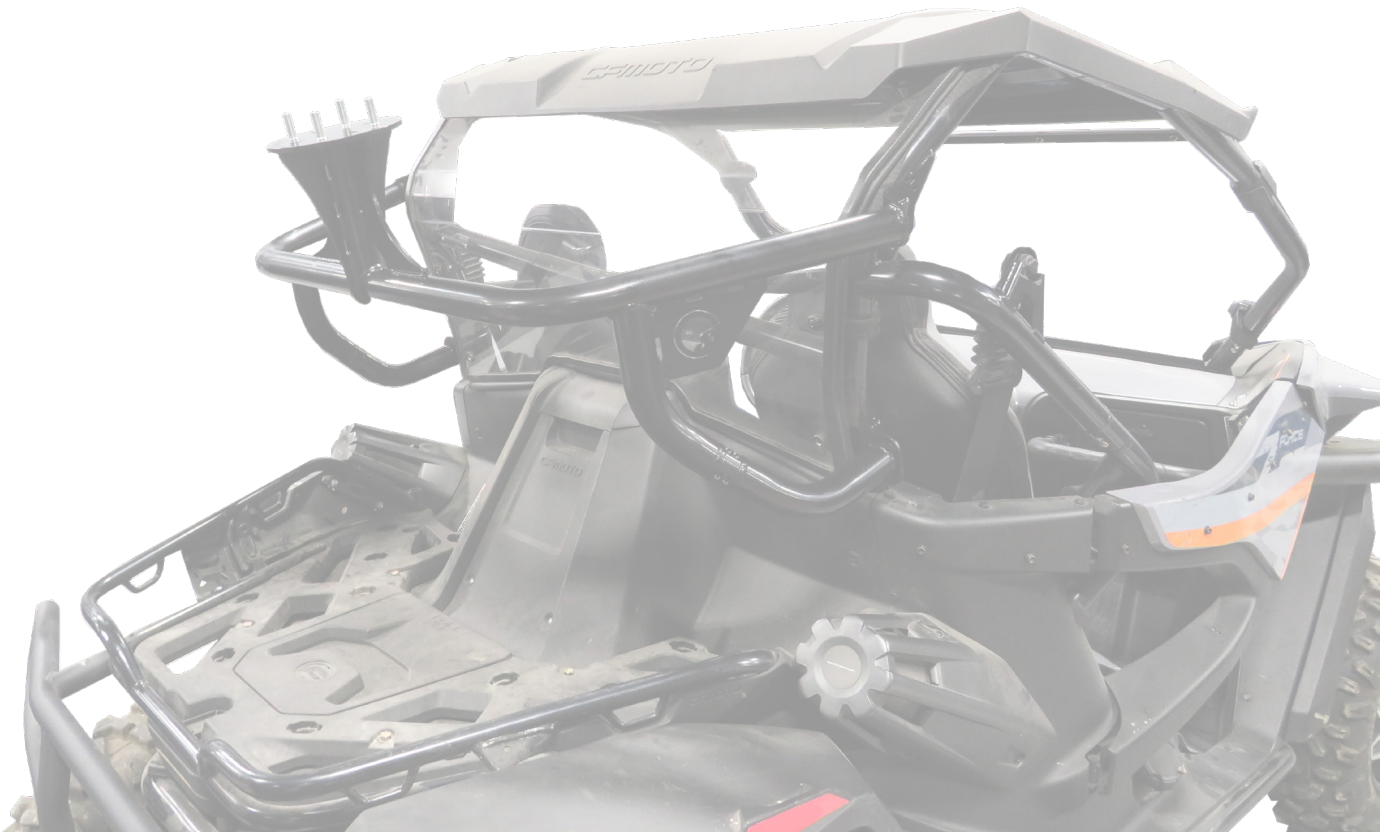

Liability Statement

SuperATV's® products are designed to best fit user's ATV/UTV under stock conditions. Adding, modifying, or fabricating any factory or aftermarket parts will void any warranty provided by SuperATV® and is not recommended. SuperATV's® products could interfere with other aftermarket accessories. If user has aftermarket products on machine, contact SuperATV® to verify that they will work together.

Although SuperATV® has thousands of satisfied customers, user should be aware that installing lift kits, long travel, or suspension kits, tires, etc. will change the ride of machine and may increase maintenance and part wear. Operating any off-road machine while, or after, consuming alcohol and/or drugs increases risk of bodily harm or death. No warranty or representation is made as to this product's ability to protect user from severe injury or death. SuperATV® urges operators and occupants to wear a helmet and appropriate riding gear at all times.

By purchasing and installing SuperATV® products, user agrees that should damages occur, SuperATV® will not be held responsible for loss of time, use, labor fees, replacement parts, or freight charges. SuperATV®, nor any 3rd party, will not be held responsible for any direct, indirect, incidental, special, or consequential damages that result from any product purchased from SuperATV®. The total liability of seller to user for all damages, losses, and causes of action, if any, shall not exceed the total purchase price paid for the product that gave rise to the claim.

SuperATV® will warranty only parts provided by SuperATV®. Any damage or problems with OEM housings, bearings, seals, or other manufacturers' products will not be covered by SuperATV®. SuperATV® parts and products are not warranted if item was not installed properly, misused, or modified.

Installing, adding, modifying, or fabricating any factory or aftermarket product to your ATV/UTV may violate certain local, state, and federal laws. Be advised that laws vary depending on town, city, county, state, etc. Use of certain products on public streets, roads, or highways may be in violation law. The Buyer is solely and exclusively legally and personally responsible for any violation of the law by the installation or use of the product. You must abide by all local, state, and federal laws, including but not limited to vehicle safety, traffic laws, and ordinances. It is your responsibility to know the laws and how they apply to you.

The Buyer is responsible to fully understand the capability and limitations of his/her vehicle according to manufacturer specifications, warnings and instructions and agrees to hold SuperATV® harmless from any damage resulting from failure to adhere to such specifications, warnings and/ or instructions. The Buyer is also responsible to obey all applicable federal, state, and local laws and ordinances when operating his/her vehicle while using this product, and the Buyer agrees to hold SuperATV® harmless from any violation thereof.

If you have any problems/questions on this kit, contact us by email at [Superatv.com](mailto:sales@superatv.com).

Need help with your installation?



sales@superatv.com



www.superatv.com



1-855-743-3427



8:00am - 9:00pm EST M-Th
8:00am - 7:00pm EST Friday
9:00am - 2:00pm EST Saturday

*Thank You
For Choosing*



Like SuperATV on Facebook to keep up to date on new products!