

INSTALLATION INSTRUCTIONS

Power Front Windshield: IN-PFWS-P-RZRXP

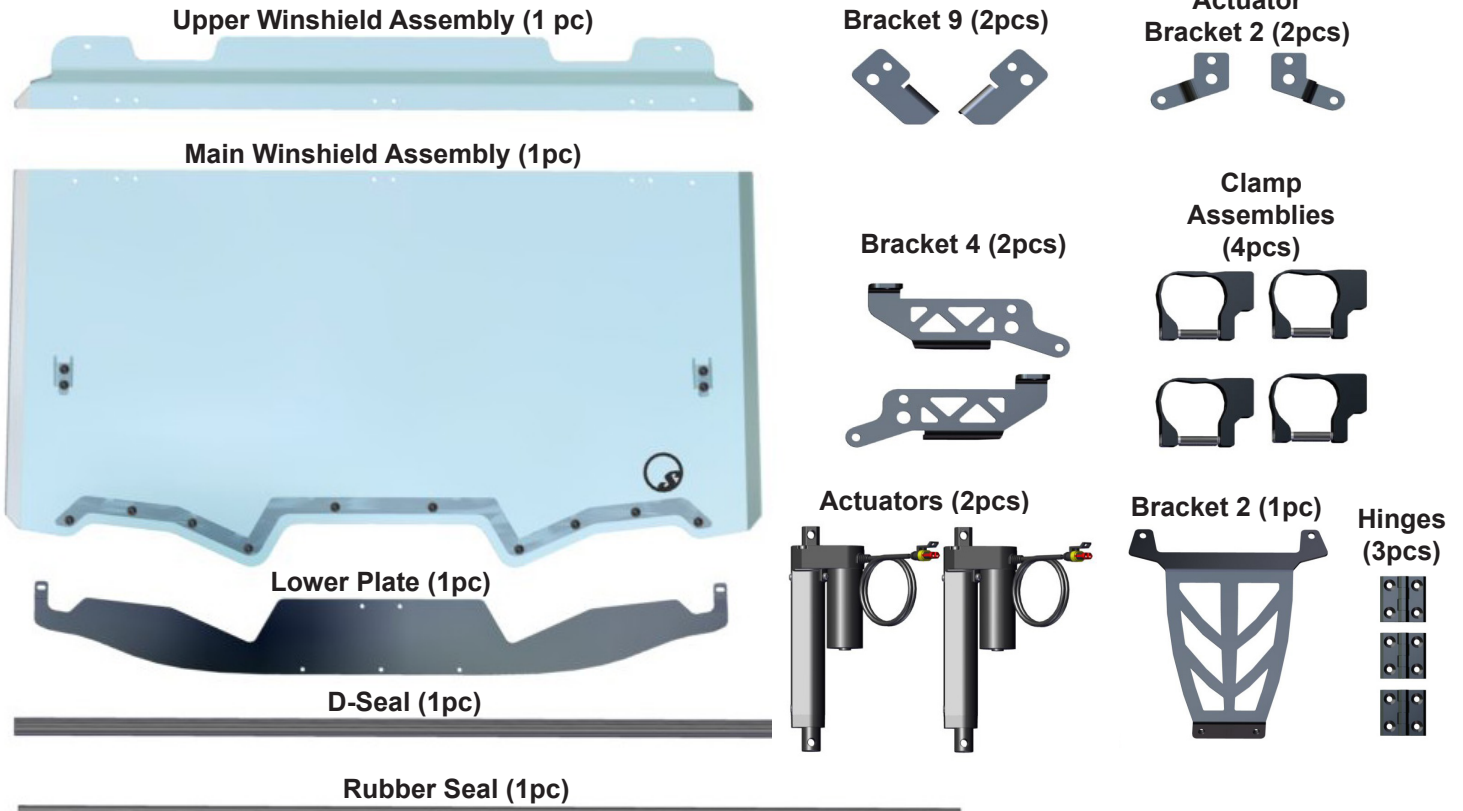

Edge Trim (1pc)

Bracket 8 (2pcs)



Item	Description	Qty
A	M8x14 Button FT	6
B	M6x12 Button FT	8
C	M6x12 Flanged Button FT	2
D	M6x20 Button FT	4
E	M6 Nylock Hex Flanged Nut	7
F	M6x25 Button FT	2
G	Flanged Sleeve Bearing	8

Item	Description	Qty
H	M6 Nylock Hex Nut	14
J	M6x25 Flat FT	12
K	M8 Nylock Hex Nut	2
L	M5 Nylock Hex Nut	4
M	M6x16 Button FT	3
N	M6x30 Socket Shoulder Bolt	4

What You'll Be Doing

- 1 First you'll remove hood panels
- 2 Assemble Actuator Brackets
- 3 Install Windshield clamps
- 4 Edge Trim To Lower Bracket/Install
- 5 Assemble Upper Windshield Panel
- 6 Install Brackets-Seal-Hinges-Seal To Main Windshield
- 7 Mount Main Windshield
- 8 Install Actuators-Run Cables
- 9 Run Switch Harness to Actuators-Connect
- 10 Replace Hood Panels-Install Bracket 2
- 11 Zip-Tie Cables Securely

NOTE: THESE INSTRUCTIONS WILL MOSTLY BE SHOWING INSTALLATION FOR ONE SIDE (DRIVER'S OR PASSENGER'S), SO REPEAT THE SAME PROCEDURES FOR THE OPPOSITE SIDE.

Before starting the installation, you will need to remove the two front hood panels to give you access to all you will be working with. Remove all screws and remove panels. See Below.



1. First, you need to assemble a couple front mounting brackets. we will do the upper brackets first. For these you will use one of the **Clamp Assemblies**, (1) **Bracket 4** and (1) **Bracket 2**. Then assemble them using (1) M5x12, **Item "B"** and (1) M8x14 **Item "A"** as shown in **Fig.1**.

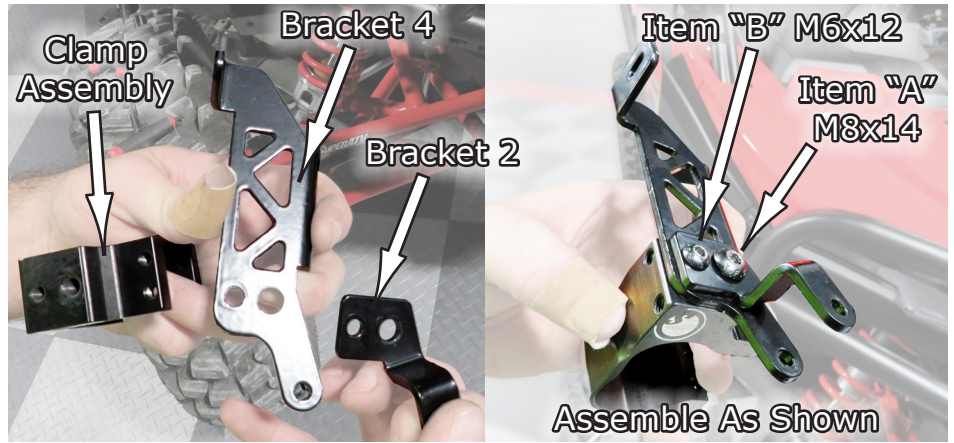

Fig.1

2. Once the bracket assembly is together, now you can mount it. To give a good starting point for placement of the clamp, measure with a tape starting from the top edge of the hood in front of the frame bar, and measure up approx 20 11/16". This is where you will place the bottom edge of the clamp on the bar as shown in **Fig.2**.



Fig.2

2

When bolting the clamp to the bar, lightly snug it to hold in place, but do not tighten down yet to allow for final adjustment once the windshield is also in place.

3. Be sure to cut out and clear any Hook & Loop or other seals where the clamp will be (if any) on the bar so that it can grip the bar itself with nothing between the clamp and the bar. Then using the screws in the clamp, attach the clamp to that location and lightly snug. See **Fig.3**.



Fig.3

3

4. Now you need to assemble the lower bracket. For this one you'll use (1) **Clamp** and (1) **Bracket 9** and will assemble them together using the same (1) M5x12, **Item "B"** and (1) M8x14 **Item "A"** as you used on the upper bracket previously. See **Fig.4**.



Fig.4

5. For the lower bracket, you measure from the same starting point and measure up approx 3-7/8". This is where the bottom edge of the lower bracket should be placed as shown in **Fig.5**. Install clamp the same way and also leave a little loose for adjustment as you did on the upper bracket.



Fig.5



6. After both upper and lower brackets are on, now find the Lower Plate shown on the cover of these instructions. Now find the Edge Trim piece and cut to length two pieces to fit on the corner areas of the plate as shown in **Fig.6**.



Fig.6

7. To get the approx length to cut, lay the plate in the position on the vehicle where it will go and mark where to cut from there. The inner edge of the trim should just meet the edge of the hood as shown in Fig.7.

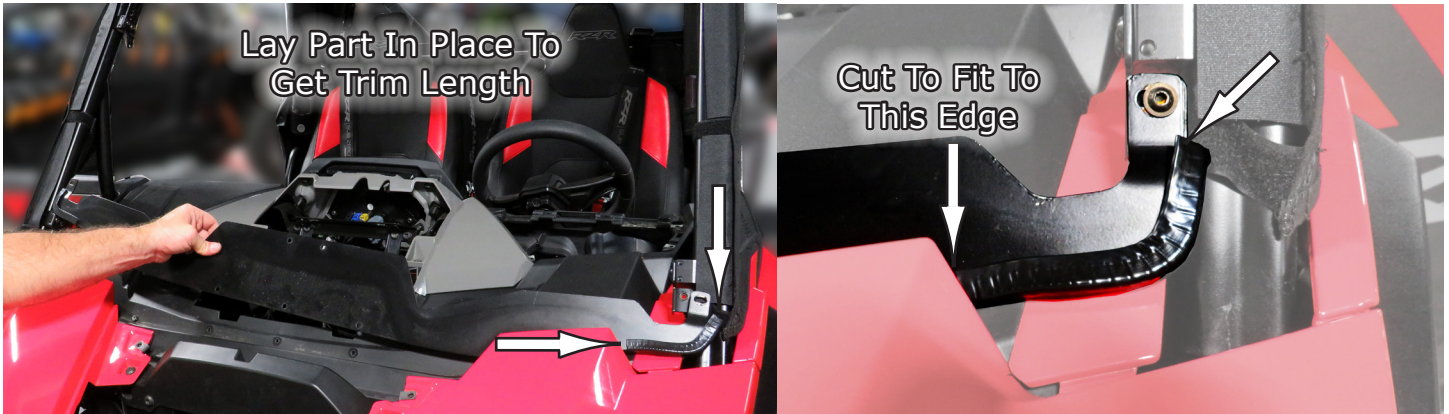

Fig.7

8. After you get the corner trim put on, then lay it in place. You will then mount the plate using the M6x16 Button Ft bolts **Item "M"** and M6 Nylock Nuts **Item "H"** provided in your kit.

You will notice the you can only install the two bolts in the lower center of the panel as there is no thru hole for the center panel hole. This you will need to drill thru using a **6mm bit**. After drilling, then install the remaining bolt and Nylock nut, **items "M" & "H"**. See Fig.8.

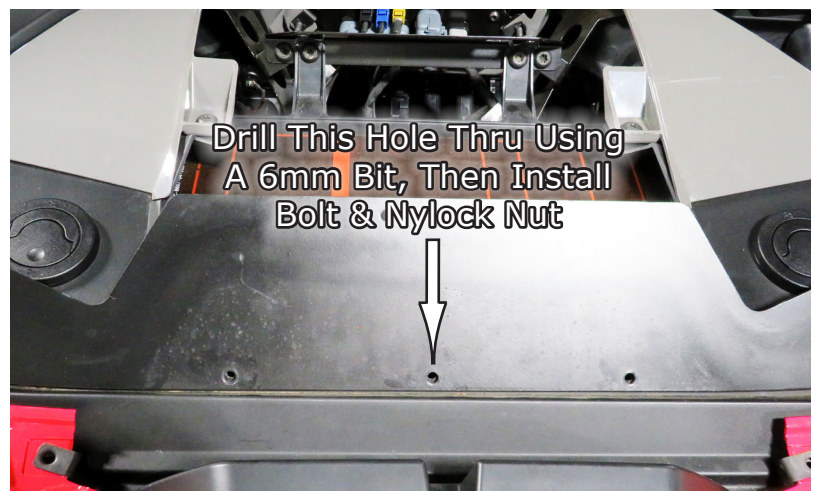

Fig.8

9. Now that the Lower Plate is installed, we can now install the **Upper Windshield Assembly**. You will do this by first installing it to the corner frame brackets using the M6x20 Button FT **Item "D"** and M6 Nylock Nut **Item "E"**. Then install it to the Actuator Brackets with "**Bracket 8**" using the M6x25 Button FT **Item "F"** and M6 Nylock Nut **Item "E"** shown in Fig.9. Fig.9 also shows the correct placement of the parts for correct installation.



Fig.9

10. After the Upper Windshield Assembly is installed, now you can prep the Main Windshield Assembly. To do this, first find the other **Bracket-8**, and apply the **Adhesive D-Seal** onto the flat surface with no holes that will be sealing between the Upper and Lower Windshield sections. **Fig.10** shows where you apply the **D-Seal** and where **Bracket-8** will be installing on the Main Windshield.

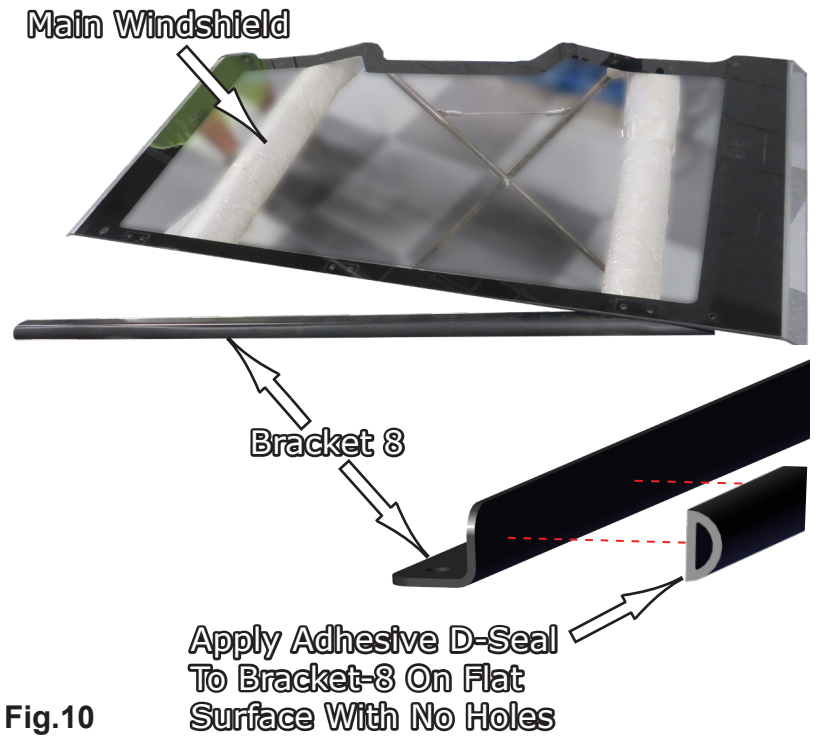

Fig.10

11. Now install the Bracket and Seal to the Main Windshield along with the Hinges. It is easier to install the Bracket-8 with the two outer corner bolts first, and then mount the Hinges. Snug all bolts, but do not tighten until all bolts have been threaded into place. Then adjust and tighten. You will install the corner locations using the M6x20 Seal Washer Bolt, **Item "D"** and M6 Nylock Nut, **Item "H"** from your kit. Then install the 3 Hinges to the Windshield using the M6x25 Flat Top Bolts, **Item "J"** and M6 Nylock Nuts, **Item "H"** also in your kit. **See Fig.11.**

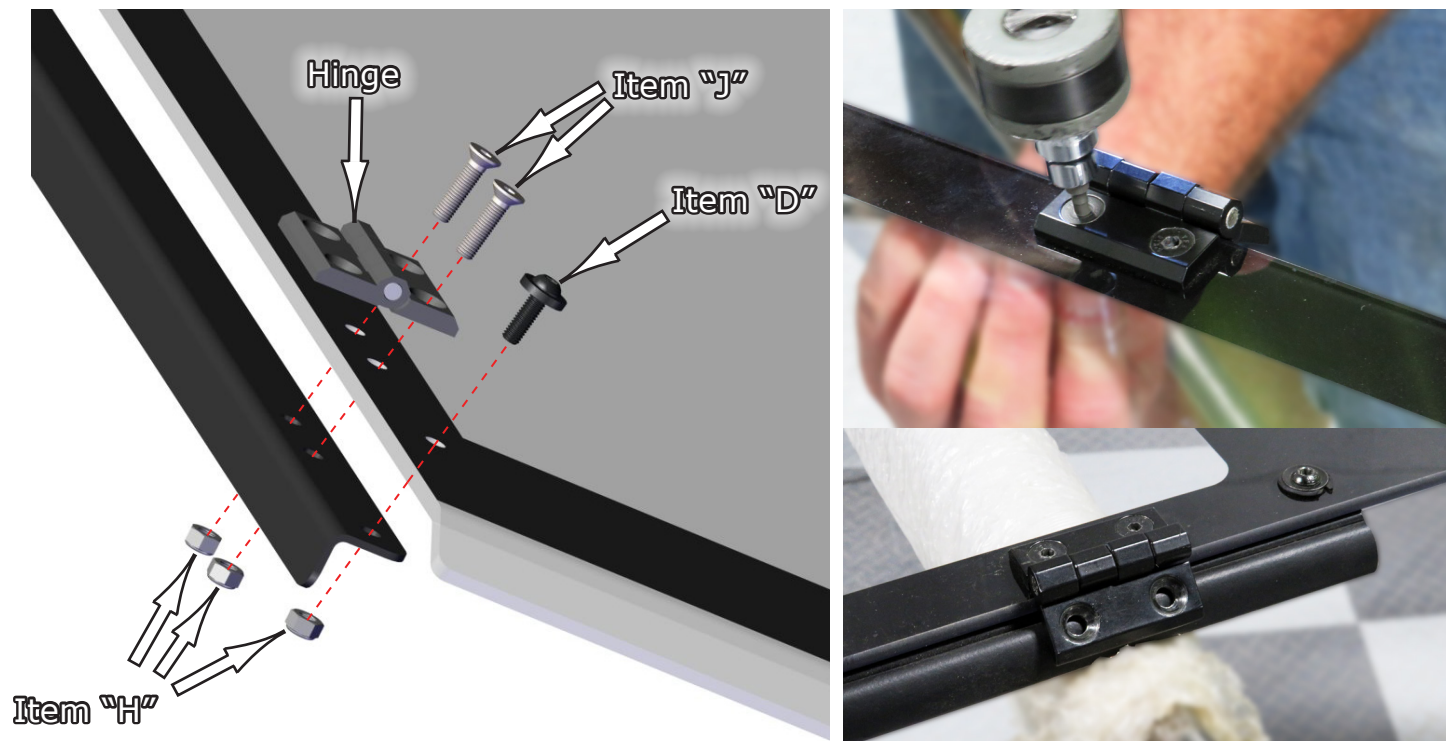

Fig.11

12. Next you will install the Lower Actuator Mounting Brackets to the Windshield. You will install these to the inside surface of the windshield using the M6x20 Sealing Washer Bolts, **Item "D"**, and M6 Nylock Nuts, **Item "H"** and tighten. See **Fig.12**.

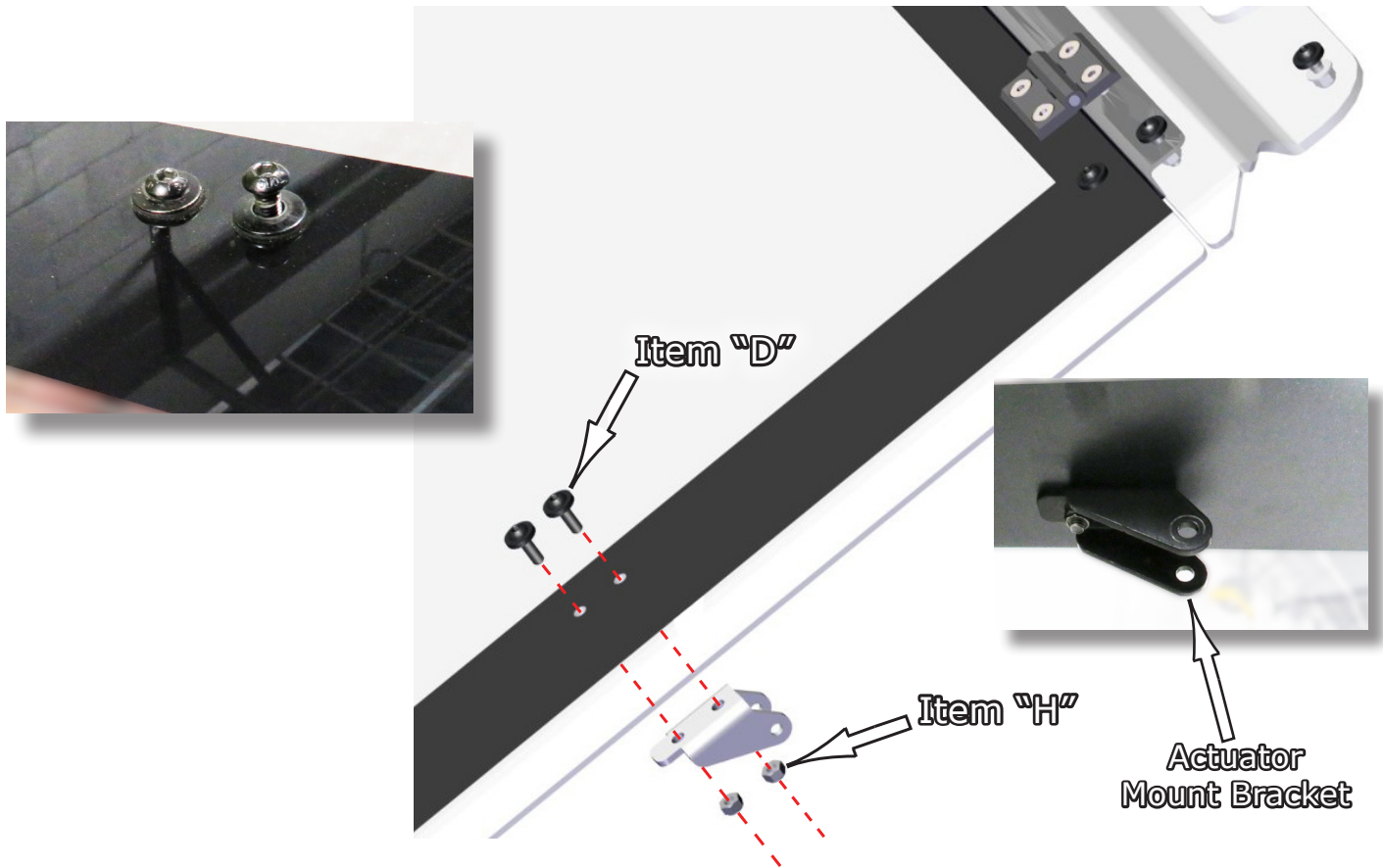

Fig.12



13. Now add the seal strip to the lower edge of the windshield frame as shown in **Fig.13**. This will just slip onto the frame. No adhesive is needed.

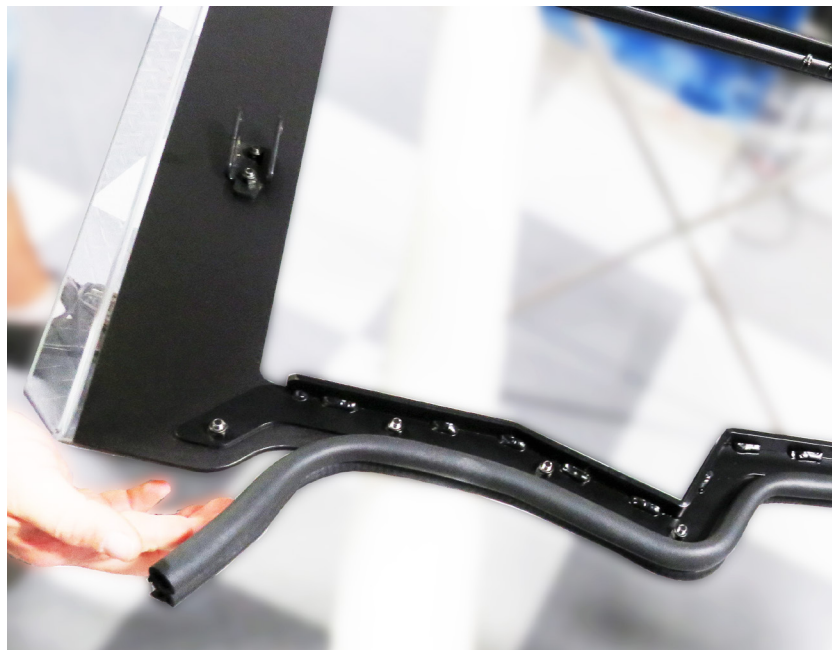

Fig.13

14. After the previous has been installed on the windshield, you can now set the Windshield in place and align the holes of the 3 hinges to the holes in the **Upper Windshield** section. You will use the M6x25 FT Bolts, **Item "J"** and Nylock Nuts, **Item "H"** and secure. **Fig.14** shows these actions and how these all go together.

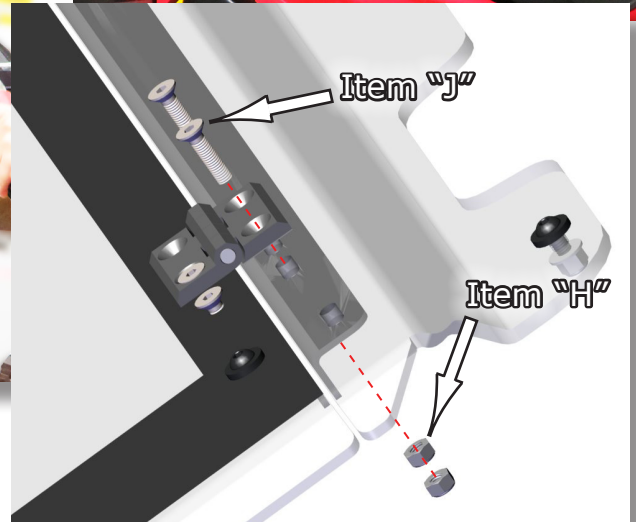

Fig.14



15. Once the Windshield is mounted on the Hinges, You can now install the Actuators to the Windshield and frame brackets as shown in **Fig.15**.

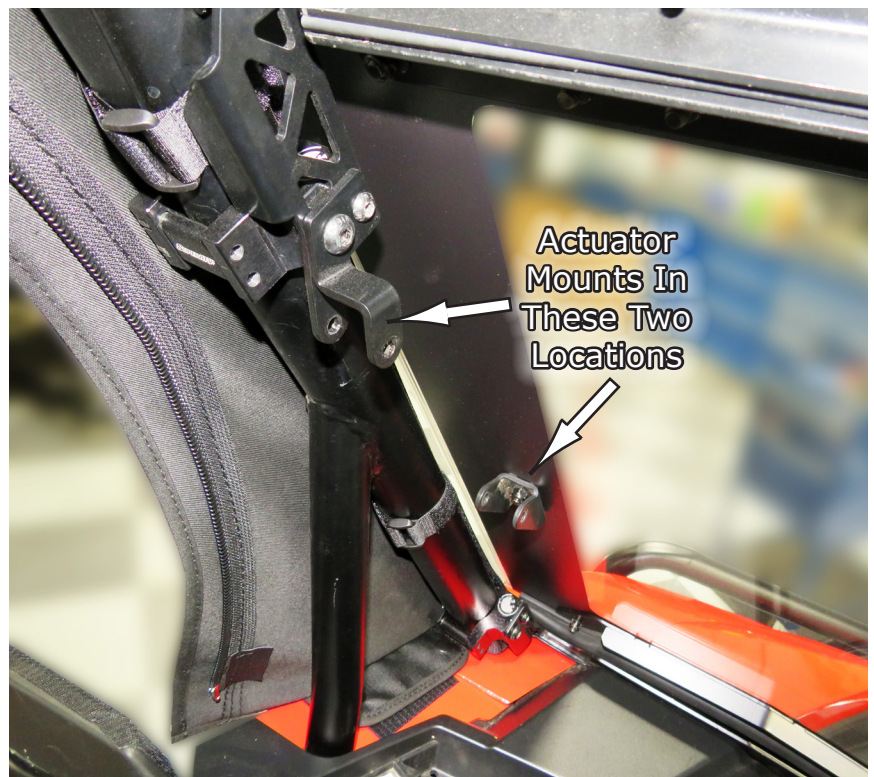

Fig.15

16 .To install the Actuator, first insert the Flanged Sleeve Bearings, **Item "G"**, into the mounting clevis's of the Actuator. Two in the Upper Location, and two in the lower location.

17. Then insert the Actuator into the mounting brackets and secure by using the M6x30 Shoulder Bolts, **Item "N"** and the M6 Flanged Nylock Nuts, **Item "E"** and secure. See **Fig.16-17**.

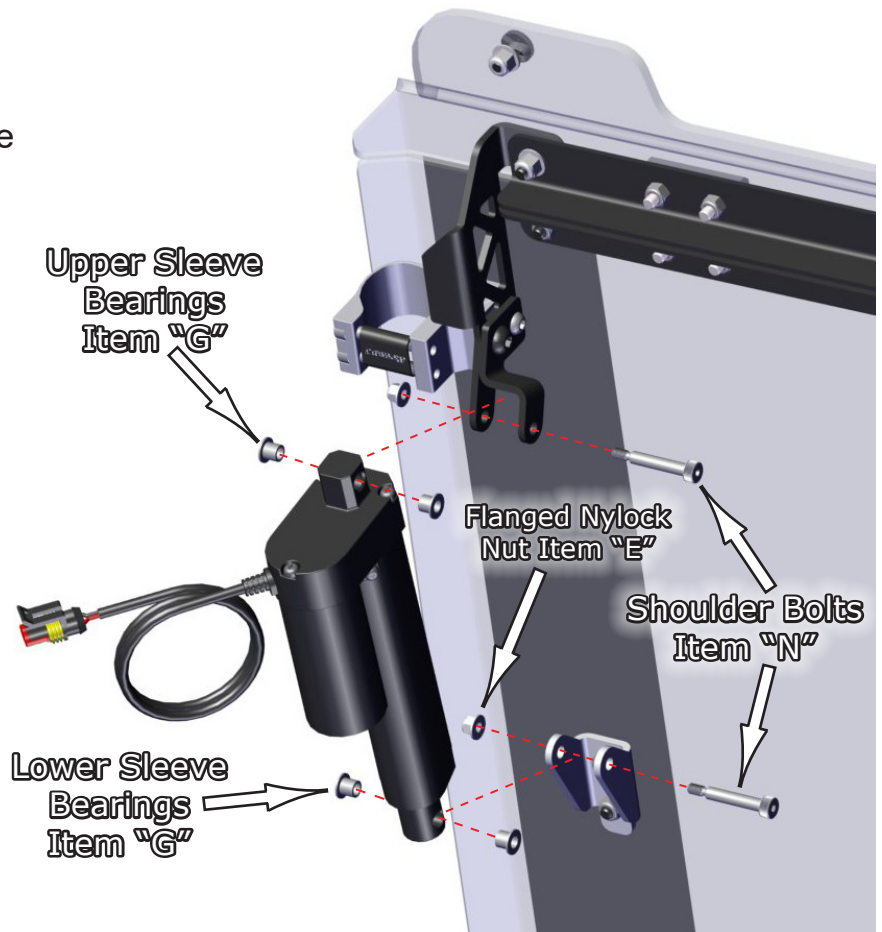

Fig.16

NOTE: After the Main Windshield is installed and the actuators are installed, go back and adjust position of the windshield or other if needed, and tighten all screws and bolts down securely. You will want to make sure of this before trying out the system to see that it functions correctly!



Fig.17

18. Make sure at this point that you have removed the dash panels in front of the steering wheel and the passenger areas shown in **Fig.18**. You will need this access to route the Actuator cables to the Switch Harness to power them in the steps ahead.



Fig.18

19. Now route the Actuator cable down thru the outside of the dash area as shown in **Fig.19**, for both sides, and feed it back thru to the open dash areas where you removed the panels from. This is where the Switch Harness will meet the Actuator cables to connect, in the following steps.

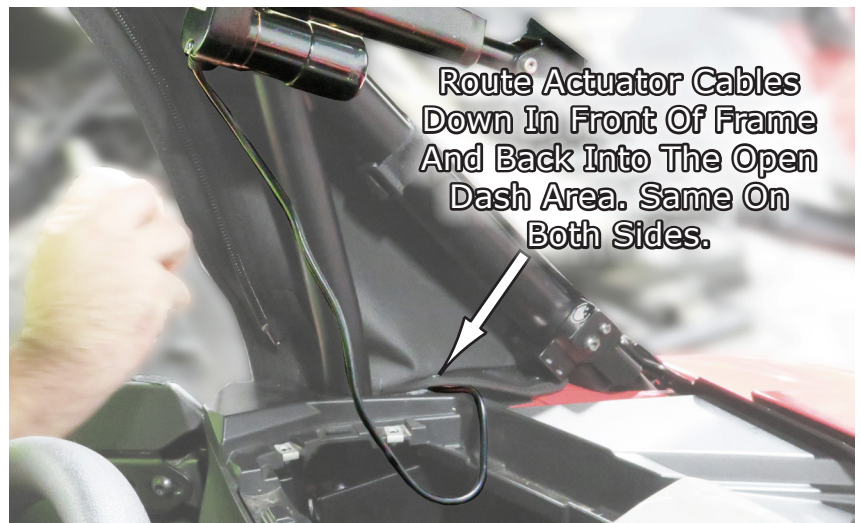

Fig.19

20. Once you have the Actuator cables routes down and back up thru the open dash areas, now select your switch location and clear the space for the switch to be inserted. Then run the Switch Harness thru the switch opening to inside the dash to hook up the power and actuators, but do not snap the switch into the opening until after you try out the system making sure everything is working first. See **Fig.20**.



Fig.20

There are three cables coming from the switch, one for each actuator, and one for the main power connection.

21. Once the harness is inside the dash area, find the Power Cable, Red and Brown, and route it to the junction box attached to the compartment wall, and plug it into the open connector slot, the last on the Right, next to the big Red plug, as shown in **Fig.21**. This is your main power for the actuators.



Fig.21

22. Now route the other two harness cables, one to the Driver's side and one to the Passenger's side, and connect each of those cables to the Actuator cables on each side.

At this point, the system is ready to be checked. Try out the switch to see that the actuators are lifting the windshield up and back down as intended. Once that is confirmed, then snap the switch into the slot and you're good to go. See **Fig.22**.

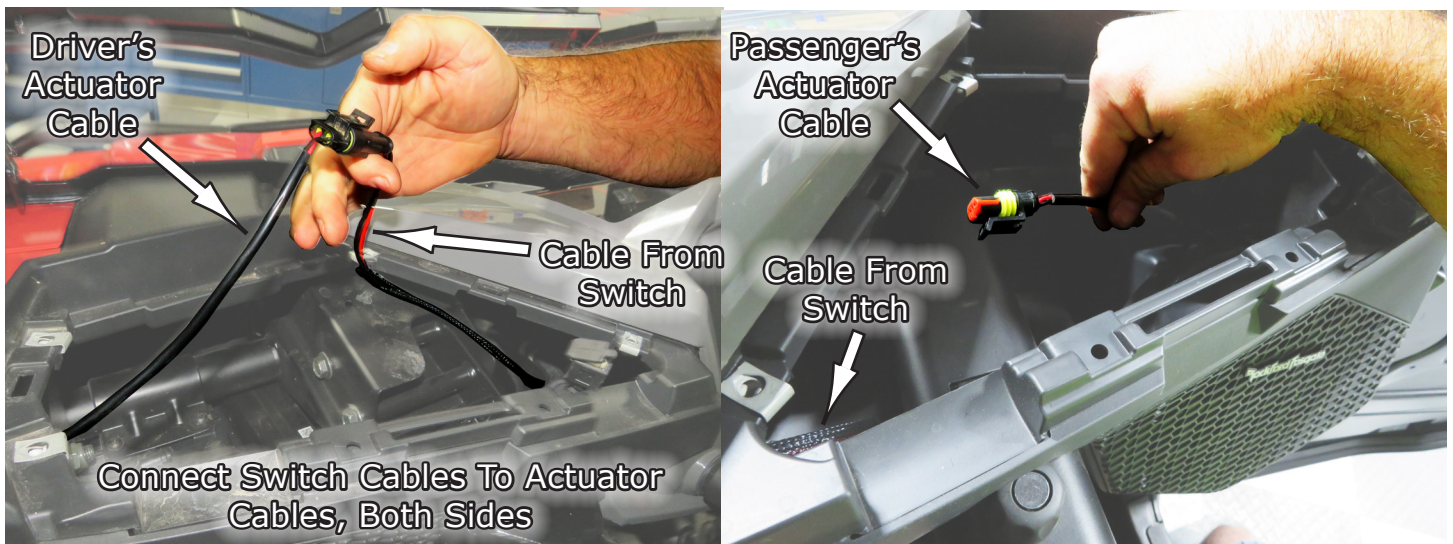

Fig.22

23. After you verify that the system is working properly, replace all hood and dash panels you removed previously, and secure. See Fig.23.



Fig.23

24. Next, you can install the **Bracket-2**. This is mounted using the M6x12 Button Bolt **Item "B"** which threads into the bracket itself on the smaller end of the bracket, which also attaches to the bottom windshield frame. See Fig.24.

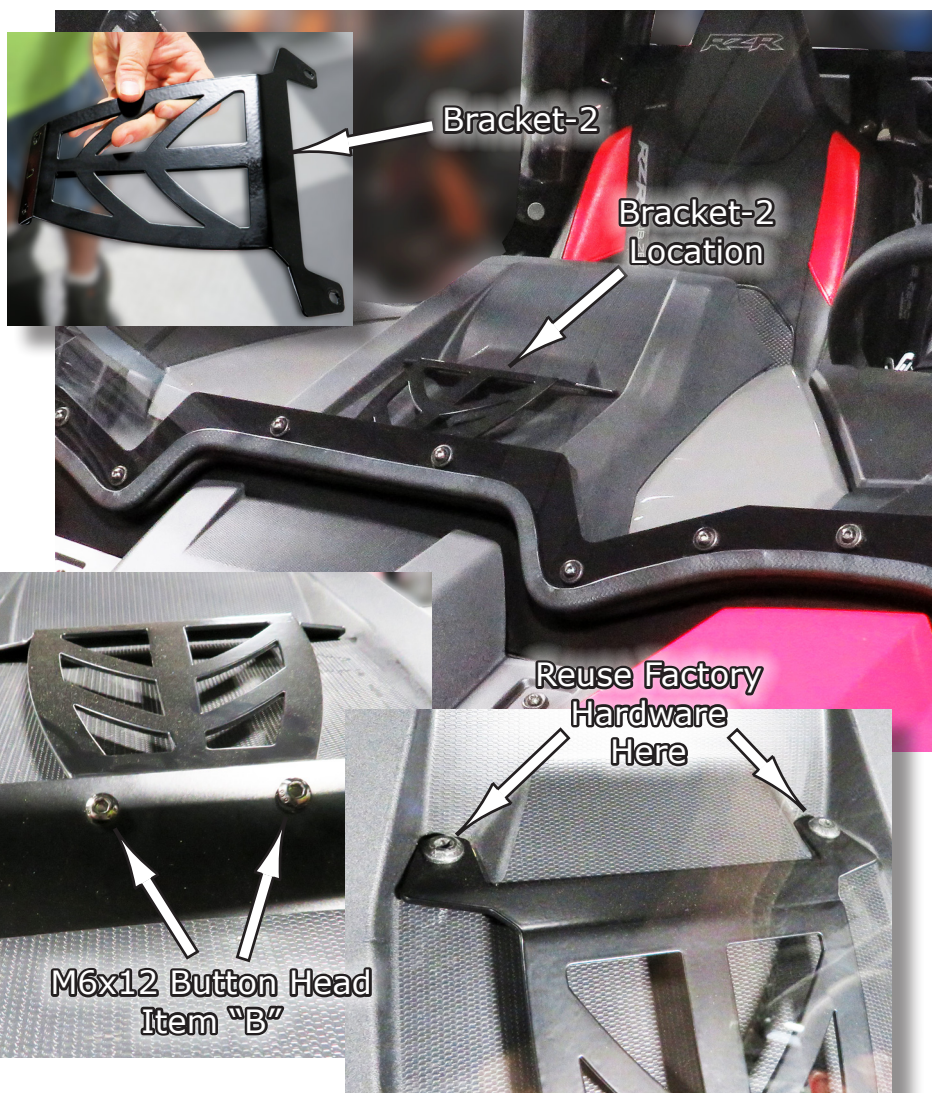

Fig.24

25. Now Zip-Tie the Actuator cables out of the way neatly and check all other cables and wires to make sure they are out of harms way and secure. See Fig.25.

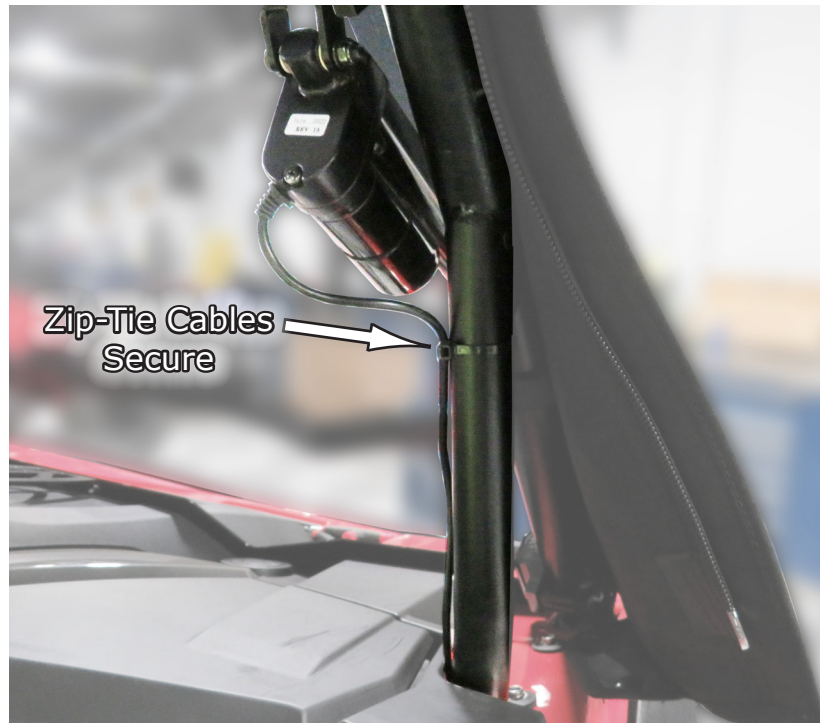

Fig.25

Liability Statement

SuperATV's® products are designed to best fit user's ATV/UTV under stock conditions. Adding, modifying, or fabricating any factory or aftermarket parts will void any warranty provided by SuperATV® and is not recommended. SuperATV's® products could interfere with other aftermarket accessories. If user has aftermarket products on machine, contact SuperATV® to verify that they will work together.

Although SuperATV® has thousands of satisfied customers, user should be aware that installing lift kits, long travel, or suspension kits, tires, etc. will change the ride of machine and may increase maintenance and part wear. Operating any off-road machine while, or after, consuming alcohol and/or drugs increases risk of bodily harm or death. No warranty or representation is made as to this product's ability to protect user from severe injury or death. SuperATV® urges operators and occupants to wear a helmet and appropriate riding gear at all times.

By purchasing and installing SuperATV® products, user agrees that should damages occur, SuperATV® will not be held responsible for loss of time, use, labor fees, replacement parts, or freight charges. SuperATV®, nor any 3rd party, will not be held responsible for any direct, indirect, incidental, special, or consequential damages that result from any product purchased from SuperATV®. The total liability of seller to user for all damages, losses, and causes of action, if any, shall not exceed the total purchase price paid for the product that gave rise to the claim.

SuperATV® will warranty only parts provided by SuperATV®. Any damage or problems with OEM housings, bearings, seals, or other manufacturers' products will not be covered by SuperATV®. SuperATV® parts and products are not warrantied if item was not installed properly, misused, or modified.

Installing, adding, modifying, or fabricating any factory or aftermarket product to your ATV/UTV may violate certain local, state, and federal laws. Be advised that laws vary depending on town, city, county, state, etc. Use of certain products on public streets, roads, or highways may be in violation law. The Buyer is solely and exclusively legally and personally responsible for any violation of the law by the installation or use of the product. You must abide by all local, state, and federal laws, including but not limited to vehicle safety, traffic laws, and ordinances. It is your responsibility to know the laws and how they apply to you.

The Buyer is responsible to fully understand the capability and limitations of his/her vehicle according to manufacturer specifications, warnings and instructions and agrees to hold SuperATV® harmless from any damage resulting from failure to adhere to such specifications, warnings and/ or instructions. The Buyer is also responsible to obey all applicable federal, state, and local laws and ordinances when operating his/her vehicle while using this product, and the Buyer agrees to hold SuperATV® harmless from any violation thereof.

If you have any problems/questions on this kit, contact us by email at [superatv.com](mailto:sales@superatv.com).

Need help with your installation?



sales@superatv.com



www.superatv.com



1-855-743-3427



8:00am - 9:00pm EST M-Th
8:00am - 7:00pm EST Friday
9:00am - 2:00pm EST Saturday

*Thank You
For Choosing*



Like SuperATV on Facebook to keep up to date on new products!