

INSTALLATION INSTRUCTIONS

Soft Cab - Upper Door Kit: for Can-Am Maverick X3 MAX

- Do not discard packaging until product has been successfully installed.

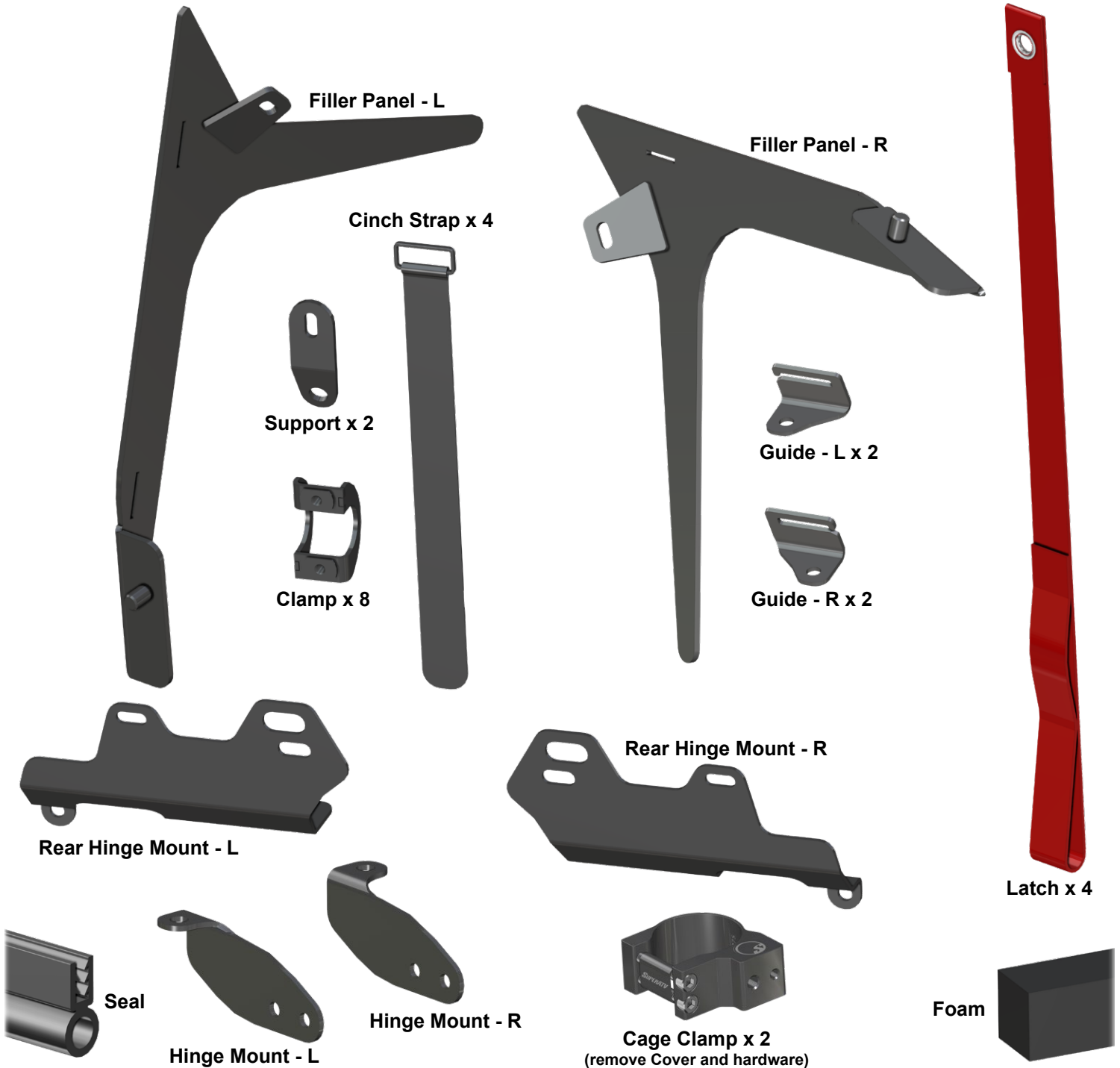

Need help with your installation?



sales@superatv.com



www.superatv.com



1-855-743-3427



8:00am - 8:00pm EST M-Th
8:00am - 7:00pm EST Friday
9:00am - 2:00pm EST Saturday

Read instructions and view illustrations before beginning.

*Thank You
For Choosing*

SUPERATV.COM

Notes:

- Hook and Loop Fasteners should be applied at a temperature of 70°F or above.
- Use Denatured Alcohol and thoroughly clean any area where Hook and Loop Fasteners will be installed.
- Installing and adjusting Soft Cab is easier with two people.
- When cleaning Soft Cab, use soap and water only. Do not use detergent, window cleaner, solvents.
- Do not use a dry cloth or rag on windows.
- Any whiteness, clouding, wrinkles, or waves that develop will gradually disappear when Soft Cab is exposed to sunlight and/or heat. Use a heat gun or hair dryer to speed up this process. Do not overheat or heat in one area for an extended period of time.
- Windows must be rolled up when trailering machine.

Liability Statement

SuperATV's® products are designed to best fit user's ATV/UTV under stock conditions. Adding, modifying, or fabricating any factory or aftermarket parts will void any warranty provided by SuperATV® and is not recommended. SuperATV's® products could interfere with other aftermarket accessories. If user has aftermarket products on machine, contact SuperATV® to verify that they will work together.

Although SuperATV® has thousands of satisfied customers, user should be aware that installing lift kits, long travel, or suspension kits, tires, etc. will change the ride of machine and may increase maintenance and part wear. Operating any off-road machine while, or after, consuming alcohol and/or drugs increases risk of bodily harm or death. No warranty or representation is made as to this product's ability to protect user from severe injury or death. SuperATV® urges operators and occupants to wear a helmet and appropriate riding gear at all times.

By purchasing and installing SuperATV® products, user agrees that should damages occur, SuperATV® will not be held responsible for loss of time, use, labor fees, replacement parts, or freight charges. SuperATV®, nor any 3rd party, will not be held responsible for any direct, indirect, incidental, special, or consequential damages that result from any product purchased from SuperATV®. The total liability of seller to user for all damages, losses, and causes of action, if any, shall not exceed the total purchase price paid for the product that gave rise to the claim.

SuperATV® will warranty only parts provided by SuperATV®. Any damage or problems with OEM housings, bearings, seals, or other manufacturers' products will not be covered by SuperATV®. SuperATV® parts and products are not warrantied if item was not installed properly, misused, or modified.

Installing, adding, modifying, or fabricating any factory or aftermarket product to your ATV/UTV may violate certain local, state, and federal laws. Be advised that laws vary depending on town, city, county, state, etc. Use of certain products on public streets, roads, or highways may be in violation law. The Buyer is solely and exclusively legally and personally responsible for any violation of the law by the installation or use of the product. You must abide by all local, state, and federal laws, including but not limited to vehicle safety, traffic laws, and ordinances. It is your responsibility to know the laws and how they apply to you.

The Buyer is responsible to fully understand the capability and limitations of his/her vehicle according to manufacturer specifications, warnings and instructions and agrees to hold SuperATV® harmless from any damage resulting from failure to adhere to such specifications, warnings and/ or instructions. The Buyer is also responsible to obey all applicable federal, state, and local laws and ordinances when operating his/her vehicle while using this product, and the Buyer agrees to hold SuperATV® harmless from any violation thereof.

- Cut and install Hook and Loop to Hinge Mount - L in location shown. Set aside.



- Install Seal to Filler Panel - L.



- Install Support to Filler Panel - L with hardware shown; do not tighten.

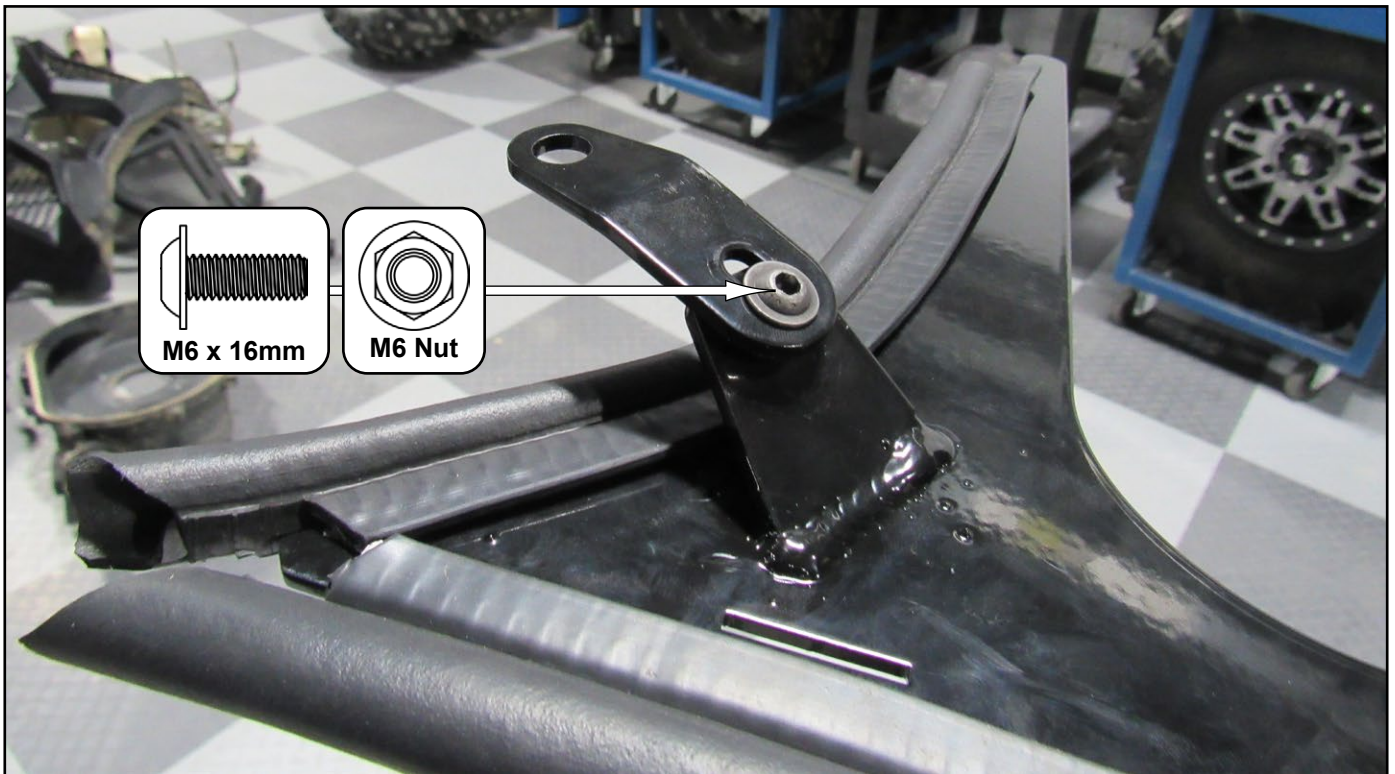

- Secure Filler Panel - L to machine with components shown; do not tighten.



- Install Hinge Mount - L to Cage Clamp with hardware shown; tighten.

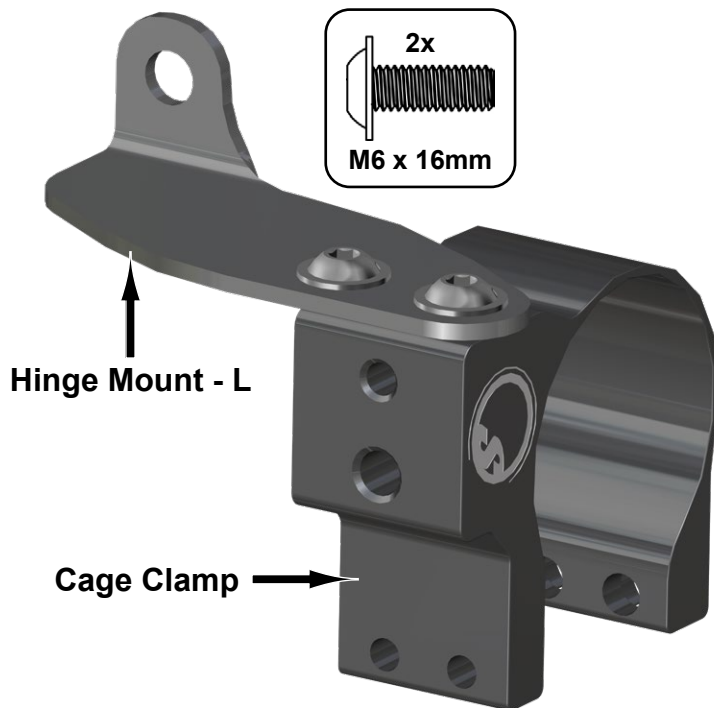

- Install Hook and Loop Fastener to Cage in location shown.
- Install Cage Clamp assembly to location shown.
- Secure with previously removed hardware and Cover.



- Place Left Front Door onto machine.
- Secure Left Front Frame to stock Door with Clamps and hardware shown; do not tighten.

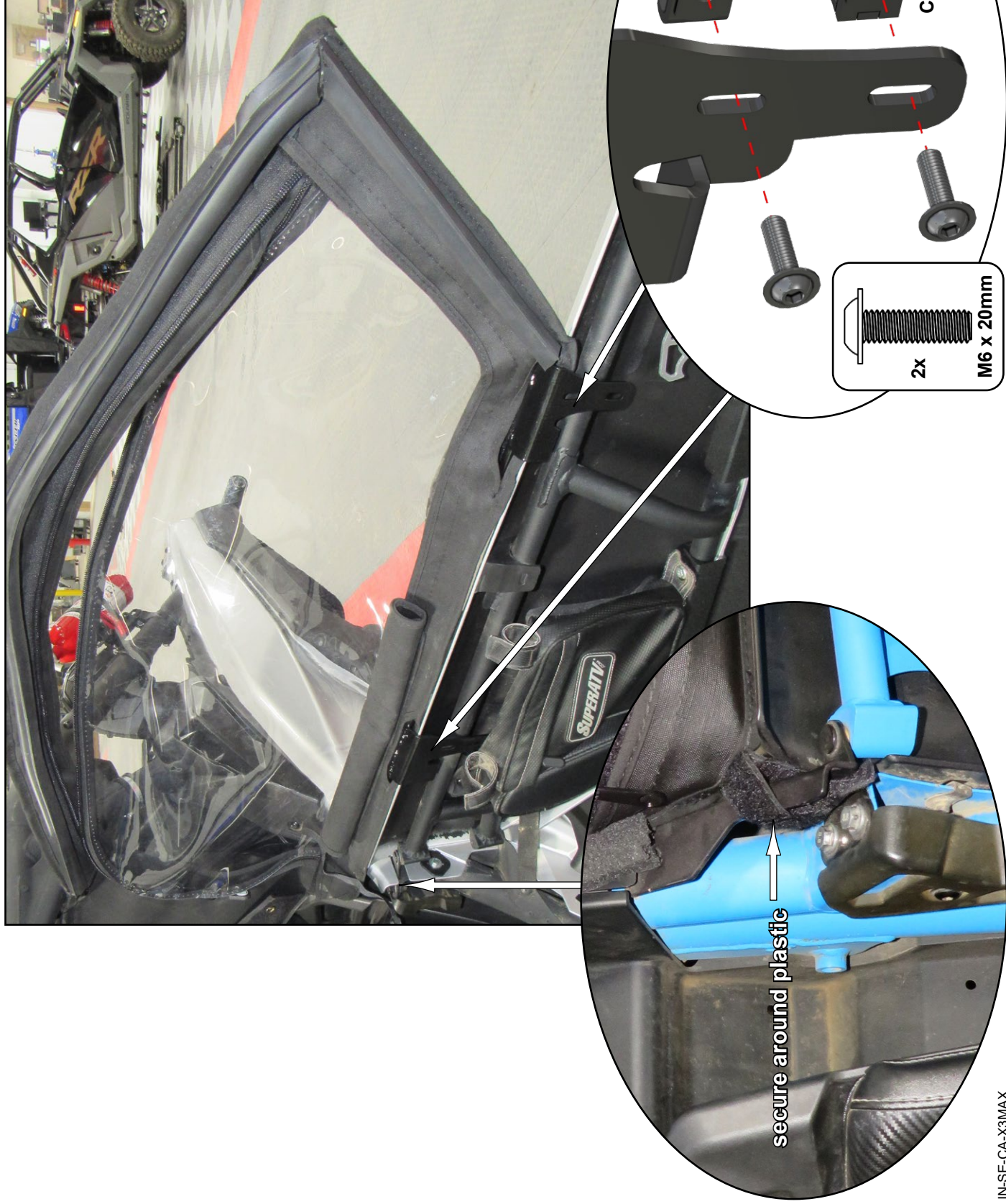

- Secure Left Front Frame to Hinge Mount - L with hardware shown.

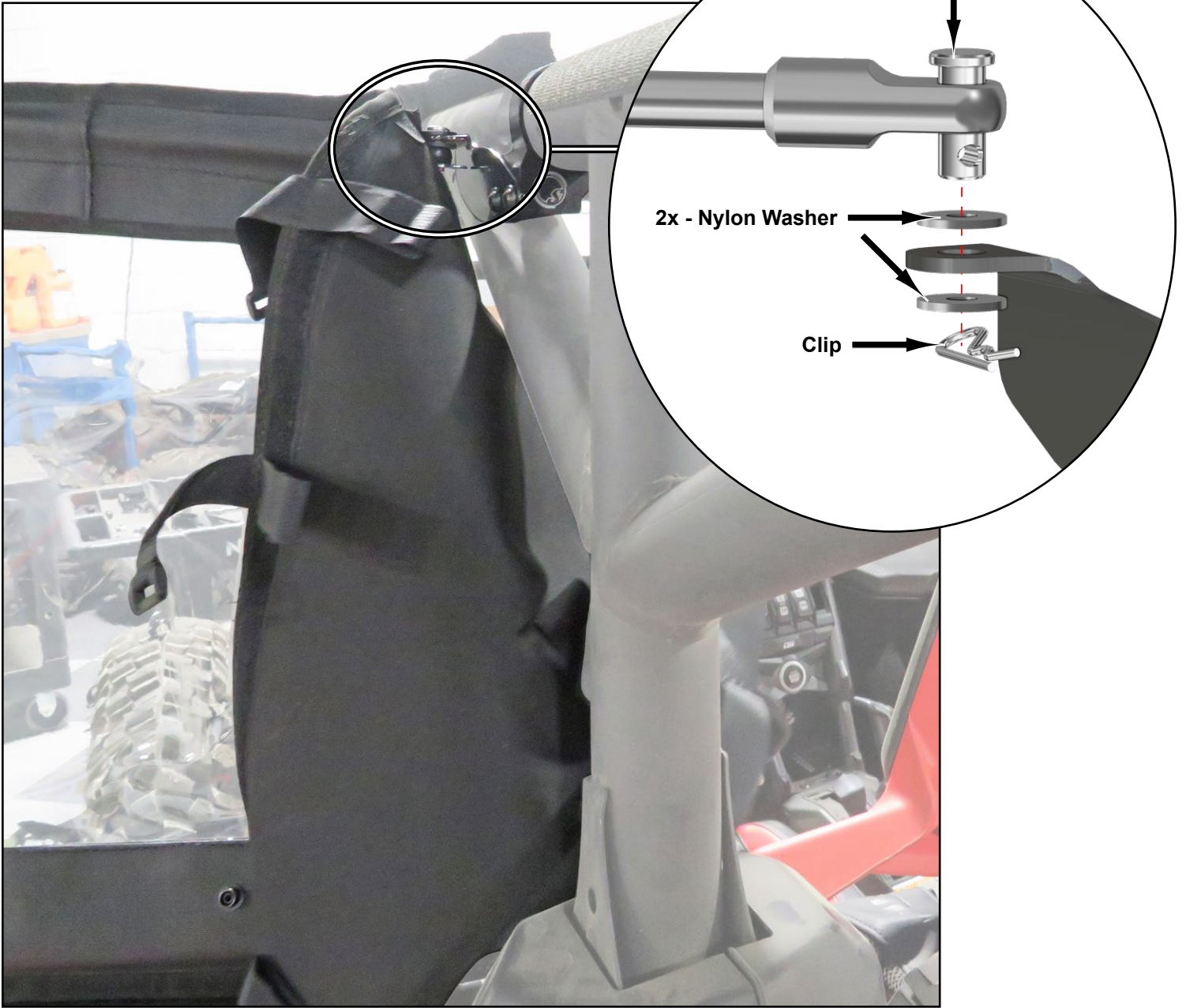

- Secure Straps around Cage.
- Secure Hook and Loop on Door to Hook and Loop previously installed on Cage.

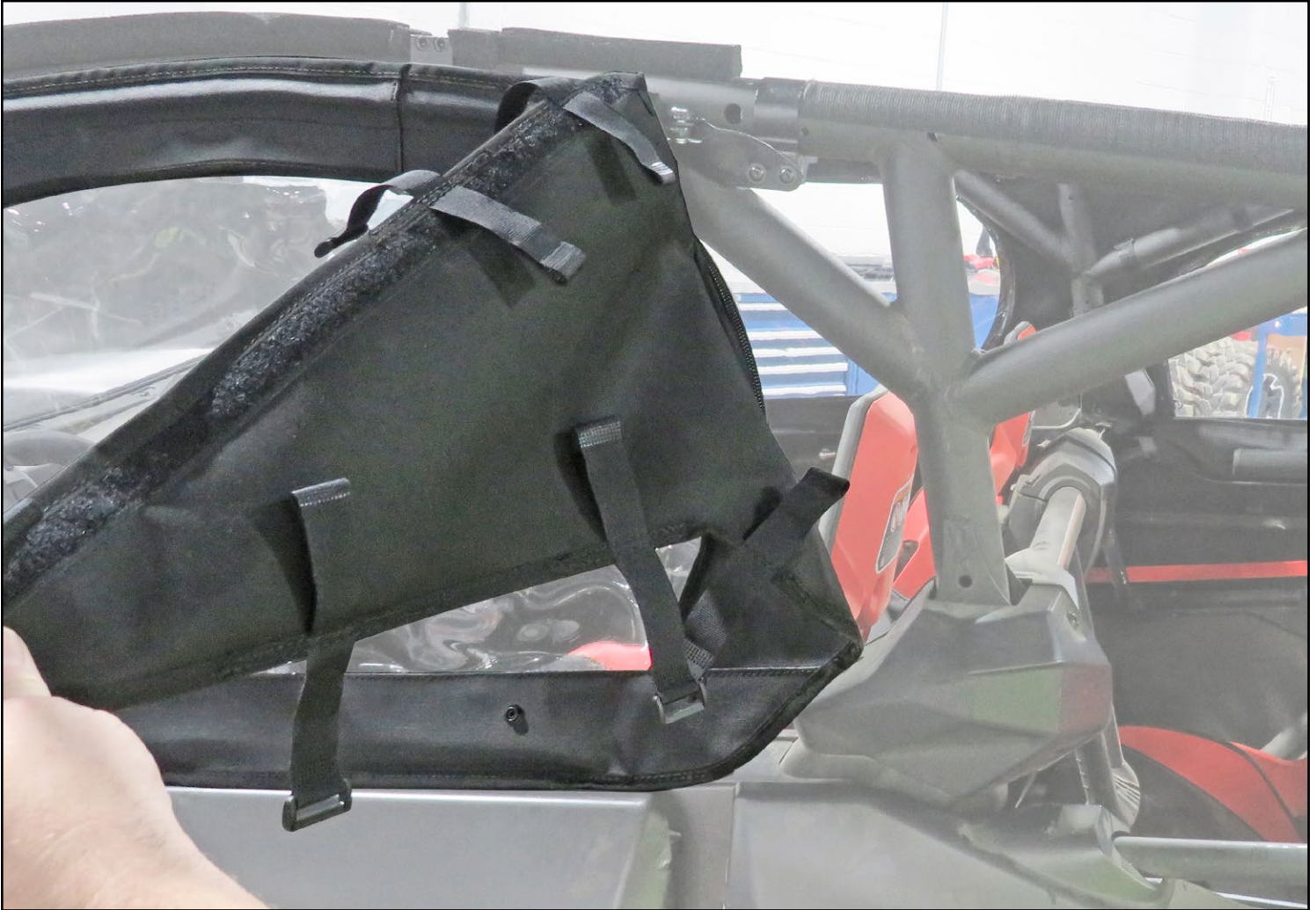



- Install Guide - L with components shown; tighten.

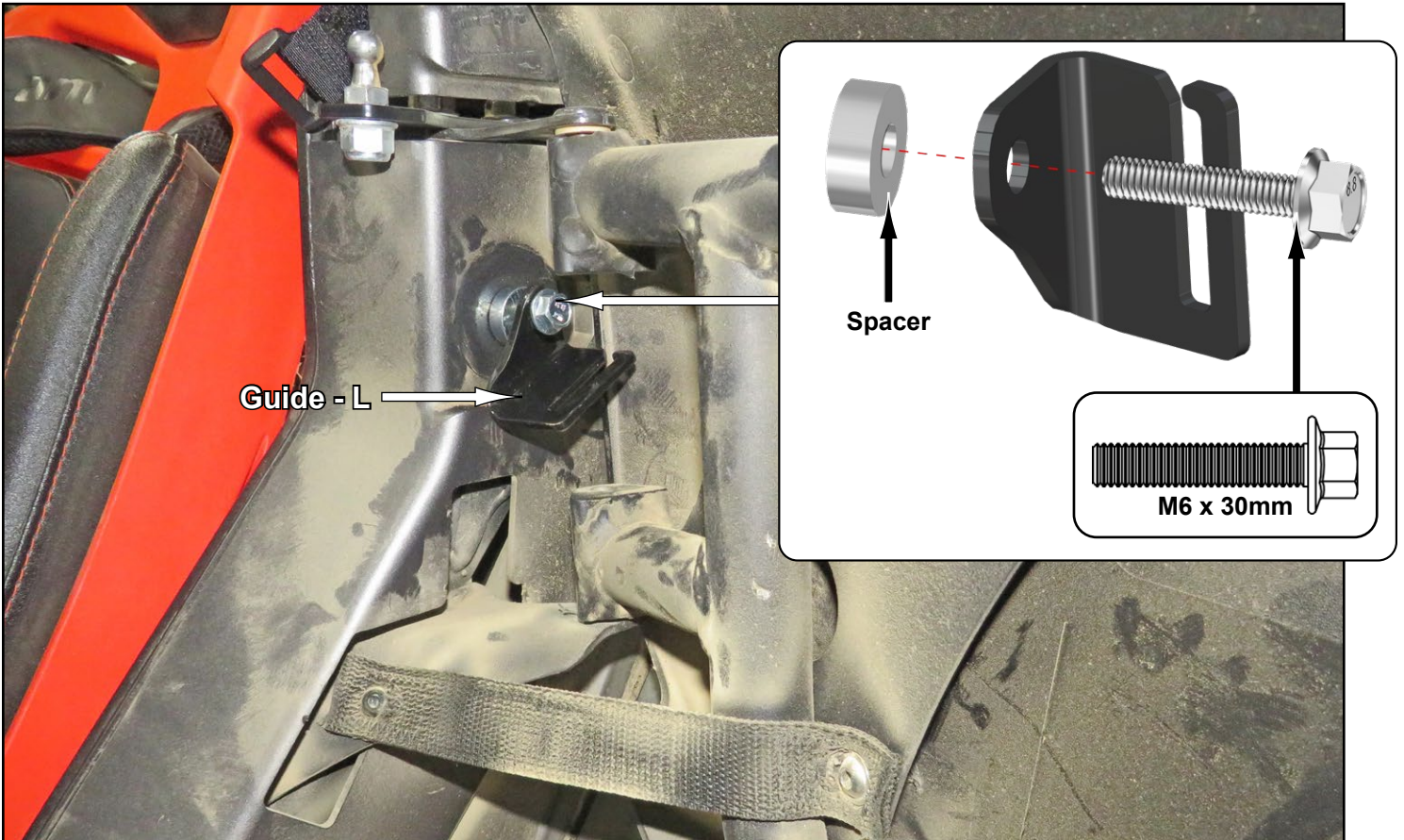

- Install hardware shown to locations shown; tighten.

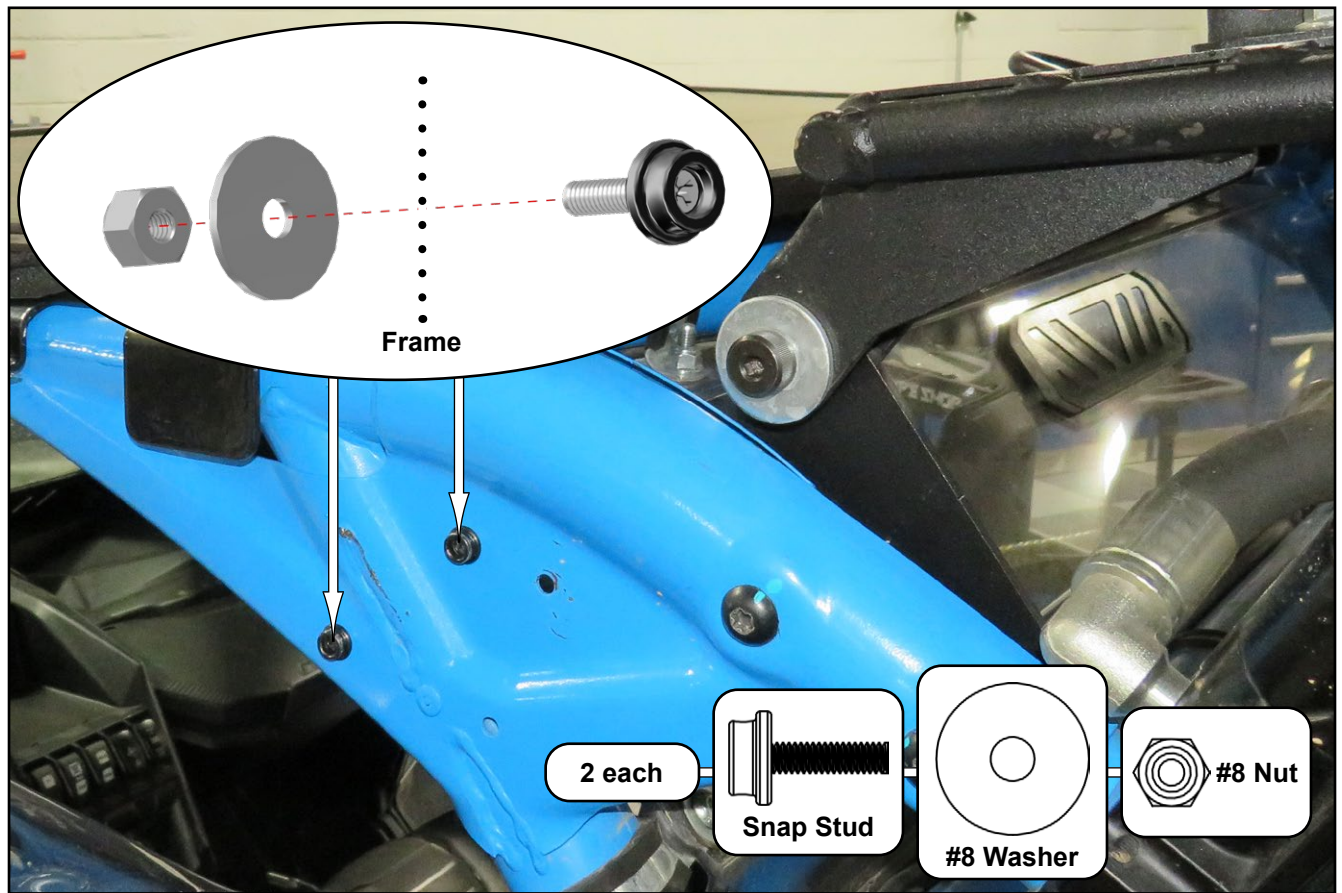

- Place Left Rear Door onto machine.
- Secure Left Rear Frame to stock Door with Clamps and hardware shown; do not tighten.



- Install Hinge Mount - L to Frame with hardware shown; do not tighten.

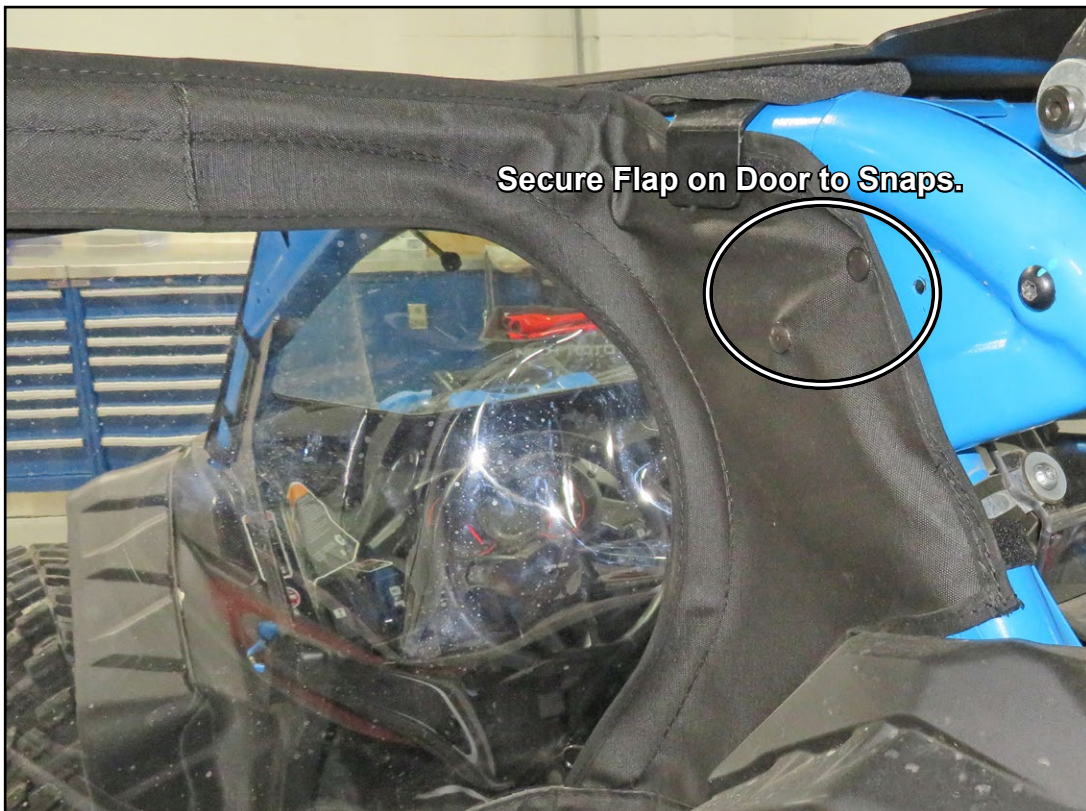
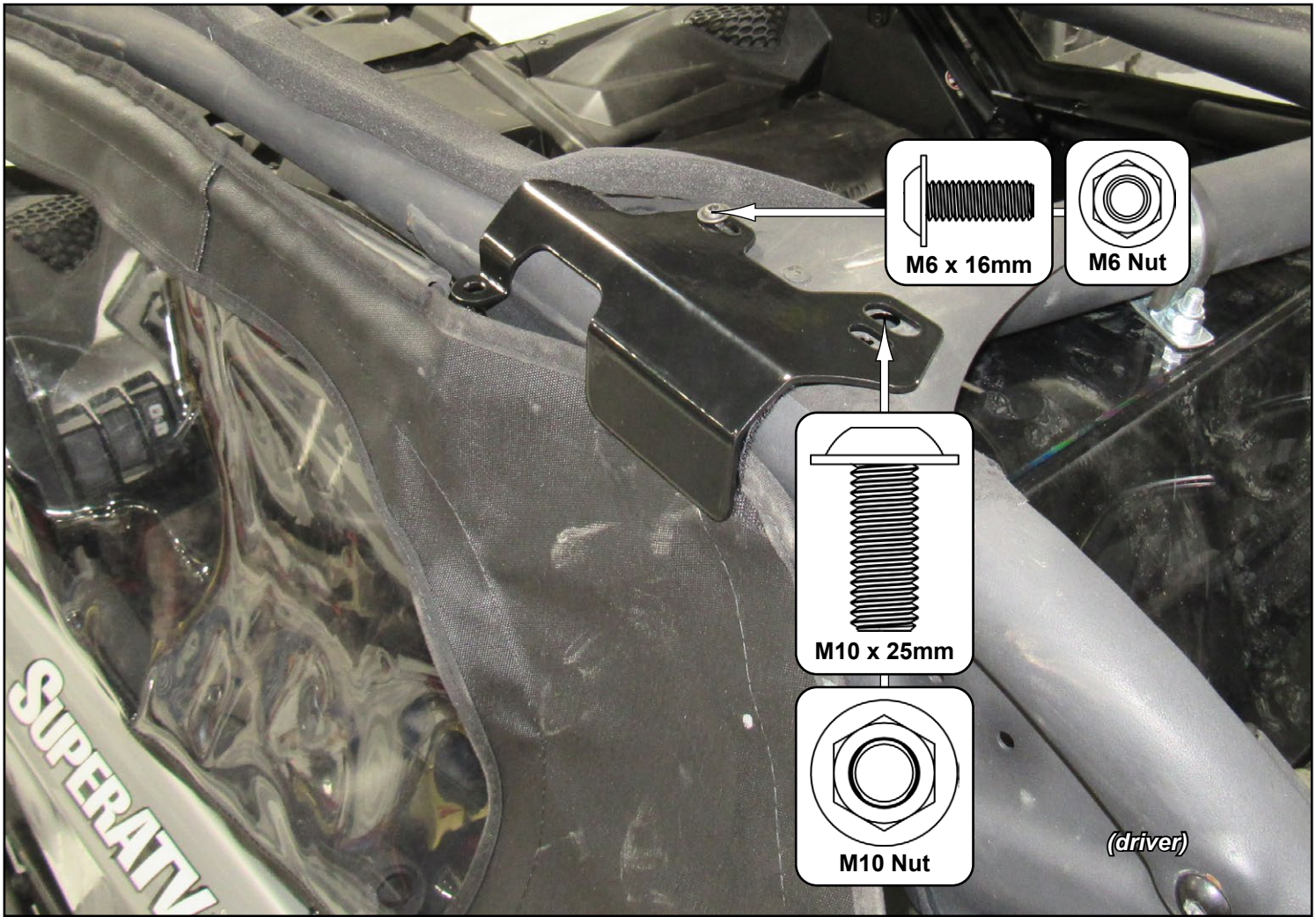

- Secure Left Rear Frame to Hinge Mount - L with hardware shown.

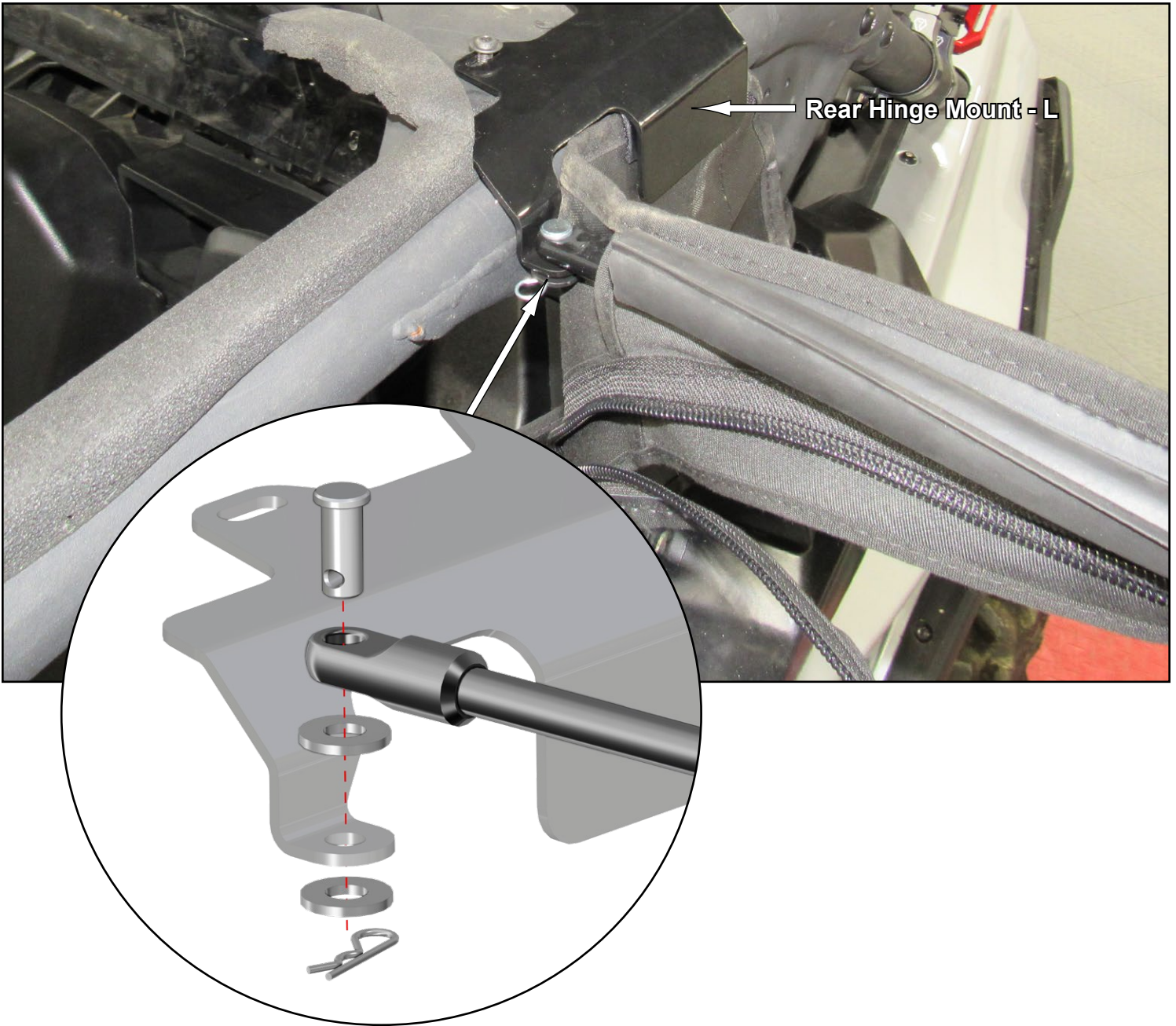





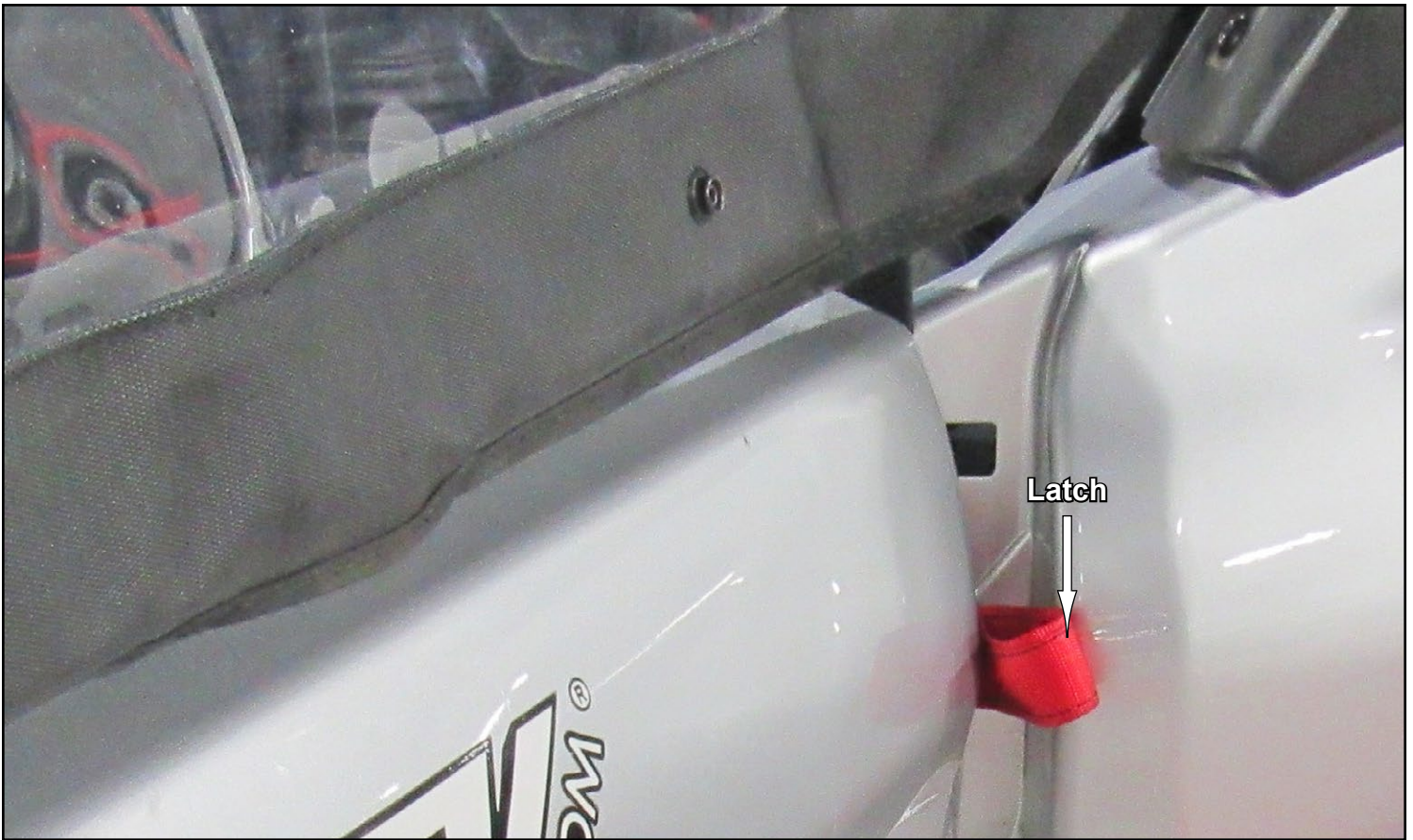

- Thread Latch through Guide - L and secure to stock mounting location with hardware shown; tighten.

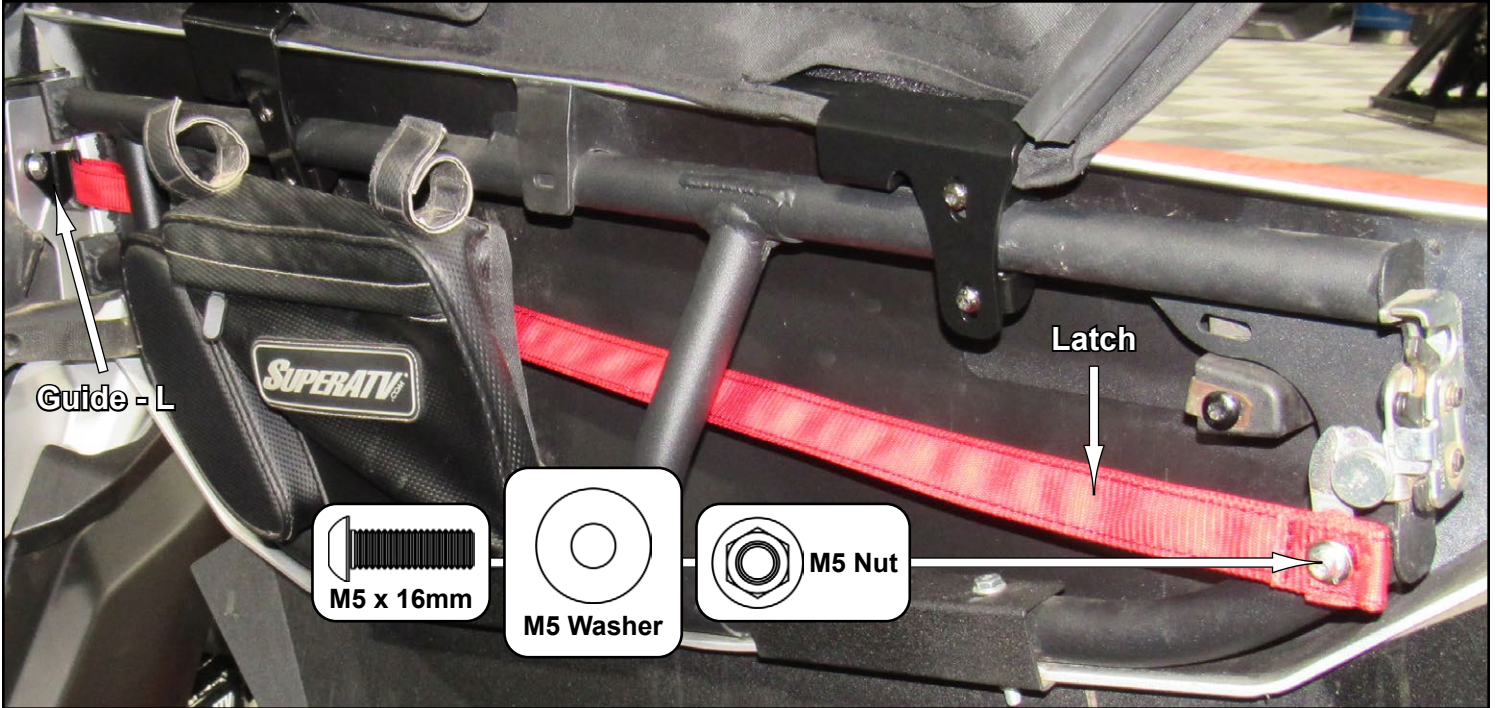

- Repeat for remaining Latches.

- Cut and install Foam to location shown.



- Align Door assembly to machine and tighten all hardware.
- Repeat steps for passenger side installation.

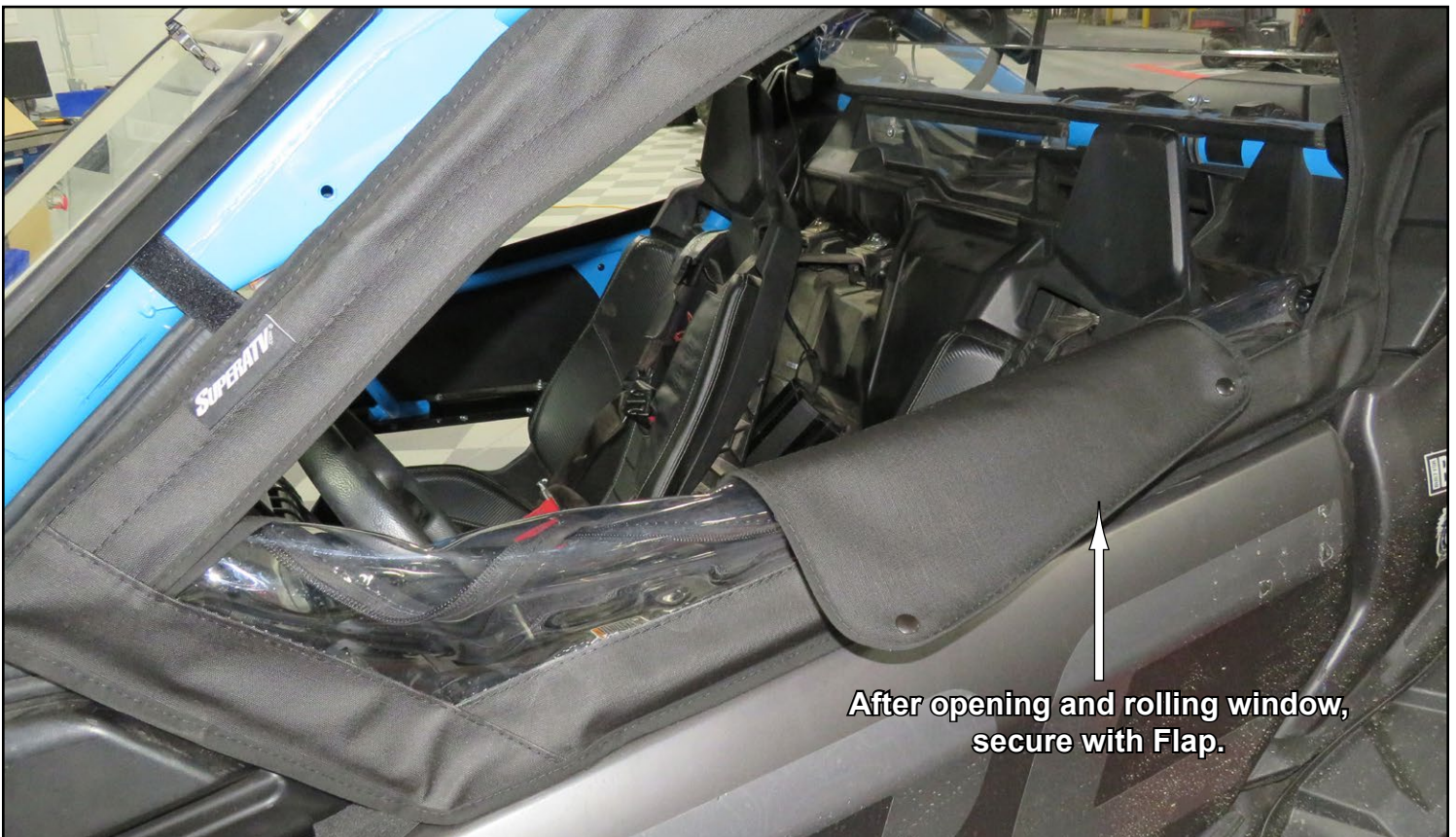

After opening and rolling window,
secure with Flap.

SuperATV Sport Side View Mirrors installation:

- Remove Mirrors from machine.
- Place passenger side Mirror onto Left Door and mark hole locations.
- Use a soldering iron to create holes in material.



- Secure Mirror with hardware shown; tighten.



- Install Plug into Mirror.



- Use provided Mirror Hardware Kit if Side Mirrors are not SuperATV.
- Use a soldering iron to create mounting holes in material.



Machines with Sport Roof installed:

- Measure 1/2" away from edge and cut away material.

