

FALCON RIDGE SUMMIT SERIES LED LIGHT INSTALLATION GUIDES

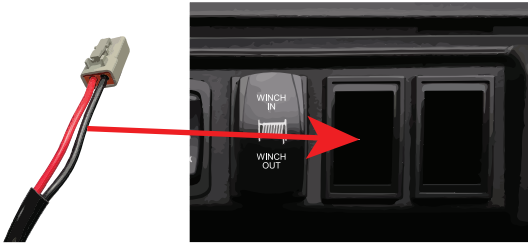

1. Locate an empty switch knock out in your machine. Then push the wire harness from the inside of your machine through the empty knock out until the switch snaps into place.

Temporarily locate where you'd like to install your lights to ensure there is enough length in the wire harness.

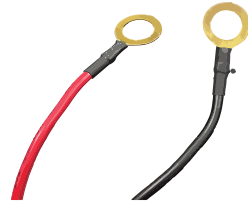

2. Connect the ring terminals to the closet bus bar. Red wire goes to 12v (+), black wire goes to 12v (-)



3. Plug the end of the harness connector into your lights and test. Once you've confirmed function, neatly route and secure all wires with zip ties.

Mounting Guide: Summit Series Light Bars

Part Numbers: 55-20630, 55-20631, 55-20632, 55-20633, 55-20634, 55-20635, 55-20636

Parts List

1	Side Bracket 4.0mm	QTY 2
2	M8 x 35 Hex Screw	QTY 2
3	M8 x 5 Nut	QTY 2
4	M8 x 20 x 1.5 Flat Washer	QTY 2
5	M8 Split Lock Washer	QTY 2
6	M6 x 16 Screw	QTY 2
7	M6 Flat Washer	QTY 2
8	M6 Split Lock Washer	QTY 2
9	M4 x 8 Screw	QTY 4

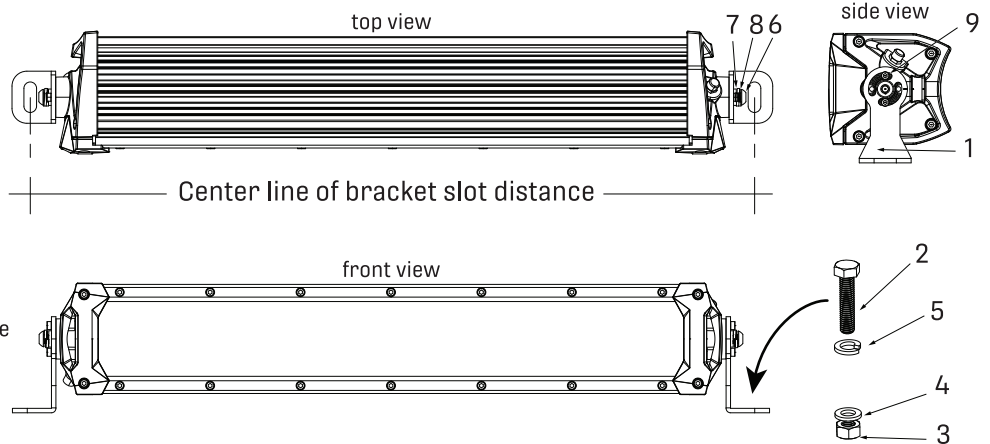

1. Install side brackets
2. Measure center line to slot to center line of slot
3. Mark where you'd like to mount on your machine
4. Use a 5/16" drill bit to drill your location. Secure using the provided M8 hardware

Mounting Guide: Summit Series 7" Driving Lights

Part Numbers: 55-20639, 55-20640

Parts List

1	M12 x 30 Hex Screw	QTY 2
2	M12 Nut	QTY 2
3	M12 Split Lock Washer	QTY 2
4	M12 Flat Washer	QTY 2
5	M10 x 30 Bolt	QTY 4
6	M10 Nut	QTY 4
7	M10 Split Lock Washer	QTY 4
8	M10 x 20 x 2.0 Flat Washer	QTY 4
9	Rubber Pad	QTY 2

Drill a 1/2" hole for the center bolt in the location you'd like the bracket mounted. Drill a 7/16" for the 2 outer holes. Use bracket as a template as needed.

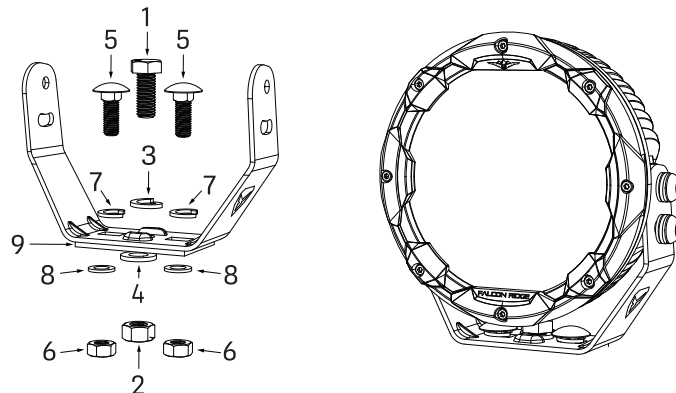

Mounting Guide: Summit Series Pod Lights

Part Numbers: 55-20637, 55-20638

Parts List

1	Mounting Bracket	QTY 2
2	M6 x 12 Screw	QTY 4
3	M6 Split Lock Washer	QTY 4
4	M6 x 11 x 1.5 Flat Washer	QTY 4
5	M8 x 35 Hex Screw	QTY 2
6	M8 x 5 Nut	QTY 2
7	M8 x 20 x 1.5 Flat Washer	QTY 2
8	M8 Split Lock Washer	QTY 2

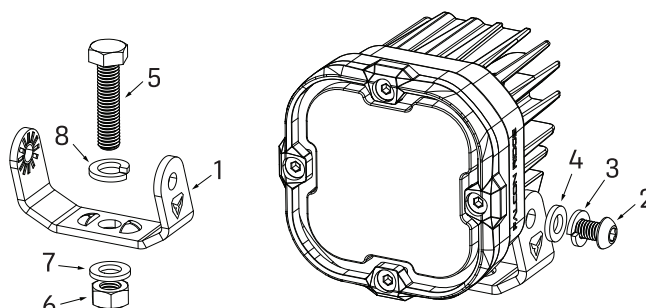

Drill a 5/16" hole in the location you'd like the bracket mounted. You may need to ream the hole a little bit to fit the M8 screw.

If you are having any issues with your Falcon Ridge product, please reach out to Falcon Ridge customer service toll free at 800-213-7981 or info@falconridge.com

FALCON RIDGE
A Nival Company
3510-1 Port Jacksonville Pkwy
Jacksonville, FL 32226