

# INSTALLATION INSTRUCTIONS

## Power Steering Kit: PS-H-PIO700-001

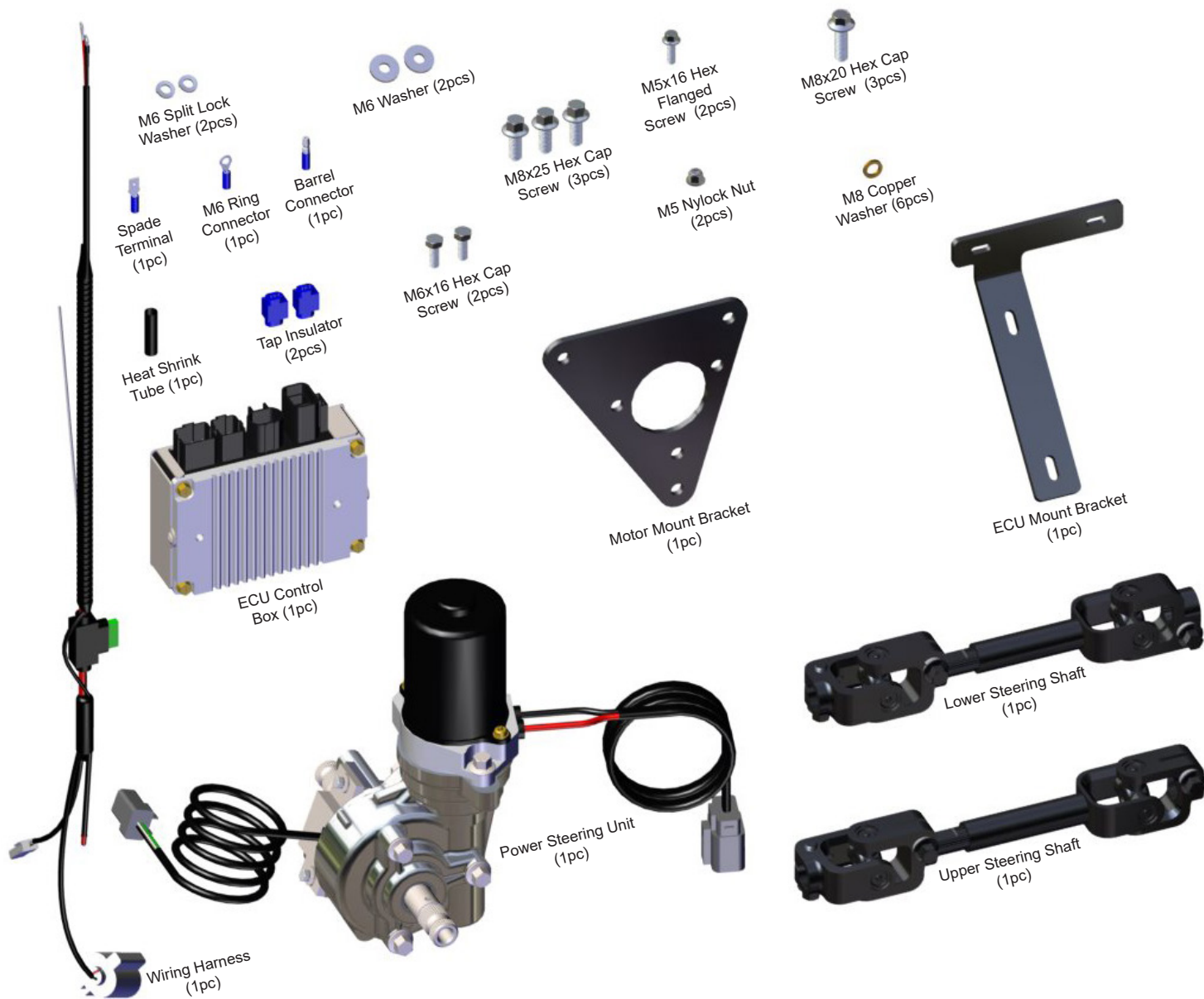

- ### What You'll Be Doing
- 🔧 Remove the Hood To Access The Steering
  - 🔧 Disassemble Gauge Cluster and Dash Panel
  - 🔧 Remove Key Switch
  - 🔧 Remove Factory Steering Rod
  - 🔧 Install Both Upper & Lower Steering Shafts
  - 🔧 Install ECU Bracket to ECU
  - 🔧 Mount ECU to vehicle & Pug In Connectors
  - 🔧 Route Harness to Battery
  - 🔧 Hook up Red & Black Wires To Battery

· Installation Pre-Check ·

ⓘ Before installing, ensure that all Gaskets in electrical connections are properly seated.

ⓘ If Gaskets are not seated use a Flathead Screwdriver to seat them.

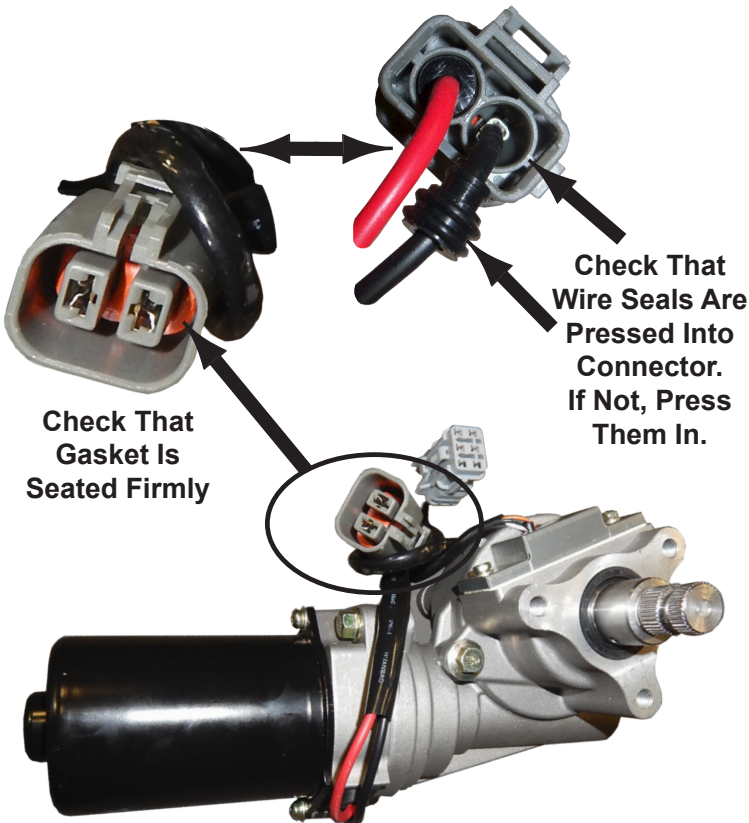

**Secure LED in a visible location**



**NOTE:** When activated, Diagnostic light will flash once for about (1) second before turning off, indicating proper function. Should different flashing patterns occur, contact SuperATV.

Plug	Function	Plug	Function
A	Torque Sensor	C	Power
B	Switched 12V Source	D	Motor

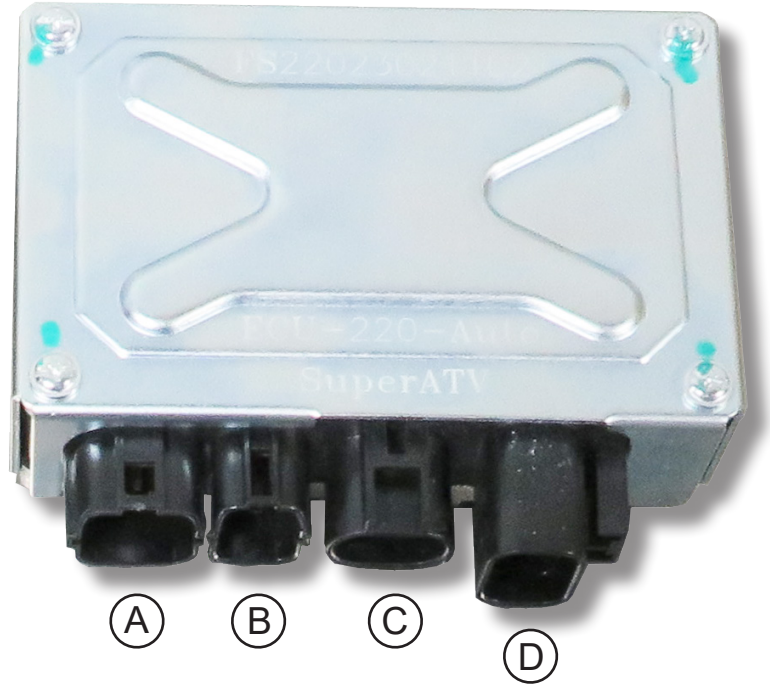

**... Components Removal - Keep All Components Removed From Machine ...**

1. First, remove Hood from vehicle for access to the Factory Steering rod. See **Fig.1**. then we'll move inside the cab to start the components removal.



**Fig.1**

2. Looking down into the compartment under the hood, you can see the steering rod and where the installation will take place. See **Fig.2**.

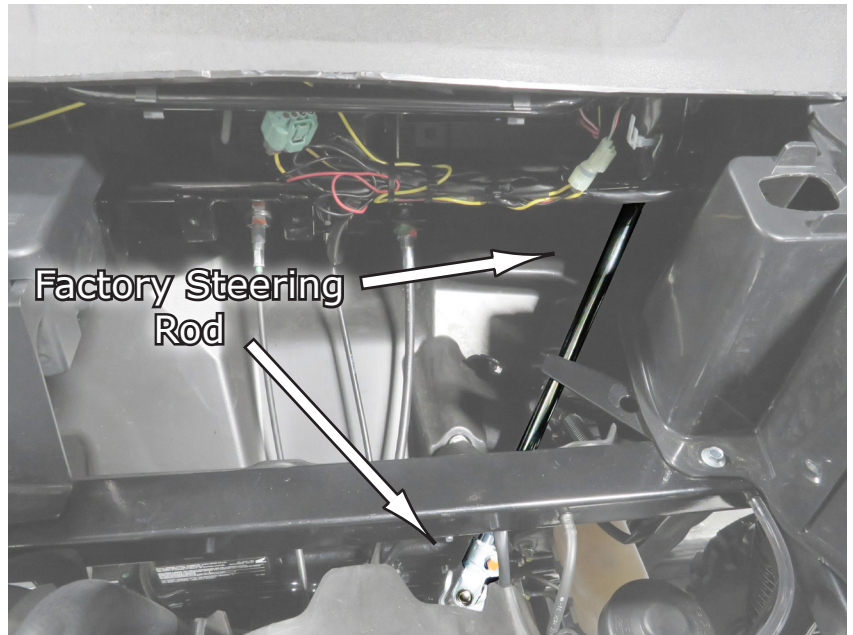

**Fig.2**

3. Now, you'll remove the steering column display panel assembly, by first removing the (4) screws around the perimeter of the cover. Take the front cover off and set aside. See **Fig.3**.



**Fig.3**

4. Next, remove the (3) screws from the back of the cluster to remove from the plastic front casing and remove the internal cluster. **See Fig.4.**

(Fig.4 shown with mount already removed to show you placement of the screws for this step. You will remove it in the following steps )



**Fig.4**

5. After the front cover is removed, take out the internal cluster as shown in **Fig.5.**



**Fig.5**

6. Then remove the (2) 5mm bolts from each side of the cluster that mounts the cluster to the column, **See Fig.6.**

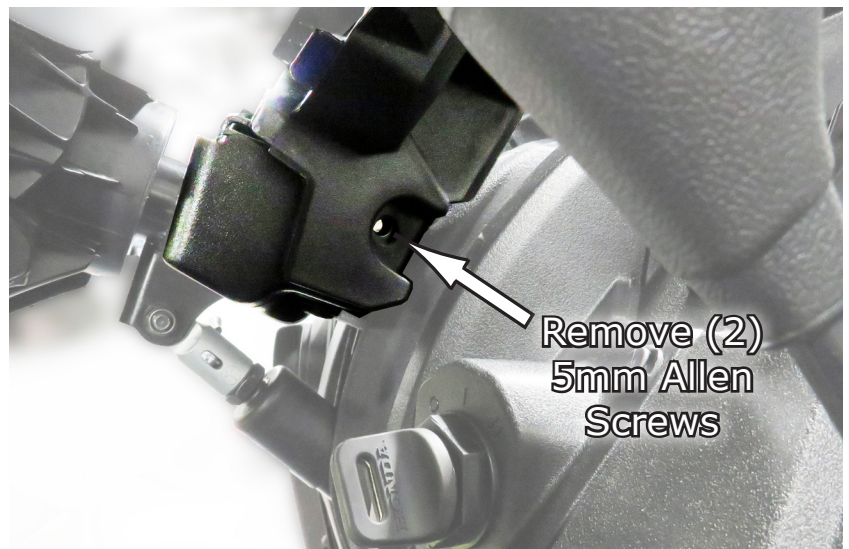

**Fig.6**

7. And remove the center screw to allow you to remove the display cluster mounting plastic. Set Aside. See **Fig.7**.

8. Now remove the rubber Seal and set aside. Seal is fitted, but just pulls out along the edges. See **Fig.8**.

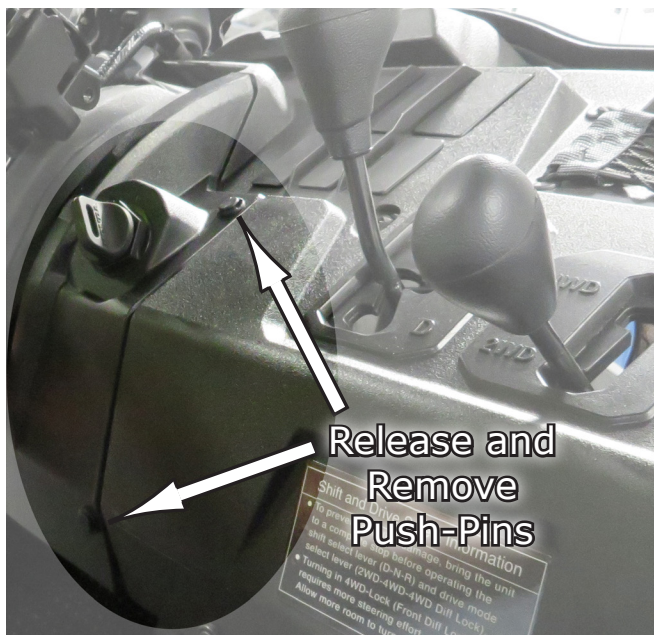

**Fig.7**

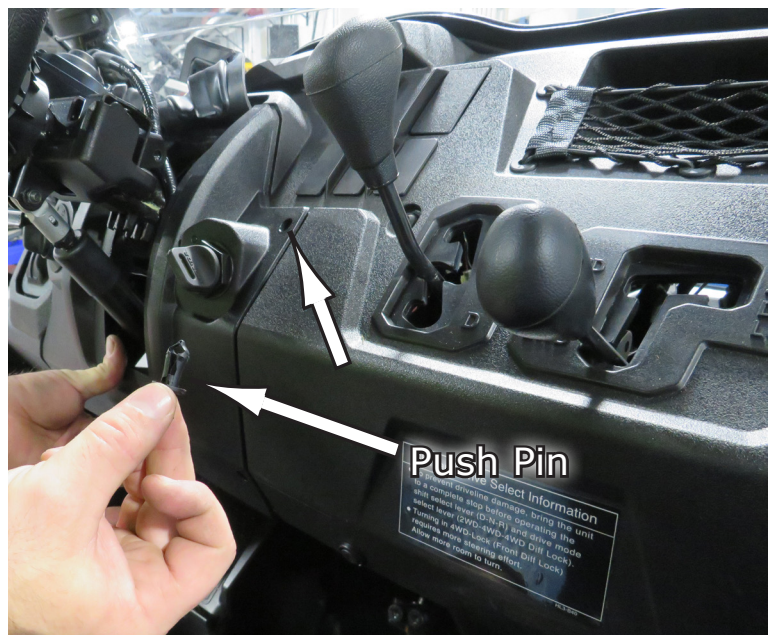

**Fig.8**

9. Next you will remove the steering dash panel by removing the (4) Push-Pins around the panel's perimeter as shown in See **Fig.9 & 9a**.



**Fig.9**



**Fig.9a**

10. The next thing is to remove the Ignition Key Switch from the Panel you just removed. Unscrew plastic nut from the front and pull it out the back side of the panel. See **Fig's 10 & 10a**.



Fig.10



Fig.10a

11. Set panel aside and let display cluster hang in place. This will now give you access space to get to the Steering components. See **Fig.11**.

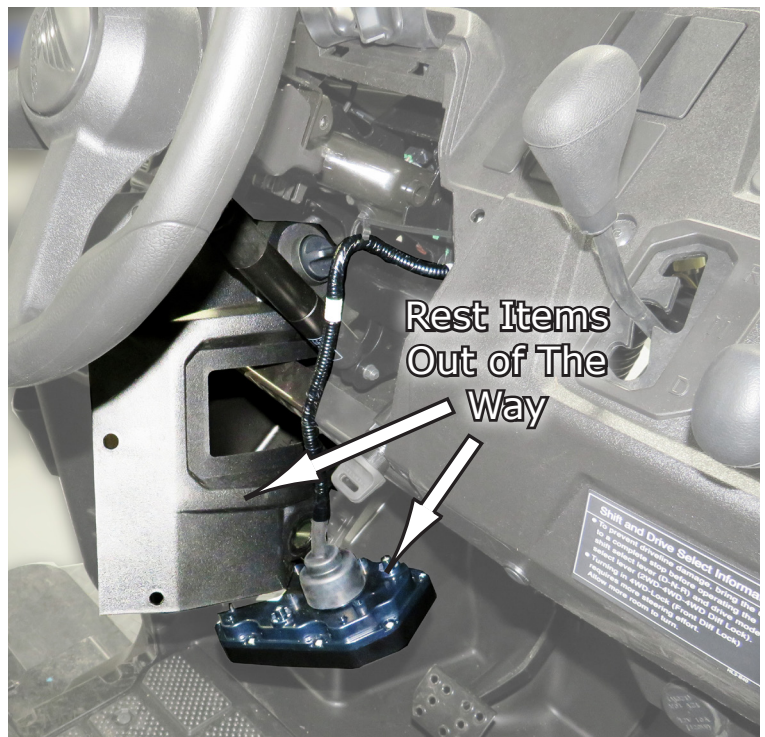

Fig.11

12. Now that you have upper access to the steering components, You are ready to remove the Factory Steering Rod in the next steps.

13. To remove the Factory Steering Rod, locate the Lower connecting bolt, and remove it from the bottom shaft, disconnecting it at the bottom. See Fig.12.

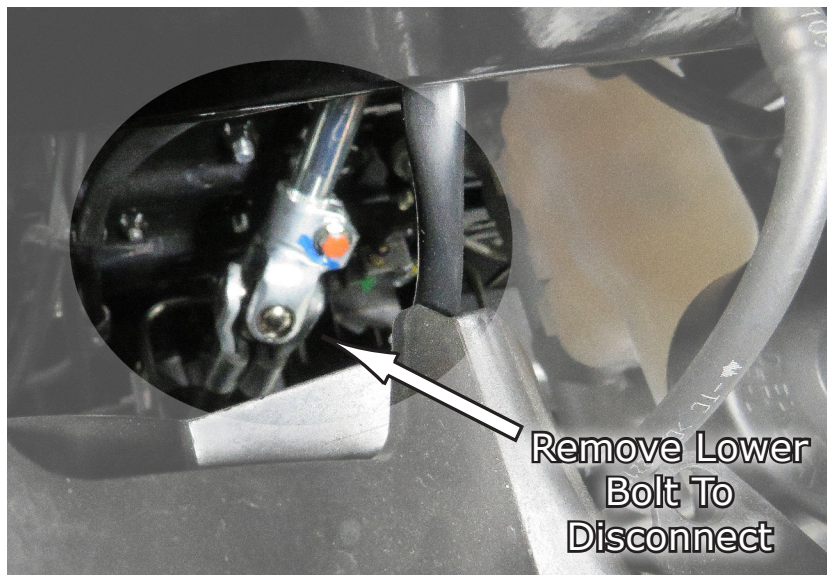

Fig.12

14. After disconnecting the lower bolt of the Factory Steering Rod, move back to the cab where you removed the steering dash panel, and locate the upper bolt of the steering rod. Access in front of the steering wheel. Remove the bolt, and you are now ready to slide it off the steering spline. See Fig.13.

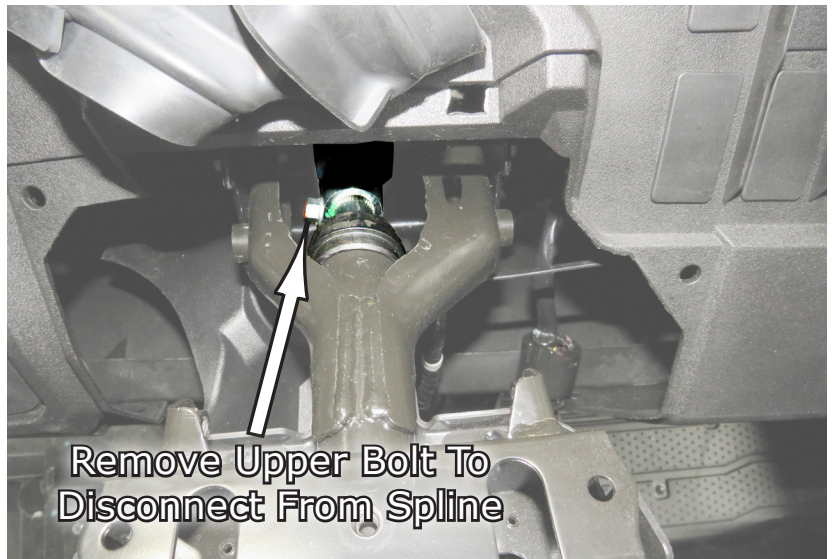

Fig.13



15. After you release the upper bolt of the steering rod, slip it off the spline and pull it up and out the top thru the same access point as shown in Fig.14. Now you are ready to install your New Kit.



Fig.14



... Installing Your New Kit ...

16. First, you will notice that there are (2) shafts to install. The Longer one is the Upper Shaft and the Shorter one is the Lower Shaft. See Fig.15.

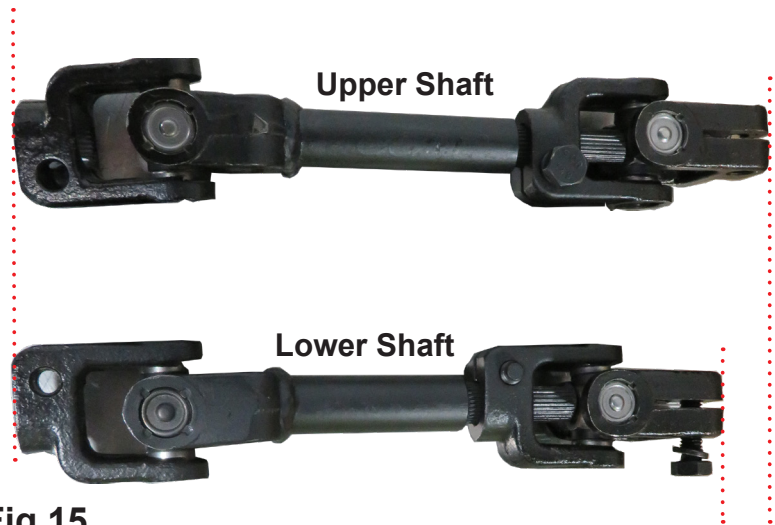

Fig.15

17. You will install the Lower Shaft onto the lower spline first using the hardware provided in your kit and tighten. See Fig.16 & 17.



Fig.16

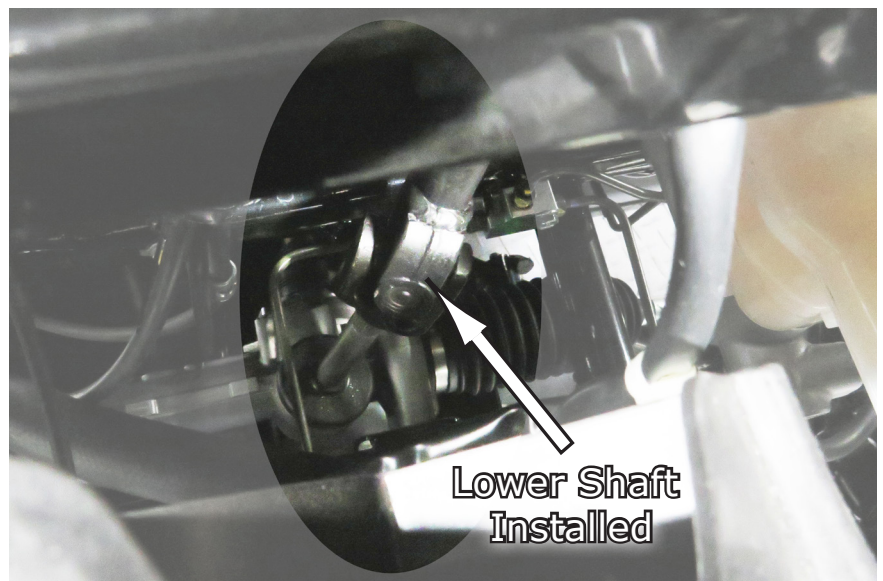

Fig.17

18. Fig.18 shows how these parts install one into the other, for your reference.

19. Now install the Upper Shaft to the steering column and tighten.  
See Fig.19 & 20.



Fig.19

Fig.20 shows both shafts installed and ready to install the Motor.

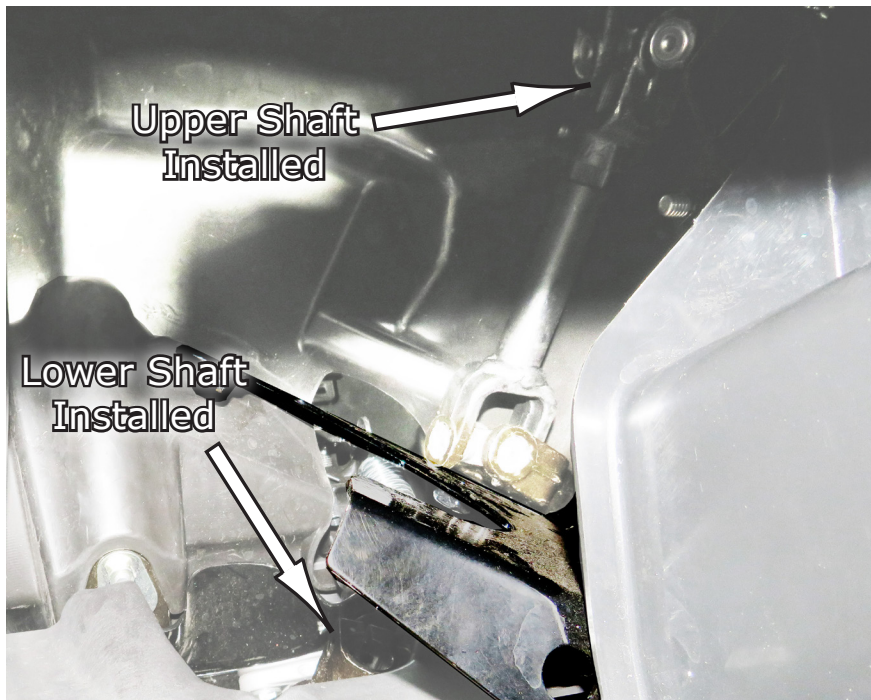

Fig.20

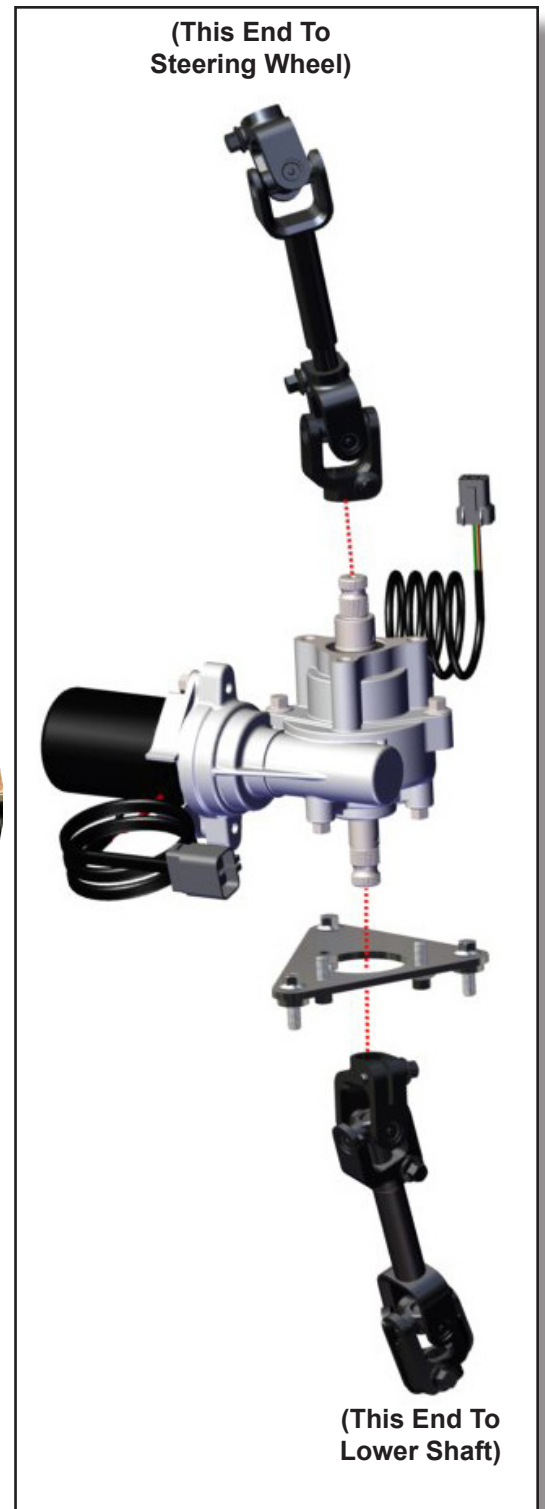
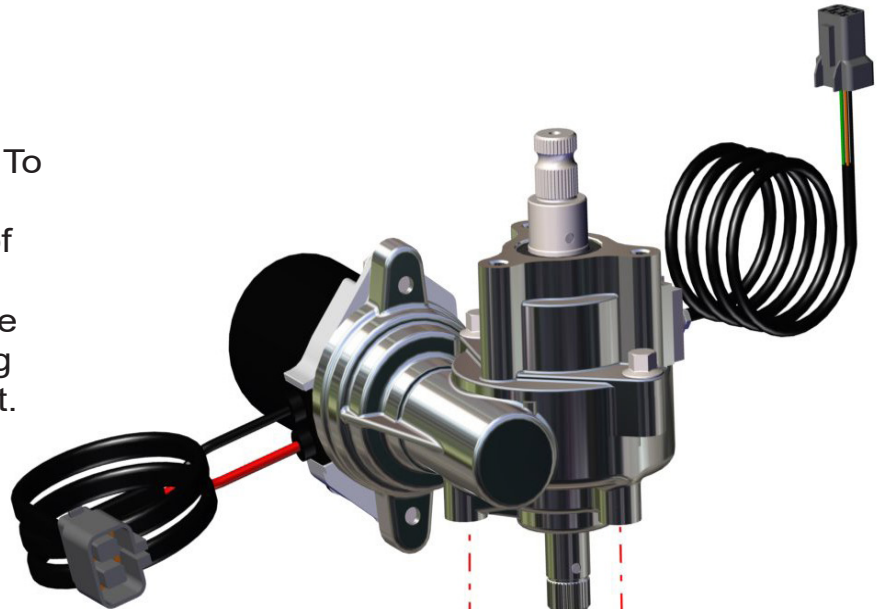

Fig.18

20. Next, before you install the motor, you will need to install the mounting bracket to the steering motor using the hardware provided in your kit. To do this, you will need to put a copper washer on each side of the bracket plate before mounting it to the motor. These Copper washers and mounting screws are provided in your kit. See Fig.21,22 & 23.



Copper Washers  
Must Go On Each  
Side Of Bracket

Fig.21



Secure Bracket To Motor  
With Provided Screws

Copper Washer  
On Each Side Of Plate

Fig.23



Bracket Shown Mounted

Fig.22

21. After the bracket is securely attached to the motor, you can now mount the Steering Motor to the machine. **Fig.24** shows the frame area ready to mount your unit. You will mount your motor to this frame bracket using the hardware provided in your kit. This view is looking down from the open hood in the front of your machine.

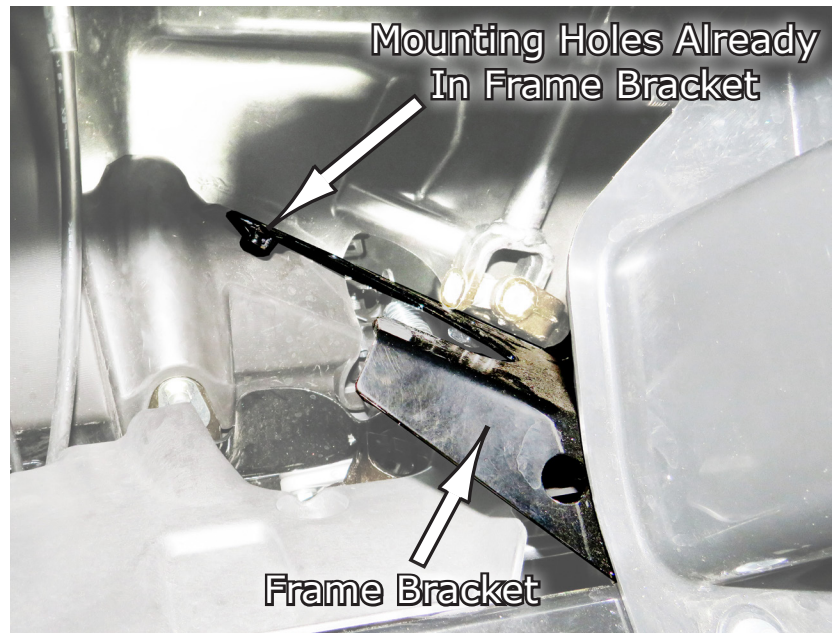

**Fig.24**

22. Now mount the motor unit using the hardware provided in your kit. Notice the position of the motor and which end is up and down etc. Secure the motor tightly to the frame bracket ready to install the steering shafts to the motor that you installed to the steering wheel and lower spline shaft previously. See **Fig.25**.



**Fig.25**

23. **TIP:** When tightening down the screws of the motor to the frame bracket, it may be easier to drop an extension and socket down from the top from inside the cab in front of the steering wheel, as shown in **Fig.26**.



**Fig.26**

24. **Fig.27** Shows the Steering Motor installed.

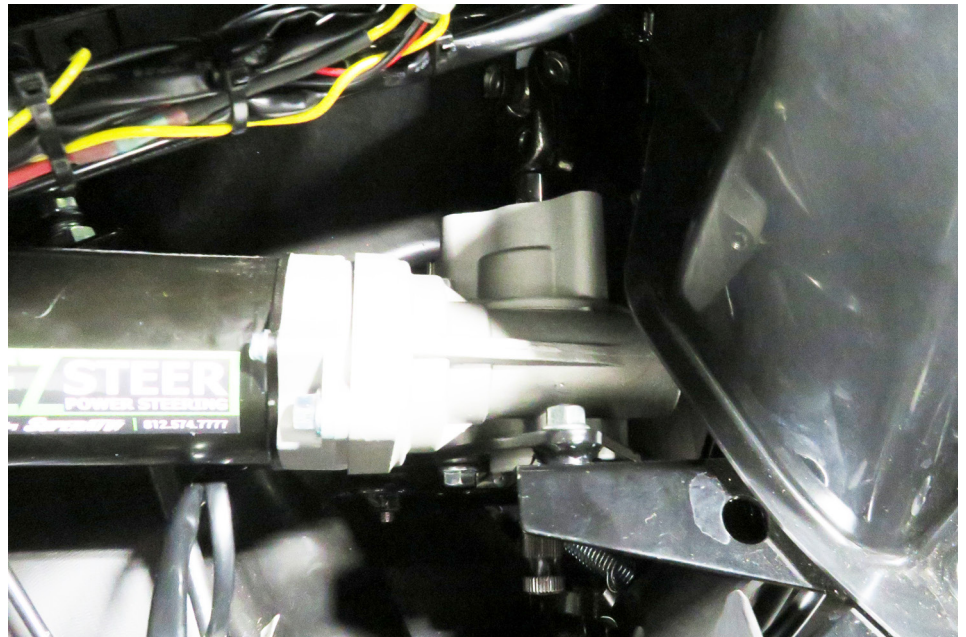

**Fig.27**

25. After the motor is installed, now we will hook up all the power and associated items to get it working. The first thing to do is to mount the "T" bracket or ECU bracket to the Control Unit Box. This is installed using the hardware provided in your kit. **Fig.28** shows the bracket mounded and ready to install.

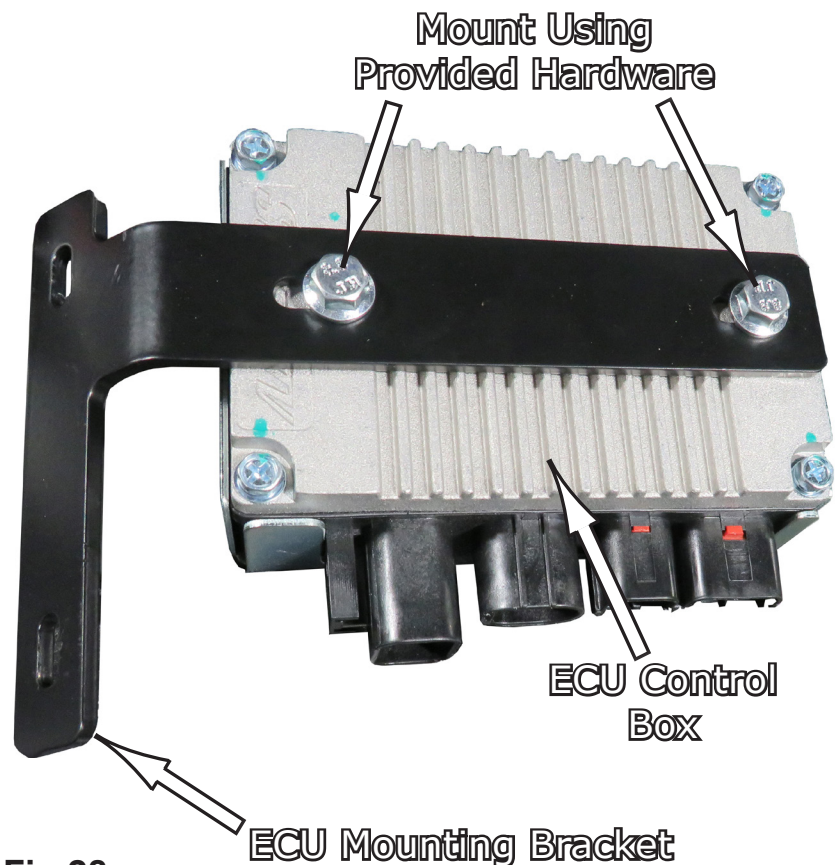
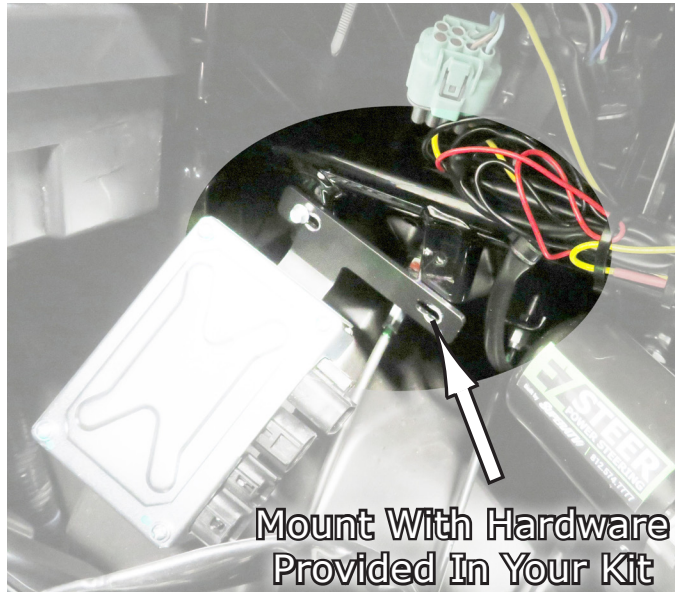

**Fig.28**

ECU Mounting Bracket

ECU Control Box

26. After you've mounted the bracket to the ECU Box, you can now mount it to your machine using the hardware provided in your kit. **Fig.29, 30 & 31** shows the frame mounting location under the hood and after the unit is installed.

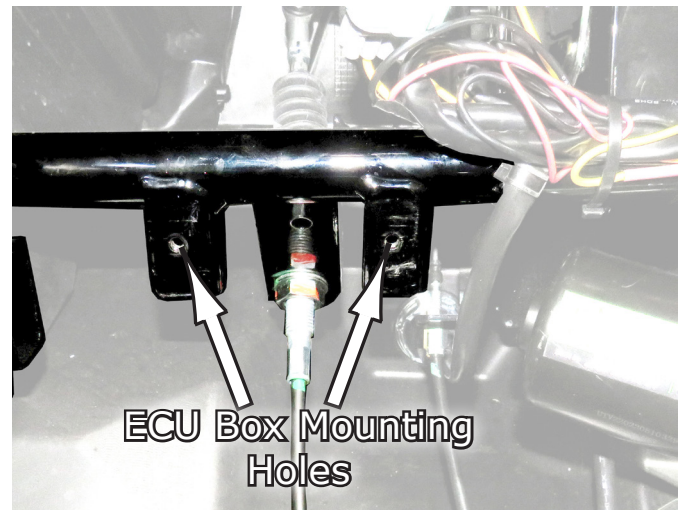

**Fig.30**

27. Once the box is mounted, you can now plug in the harness connectors to the box. Your box connections should look like the pics below in **Fig's.32 & 33**.



**Fig.32**



**Fig.29**

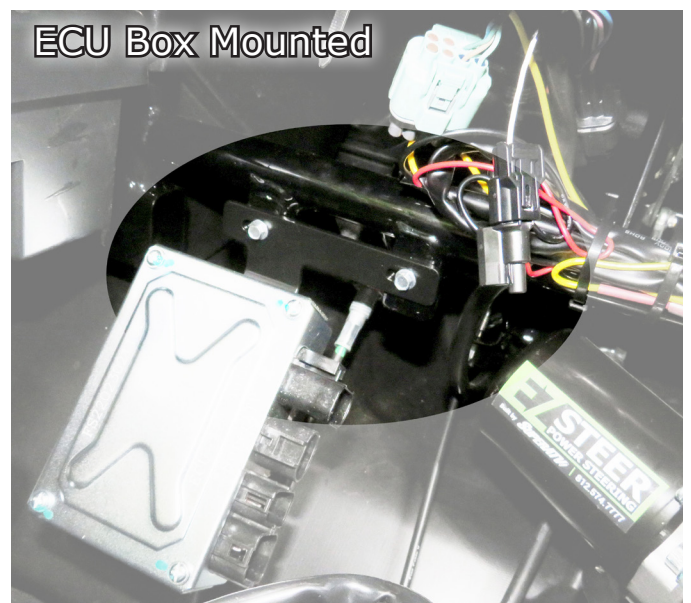

**Fig.31**

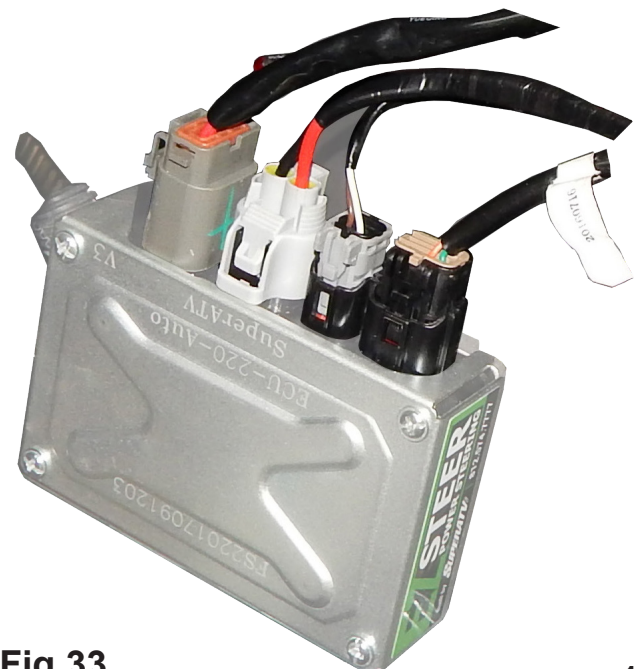

**Fig.33**

28. After you've plugged the connectors into the ECU, find the White wire from your new harness, and find the white wire from the Factory Harness. With using the Scotch Lock Splice connector, splice both white wires together. This is the Switched Power from your ignition so that your steering only comes on when the key is in the on position. So only splice White to White as shown in Fig.34.

29. Now you will take the rest of the ECU Harness and route it out the fender well to the back of the vehicle to hook up the power. Fig.35 shows where to feed the harness out of that compartment area.

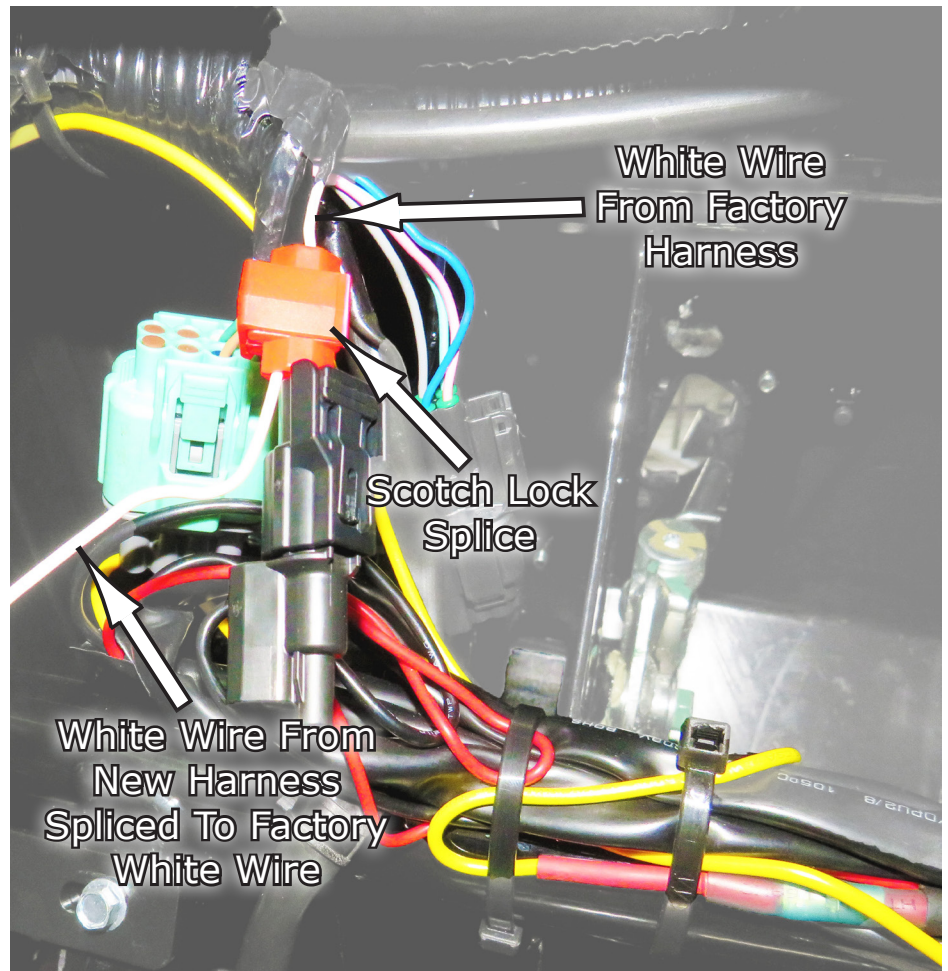

Fig.34

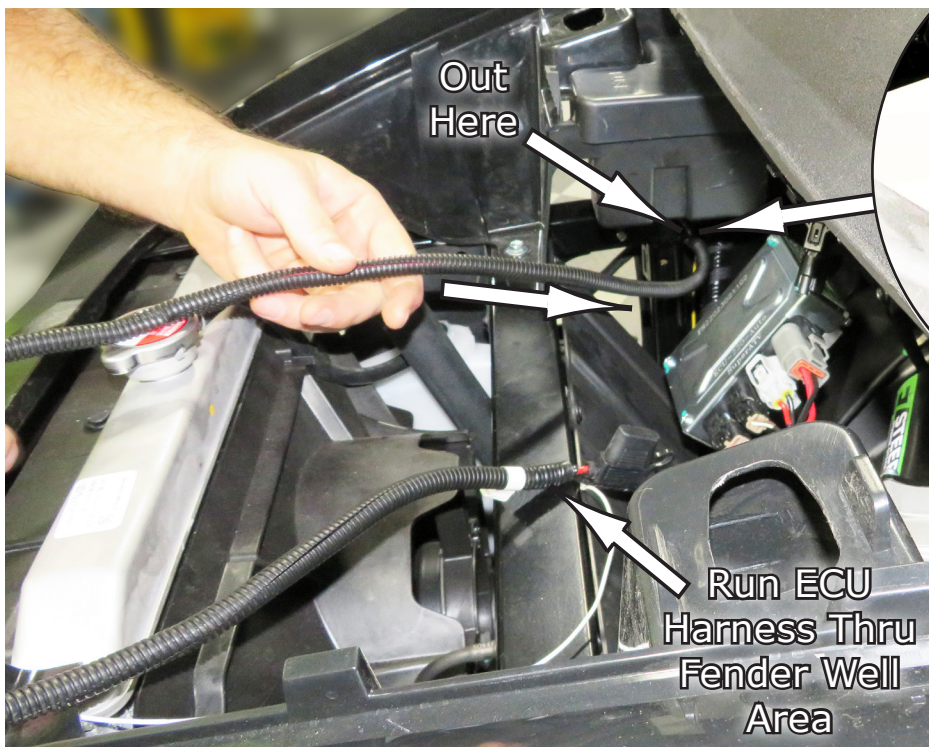
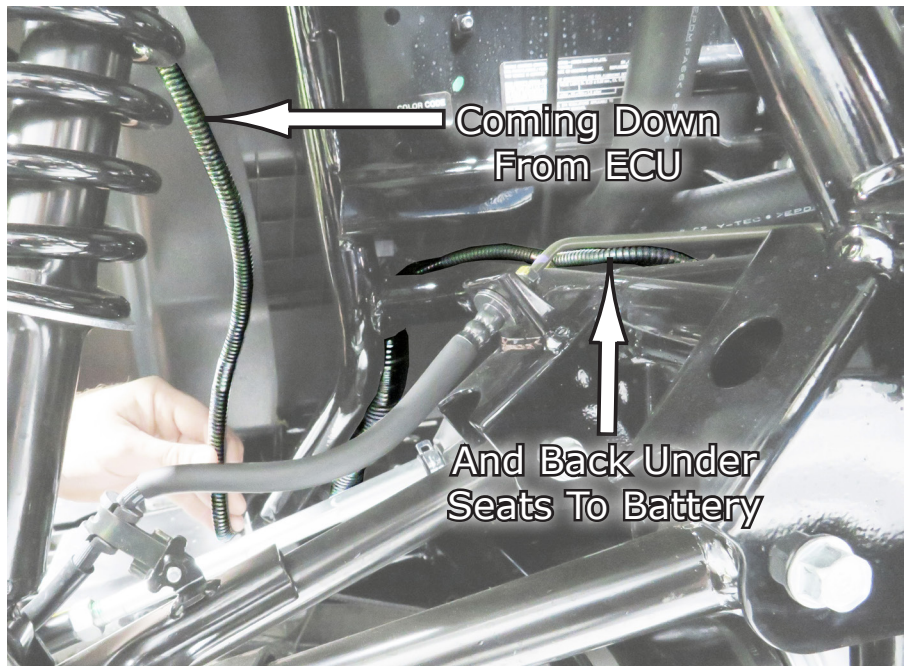

Fig.35

30. **Fig.36** shows the Harness coming down (from **Fig.35**), and routing to the battery via under the seat area.



31. After you feed the harness down and back under the Seat/Center Console routing to the Battery, you then bring it into the Battery compartment and hook up the remaining Red & Black wires to the Battery as shown in **Fig.37**.

**Fig.36**

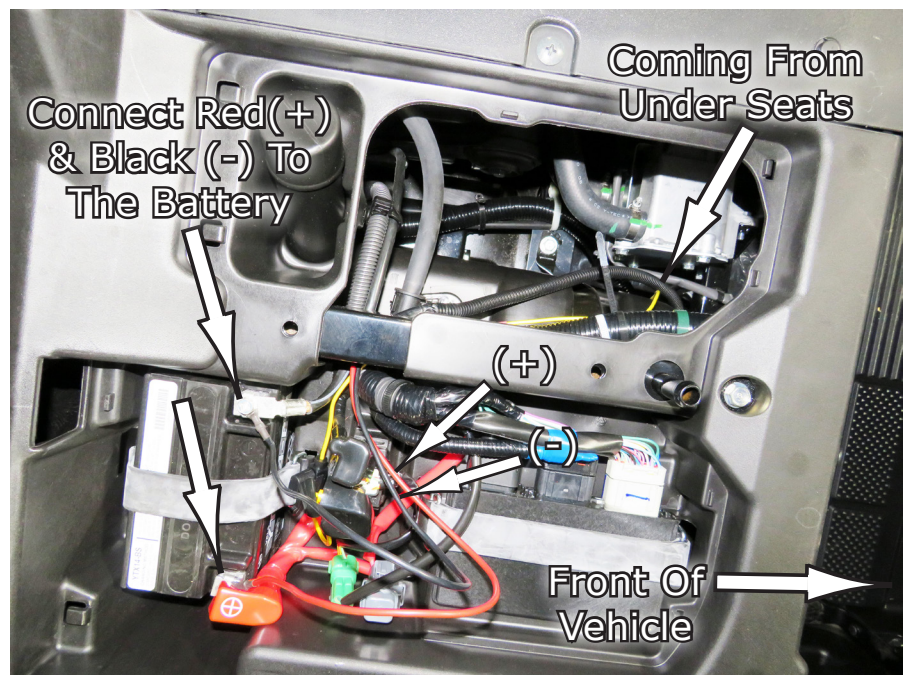

Once the battery is hooked up and all Harness cables are securely Zip-Tied away from rubbing, heat or moving parts, you can now start the vehicle and try out your new Power Steering!





#### Liability Statement

SuperATV's® products are designed to best fit user's ATV/UTV under stock conditions. Adding, modifying, or fabricating any factory or aftermarket parts will void any warranty provided by SuperATV® and is not recommended. SuperATV's® products could interfere with other aftermarket accessories. If user has aftermarket products on machine, contact SuperATV® to verify that they will work together.

Although SuperATV® has thousands of satisfied customers, user should be aware that installing lift kits, long travel, or suspension kits, tires, etc. will change the ride of machine and may increase maintenance and part wear. Operating any off-road machine while, or after, consuming alcohol and/or drugs increases risk of bodily harm or death. No warranty or representation is made as to this product's ability to protect user from severe injury or death. SuperATV® urges operators and occupants to wear a helmet and appropriate riding gear at all times.

By purchasing and installing SuperATV® products, user agrees that should damages occur, SuperATV® will not be held responsible for loss of time, use, labor fees, replacement parts, or freight charges. SuperATV®, nor any 3rd party, will not be held responsible for any direct, indirect, incidental, special, or consequential damages that result from any product purchased from SuperATV®. The total liability of seller to user for all damages, losses, and causes of action, if any, shall not exceed the total purchase price paid for the product that gave rise to the claim.

SuperATV® will warranty only parts provided by SuperATV®. Any damage or problems with OEM housings, bearings, seals, or other manufacturers' products will not be covered by SuperATV®. SuperATV® parts and products are not warranted if item was not installed properly, misused, or modified.

Installing, adding, modifying, or fabricating any factory or aftermarket product to your ATV/UTV may violate certain local, state, and federal laws. Be advised that laws vary depending on town, city, county, state, etc. Use of certain products on public streets, roads, or highways may be in violation law. The Buyer is solely and exclusively legally and personally responsible for any violation of the law by the installation or use of the product. You must abide by all local, state, and federal laws, including but not limited to vehicle safety, traffic laws, and ordinances. It is your responsibility to know the laws and how they apply to you.

The Buyer is responsible to fully understand the capability and limitations of his/her vehicle according to manufacturer specifications, warnings and instructions and agrees to hold SuperATV® harmless from any damage resulting from failure to adhere to such specifications, warnings and/ or instructions. The Buyer is also responsible to obey all applicable federal, state, and local laws and ordinances when operating his/her vehicle while using this product, and the Buyer agrees to hold SuperATV® harmless from any violation thereof.



If you have any problems/questions on this kit, contact us by email at [Superatv.com](mailto:sales@superatv.com).

#### Need help with your installation?



[sales@superatv.com](mailto:sales@superatv.com)



[www.superatv.com](http://www.superatv.com)



1-855-743-3427



8:00am - 9:00pm EST M-Th  
8:00am - 7:00pm EST Friday  
9:00am - 2:00pm EST Saturday

*Thank You  
For Choosing*



**Like SuperATV on Facebook to keep up to date on new products!**