



Need help with your installation?



sales@superatv.com



www.superatv.com



1-855-743-3427



8:00am - 9:00pm EST M-Th
8:00am - 7:00pm EST Friday
9:00am - 2:00pm EST Saturday

Read instructions and view illustrations before beginning.

Thank You

For Choosing

SUPERATV.COM[®]

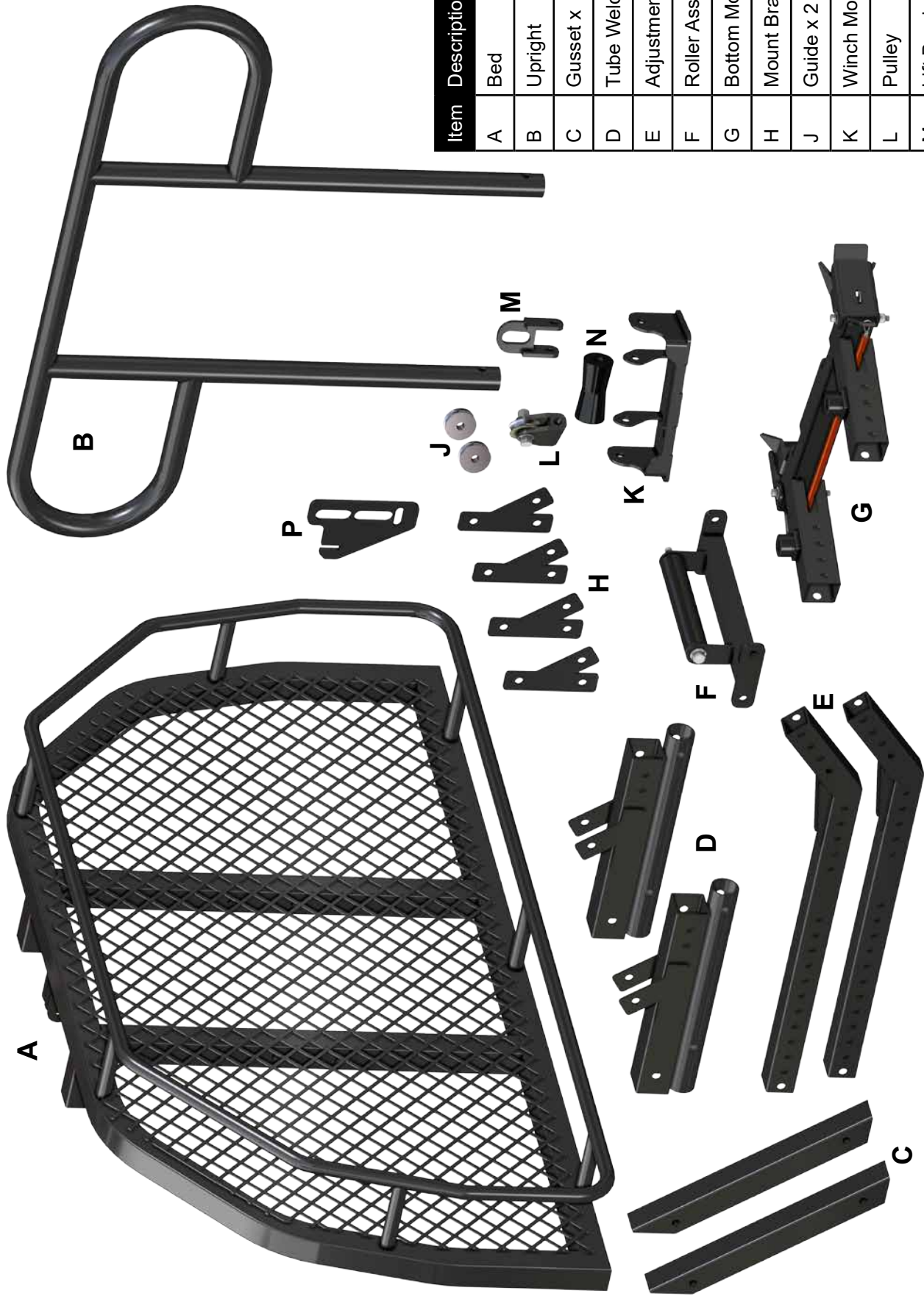

Item	Description
A	Bed
B	Upright
C	Gusset x 2
D	Tube Weldment x 2
E	Adjustment Tube x 2
F	Roller Assembly
G	Bottom Mount
H	Mount Bracket x 4
J	Guide x 2
K	Winch Mount Bracket
L	Pulley
M	Lift Bracket
N	Winch Mount Roller
P	Lock

(kit contents continued)

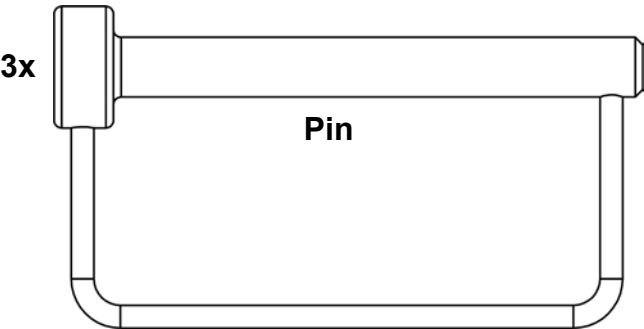
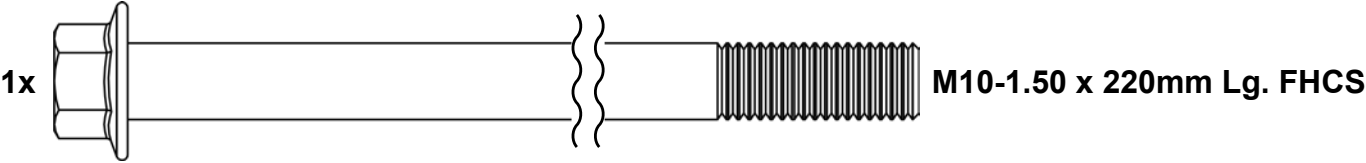
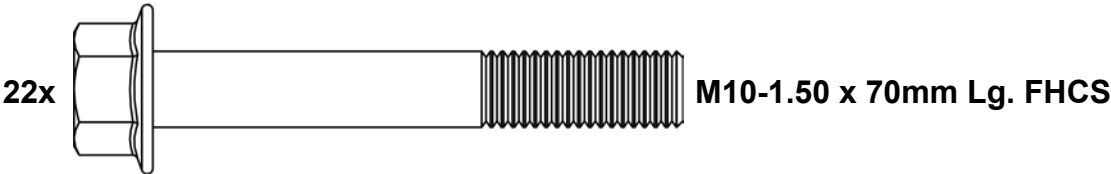
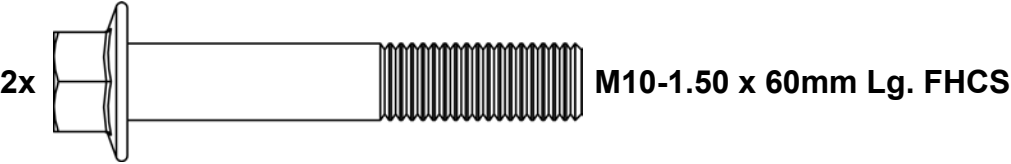
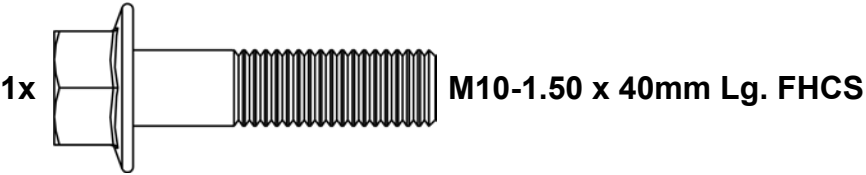

Do not tighten any hardware completely when assembling components.

Liability Statement
SuperATV's® products are designed to best fit user's ATV/UTV under stock conditions. Adding, modifying, or fabricating any factory or aftermarket parts will void any warranty provided by SuperATV® and is not recommended. SuperATV's® products could interfere with other aftermarket accessories. If user has aftermarket products on machine, contact SuperATV® to verify that they will work together.

Although SuperATV® has thousands of satisfied customers, user should be aware that installing lift kits, long travel, or suspension kits, tires, etc. will change the ride of machine and may increase maintenance and part wear. Operating any off-road machine while, or after, consuming alcohol and/or drugs increases risk of bodily harm or death. No warranty or representation is made as to this product's ability to protect user from severe injury or death. SuperATV® urges operators and occupants to wear a helmet and appropriate riding gear at all times.

By purchasing and installing SuperATV® products, user agrees that should damages occur, SuperATV® will not be held responsible for loss of time, use, labor fees, replacement parts, or freight charges. SuperATV®, nor any 3rd party, will not be held responsible for any direct, indirect, incidental, special, or consequential damages that result from any product purchased from SuperATV®. The total liability of seller to user for all damages, losses, and causes of action, if any, shall not exceed the total purchase price paid for the product that gave rise to the claim.

SuperATV® will warranty only parts provided by SuperATV®. Any damage or problems with OEM housings, bearings, seals, or other manufacturers' products will not be covered by SuperATV®. SuperATV® parts and products are not warranted if item was not installed properly, misused, or modified.

Installing, adding, modifying, or fabricating any factory or aftermarket product to your ATV/UTV may violate certain local, state, and federal laws. Be advised that laws vary depending on town, city, county, state, etc. Use of certain products on public streets, roads, or highways may be in violation law. The Buyer is solely and exclusively legally and personally responsible for any violation of the law by the installation or use of the product. You must abide by all local, state, and federal laws, including but not limited to vehicle safety, traffic laws, and ordinances. It is your responsibility to know the laws and how they apply to you.

The Buyer is responsible to fully understand the capability and limitations of his/her vehicle according to manufacturer specifications, warnings and instructions and agrees to hold SuperATV® harmless from any damage resulting from failure to adhere to such specifications, warnings and/ or instructions. The Buyer is also responsible to obey all applicable federal, state, and local laws and ordinances when operating his/her vehicle while using this product, and the Buyer agrees to hold SuperATV® harmless from any violation thereof.

- Install Adjustment Tube (E) and Gusset (C) to Tube Weldment (D) with hardware shown.
- Repeat for opposite side.

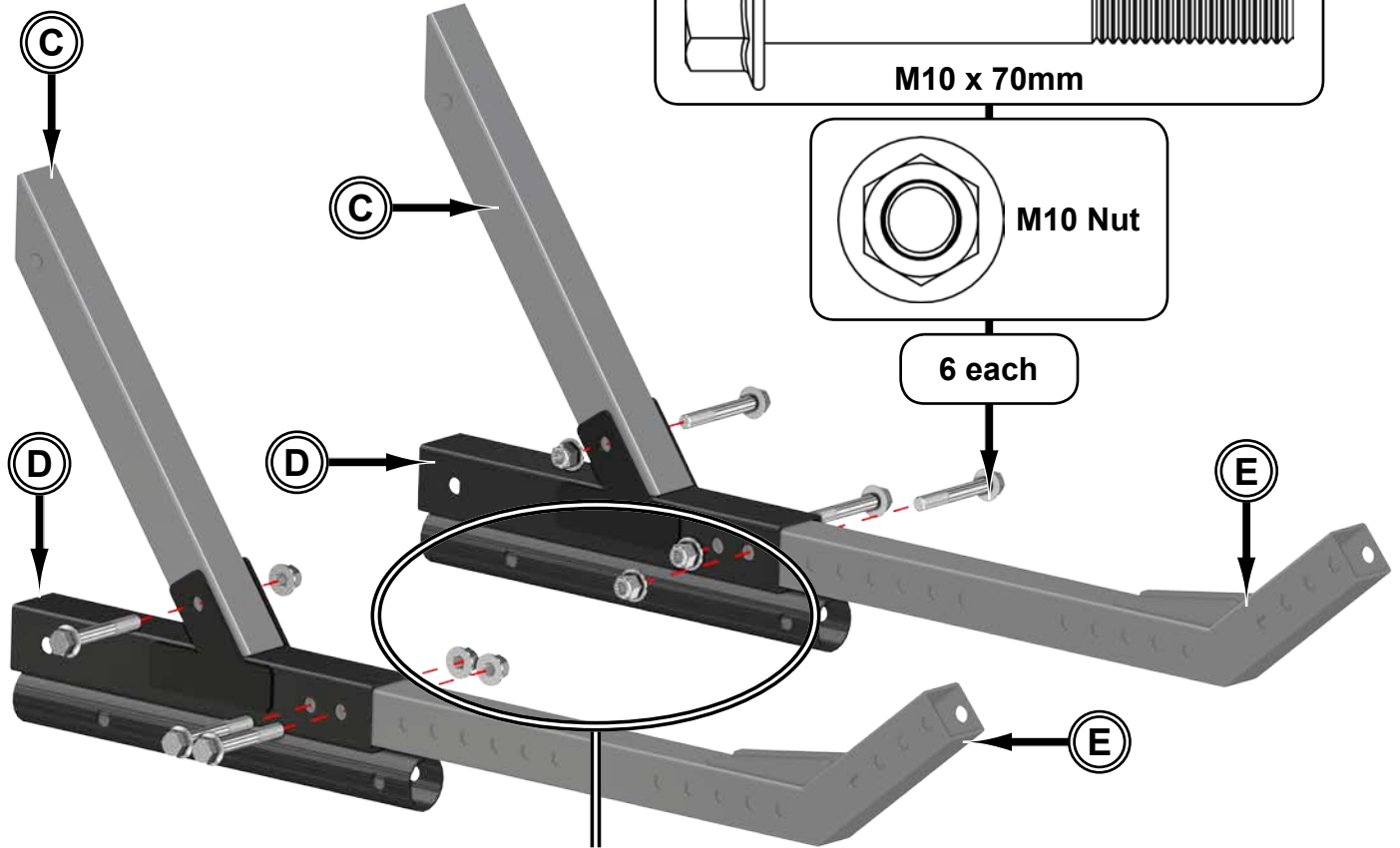

Leave Nuts loose; adjustments may be required.

- Join Roller Assembly (F) and Adjustment Tubes (E) with hardware shown.

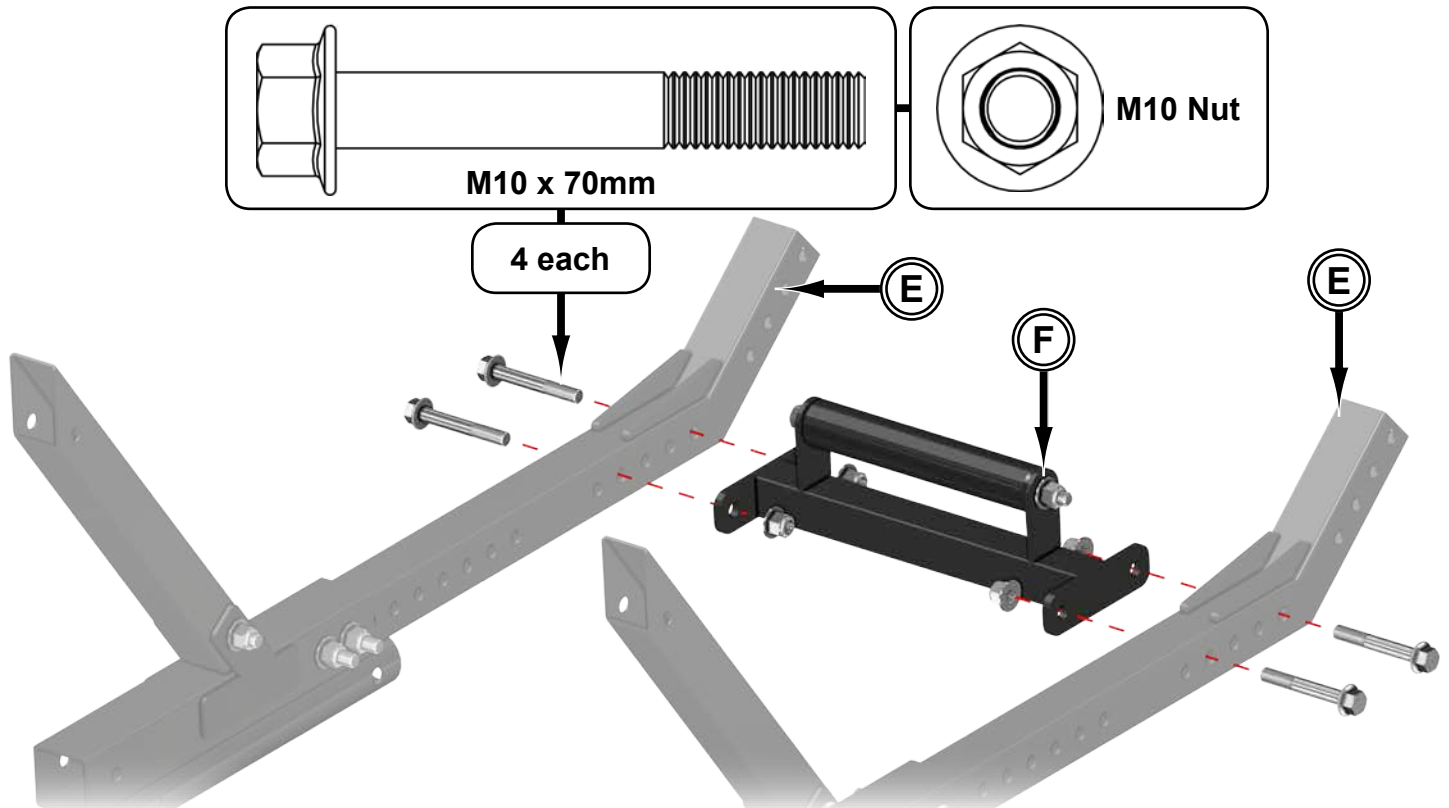

- Install Bottom Mount (G), Lock (P), and Adjustment Tubes (E) with hardware shown.

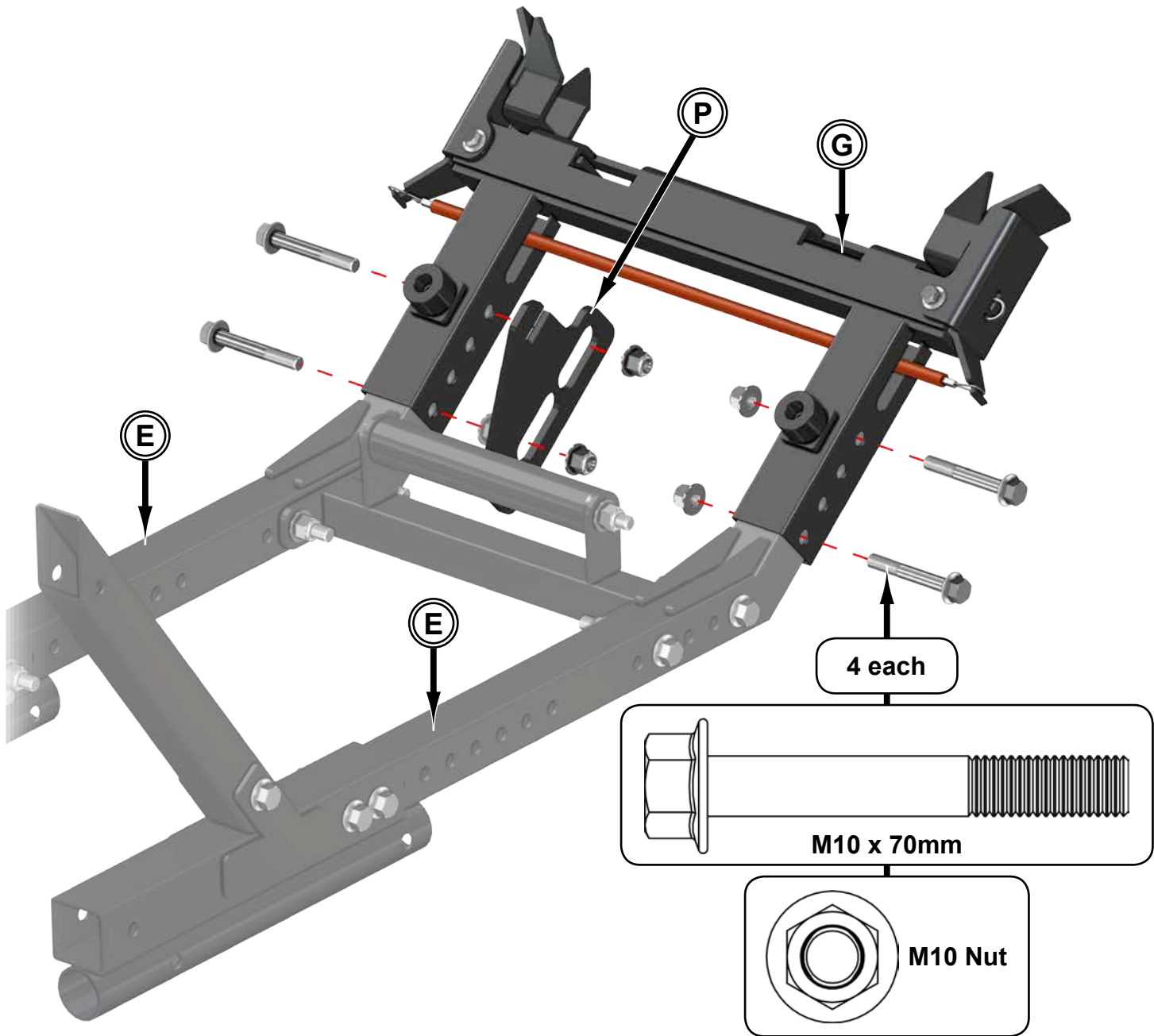

Leave Nuts loose; adjustments may be required.

- Install Bed (A) to Adjustment Tubes (E) with hardware shown.

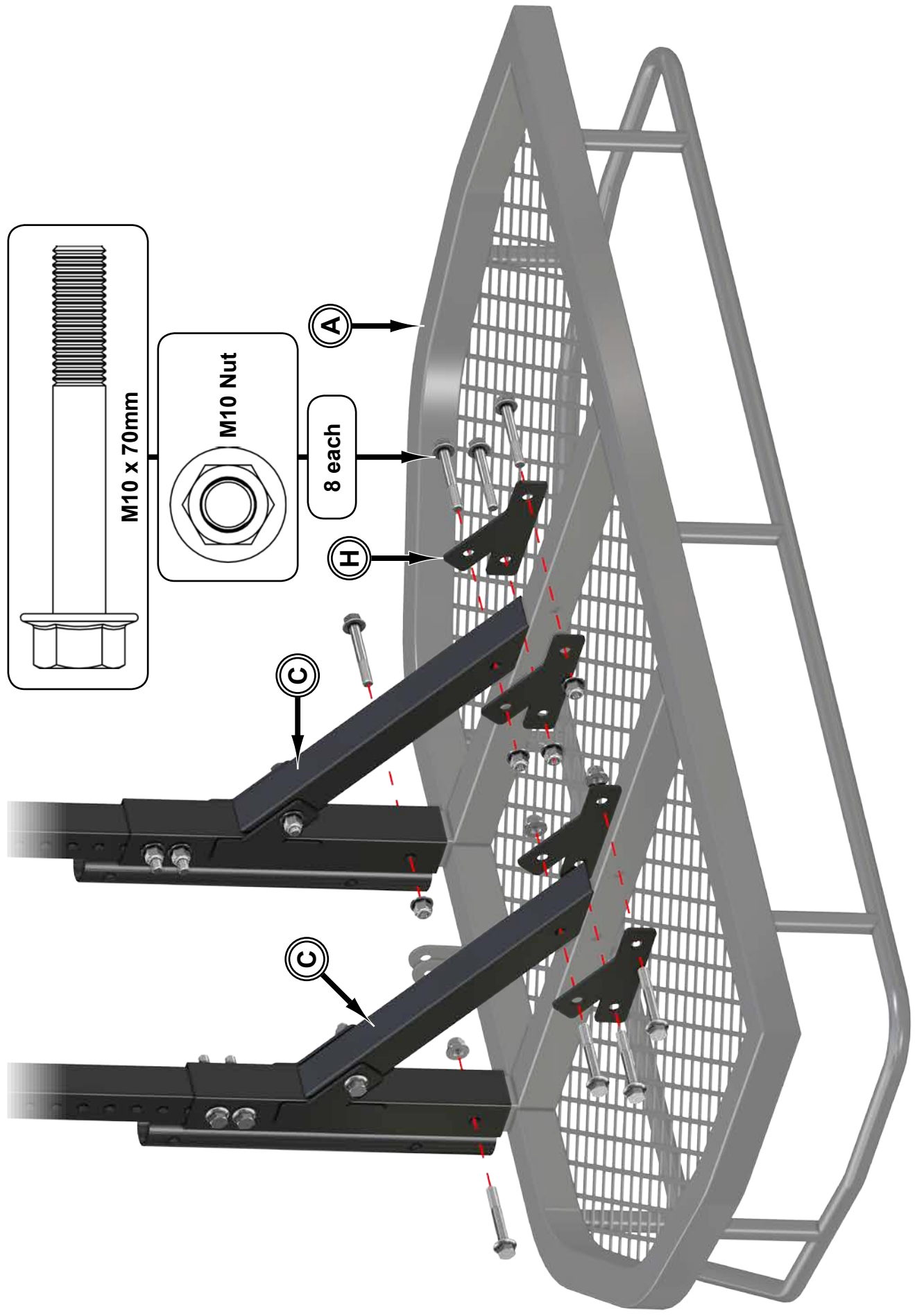

- Insert Upright (B) into Tube Weldments (D). Secure with provided Pins.
- Install Guides (J) to Bed (A) with hardware shown. Tighten hardware completely.

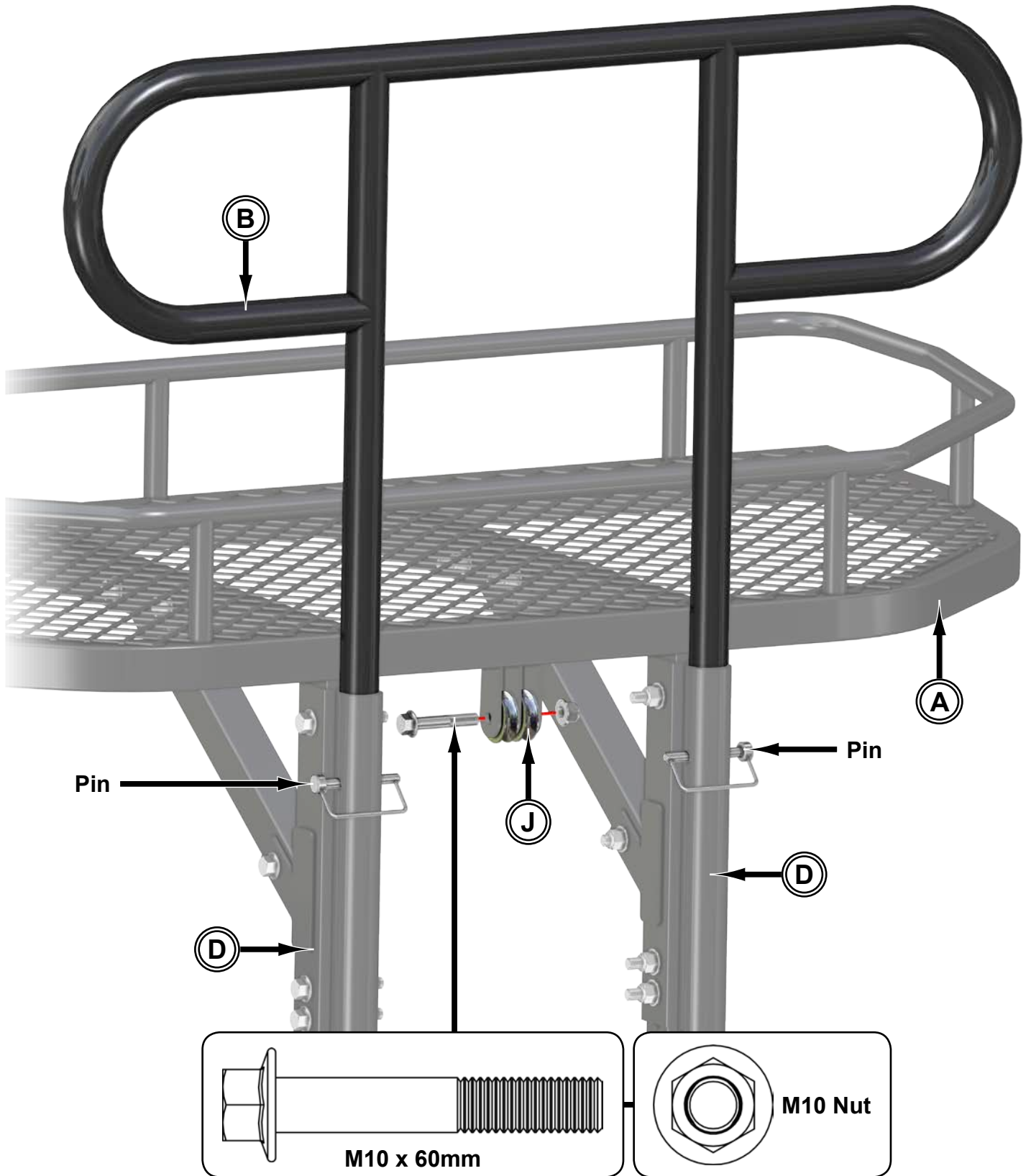



- Install Winch Mount Bracket (K) to Bumper with hardware shown. Tighten hardware completely.

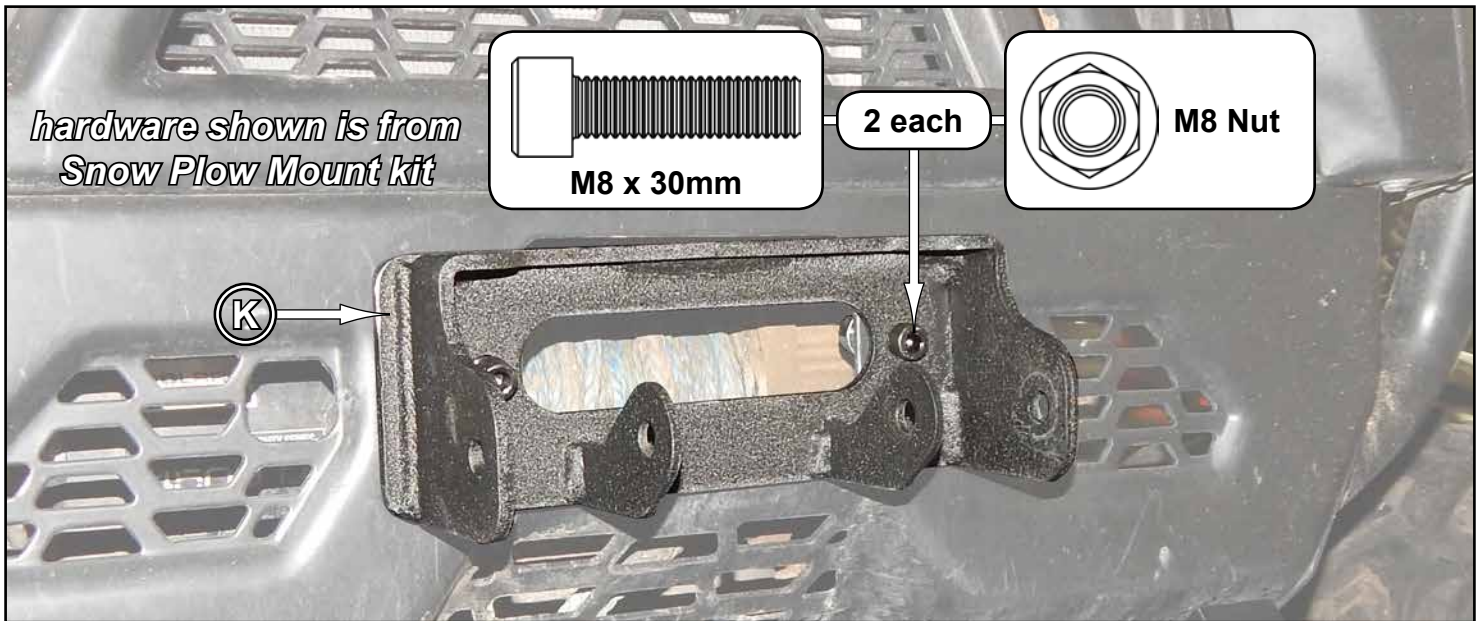

- Install Lift Bracket (M), Winch Mount Roller (N), and Pulley (L) to Winch Mount Bracket (K) with hardware shown. Tighten hardware completely.

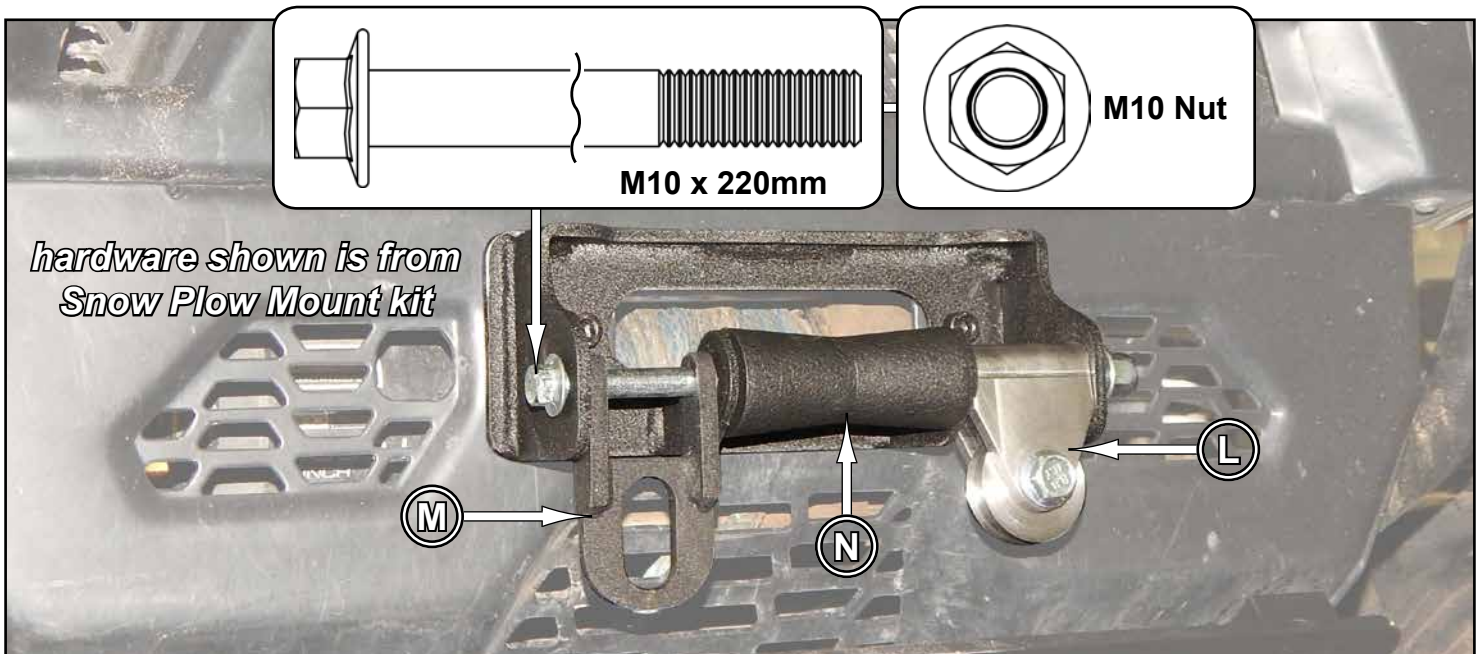

Snow Plow Mount

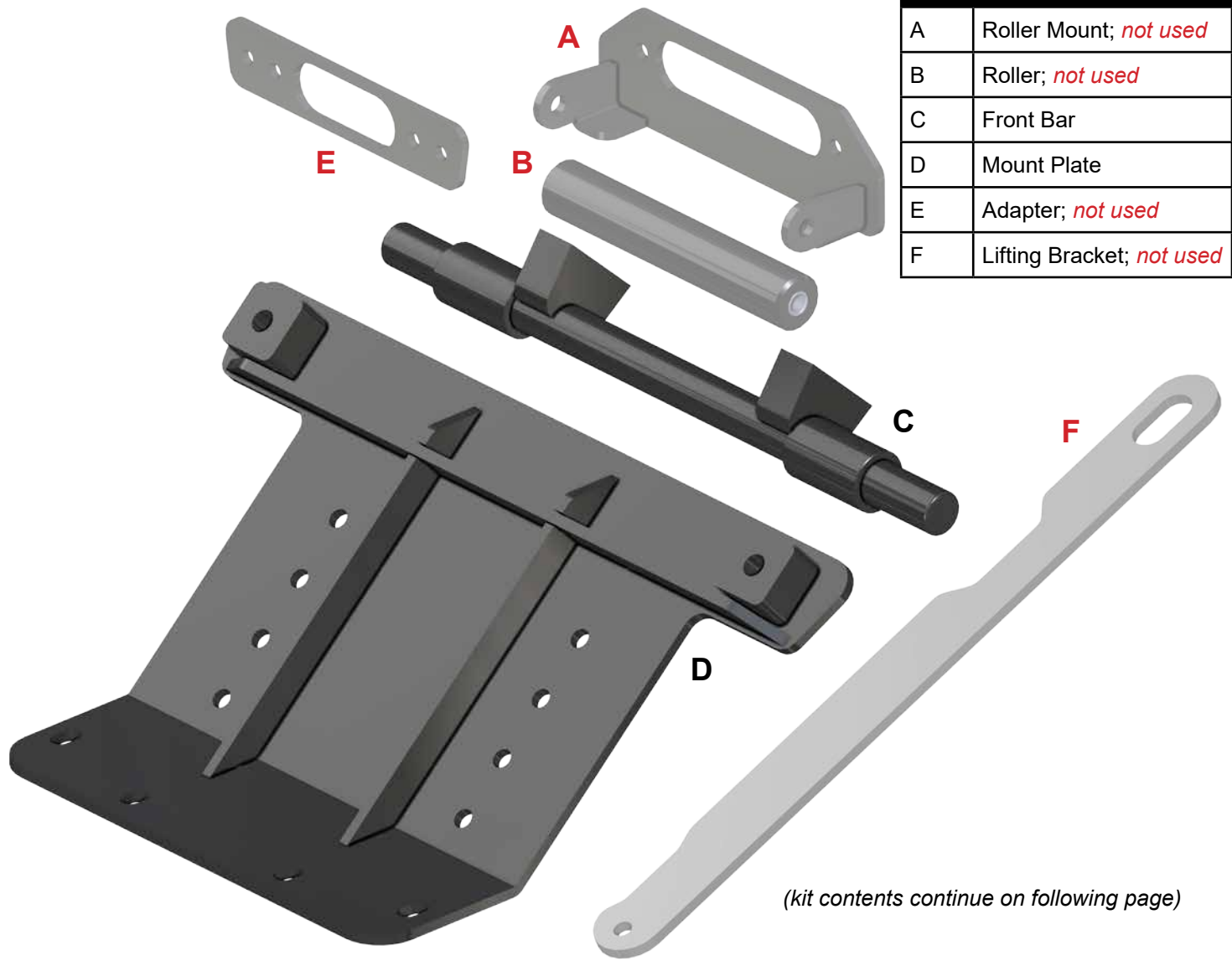

Item	Description
A	Roller Mount; <i>not used</i>
B	Roller; <i>not used</i>
C	Front Bar
D	Mount Plate
E	Adapter; <i>not used</i>
F	Lifting Bracket; <i>not used</i>

(kit contents continue on following page)

(kit contents continued)

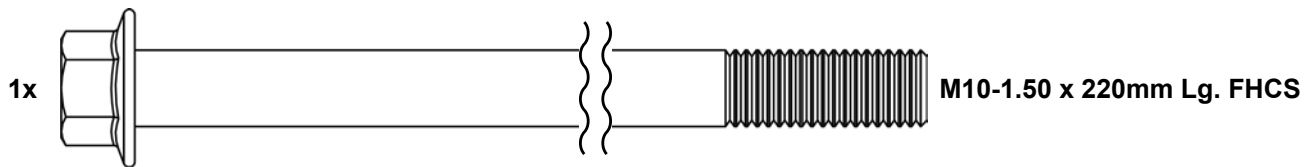
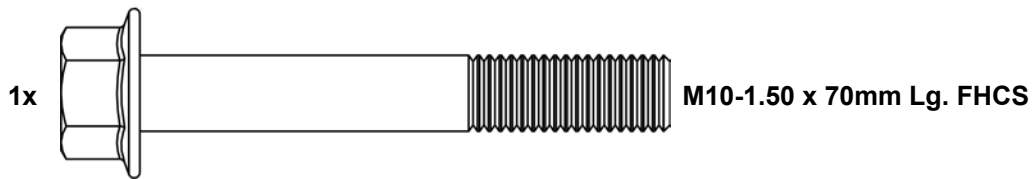
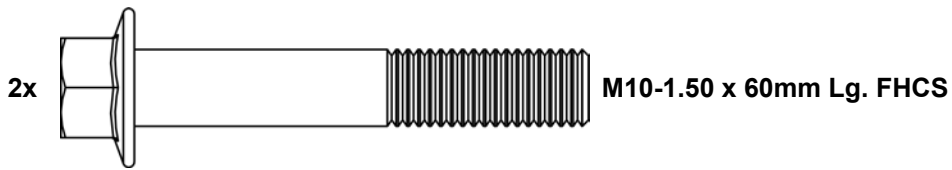
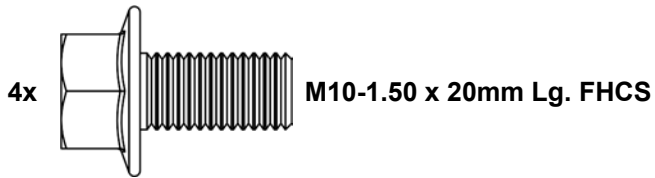

discard any remaining hardware

Do not tighten hardware completely unless noted.

- Install Front Bar (C) to Mount Plate (D) with hardware shown.
- **FRONT BAR (C) MUST BE INSTALLED AS SHOWN.**

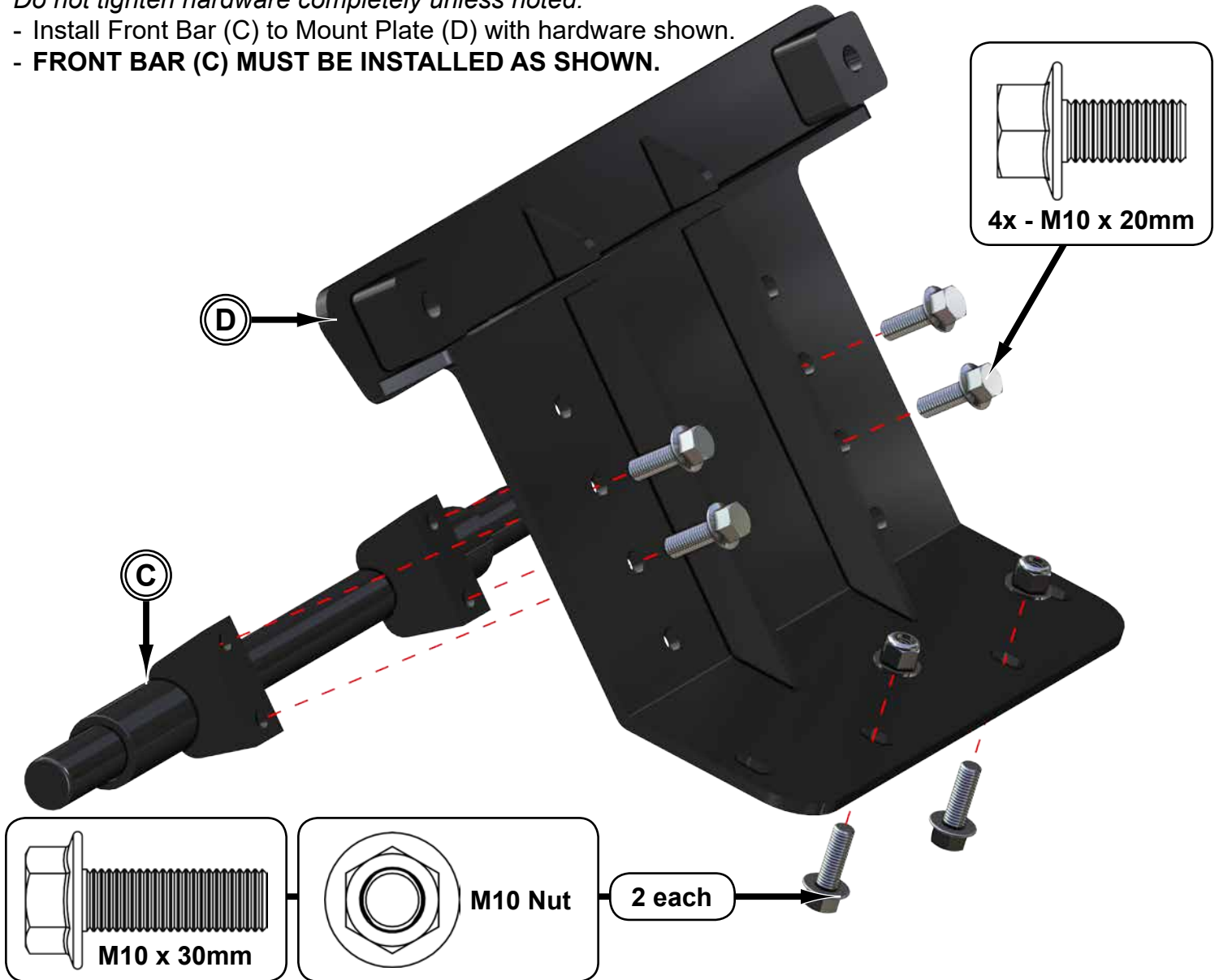

- Secure lower section of Mount Plate (D) to bottom of machine with hardware shown.
- **Ranger 570 models see page 13.**



- Secure upper section of Mount Plate (C) with hardware shown. *Ranger 570 models see page 13.*

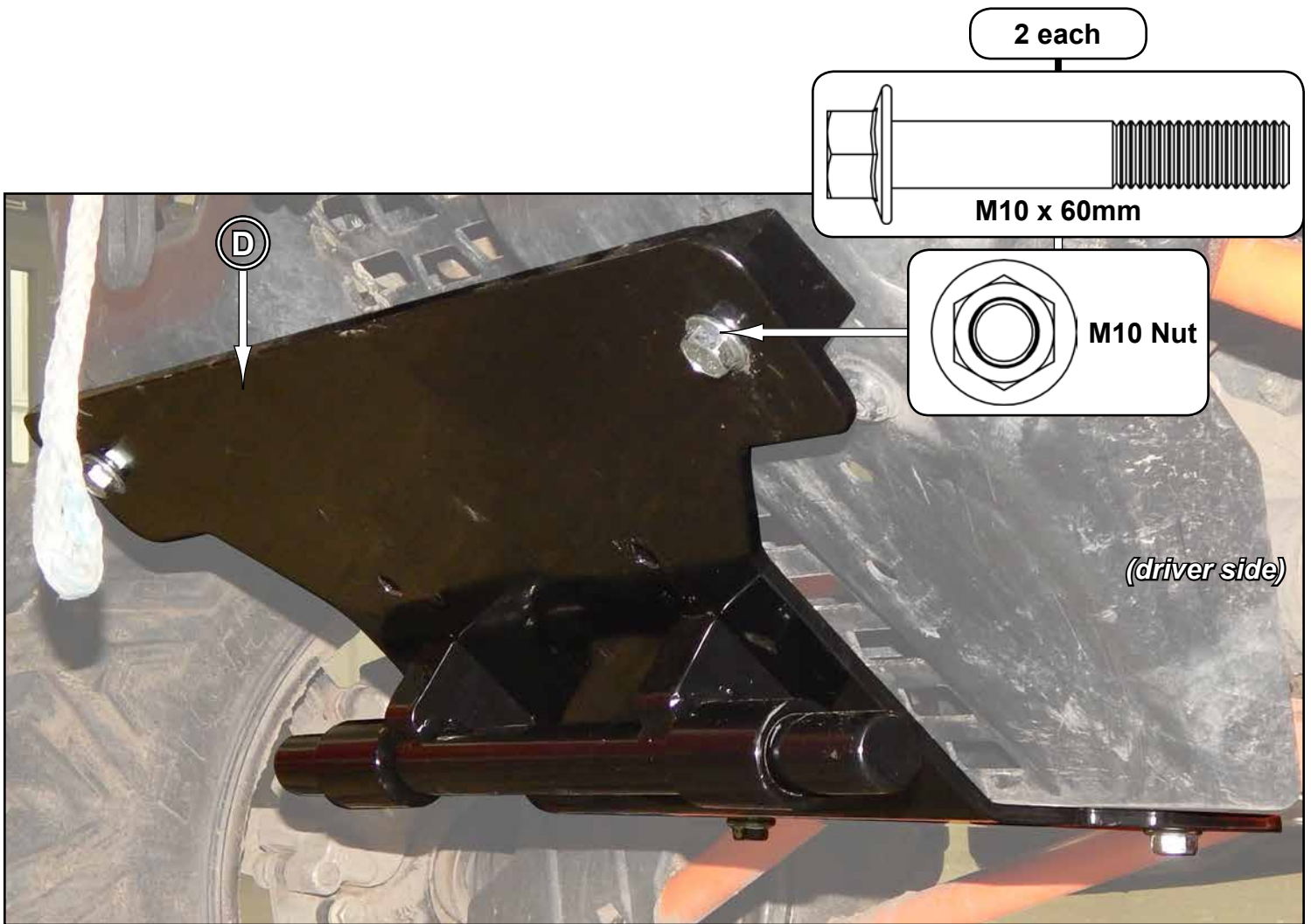

Tighten hardware completely.

Polaris Ranger® 570 install

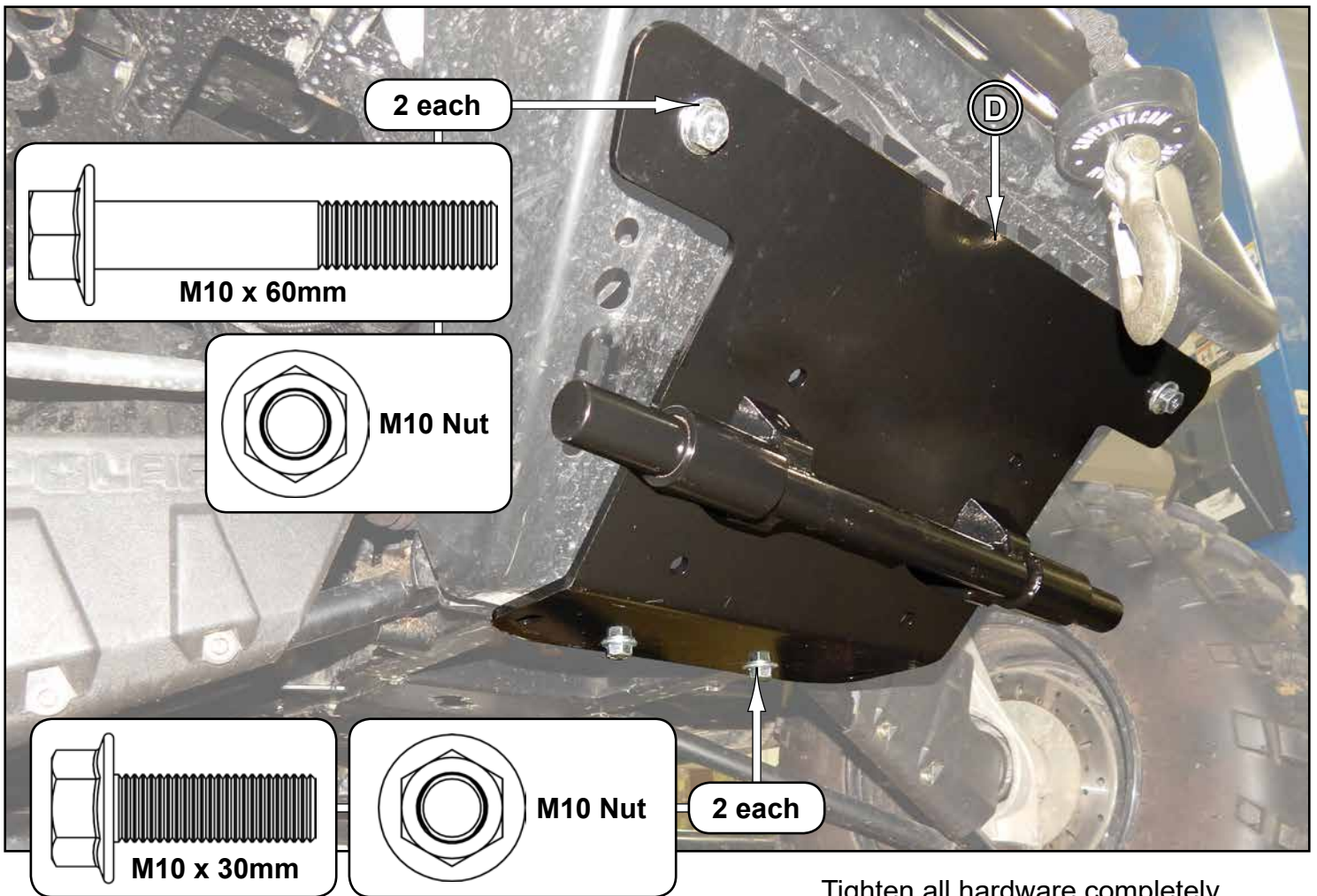

Tighten all hardware completely.

- Install Deer Lift to Snow Plow Mount.

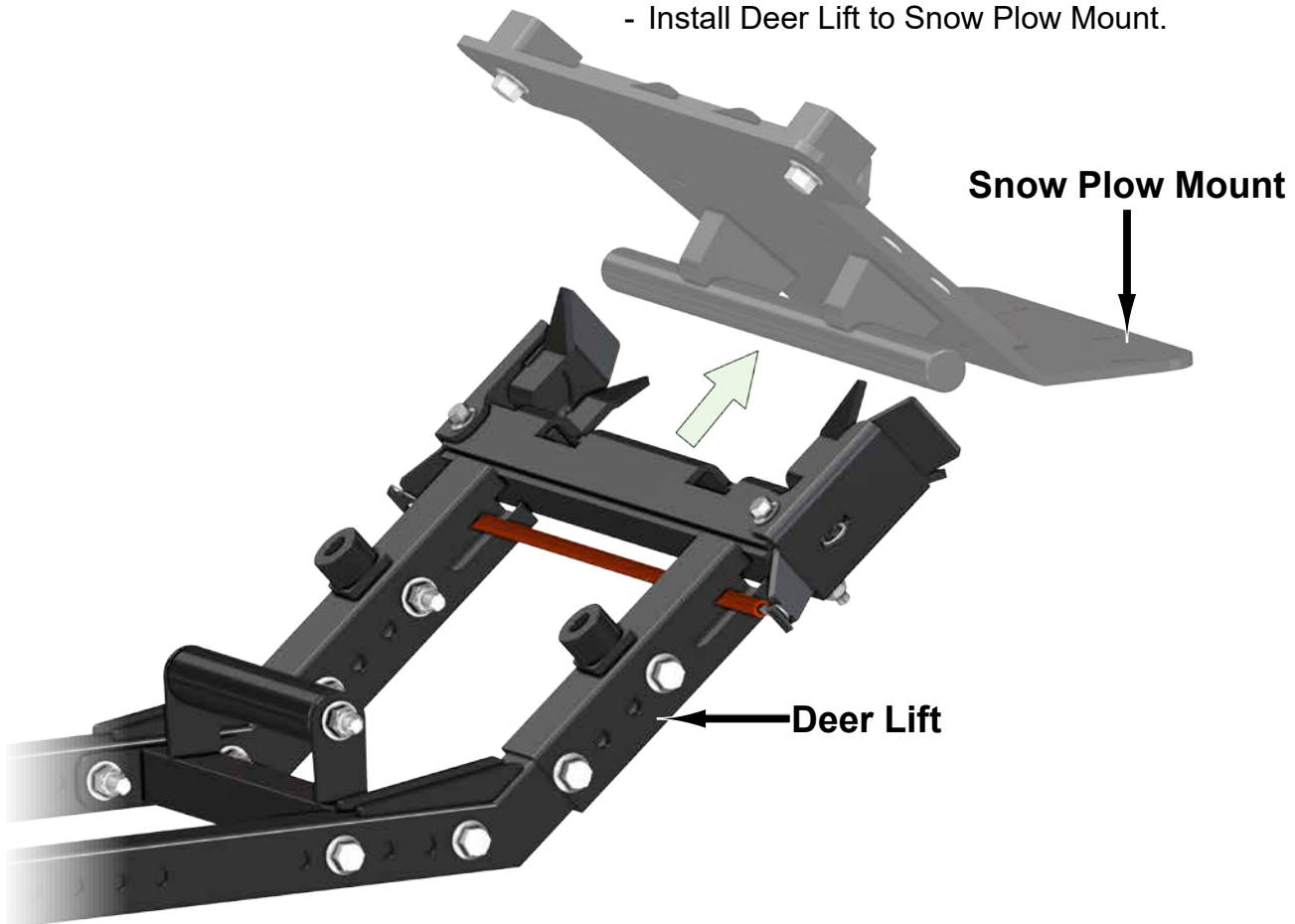

Route Winch Rope as shown:

- Clevis Hook and Pin must be removed.
- Reinstall after routing.

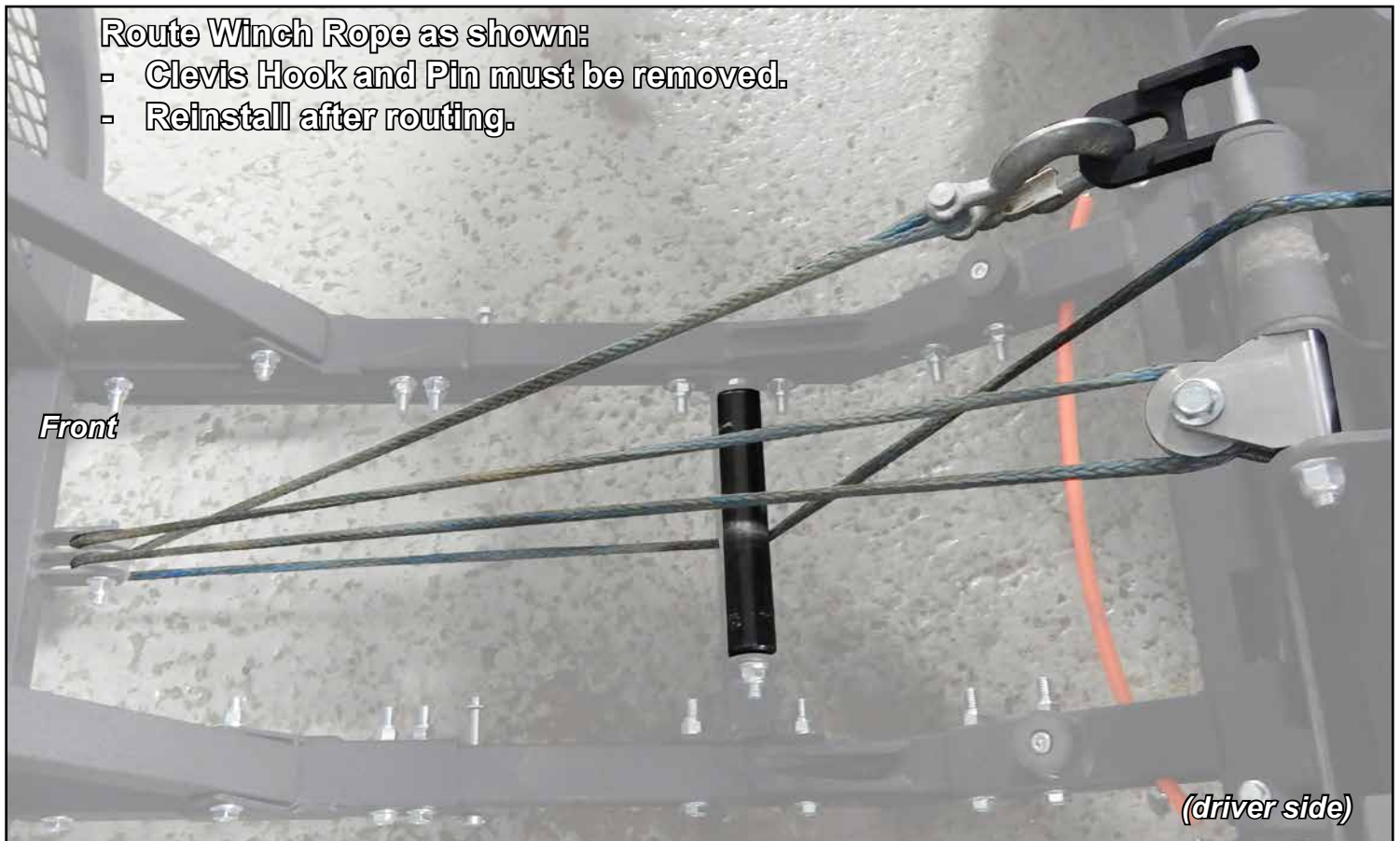

- Deer Lift should be in position shown after lifting.
- Make adjustments at locations shown until Deer Lift is in position shown.
- Tighten all hardware completely.

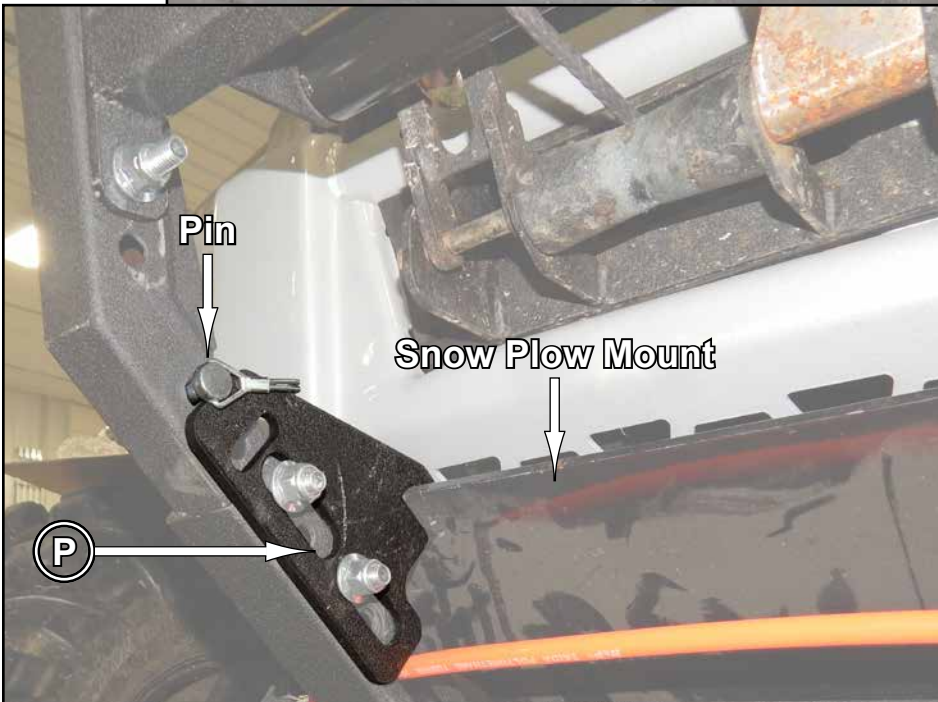

- Remove Pin and engage Lock; reinstall Pin.