

*Components may be installed in locations other than where shown.
 Always verify wire harness length.*



Horn Kit

(Bracket not used)



Hazard Light Switch



Horn Switch



Turn Signal Switch

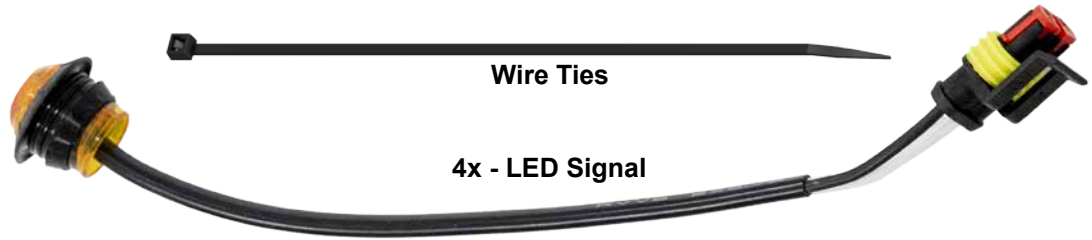

Wire Ties

4x - LED Signal



Control Box Bracket

Need help with your installation?

✉ sales@superatv.com 🖥 www.superatv.com

☎ 1-855-743-3427 🕒 8:00am - 9:00pm EST M-Th
 8:00am - 7:00pm EST Friday
 9:00am - 2:00pm EST Saturday

Read instructions and view illustrations before beginning.

*Thank You
 For Choosing*
SUPERATV.COM[®]

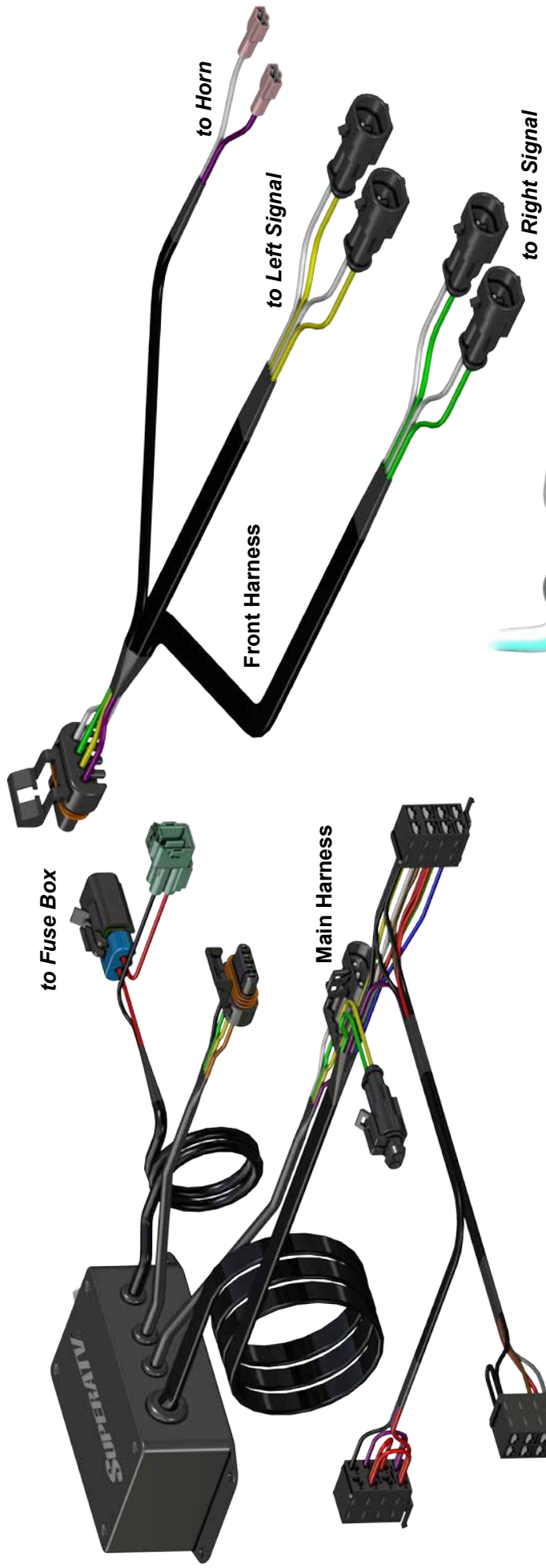

Always consult labels on Wiring Harnesses when making connections.



use provided dielectric grease on all connections

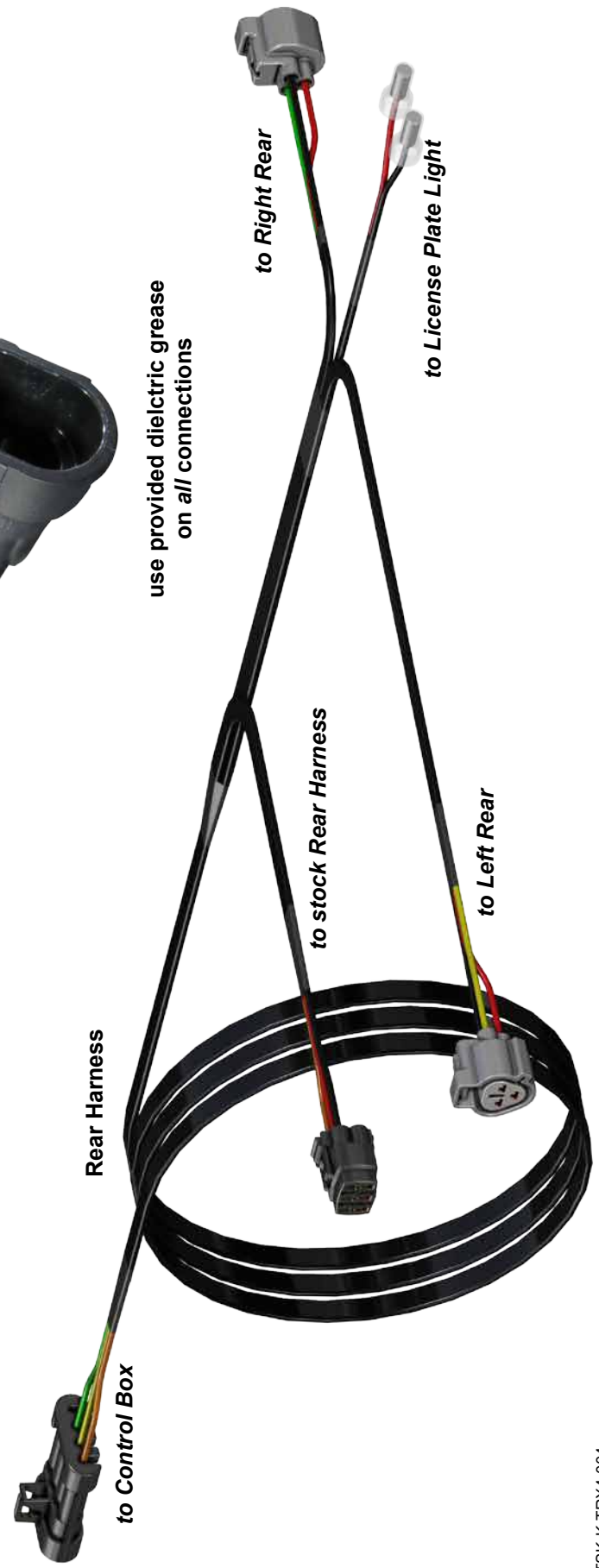



- Use hardware shown and secure Control Box and Horn to Bracket.

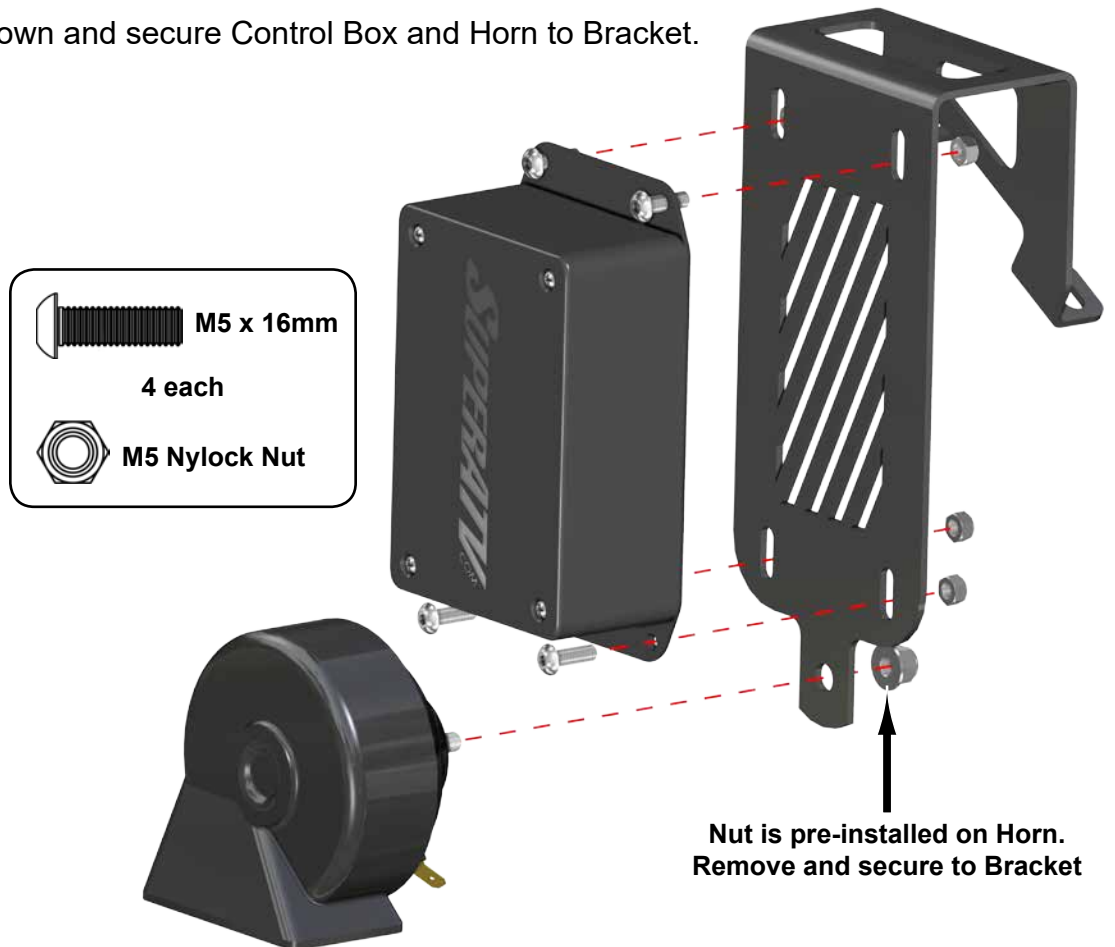

- Install Bracket to location shown.
- Remove stock hardware and use provided.

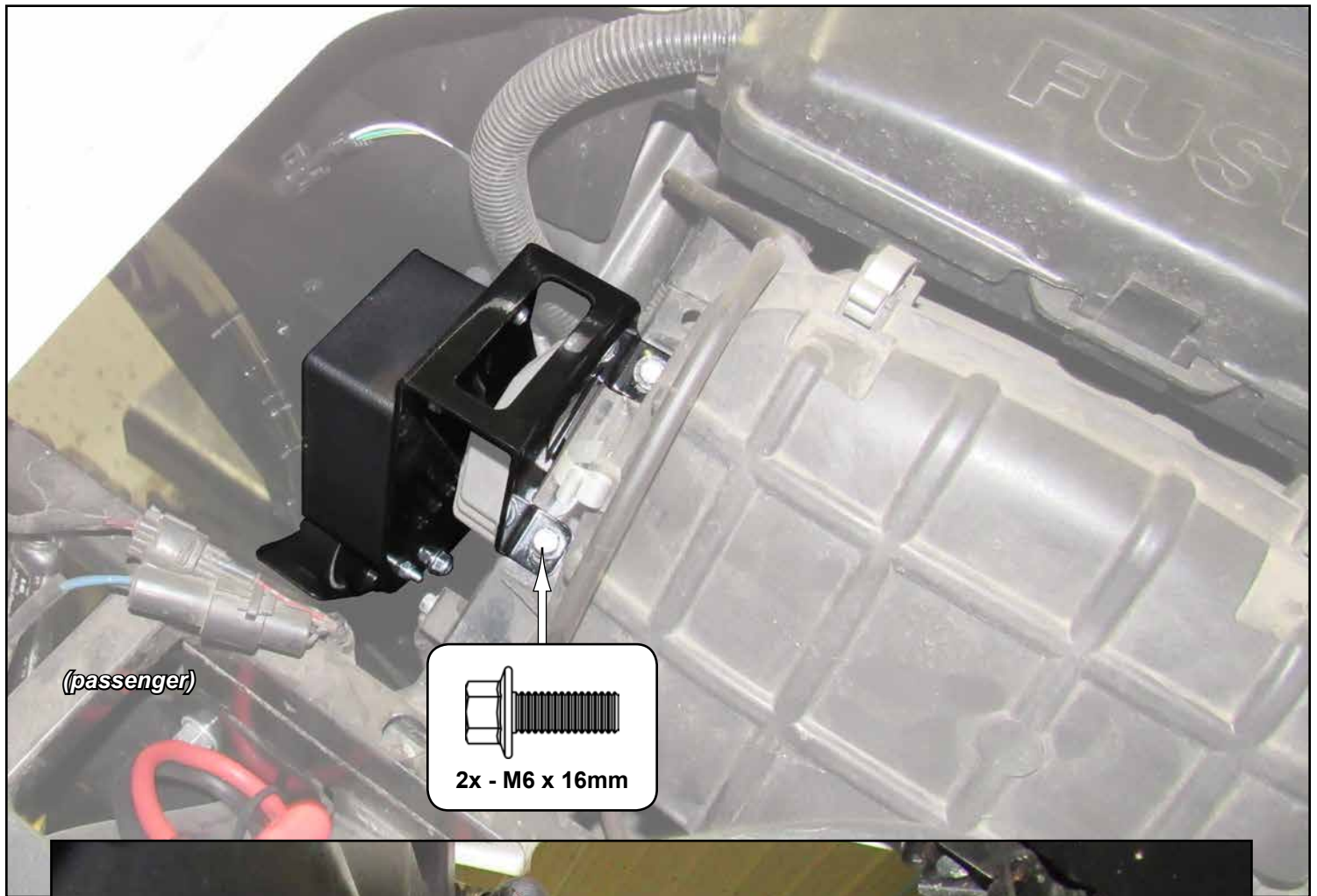

Turn Signal Light:

- Drill a Ø3/4" hole in body and install Turn Signal Light. Repeat for remaining Turn Signal Lights.
- Connect Turn Signal Lights to appropriate connections on Front Harness.
- Secure all Wires as needed.

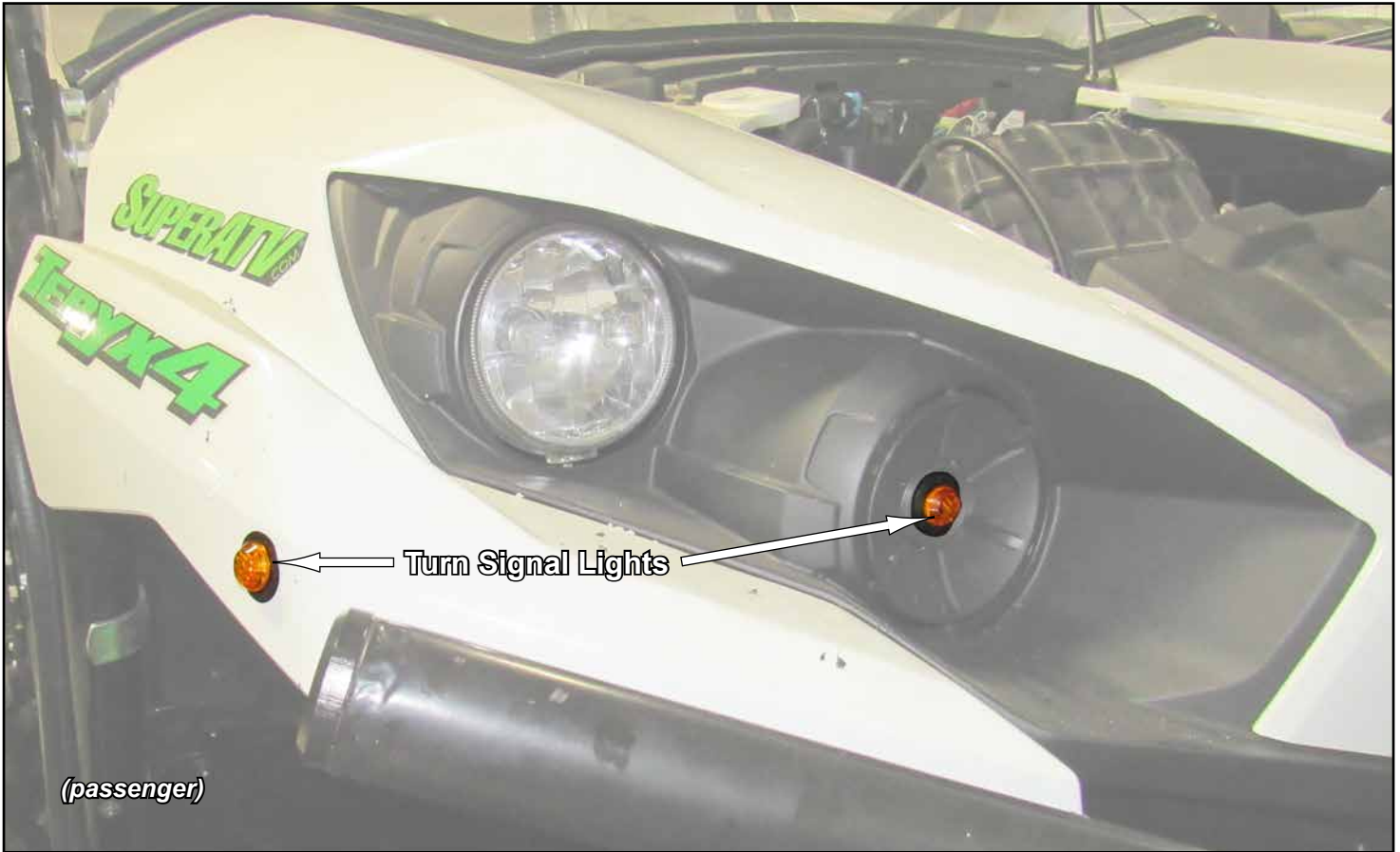

**If Light is hard to insert
separate as shown.**

- Separate LED from Gasket.
- Install Gasket into hole.
- Install LED into Gasket.

Gasket



LED

Switch Orientation

TERMINAL 7 AND ARROW MUST BE ORIENTED AS SHOWN



Rotate Actuator 180°

- Gently pry one side up.
- Pry opposite up and remove Actuator.
- Rotate and snap Actuator into place.



Switch Templates



Before drilling any holes, check behind area to be drilled for any interference.

Switch Mounting:

- User may install Switches in locations different than shown.
- Verify that Wire Harnesses will reach Switches before mounting.
- Connect appropriate wire harnesses to Switches.

Before permanently mounting Switches, SuperATV recommends testing after all components have been installed.

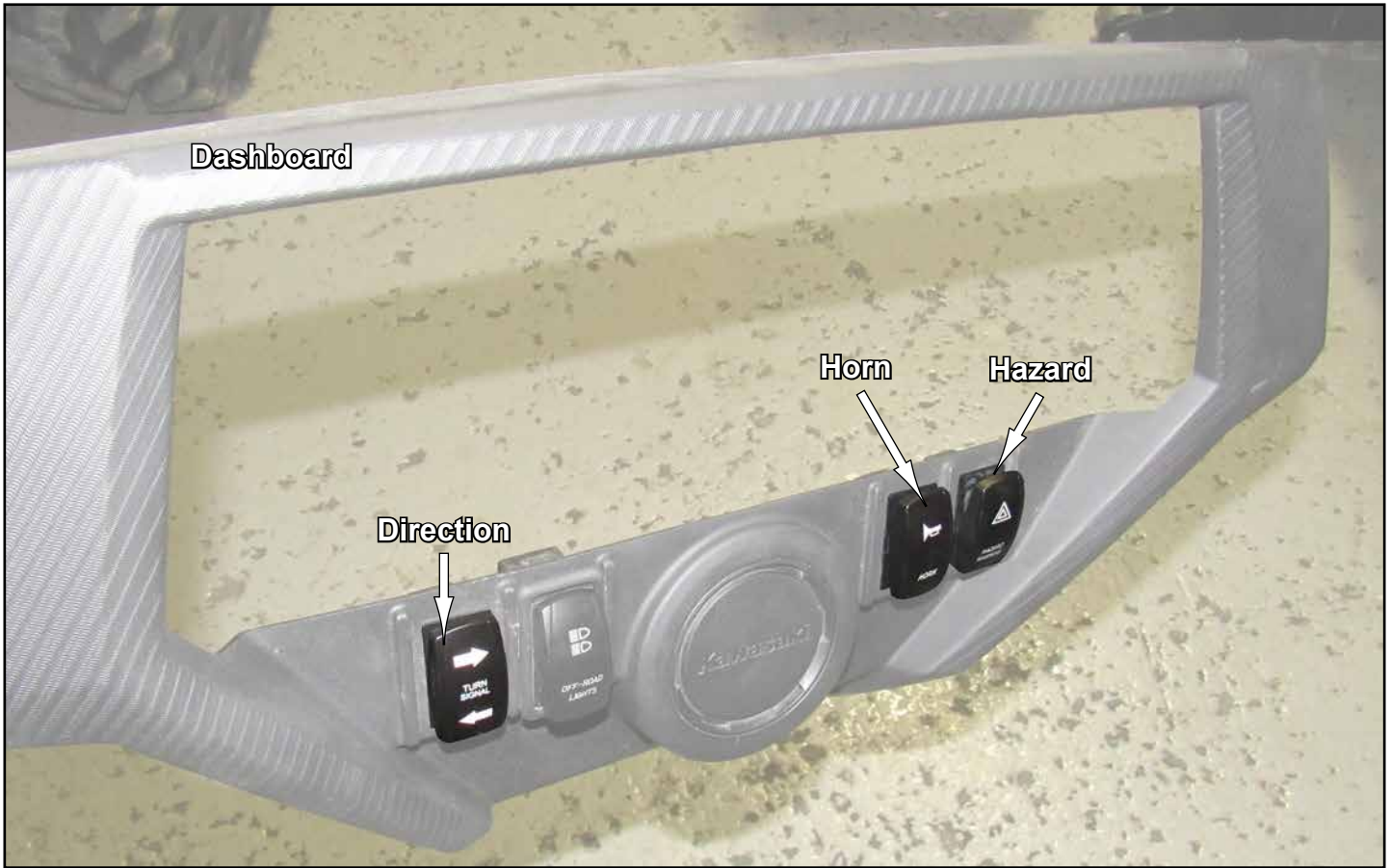

Rear Harness routing:

- Route Rear Harness from Control Box to rear of machine.
- Follow factory harness when possible.
- Secure away from rotating and hot components.

Seats and Center Console must be removed for routing. Reinstall when complete.

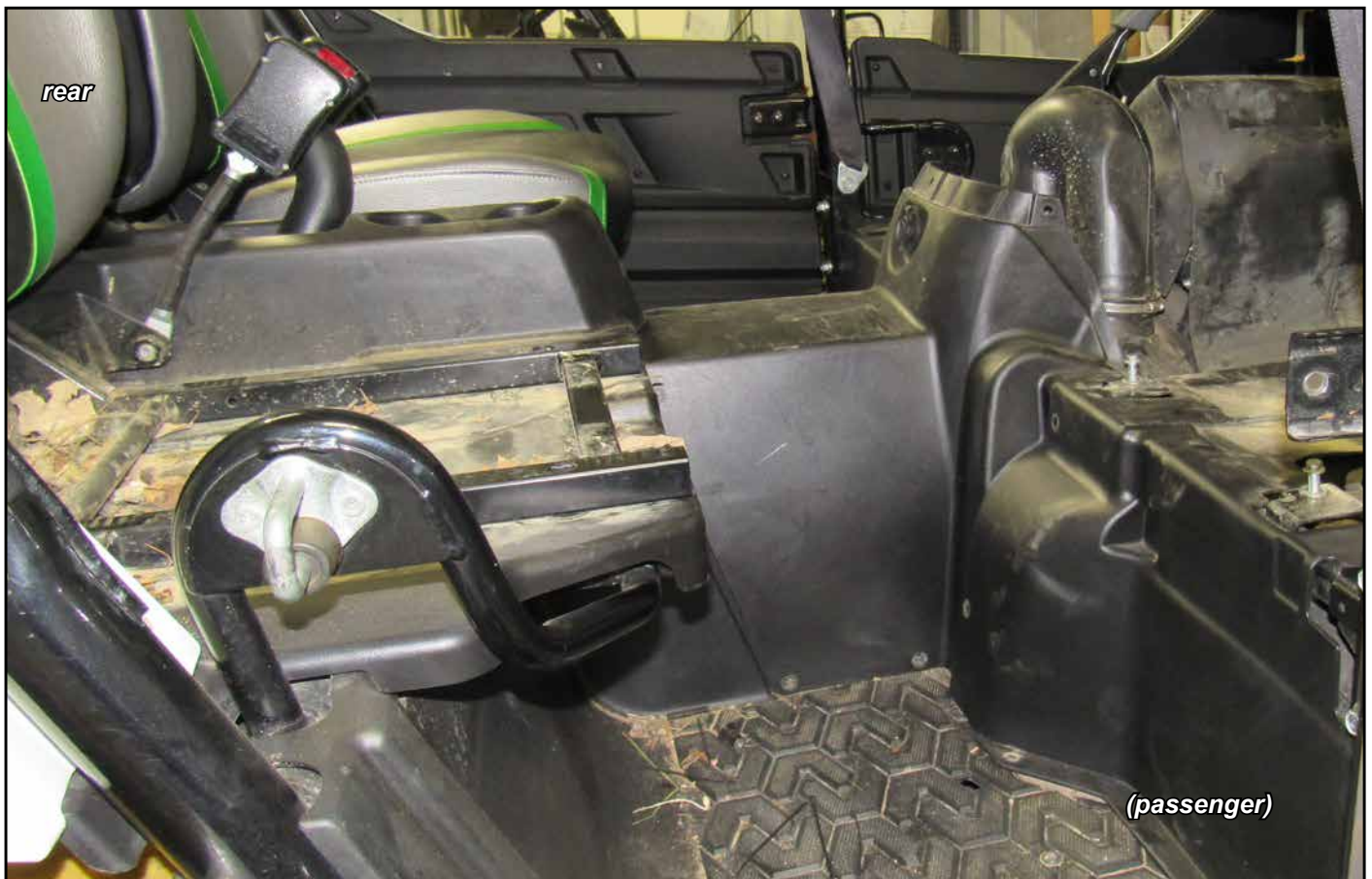

Rear Harness routing:



Rear Harness:

- Disconnect stock Tail Light harnesses as shown.

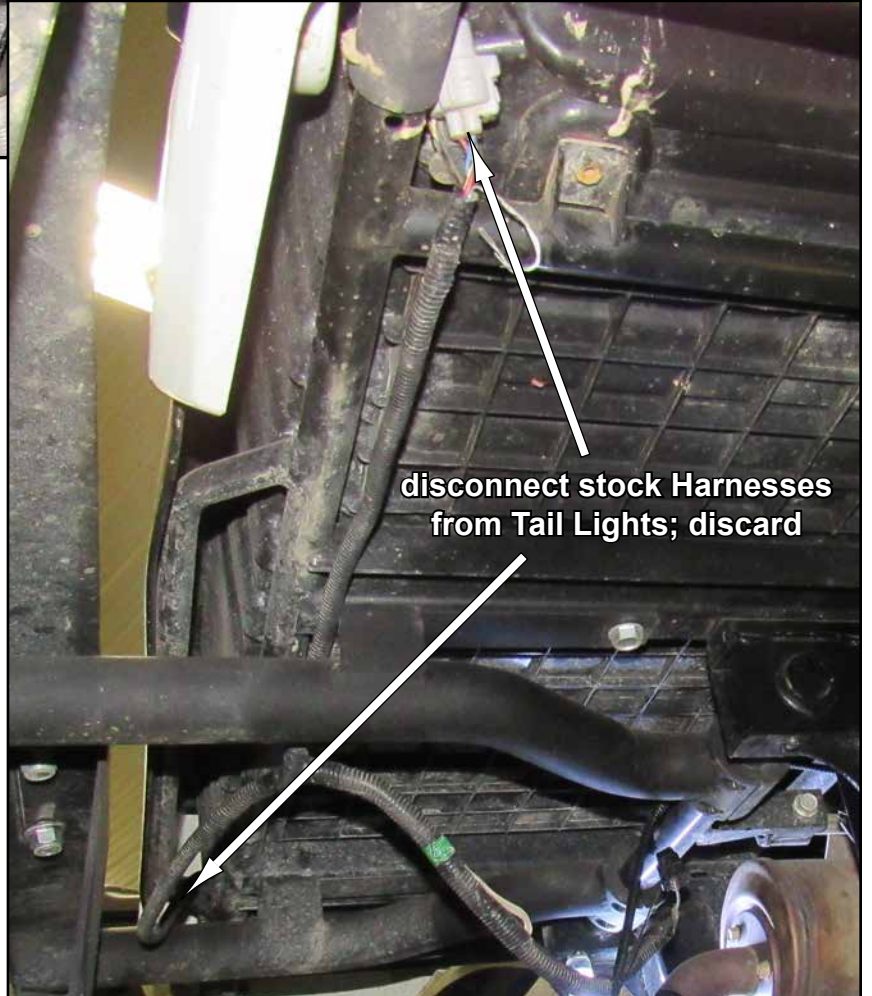

Rear Harness continued:

- Connect Rear Harness to stock Harness and Tail Lights.
- Secure all Wires as needed.

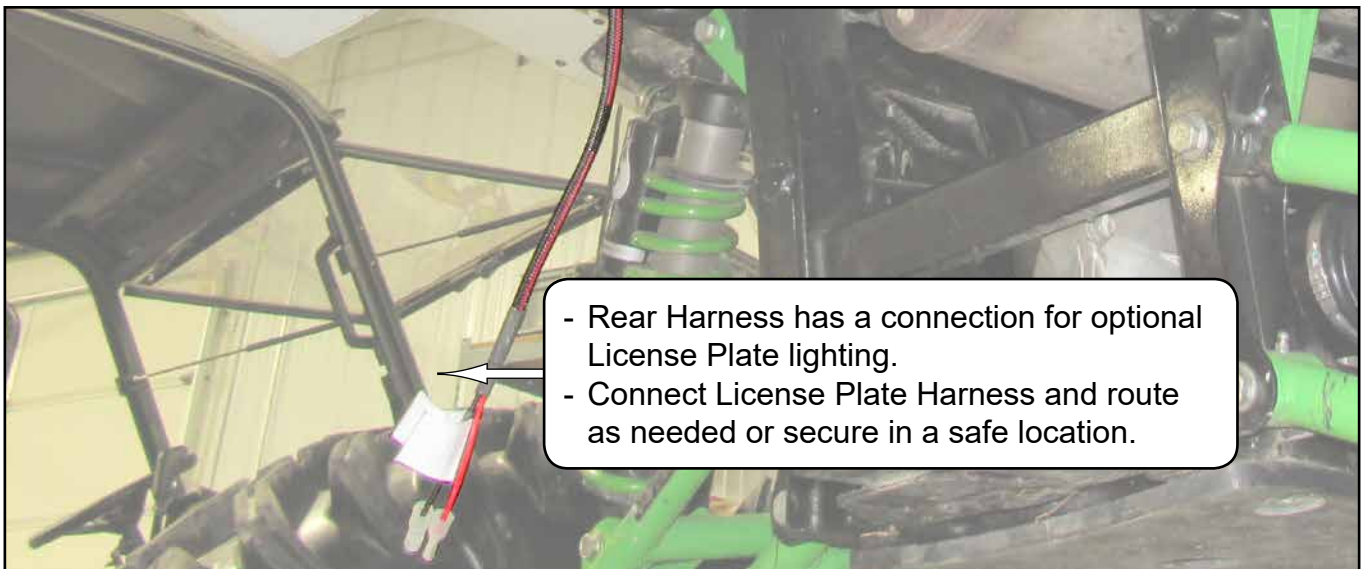

Power connection:

- Route harness from Control Box up to Fuse Box.
- Remove Fuse Box Cover and make connection shown. Replace Hood.



CUSTOMER NOTIFICATION AND DISCLAIMER LIABILITY

This product is a modification for utility task vehicles and all terrain vehicles. Use this product at your own risk.

Warranty and Liability Limitations. The Buyer hereby assumes all risks associated with the use and/or installation of this product. Buyer waives all liability claims against SuperATV® of any kind or nature, including, but not limited to, liability for penalties, fines, property damage, personal injury or death, to the fullest extent permitted by law. Buyer acknowledges and agrees that SuperATV® is not liable for any direct, indirect, incidental, consequential or special damages, including but not limited to, damage, loss of life, loss of property or equipment, loss of profits or revenue, injury, or claims from any individual or entity arising from the use of this product.

The warranty for this product, if any, may give you ("Buyer") specific legal rights, and Buyer may also have other rights which may vary from state to state. The installation of this product may void or otherwise adversely affect your factory warranty.

Consult your vehicle warranty before using this Product. Under no circumstances will SuperATV® be liable for the voidance of the Buyer's vehicle warranty. Buyer assumes all risk and responsibility if a manufacturer and/or dealer voids the Buyer's vehicle warranty due to use of this Product.

Safety and Laws. Operate your vehicle at all times in a safe manner. You must abide by all local, state, and federal laws, including but not limited to vehicle safety, traffic laws, and ordinances. It is your responsibility to know the laws and how they apply to you. The installation of this product may violate certain local, state, and federal laws. Be advised that laws vary depending on town, city, county, state, etc. Use of this product on public streets, roads, or highways may be in violation law. The Buyer is solely and exclusively legally and personally responsible for any violation of the law by the installation or use of this product. In no case will SuperATV® be held liable if Buyer violates the law or uses the product in an unsafe manner.

The Buyer is responsible to fully understand the capability and limitations of his/her vehicle according to manufacturer specifications, warnings and instructions and agrees to hold SuperATV® harmless from any damage resulting from failure to adhere to such specifications, warnings and/ or instructions. The Buyer is also responsible to obey all applicable federal, state, and local laws when operating his/her vehicle while using this product, and the Buyer agrees to hold SuperATV® harmless from any violation thereof.

Installation. The installation of this product on your vehicle indicates that you have had the opportunity to inquire about applicable local, state, and federal laws and ordinances and that you have read and understand, and accept all of the terms of, this Disclaimer.

SuperATV® shall not be responsible for the proper installation, use, and service of this product. Rather, the Buyer shall be solely responsible for the installation of the product and any damage that may be done to the vehicle or vehicle components as a result of modifications made by the Buyer.