

# S6102

94-02 Dodge Cummins, 2500/3500 Turbo-Back "Cool Duals"

# MBRP INC.

## PERFORMANCE EXHAUST

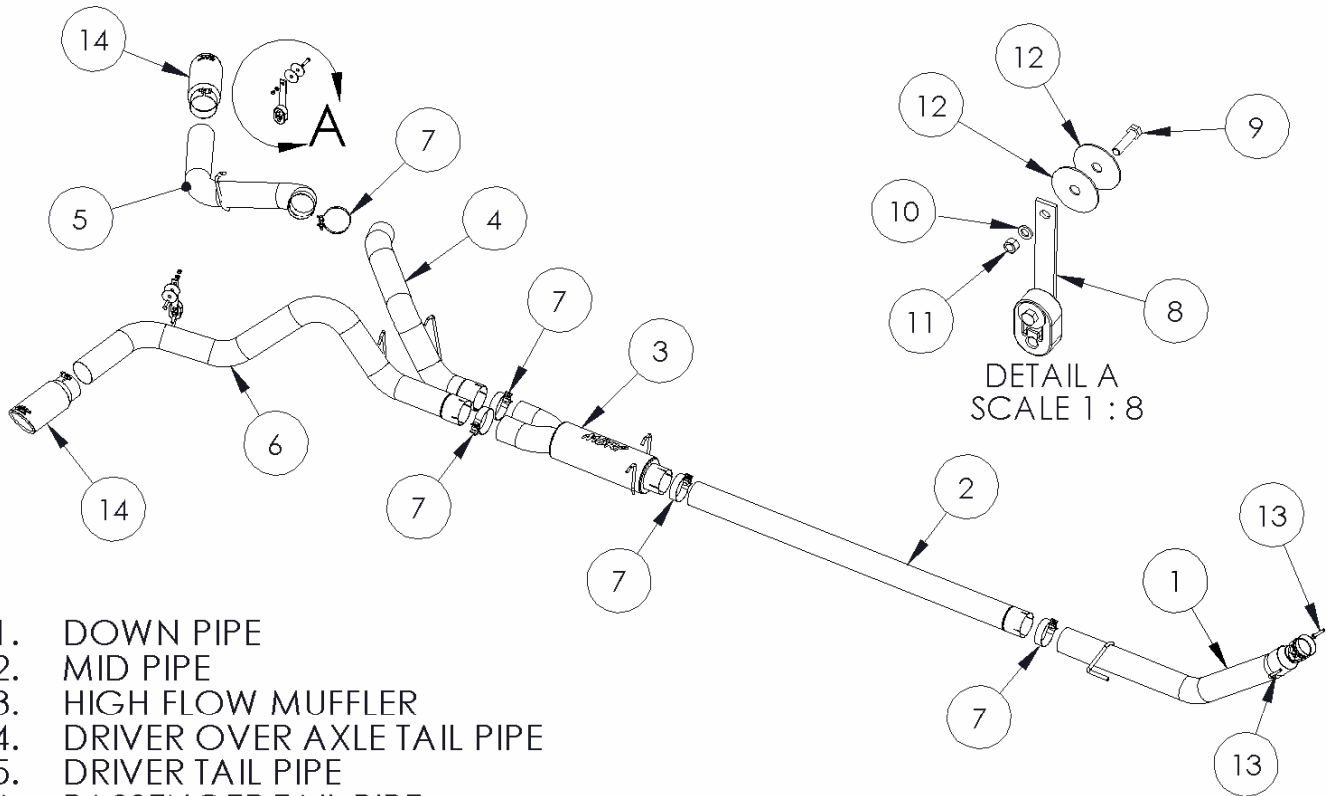

1. DOWN PIPE
2. MID PIPE
3. HIGH FLOW MUFFLER
4. DRIVER OVER AXLE TAIL PIPE
5. DRIVER TAIL PIPE
6. PASSENGER TAIL PIPE
7. 4" BAND CLAMP (SADDLE CLAMP USED IN ALUMINIZED KIT) (5PCS)
8. HANGER KIT (2PCS)
9. HEX BOLT 3/8" X 1-1/2" (2PCS)
10. LOCK WASHER 3/8" (2PCS)
11. NUT 3/8" (2PCS)
12. FENDER WASHER 3/8" (4PCS)
13. HEX BOLT - M10 X 1.5" (2PCS)
14. EXHAUST TIP (2PCS)

### PLEASE READ BEFORE STARTING INSTALATION

While MBRP Inc. has made every effort to ensure that all components of this system are of superior quality and properly packaged it is the installer's responsibility to ensure the following before removal of the factory exhaust:

- that ALL components shown above are present.
- that ALL mating components fit together.
- that there are no damaged components.
- that the system you have purchased is appropriate for your vehicle year, model and configuration.
- that the system will not interfere with any modifications previously installed or planned.
- that you have read and understand these instructions.

If you have any questions or are uncertain about any aspect of the installation of this system to your vehicle please contact your dealer before commencing installation.



## **Removal of stock system:**

1. Separate the stock exhaust system at the slip joint by the muffler. Remove the rear exhaust from rubber hangers and remove the system from under the truck.
2. Using a 15mm socket or wrench, remove the two (2) bolts at the turbo flange and remove the stock down pipe.

## **Installation of MBRP Inc. Performance Exhaust:**

1. Install the **Down Pipe** in the same position as the stock down pipe placing the hanger into the OEM rubber insulator and attaching the flared end to the turbo using the supplied hardware. Do not fully tighten until all components are in place.
2. Install the **Extension Pipe** over the **Down Pipe**. The **Extension Pipe** may require cutting to accommodate vehicles other than the Quad Cab long bed.  
(**Installation tip:** Temporarily hang the muffler in place using the two OEM rubber hangers and measure from the muffler to the down pipe to determine the length required.)
3. Install the **Muffler** over the **Extension Pipe** and into the OEM rubber hangers above the inlet.
4. Install the **Over Axle Pipe** onto the **Muffler** outlet closest to the drive shaft. Insert the pre-welded hanger on the **Over Axle Pipe** into the OEM rubber hanger located directly above the **Muffler** outlet.
5. Install the **Driver Side Tail Pipe** by feeding it around the outside of the shock and connecting it to the **Over Axle Pipe**.
6. Using the factory hole located in the frame, found directly above the **Tail Pipe** hanger, attach the **Rubber Hanger** provided using the supplied hardware. Hang the **Tail Pipe** using the installed **Rubber Hanger**.
7. Install the **Passenger Side Tail Pipe** onto the remaining **Muffler** outlet.
8. Using the factory hole located in the frame, found directly above the **Tail Pipe** hanger, attach the **Rubber Hanger** provided using the supplied hardware. Hang the **Tail Pipe** using the installed **Rubber Hanger**.
9. Install the provided **Clamps** around the pipes where required. Adjust the **Tail Pipe** and check along the whole length of the exhaust system to ensure there is adequate clearance around the fuel and brake lines or any wiring. If any interference is detected relocate or adjust.
10. Ensure that the exhaust is in place before tightening clamps. Start at the front of the exhaust system and begin tightening all connections.
11. Install and adjust the **Tip** to suit. Using a 17mm wrench tighten lock bolt located on the **Tip**.

**Congratulations!** You are ready to begin enjoying the improved performance and driving experience of your MBRP Inc. performance exhaust system. We hope you enjoy your purchase.